

KONIKA 11x17  
REVIEWED BY: JSH  
JAN 2022

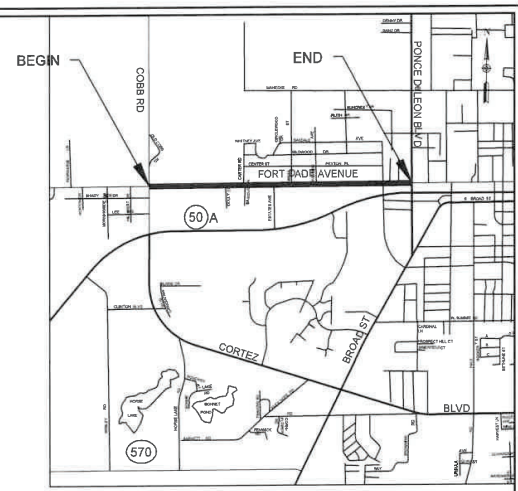

**HERNANDO COUNTY**  
**BOARD OF COUNTY COMMISSIONERS**  
**DEPARTMENT OF PUBLIC WORKS**  
**ENGINEERING DIVISION**  
**FORT DADE AVENUE**  
**MILLING & RESURFACING PLANS**  
 FPN# 448503-1-54-01



**PROJECT LOCATION MAP**  
 (NOT TO SCALE)

SECTIONS: 20, 21, 22, TOWNSHIP: 22 SOUTH, RANGE: 19 EAST  
 HERNANDO COUNTY, FLORIDA

**COUNTY COMMISSIONERS**

- DISTRICT 1 - ELIZABETH NARVERUD (2nd VICE CHAIRMAN)
- DISTRICT 2 - WAYNE DUKES
- DISTRICT 3 - JOHN ALLOCCO (VICE CHAIRMAN)
- DISTRICT 4 - JEFF HOLCOMB
- DISTRICT 5 - STEVE CHAMPION (CHAIRMAN)

CEO# 22-111670

**DRAWING INDEX**

SHEET NUMBER	DRAWING DESCRIPTION
1.	COVER SHEET
2.	GENERAL NOTES SHEET
3.	TYPICAL SECTION SHEET
4. - 10.	PLAN SHEETS

COUNTY ADMINISTRATOR - JEFFREY W. ROGERS, P.E.  
 DEPUTY COUNTY ADMINISTRATOR - TOBEY PHILLIPS  
 PUBLIC WORKS DIRECTOR / COUNTY ENGINEER - J. SCOTT HERRING, P.E.  
 ASSISTANT COUNTY ENGINEER - D. TODD CROSBY, P.E.

**FINAL CONSTRUCTION PLANS**

**DESIGN AND CONSTRUCTION REFERENCE**

GOVERNING STANDARDS AND SPECIFICATIONS:

- MANUAL OF UNIFORM MINIMUM STANDARDS FOR DESIGN, CONSTRUCTION & MAINTENANCE OF STREETS & HIGHWAYS, 2018 (F.D.O.T. GREENBOOK).
- F.D.O.T. FY2022-23 STANDARD PLANS FOR ROAD & BRIDGE CONSTRUCTION.
- F.D.O.T. FLORIDA DESIGN MANUAL, LATEST EDITION.
- DIVISION II & III OF THE F.D.O.T. JULY 2022 STANDARD SPECIFICATIONS FOR ROAD & BRIDGE CONSTRUCTION.
- MANUAL ON UNIFORM TRAFFIC CONTROL DEVICES (MUTCD), 2009 w/ REV 1 & 2 (MAY 2012).
- HERNANDO COUNTY FACILITY DESIGN GUIDELINES, OCT. 2008.
- HERNANDO COUNTY UTILITIES DEPARTMENT WATER, RECLAIMED WATER AND WASTEWATER CONSTRUCTION SPECIFICATION MANUAL LATEST EDITION.

DATE 8 / 19 / 2022

**UTILITY COMPANY CONTACTS**

COMPANY	CONTACT	PHONE NUMBER
HERNANDO COUNTY UTILITIES	Brad Smith	(352) 754-4858 (352) 754-4037
AT&T	SHAUN PURVIS (ENG) HEATHER BIRGE (ENG) TED KUKICH (CONST)	(407) 321-6909 CELL (407) 496-6259 (407) 403-3582 (352) 754-3888
SPECTRUM / CHARTER COMMUNICATIONS	TONY EICHHORN	(352) 746-7664 EXT 2084915
DUKE ENERGY	T. K. CHRISTIE	(863) 678-4403
WREC (Hernando) WREC (Pasco)	DONALD TAULBEE COREY LITTLEFIELD	(352) 596-4000 Ext 3130 (352) 588-5115 Ext 1130
SUNSHINE STATE ONE CALL		811
TECO ENERGY (PEOPLE'S GAS)	CHRIS URIA DARLENE CALLENDER TODD TAYLOR	(813) 257-3731 (813) 275-3735 (813) 228-4577 / (813) 917-4577
HERITAGE PROPANE	DON TAYLOR	(352) 683-4187

	LENGTH OF PROJECT	
	LINEAR FEET	MILES
FORT DADE AVENUE	7304	1.383
GROSS LENGTH OF PROJECT	7304	1.383

PLAN REVISIONS			
NO.	DATE	REVISION	BY
1	4/11/2022	REVISIONS PER ERC COMMENTS	SEN
2	4/25/2022	REVISIONS PER ERC COMMENTS	SEN
3	8/19/2022	REVISIONS PER ERC COMMENTS	SEN



Know what's below.  
Call before you dig.

PERMITS & EXEMPTIONS	
SWFWMD	N/A
USACE	N/A
DEP	N/A
FEMA	N/A

J. SCOTT HERRING, P.E.  
 COUNTY ENGINEER  
 HERNANDO COUNTY,  
 FLORIDA, FLORIDA REG. #45241

SIGNATURE \_\_\_\_\_  
 DATE \_\_\_\_\_  
 VALID ONLY WITH SIGNATURE & DATE

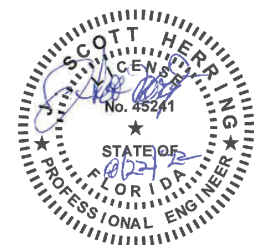

4 full bleed @ (11.00 x 17.00 inches), 1:1

### GENERAL NOTES:

1. INTENTIONALLY LEFT BLANK.
2. ALL DISTURBED AREAS, INCLUDING AREAS OUTSIDE THE CONSTRUCTION LIMITS, MUST BE RETURNED TO THEIR PRE-CONSTRUCTION CONDITIONS UPON COMPLETION OF THE PROJECT AT THE CONTRACTORS EXPENSE.
3. CONSTRUCTION WORK HOURS MUST BE FROM 7:30 AM TO 5:00 PM MONDAY THROUGH FRIDAY, EXCEPT COUNTY RECOGNIZED HOLIDAYS. THE CONTRACTOR WILL REQUEST PERMISSION IN WRITING MINIMUM **FIVE (5)** DAYS IN ADVANCE IF THE INTENTION IS TO WORK ON WEEKENDS AND HOLIDAYS (SUBJECT TO AVAILABILITY OF INSPECTORS).
4. ALL ITEMS MUST BE REMOVED UPON COMPLETION OF THE PROJECT. INCLUDES ANY SILT, SEDIMENT, TRASH OR CONSTRUCTION DEBRIS.
5. IT WILL BE THE CONTRACTORS RESPONSIBILITY TO ENSURE MATERIALS ARE READY FOR TESTING. THE ON SITE HERNANDO COUNTY DPW INSPECTOR MUST COORDINATE TESTING OF THOSE MATERIALS. TESTING LAB REQUIRES 24 HOUR NOTICE MINIMUM FOR SCHEDULING ANY WORK. HERNANDO COUNTY WILL NOT BE CHARGED FOR FAILED RESULTS. HERNANDO COUNTY WILL PROVIDE AN INVOICE TO THE CONTRACTOR FOR ANY FAILING TESTING PROVIDED BY THE TESTING LAB.
6. D.E.P. N.O.I. PERMIT IS NOT REQUIRED.
7. ASPHALT SUBMITTALS MUST BE RECEIVED AND APPROVED BY HERNANDO COUNTY ENGINEERING PRIOR TO INSTALLATION. ALL ASPHALT SAMPLING AND TESTING WILL BE COORDINATED BY HERNANDO COUNTY. TESTING LAB REQUIRES 24 HOUR NOTICE MINIMUM FOR SCHEDULING ANY WORK.
8. THE CONTRACTOR IS TO USE SPECIAL ATTENTION WHEN MILLING AND MATCHING SIDE STREETS & DRIVEWAYS BACK TO NEW ASPHALT. IT WILL BE THE CONTRACTORS RESPONSIBILITY TO MATCH THESE DRIVEWAYS BACK PROPERLY.
9. THE CONTRACTOR WILL HAUL ALL EXCESS MATERIALS OFF THE JOB SITE. IT WILL BE THE CONTRACTORS RESPONSIBILITY TO DISPOSE OF ALL EXCESS MATERIAL AFTER IT IS DETERMINED THAT IT IS NO LONGER NEEDED ON THE JOB. UNSUITABLE MATERIAL FROM WITHIN THE PROJECT MUST BE DISPOSED OF OFF SITE BY THE CONTRACTOR. SUITABLE MATERIAL FROM WITHIN THE PROJECT MUST BE USED FOR FILL WHERE NEEDED WITHIN THE PROJECT LIMITS AND EXCESS DISPOSED OF BY CONTRACTOR WHEN NO LONGER NEEDED.
10. ALL CONSTRUCTION ACTIVITIES, MATERIALS AND WORKMANSHIP MUST BE IN ACCORDANCE WITH HERNANDO COUNTY FACILITIES DESIGN GUIDELINES HERNANDO COUNTY ENGINEERING AND FDOT STANDARD SPECIFICATIONS FOR ROAD AND BRIDGE 2022. MANUAL OF UNIFORM MINIMUM STANDARDS FOR DESIGN, CONSTRUCTION & MAINTENANCE OF STREETS & HIGHWAYS, 2018 (F.D.O.T. GREENBOOK).
11. THE CONTRACTOR IS RESPONSIBLE FOR PROVIDING HAUL TICKETS FOR ANY MATERIAL SUPPLIED ONSITE TO THE HERNANDO COUNTY CONSTRUCTION INSPECTOR. ASPHALT TICKETS WILL BE COLLECTED DAILY DURING PAVING OPERATIONS. ANY INVOICE/HAUL TICKET FOR MATERIALS DELIVERED MUST BE MADE AVAILABLE TO THE HERNANDO COUNTY CONSTRUCTION INSPECTOR UPON REQUEST.
12. IF, DURING OR PRIOR TO CONSTRUCTION OPERATIONS, THE ENGINEER SHOULD FAIL TO REJECT DEFECTIVE WORK OR MATERIALS, WHETHER FROM LACK OF DISCOVERY OF SUCH DEFECT OR FOR ANY REASON, SUCH INITIAL FAILURE TO REJECT MUST IN NO WAY PREVENT HIS/HER LATER REJECTION WHEN SUCH DEFECT IS DISCOVERED.
13. THE CONTRACTOR WILL MAINTAIN ALL WORK IN FIRST-CLASS CONDITION UNTIL IT HAS BEEN COMPLETED AS A WHOLE AND HAS BEEN ACCEPTED BY THE ENGINEER. WHEN ALL MATERIALS HAVE BEEN FURNISHED, ALL WORK HAS BEEN PERFORMED, AND THE CONSTRUCTION HAS BEEN SATISFACTORILY COMPLETED, THE ENGINEER WILL MAKE THE FINAL INSPECTION.
14. THE CONTRACTOR WILL DELIVER ALL MILLINGS TO THE HERNANDO COUNTY COBB ROAD STOCK PILE YARD (2000' NORTH OF YONTZ RD.), ALL MILLINGS MUST BECOME THE PROPERTY OF HERNANDO COUNTY. COUNTY STAFF TO COORDINATE ACCESS AT THE DROP-OFF SITE.
15. ALL PROPOSED REBUILD AREAS DEPICTED ON PLANS ARE SHOWN IN THERE APPROXIMATE LOCATION AND MUST BE FIELD LOCATED PRIOR TO CUTTING OUT AND EXCAVATING THE AREA INDICATED ON PLANS.
16. THE CONTRACTOR WILL MAINTAIN EXISTING POSTED SPEED DURING CONSTRUCTION ACTIVITIES.
17. THE CONTRACTOR WILL PROVIDE ACCESS TO DRIVEWAYS AT ALL TIMES.
18. THE CONTRACTOR WILL NOT ALLOW ANY DROP-OFF DEPTH OVER ONE INCH (1") TO BE LEFT OVERNIGHT.
19. MILLING LIMITS ON THE SIDE STREETS ARE MILLED TO THE RADIUS RETURNS AS SHOWN ON PLANS.
20. VIBRATORY ROLLING IS NOT ALLOWED. ONLY STATIC ROLLING IS ALLOWED PER HERNANDO COUNTY.
21. THE CONTRACTOR WILL ONLY EXCAVATE EXISTING BASE AND REPLACE RECYCLED CONCRETE AGGREGATE MATERIAL. ANY WORK NOT COMPLETE WITHIN WORK HOURS WILL BE SAFENED UP FOR TRAFFIC USE BY 5:00 PM EACH DAY.
22. WORKING THE REBUILD AREA WILL BE IN EITHER W.B.L. OR E.B.L. ONLY AT ONE TIME. NO WORK WILL CROSS OVER THE CENTERLINE AT ANY TIME.

### UTILITY NOTES:

1. THE CONTRACTOR WILL CALL SUNSHINE STATE ONE CALL OF FLORIDA, INC. (SSOCOF) AT 811 OR 1-800-638-4097 AND ALL LISTED UTILITY OWNERS 48 HOURS BEFORE BEGINNING CONSTRUCTION OPERATIONS. ALL UTILITY OWNERS MAY NOT BE SSOCOF MEMBERS, IN WHICH CASE, DIRECT CONTACT BY THE CONTRACTOR IS REQUIRED. THE CONTRACTOR WILL BE RESPONSIBLE FOR COORDINATING DIRECTLY WITH ALL THE UTILITY OWNERS.
2. DUE TO EXISTING UNDERGROUND AND OVERHEAD UTILITIES WITHIN THE PROJECT LIMITS, EXTREME CAUTION WILL BE EXERCISED BY THE CONTRACTOR WHEN CLEARING AND GRUBBING, EXCAVATING, INSTALLING DRAINAGE STRUCTURES, BACKFILLING AND COMPACTING IN CLOSE PROXIMITY TO EXISTING UTILITIES.
3. ALL EXISTING UTILITIES ARE TO REMAIN UNLESS OTHERWISE NOTED ON THE PLANS. EXISTING UNDERGROUND AND OVERHEAD UTILITIES WITHIN THE PROJECT AREA AND ADJACENT TO THE PROJECT MUST BE PROTECTED DURING CONSTRUCTION OPERATIONS. DAMAGE TO EXISTING UTILITIES WILL BE REPAIRED AT THE CONTRACTOR'S EXPENSE.
4. THE LOCATION(S) OF THE UTILITIES SHOWN ON THE PLANS ARE BASED ON LIMITED INVESTIGATION TECHNIQUES AND SHOULD BE CONSIDERED APPROXIMATE ONLY.
5. THE CONTRACTOR WILL BE RESPONSIBLE FOR COORDINATING AND SCHEDULING ALL UTILITY RELOCATIONS WITH THE UTILITIES OWNERS.
6. ALL STAKING OF PROPOSED CONSTRUCTION TO ALLOW FOR PROPER INSTALLATION / RELOCATION OF UTILITIES WILL BE PERFORMED BY THE CONTRACTOR. THE CONTRACTOR WILL COORDINATE WITH THE IMPACTED UTILITIES AND STAKE THE ITEMS REQUESTED. THIS STAKING WILL BE SEPARATE AND IN ADDITION TO THE NORMAL STAKING FOR THE PROJECT. THE COST WILL BE INCIDENTAL TO AND INCLUDED IN THE COST OF THE PROJECT.

### SIGNING AND PAVEMENT MARKING NOTES:

1. SIGNING AND PAVEMENT MARKINGS SHOULD BE PLACED AS SHOWN IN THE PLANS AND PER THE 2009 MANUAL OF UNIFORM TRAFFIC CONTROL DEVICES AND THE FDOT 2022 STANDARD PLANS.
2. THE SIGN LOCATIONS SHOWN IN THE PLANS ARE APPROXIMATE AND MAY REQUIRE FIELD ADJUSTMENT AS DIRECTED BY THE ENGINEER OR AS SHOWN ON THE PLANS. ALL COSTS TO BE INCLUDED IN PAY ITEM CLEARING & GRUBBING.
3. ALL EXISTING SIGNS ARE TO REMAIN IN PLACE UNLESS OTHERWISE NOTED ON THE PLANS.
4. ANY SIGN TO REMAIN THAT IS DISTURBED DURING CONSTRUCTION OR RELOCATED WILL BE RESET TO CURRENT STANDARDS FOR HEIGHT, OFFSET AND METHOD OF INSTALLATION. ALL COSTS TO BE INCLUDED IN PAY ITEM CLEARING & GRUBBING.
5. ALL MILLED AND/OR DISTURBED PAVEMENT MARKINGS WILL BE TEMPORARY PAINTED MEETING FDOT REQUIREMENTS AT THE END OF EACH WORK DAY BEFORE THE CONTRACTOR LEAVES THE JOBSITE AND/OR OPENS THE ROADWAY FOR USE.

### MOT NOTES:

1. THE CONTRACTOR WILL MAINTAIN EXISTING POSTED SPEED DURING CONSTRUCTION ACTIVITIES.
2. THE CONTRACTOR WILL PROVIDE ACCESS TO DRIVEWAYS AT ALL TIMES.
3. THE CONTRACTOR WILL NOT ALLOW ANY DROP-OFF DEPTH OVER ONE INCH (1") TO BE LEFT OVERNIGHT.
4. MILLING LIMITS ON THE SIDE STREETS ARE MILLED TO THE RADIUS RETURNS AS SHOWN ON PLANS.
5. THE CONTRACTOR WILL INSTALL MOT SIGNS PER FDOT 102-600 SERIES INDEXES AND MUST BE INSTALLED AND INSPECTED PRIOR TO BEGINNING ANY WORK WITHIN COUNTY RIGHT OF WAY.
6. CONTRACTOR WILL UTILIZE 102-603 INDEX FOR THE BASE REPLACEMENT WORK.
7. VARIABLE MESSAGE BOARDS WILL BE INSTALLED ON EACH END OF THE PROJECT FOR A MINIMUM 10 DAYS PRIOR TO BEGINNING OF ROAD REBUILD AREAS AND MILLING & RESURFACING COURSES.
8. FLAGGERS WILL BE USED ON EACH END OF EACH BASE REPLACEMENT AREAS UNDER CONSTRUCTION TO MAINTAIN SAFE ONE WAY TRAFFIC AT ALL TIMES.

FORT DADE AVENUE RESURFACING  
GENERAL NOTES SHEET

Sheet No. of 10

2

Scale: N.T.S.

Drawn By: SEN

22-111670

Drawing File Name: FORTDADE

HERNANDO COUNTY  
DEPARTMENT OF PUBLIC WORKS  
ENGINEERING DIVISION  
1525 East Jefferson Street  
Brooksville, FL 34601-2807  
(352) 794-4062

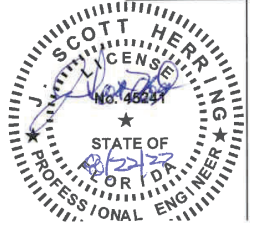

2021  
 CEO  
 BY: JSH  
 REVIEWED BY: KONIKA 11/17

R/W

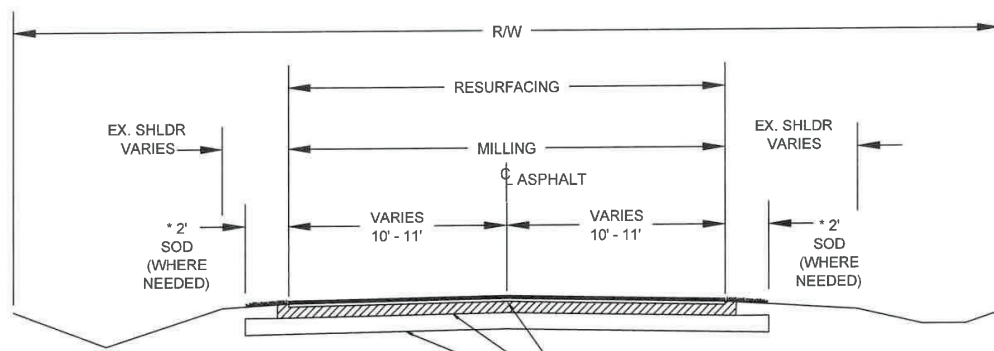

\* SOD AT EDGE OF PAVEMENT SHALL BE 1" BELOW FINAL PAVED SURFACE.

MAINTENANCE OF TRAFFIC NOTE

1. MOT TO BE PER FDOT INDEX 102-600 SERIES, INCLUDING BUT NOT LIMITED TO, INDEX 102-603 SHEET 1 OF 2 FOR TWO-LANE TWO-WAY ROADWAYS

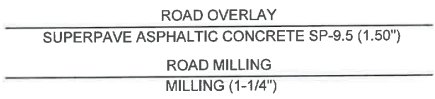

RESURFACING TYPICAL SECTION  
 N.T.S.

MILLING NOTES

1. THE CONTRACTOR SHALL PROVIDE, AS A MINIMUM, A 1:250 FEATHERING RATE, FOR ANY PAVEMENT ELEVATION CHANGE CAUSED BY MILLING OR RESURFACING ACTIVITIES THAT MOTORISTS WILL TRAVERSE DURING WORK.
2. THE CONTRACTOR SHALL TAKE ALL NECESSARY PRECAUTIONS TO PREVENT MILLED MATERIAL FROM ENTERING THE DRAINAGE SYSTEM. THE CONTRACTOR IS RESPONSIBLE FOR KEEPING INLETS CLEAN OF PAVING MATERIAL, SILT, LIMEROCK, AND DEBRIS DURING THE CONSTRUCTION AT NO ADDITIONAL COST.
3. AT NO TIME SHALL THE CONTRACTOR CLOSE THE ENTIRE MAINLINE IN BOTH DIRECTIONS AT THE SAME TIME. ONLY ONE LANE IS ALLOWED TO BE CLOSED DURING CONSTRUCTION.
4. THE CONTRACTOR SHALL NOTIFY THE COUNTY ENGINEERS OFFICE A MINIMUM 48 HOURS IN ADVANCE OF ANY LANE CLOSURES.
5. THE CONTRACTOR SHALL NOTIFY ALL LOCAL LAW ENFORCEMENT, EMERGENCY / RESCUE AGENCIES AND SCHOOL BUS TRANSPORTATION **24 HOURS** IN ADVANCE OF ANY PROPOSED LANE CLOSURES.
6. THE CONTRACTOR WILL DELIVER ALL MILLINGS TO THE HERNANDO COUNTY COBB ROAD STOCK PILE YARD (2000' NORTH OF YONTZ RD.). ALL MILLINGS MUST BECOME THE PROPERTY OF HERNANDO COUNTY. COUNTY STAFF TO COORDINATE ACCESS AT THE DROP-OFF SITE.

MATERIALS NOTE

1. APPROVED CERTIFIED FDOT MATERIALS SHALL BE USED PER LATEST DESIGN STADARDS AND STANDARD SPECIFICATIONS.

COMPACTION NOTE

1. NO VIBRATORY ROLLING SHALL BE ALLOWED. ONLY STATIC ROLLING IS ALLOWED.

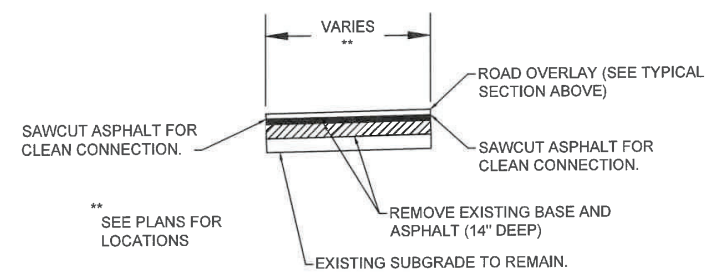

BASE REPLACEMENT  
 SUPERPAVE ASPHALTIC CONCRETE SP-12.5 (2")  
 RECYCLED CONCRETE AGGREGATE, COMPACTED (12")

REBUILD AREA (BASE REPLACEMENT) TYPICAL SECTION  
 N.T.S.

FORT DADE AVENUE RESURFACING  
 TYPICAL SECTION SHEET

Sheet No. 3 of 10  
 Scale: N.T.S.  
 Drawn By: SEN  
 Drawing File Name: FORTDADE  
 CEO No: 22-111670

HERNANDO COUNTY  
 DEPARTMENT OF PUBLIC WORKS  
 ENGINEERING DIVISION  
 1525 East Jefferson Street  
 Brooksville, FL 34601-2807  
 (352) 754-4062

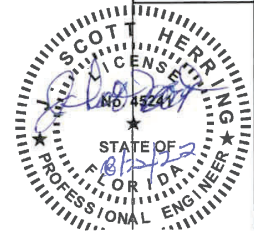

Full Sized B (11.00 x 17.00 inches), 1:1

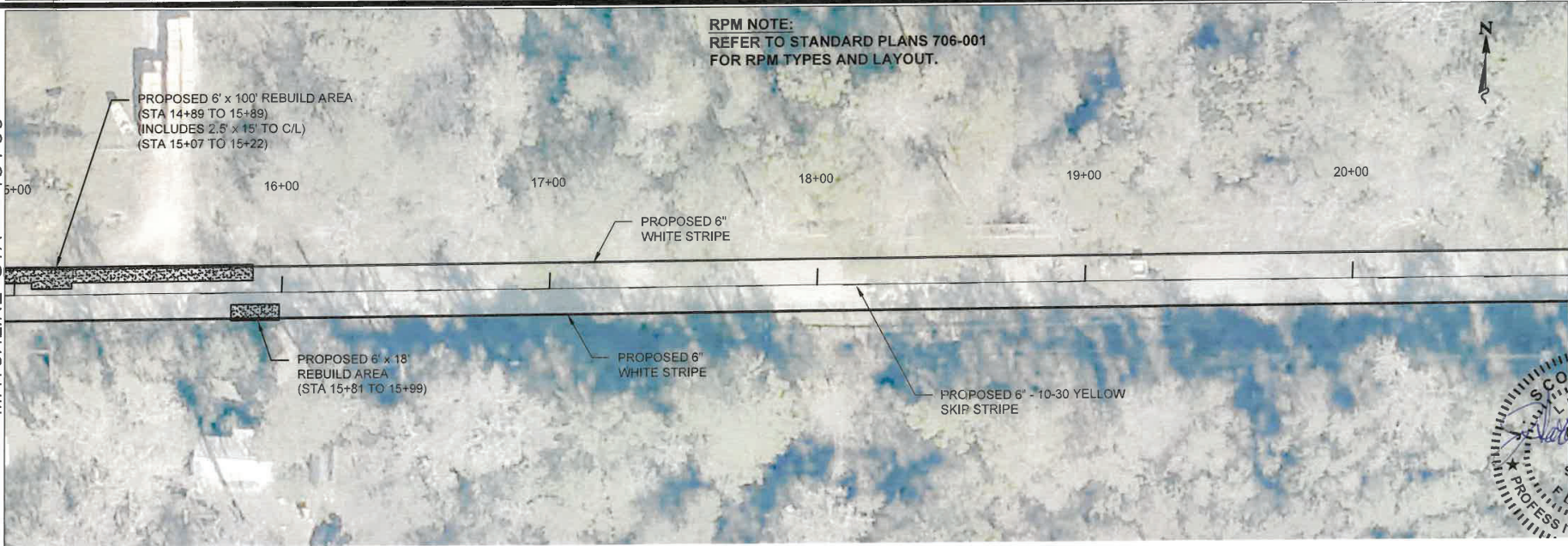
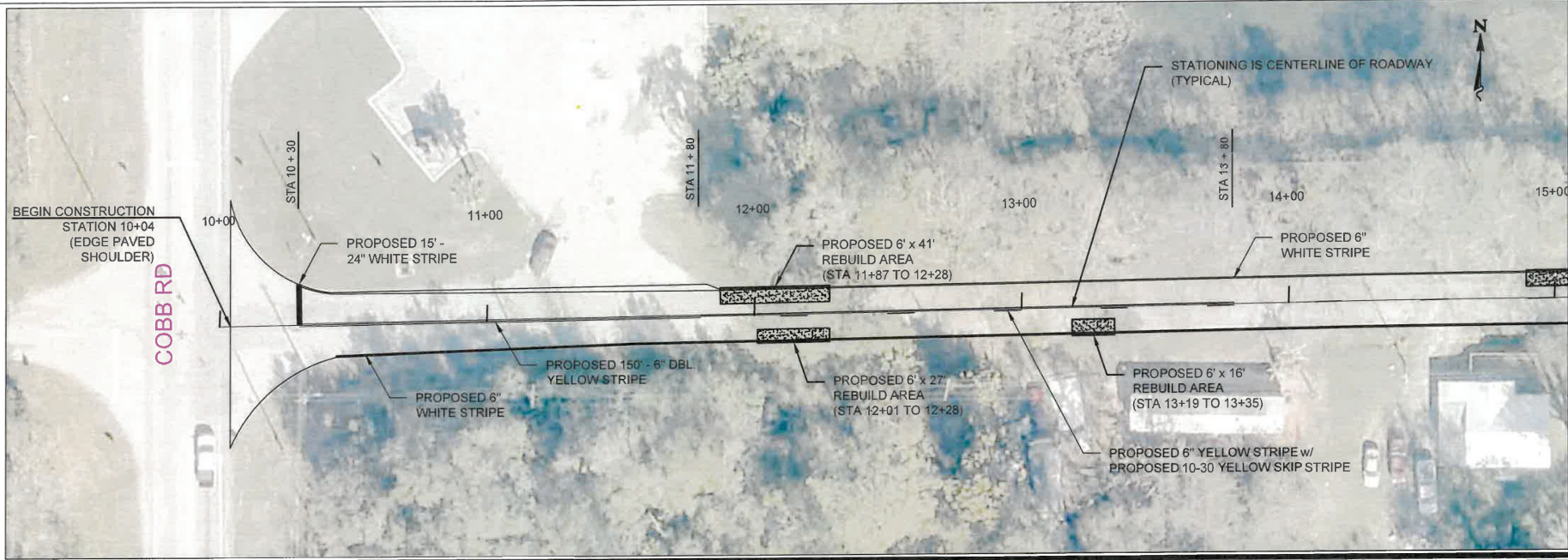

**RPM NOTE:**  
 REFER TO STANDARD PLANS 706-001  
 FOR RPM TYPES AND LAYOUT.

MATCHLINE - 15+00

MATCHLINE - 20+75

**FORT DADE AVENUE RESURFACING**

**PLAN SHEET 1**

HERNANDO COUNTY  
 DEPARTMENT of PUBLIC WORKS  
 ENGINEERING DIVISION  
 1526 East Jefferson Street  
 Brooksville, FL 34601-2807  
 (352) 754-4682



KONIKA 1/14/17  
REVIEWED BY JSH  
2021

MATCHLINE STA - 20+75

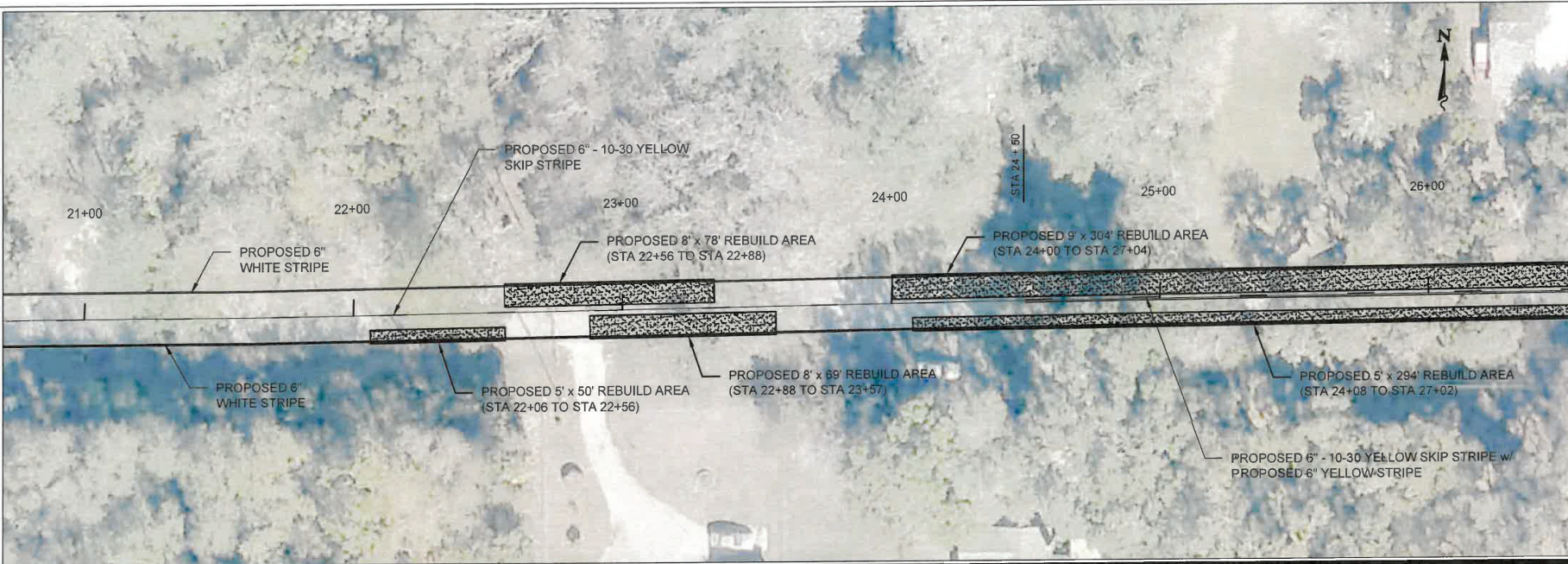

MATCHLINE - 26+50

FORT DADE AVENUE RESURFACING  
PLAN SHEET 2

Scale: 40  
Drawing File Name: FORTDADE  
Drawn By: SEN  
Sheet No. 5 of 10

Full Sized 8 1/2" x 11" (11.000 x 17.000 inches), T1

MATCHLINE STA - 26+50

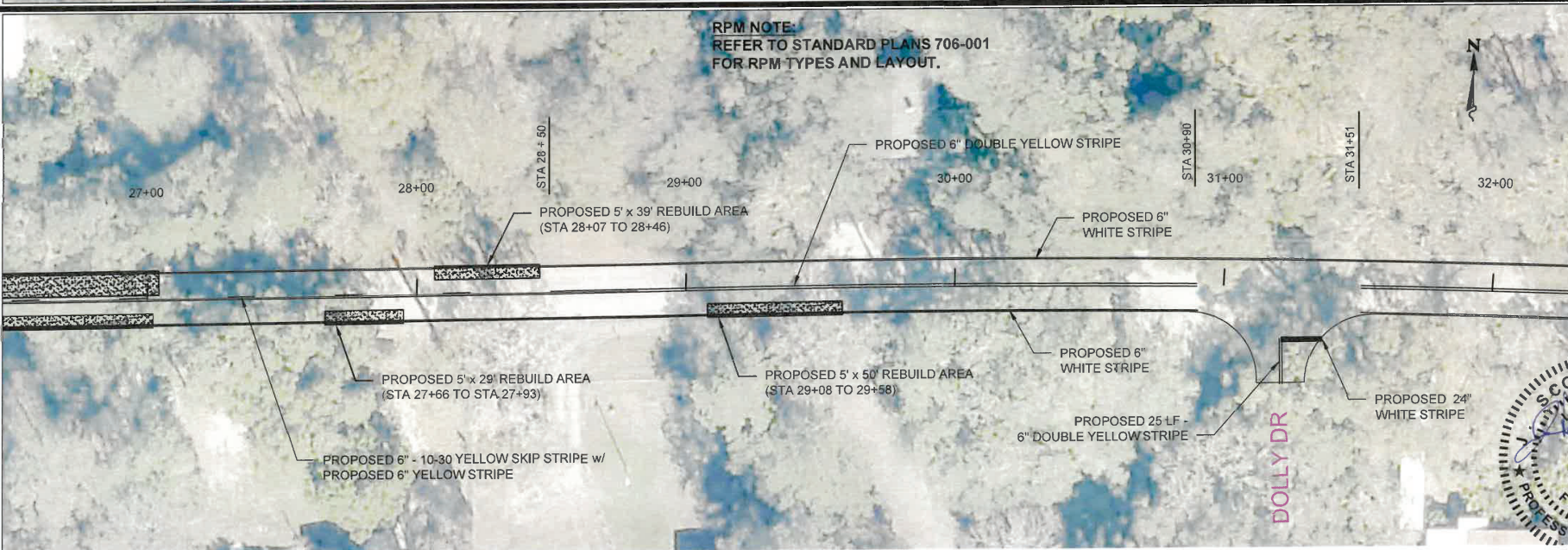

MATCHLINE - 32+25

RPM NOTE:  
REFER TO STANDARD PLANS 706-001  
FOR RPM TYPES AND LAYOUT.

HERNANDO COUNTY  
DEPARTMENT of PUBLIC WORKS  
ENGINEERING DIVISION  
1525 East Jefferson Street  
Brooksville, FL 34601-2807  
(352) 764-4082



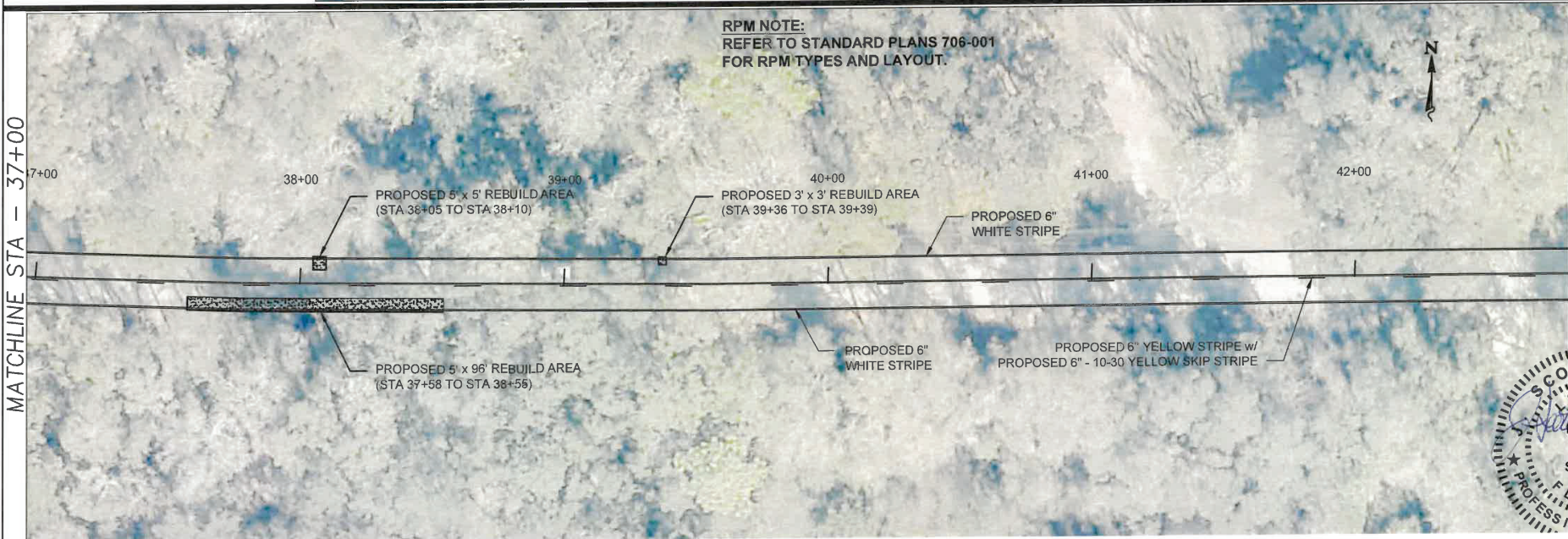
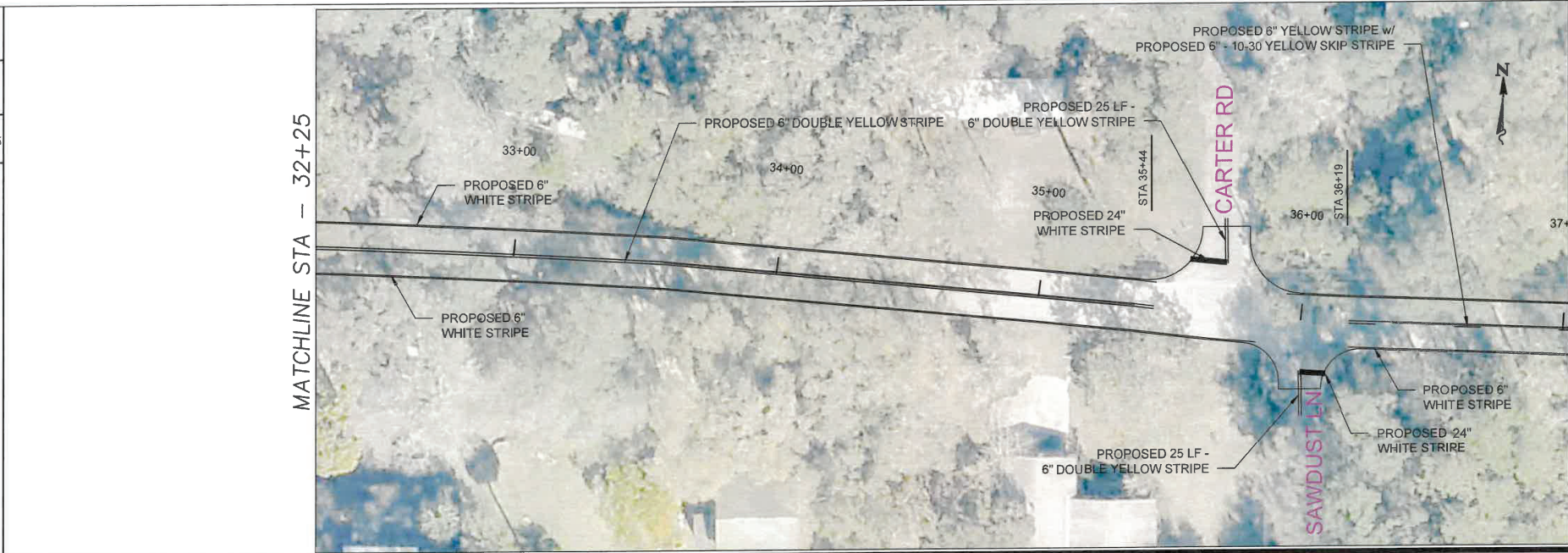

RPM NOTE:  
REFER TO STANDARD PLANS 706-001  
FOR RPM TYPES AND LAYOUT.

MATCHLINE STA - 32+25

MATCHLINE - 37+00

**FORT DADE AVENUE RESURFACING  
PLAN SHEET 3**

Drawing File Name: FORTDADE  
Drawn By: SEN  
Scale: 40  
Sheet No. 6 of 10

CEC No. 22-111670

HERNANDO COUNTY  
DEPARTMENT of PUBLIC WORKS  
ENGINEERING DIVISION  
1525 East Jefferson Street  
Brooksville, FL 34601-2807  
(352) 794-4062

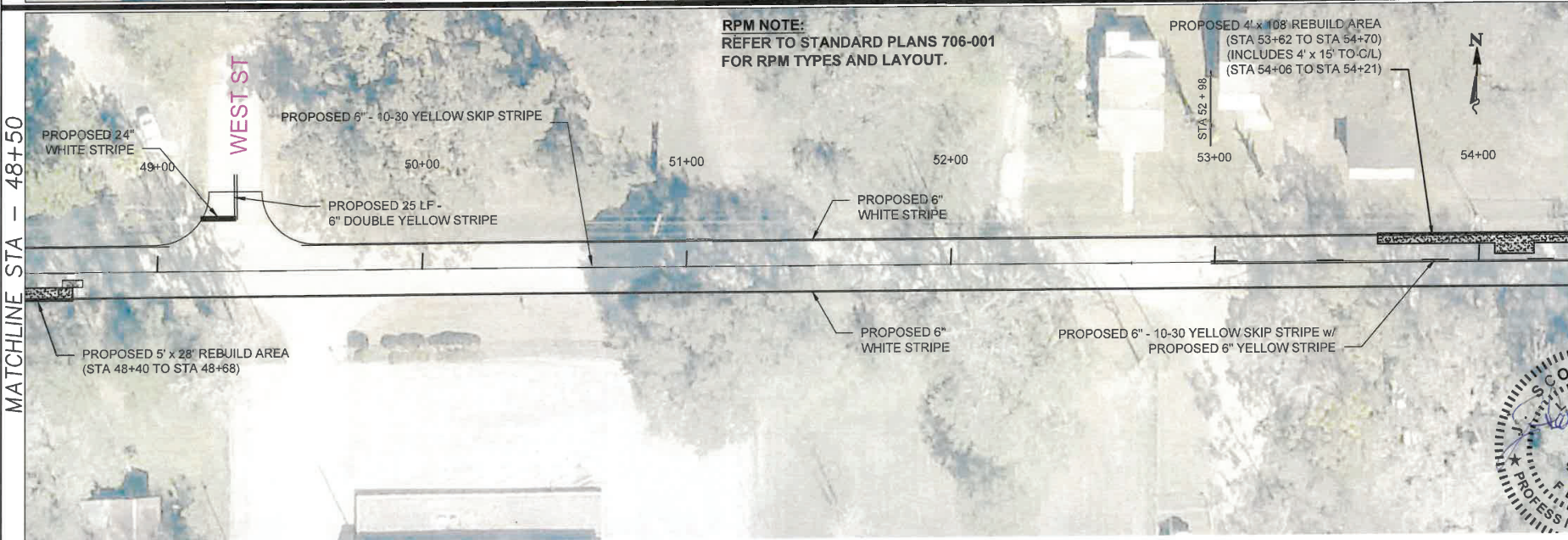
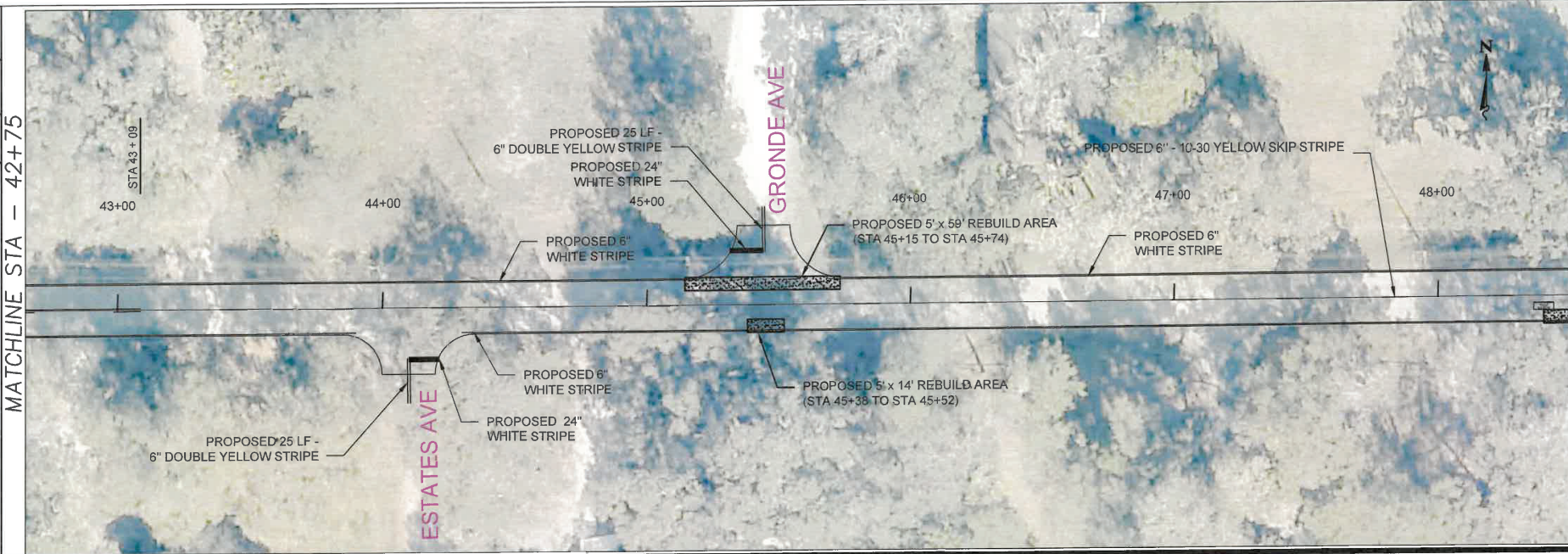

**RPM NOTE:**  
 REFER TO STANDARD PLANS 706-001  
 FOR RPM TYPES AND LAYOUT.

MATCHLINE STA - 48+50

MATCHLINE - 54+25

**FORT DADE AVENUE RESURFACING**  
**PLAN SHEET 4**

Drawing File Name: FORTDADE  
 Drawn By: SEN  
 Scale: 40  
 Sheet No. 7 of 10

GEO No. 22-111670  
 HERNANDO COUNTY  
 DEPARTMENT of PUBLIC WORKS  
 ENGINEERING DIVISION  
 1525 East Jefferson Street  
 Brooksville, FL 34601-2807  
 (352) 764-4062



1 full bleed B (11.000 x 17.000 inches), 1:1

MATCHLINE STA - 54+25

MATCHLINE STA - 60+00

MATCHLINE - 60+00

MATCHLINE - 65+75

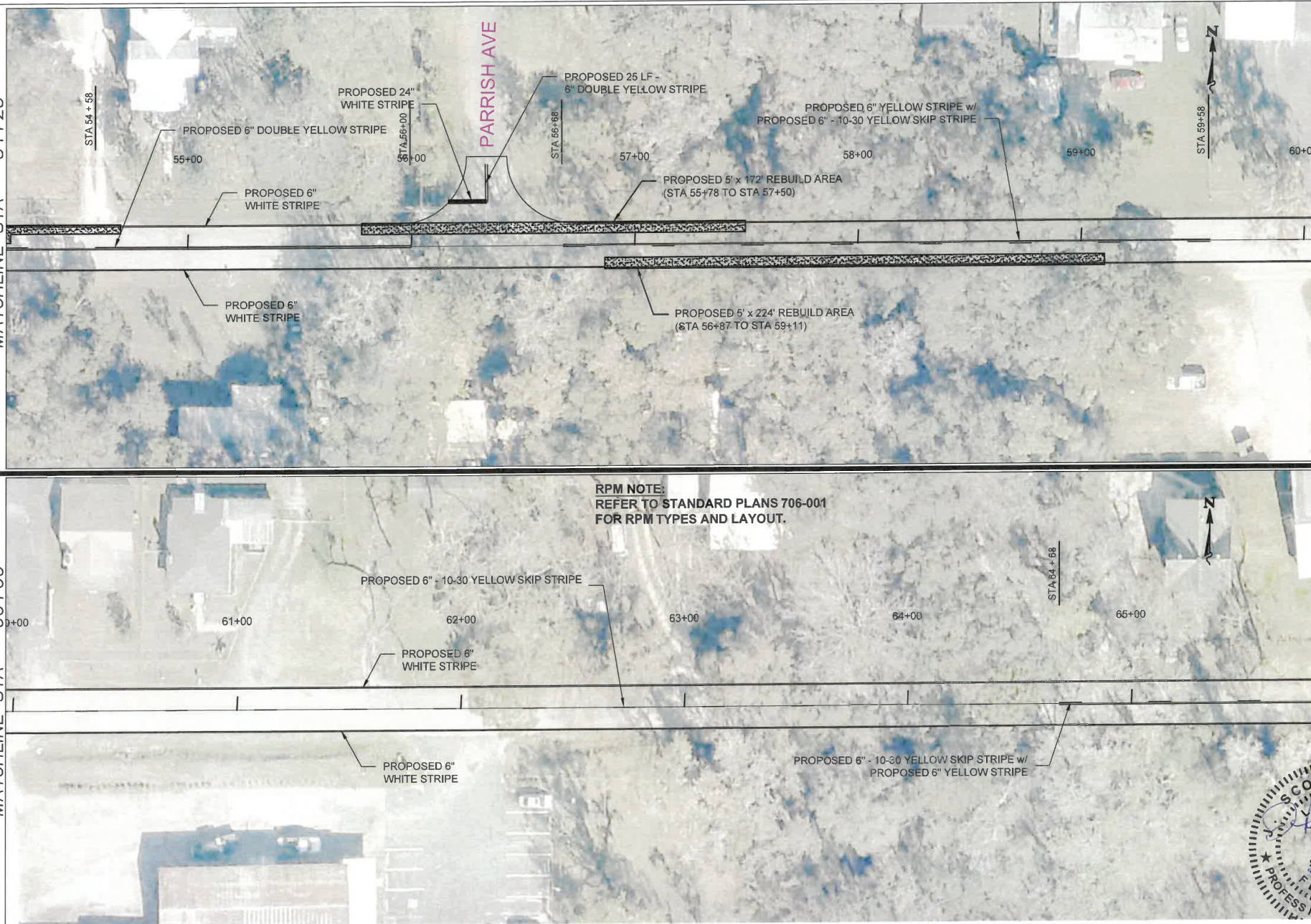

RPM NOTE:  
REFER TO STANDARD PLANS 706-001  
FOR RPM TYPES AND LAYOUT.

FORT DADE AVENUE RESURFACING  
PLAN SHEET 5

HERNANDO COUNTY  
DEPARTMENT of PUBLIC WORKS  
ENGINEERING DIVISION  
1525 East Jefferson Street  
Brooksville, FL 34601-2807  
(352) 754-4062





MATCHLINE STA - 65+75

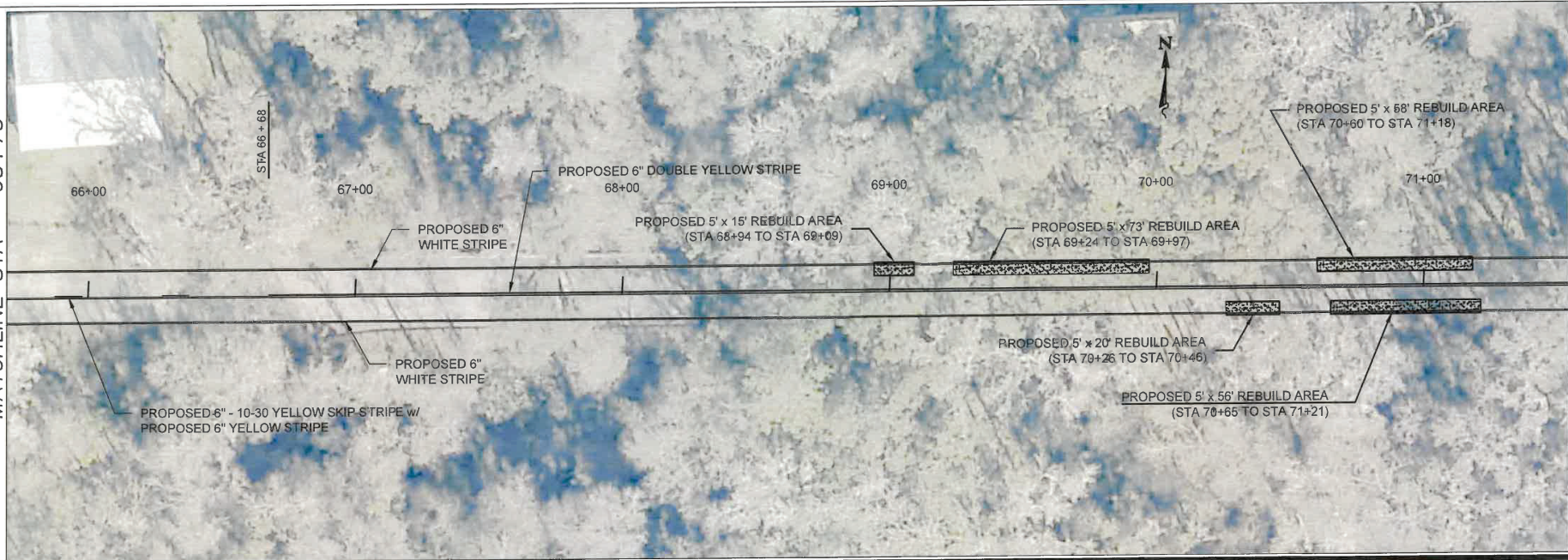

MATCHLINE STA - 71+50

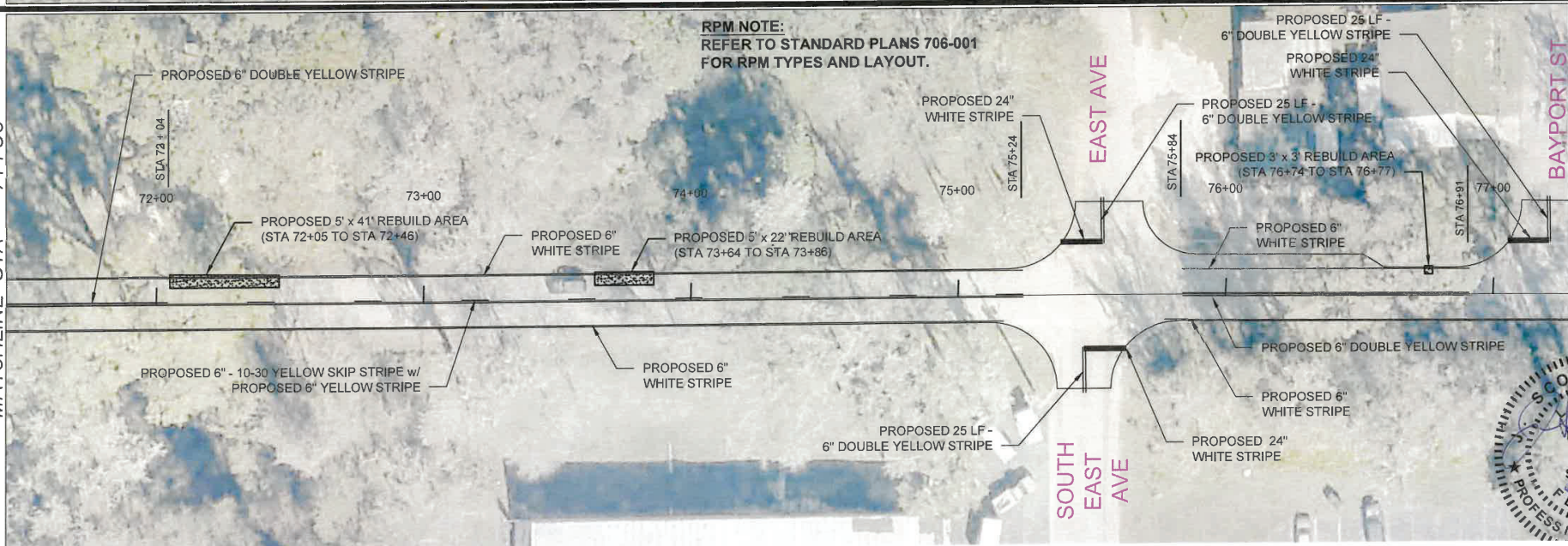

**RPM NOTE:  
REFER TO STANDARD PLANS 706-001  
FOR RPM TYPES AND LAYOUT.**

MATCHLINE - 71+50

**FORT DADE AVENUE RESURFACING  
PLAN SHEET 6**

Sheet No. 9 of 10

Scale: 40

Drawn By: SEN

Drawing File Name: Fort Dade

CEO No. 22-111670

HERNANDO COUNTY  
DEPARTMENT OF PUBLIC WORKS  
ENGINEERING DIVISION  
1525 East Jefferson Street  
Brooksville, FL 34601-2807  
(352) 754-4062

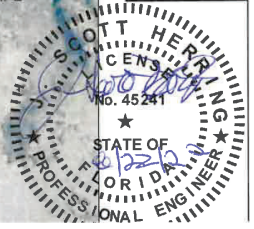

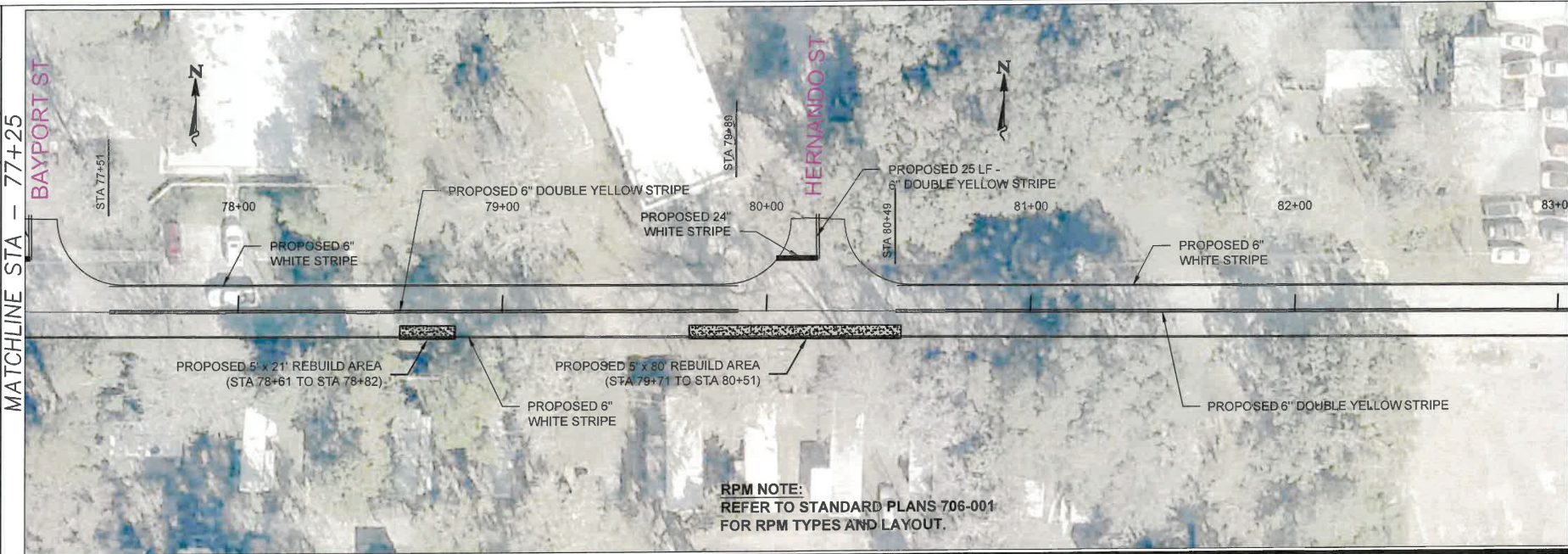

**RPM NOTE:**  
REFER TO STANDARD PLANS 706-001  
FOR RPM TYPES AND LAYOUT.

MATCHLINE STA - 83+00

**FORT DADE AVENUE RESURFACING  
PLAN SHEET 7**

HERNANDO COUNTY  
DEPARTMENT OF PUBLIC WORKS  
ENGINEERING DIVISION  
1525 East Jefferson Street  
Brooksville, FL 34601-2807  
(352) 754-4062

HERNANDO COUNTY  
FLORIDA  
**SCOTT HERRING**  
LICENSED PROFESSIONAL ENGINEER  
No. 48241

Drawing File Name: FortDade  
Drawn By: SEN  
Scale: 40  
Sheet No. 10 of 10