

# H-26-07

This map was prepared by this office to be used as aid and land parcel location and identification only. All land locations, right-of-ways widths, acreages, and utility locations are subject to field survey or other appropriate verification.





# Hernando County Comprehensive Plan Map

Existing Future Land Use: H-26-07

Version Date: 5/5/2026

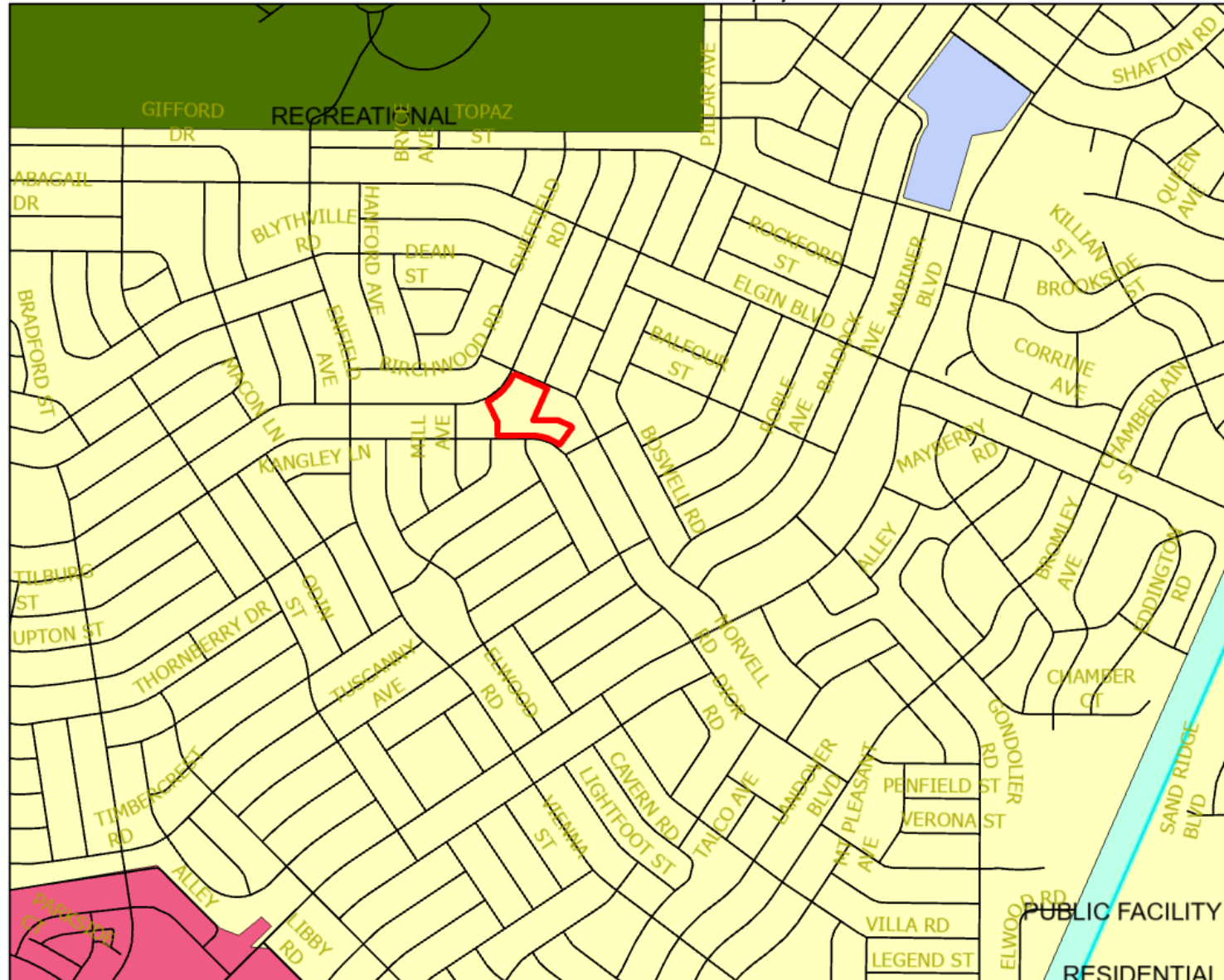

**Legend**

**FLU**

- Commercial
- Educational
- Public Facility
- Recreational
- Residential
- GIS.AllCountyRoads



**Future Land Use Map**

PLEASE REFER TO THE TEXT PORTION OF THE COMPREHENSIVE PLAN IN CONJUNCTION WITH THE USE OF THE FUTURE LAND USE MAP SERIES.

NOTE: THE RIVERINE DISTRICT IS SHOWN AS A LINE SETBACK PARALLEL TO THE WEEKI WACHEE, MUD AND WITHLACOOCHEE RIVERS.



Not to scale.

# H-26-07 Area Map

This map was prepared by this office to be used as aid and land parcel location and identification only. All land locations, right-of-ways widths, acreages, and utility locations are subject to field survey or other appropriate verification.

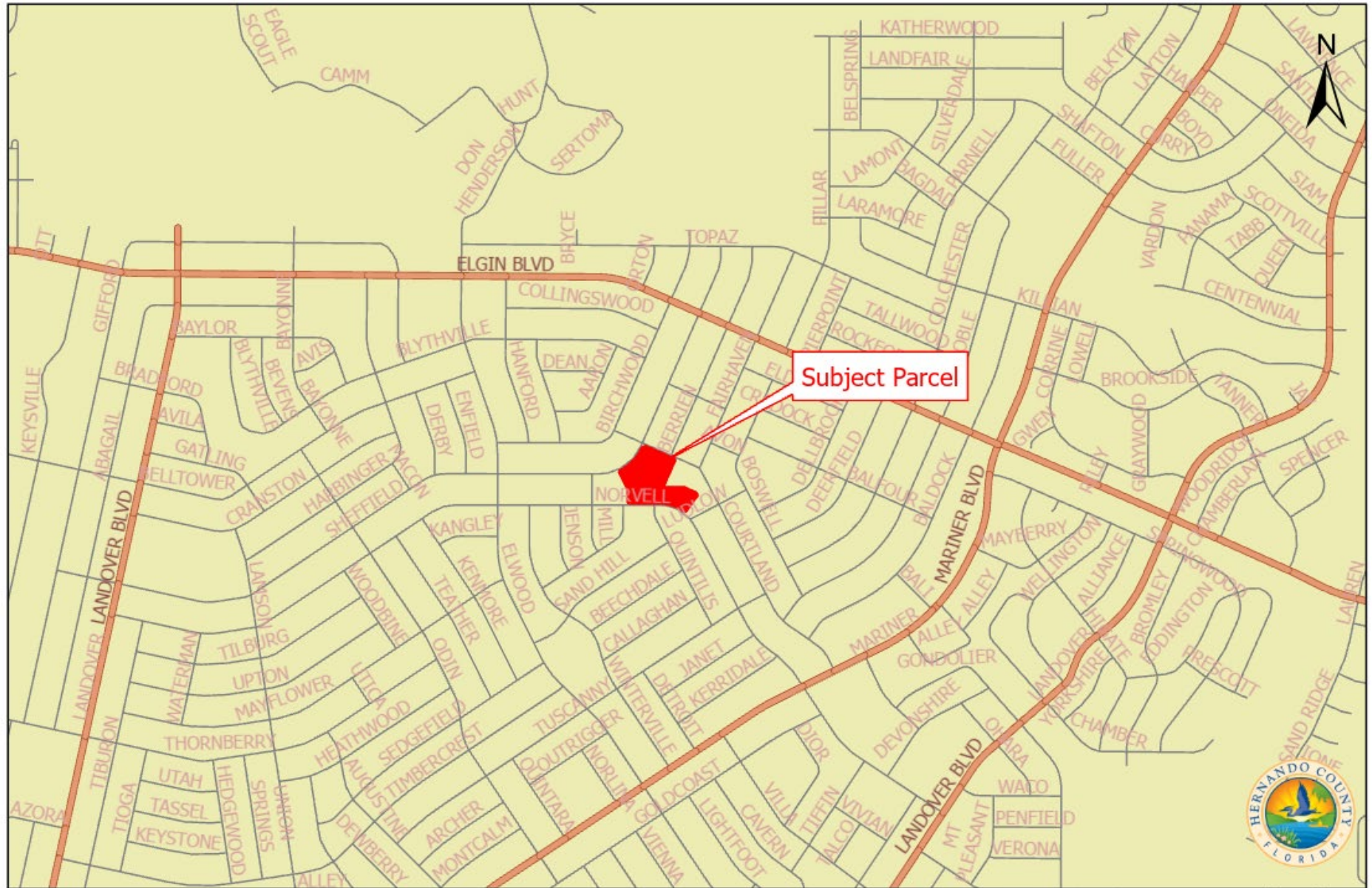

Not to scale



# H-26-07

This map was prepared by this office to be used as aid and land parcel location and identification only. All land locations, right-of-ways widths, acreages, and utility locations are subject to field survey or other appropriate verification.

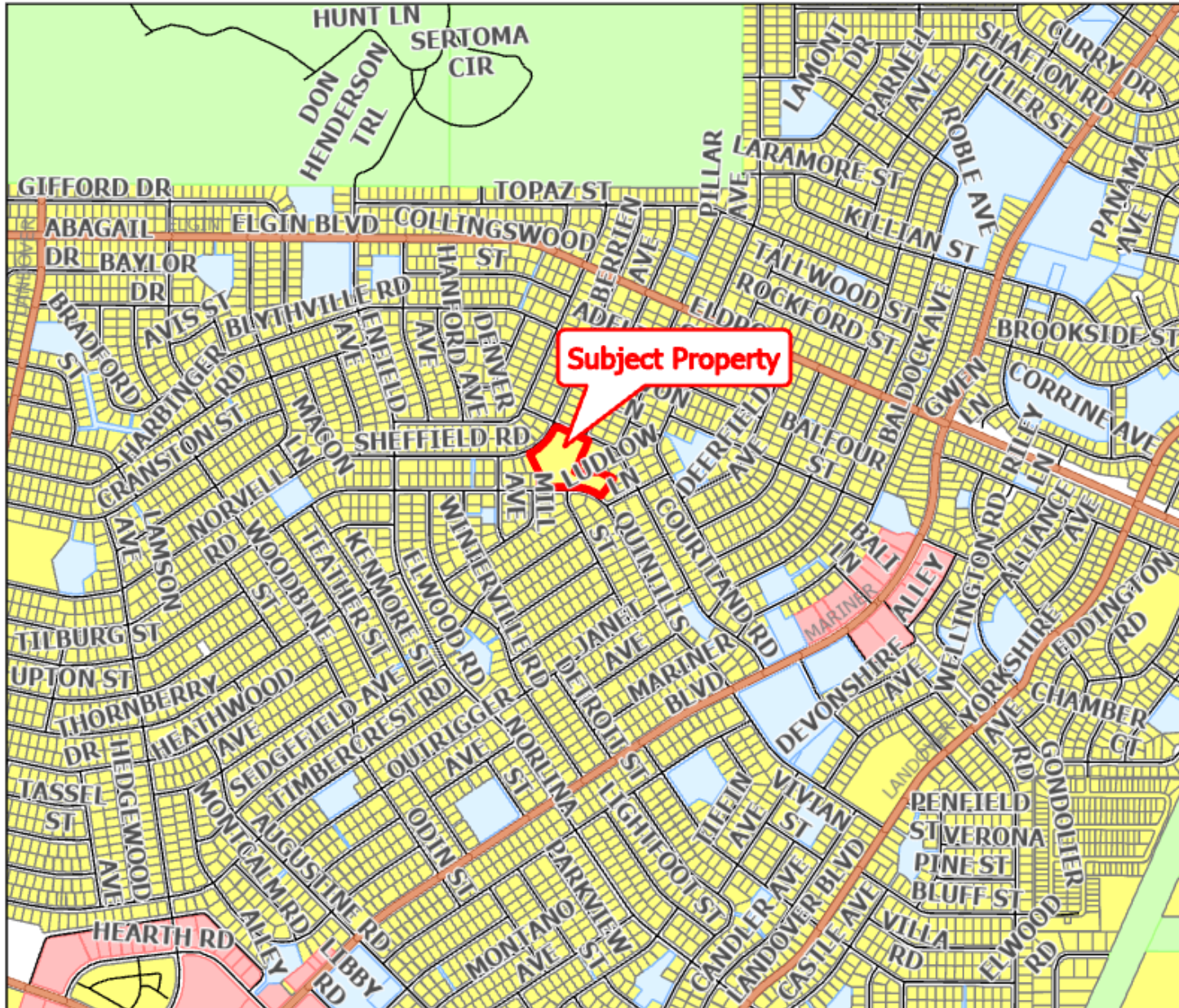

### Legend

Zoning

- Agricultural
- Commercial
- Residential
- Special Use

