



HERNANDO COUNTY PARKS AND RECREATION

DELTA WOODS TENNIS COURT LIGHTS





WHITING INSURANCE
COMMERCIAL LIFE
52) 686-2891

SpringLife
CHURCH
WAS
LIFE
CHURCH

(352) 233-4152
PRO-CRAFT BUILDERS
www.procraftbuilders.com

Florida Temples Realty, Inc.
Real Estate
www.floridatemplesrealty.com



ADAM

KILMORRICH
ESTATE AGENTS
1000
1000

WHITTEL
& MELTON

BRIDAG
www.bridaglaw.com

IT Pays
To Call!

IT Pays
To Call!

WHITING
52

DELTA WOODS PLAYGROUND REPLACEMENT







2247

- | | |
|----------------------------------|---------------------------------|
| <input type="checkbox"/> BLUE | <input type="checkbox"/> ORANGE |
| <input type="checkbox"/> GRANITE | <input type="checkbox"/> PURPLE |
| <input type="checkbox"/> GREEN | <input type="checkbox"/> RED |
| <input type="checkbox"/> LIME | <input type="checkbox"/> TAN |
| <input type="checkbox"/> OLIVE | <input type="checkbox"/> YELLOW |
- SMART YOU CLIMBER**
LIME



A AMERICAN
[813] 740-1911
a-american.com



HERNANDO PARK TENNIS COURT RE-SURFACE





HERNANDO PARK PICKLE BALL





CUSTOM
351-15-0108
COMMERCIAL
351-445-1870



VETERAN'S PARK UPGRADES/REPAIRS









ETS
FOR
CE
ALS

NO BIKES,
NO SKATEBOARDS
OR SKATES OF ANY
KIND ON
WALKING TRAIL





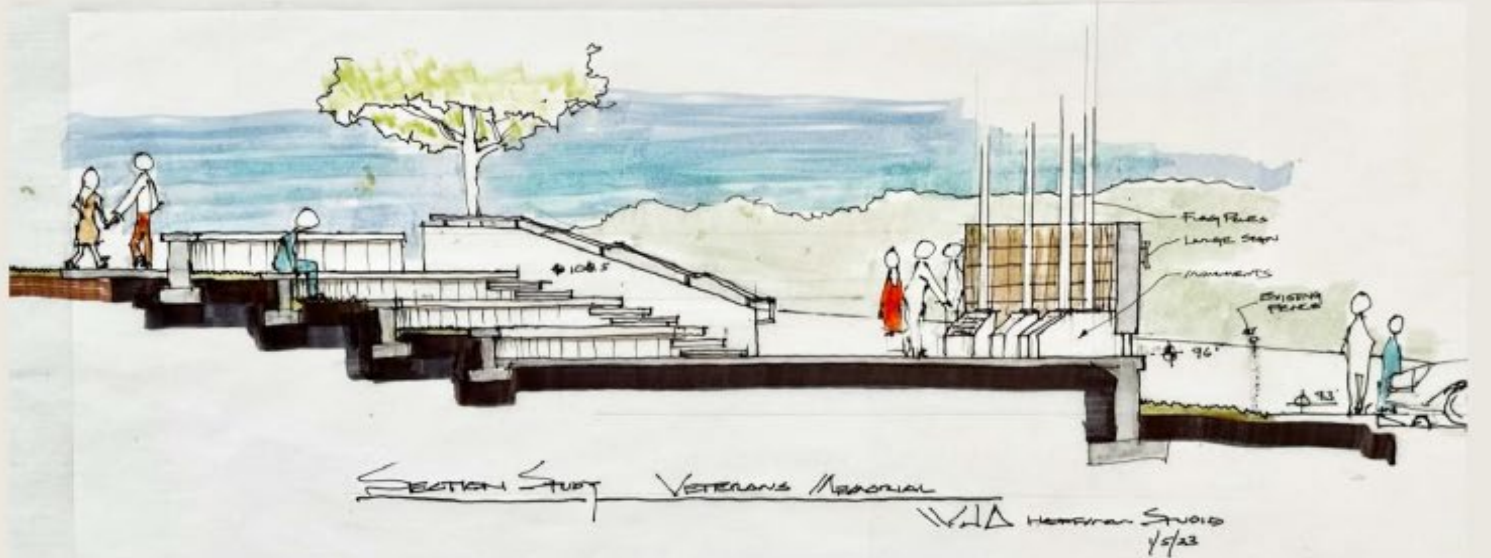
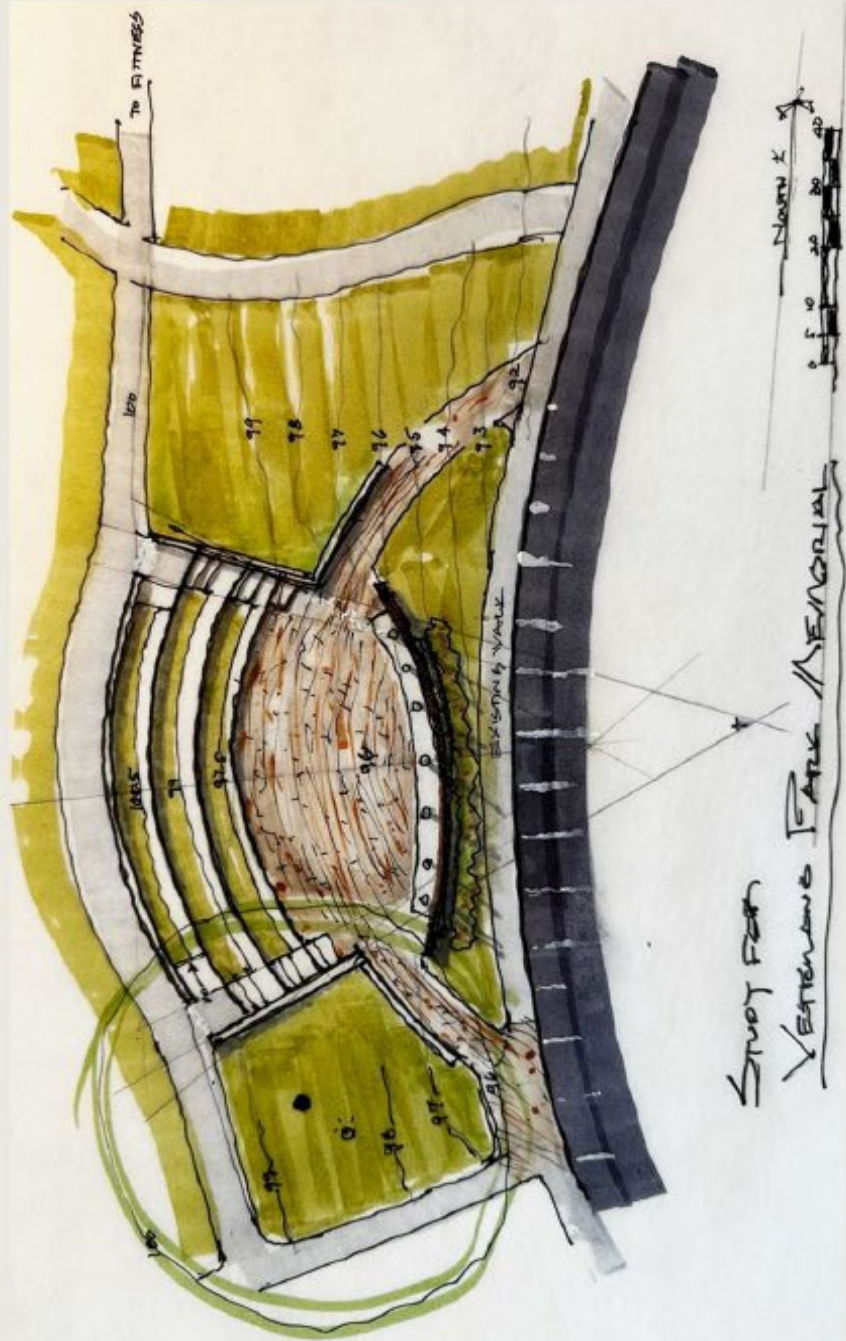



HERWANDO COUNTY VETERANS PARK

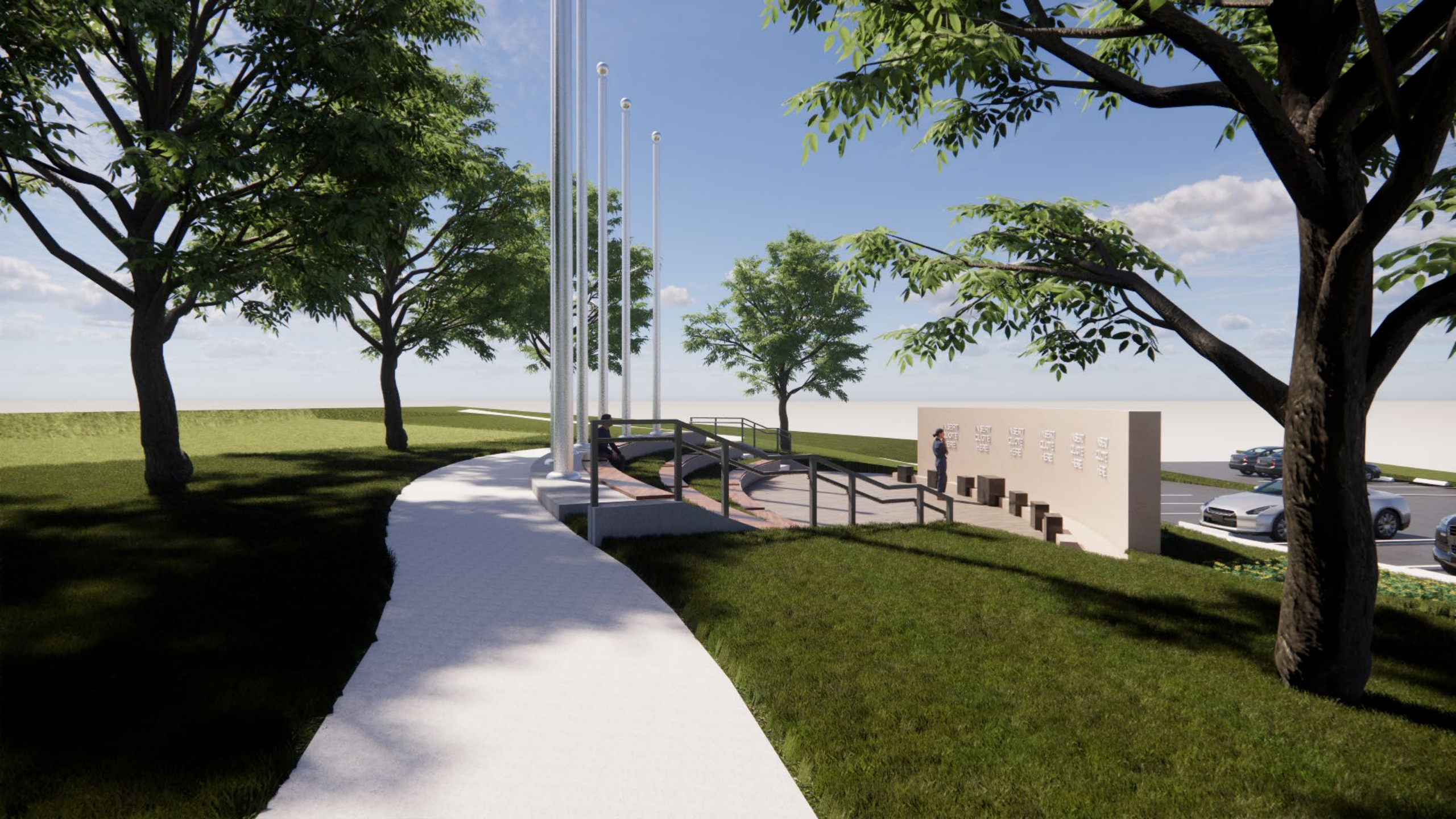

NEST NOTE HERE
巢穴在此

NEST NOTE HERE
巢穴在此

NEST NOTE HERE
巢穴在此

NEST NOTE HERE
巢穴在此

NEST NOTE HERE
巢穴在此

NEST NOTE HERE
巢穴在此

NEST NOTE HERE
巢穴在此

LINDA PEDERSEN ADA FISHING PIER







JENKIN'S CREEK FISHING PIER REPLACEMENT

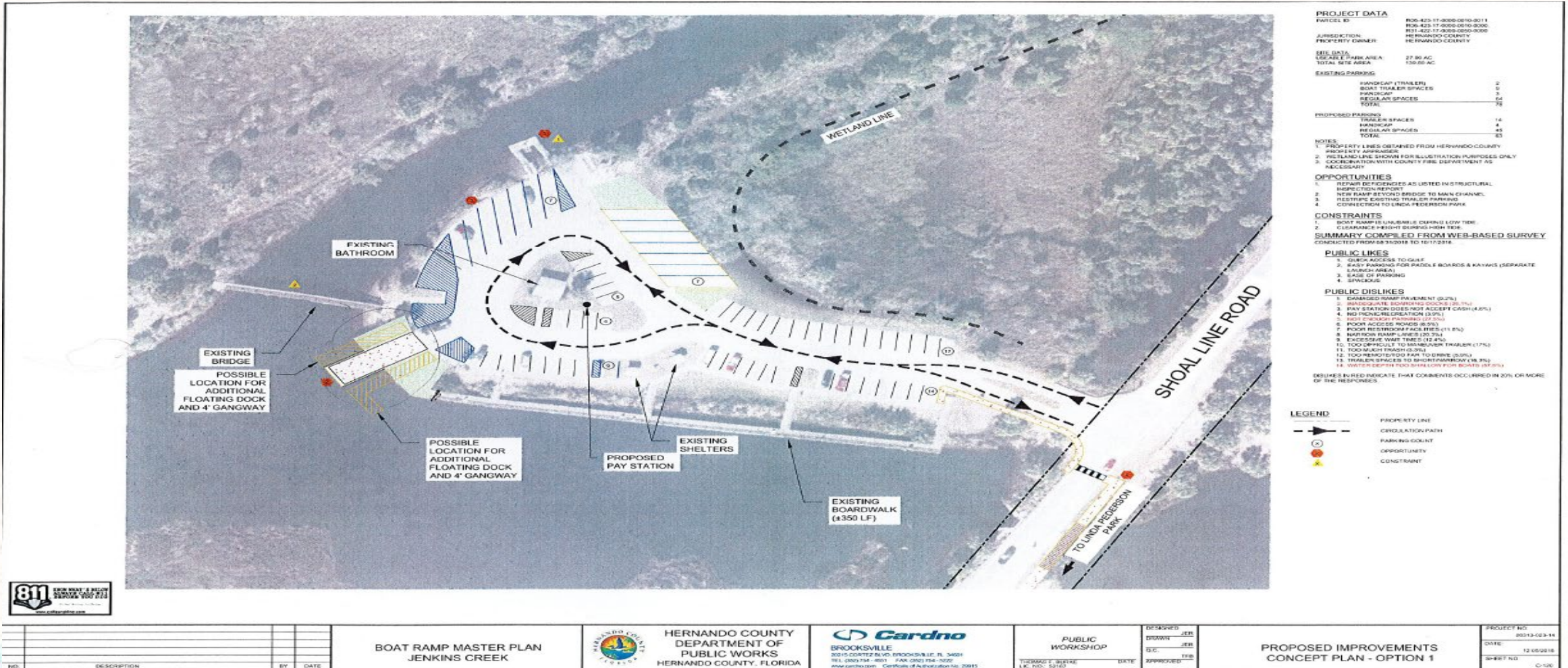

PROJECT DATA

PARTICLE # R06-425-17-0000-0010-0011
R06-425-17-0000-0010-0000
R11-425-17-0000-0000-0000

JURISDICTION HERNANDO COUNTY
PROPERTY OWNER HERNANDO COUNTY

SITE DATA
USABLE PARK AREA 27.90 AC.
TOTAL SITE AREA 130.66 AC.

EXISTING PARKING

HANDICAP (TRAILER)	2
BOAT TRAILER SPACES	0
HANDICAP	3
REGULAR SPACES	64
TOTAL	72

PROPOSED PARKING

TRAILER SPACES	14
HANDICAP	4
REGULAR SPACES	45
TOTAL	63

NOTES

- PROPERTY LINES OBTAINED FROM HERNANDO COUNTY PROPERTY ASSASSES
- WETLAND LINE SHOWN FOR ILLUSTRATION PURPOSES ONLY
- COORDINATION WITH COUNTY FIRE DEPARTMENT AS NECESSARY

OPPORTUNITIES

- REPAIR EXISTENCES AS LISTED IN STRUCTURAL INSPECTION REPORT
- NEW RAMP BEYOND BRIDGE TO MAIN CHANNEL
- RESTRICT EXISTING TRAILER PARKING
- CONNECTION TO LINDA PEDERSON PARK

CONSTRAINTS

- BOAT RAMP IS UNUSABLE DURING LOW TIDE
- CLEARANCE HEIGHT BARRIERS HIGH TIDE

SUMMARY COMPILED FROM WEB-BASED SURVEY CONDUCTED FROM 08/30/2018 TO 10/17/2018.

PUBLIC LIKES

- QUICK ACCESS TO GULF
- EASY PARKING FOR PADDLE BOARDS & KAYAKS (SEPARATE LAUNCH AREA)
- EASE OF PARKING
- SNACKS

PUBLIC DISLIKES

- DAMAGED RAMP PAVEMENT (0.2%)
- INAPPROPRIATE SIGNAGE (0.2%)
- PAY STATION DOES NOT ACCEPT CASH (4.5%)
- NO PUBLIC RESTROOM (0.5%)
- NO PUBLIC RESTROOM (0.5%)
- POOR ACCESS ROADS (0.5%)
- POOR RESTROOM FACILITIES (11.8%)
- HAZARDOUS RAMP LINES (0.2%)
- EXCESSIVE WAIT TIME (12.4%)
- TOO DIFFICULT TO MANEUVER TRAILER (1.7%)
- TOO MUCH TRASH (0.3%)
- TOO NERVOUS FOR TO DRIVE (0.5%)
- TRAILER SPACES TO SHORT PARKING (6.8%)
- WATER DEPTH TOO SHALLOW FOR BOATS (0.2%)

DELINES IN RED INDICATE THAT COMMENTS OCCURRED IN 20% OR MORE OF THE RESPONSES.



NO.	DESCRIPTION	BY	DATE

BOAT RAMP MASTER PLAN
JENKINS CREEK



HERNANDO COUNTY
DEPARTMENT OF
PUBLIC WORKS
HERNANDO COUNTY, FLORIDA

Cardno
BROOKSVILLE
3015 COURTZ BLVD. BROOKSVILLE, FL 34601
TEL: 352.744.8801 FAX: 352.744.5622
www.cardno.com Certificate of Authorization No. 25915

PUBLIC
WORKSHOP

DESIGNED	JER
DRAWN	JER
CHECKED	TMB
APPROVED	

PROPOSED IMPROVEMENTS
CONCEPT PLAN - OPTION 1

PROJECT NO.	00113-003-14
DATE	12.05.2018
SHEET NO.	C-106

WATERWAYS INSTALLED NEW DOCKS





IDLE SPEED
NO WAKE

ROCK
DANGER
AREA

352-410-59
www.BlueMan.com

PIONEER PARK RESTROOM REPLACEMENT







LAKE HOUSE STAGE DEMOLITION



