

Received
SEP 22 2023

Planning Department
Hernando County Florida



LEGAL DESC.
6.24 AC TRACT WITHIN FOREST OAKS SAID TRACT BEING RECORDED IN O.R. BOOK 1871 PAGE 1355 OF THE PUBLIC RECORDS OF HERNANDO COUNTY, FL

FOREST OAKS
LUTHERAN CHURCH
ZONING: PDP(SU) CHURCH
LAND USE: RESIDENTIAL

ZONING: PDP(SU) DRA
LAND USE: RESIDENTIAL

STAGE WEST THEATER
ZONING: PDP(SU) COMMUNITY USE
LAND USE: RESIDENTIAL

ADJACENT ZONING: PDP(PF)
LAND USE: RESIDENTIAL

POST OFFICE
ZONING: SFL ZONING (AG/PDP(OP))
LAND USE: RESIDENTIAL

BUILDING INFORMATION CHART
ZONING: PDP (OP)/LAND USE: RESIDENTIAL

BUILDING #	SF OF BUILDING	DIMENSION/ AMOUNT OF UNITS
BUILDING A CLIMATE CONTROLLED	1596 SQ FT	8 UNITS (20' X 10')
BUILDING B CLIMATE CONTROLLED	11425 SQ FT	88 UNITS (10' X 10')
BUILDING C CLIMATE CONTROLLED	12481 SQ FT	96 UNITS (10' X 10')
BUILDING D	5243 SQ FT	26 UNITS (20' X 10')
BUILDING E	10443 SQ FT	52 UNITS (20' X 10')
BUILDING F	10443 SQ FT	52 UNITS (20' X 10')
BUILDING G	7898 SQ FT	40 UNITS (20' X 10')
BUILDING H	3750 SQ FT	25 UNITS (15' X 10')
BUILDING I (COVERED STORAGE)	7750 SQ FT	12 UNITS (43' X 15')
TOTALS:	71009 SQ FT	TOTAL 389 UNITS

IN ADDITION, SPACE HAS BEEN PROVIDED IN THE AMOUNT OF 15,270 SF FOR OUTSIDE STORAGE AREAS WITHOUT ROOFS.

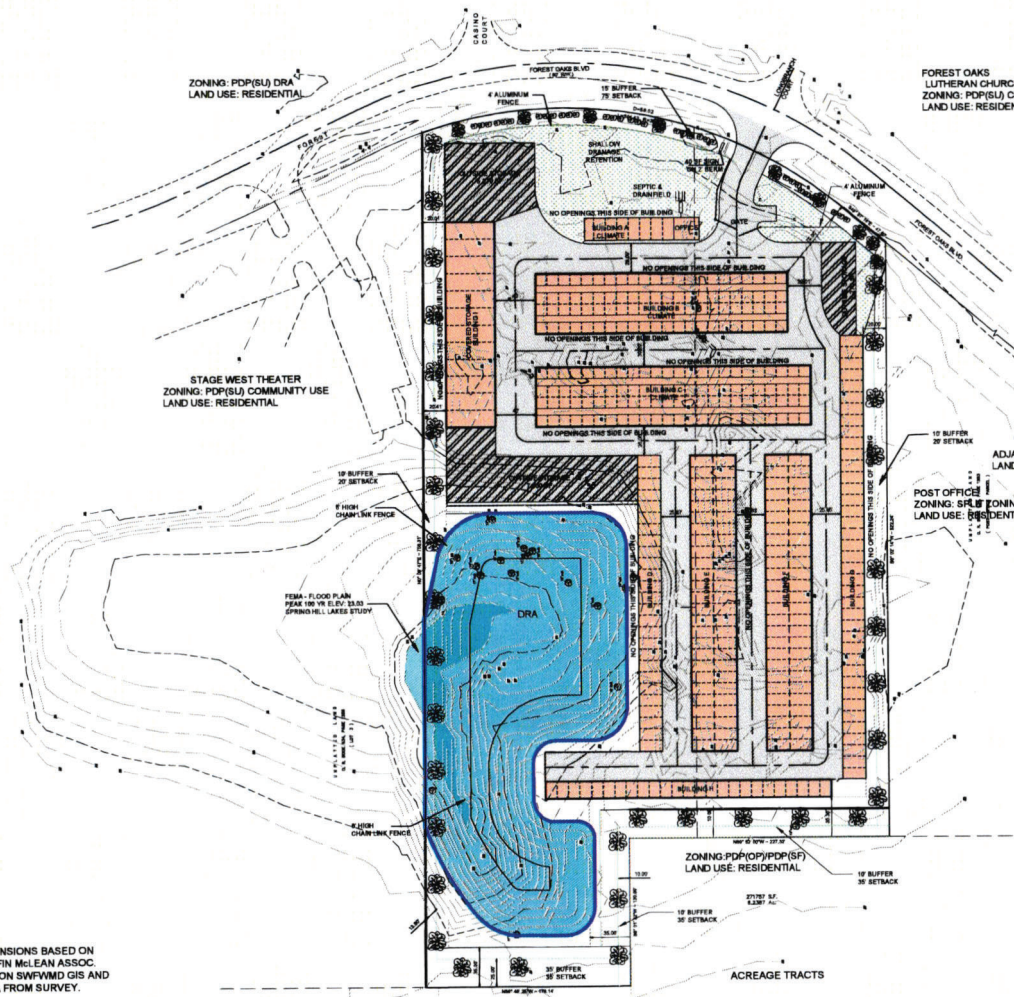

PROPERTY DIMENSIONS BASED ON SURVEY BY COFFIN McLEAN ASSOC. CONTOURS BASED ON SWFWMD GIS AND ON-SITE DATA FROM SURVEY.

- LEGEND
- CONCRETE WHEEL STOP
 - 9 OF PARKING SPACES
 - TYPE 10" IN LET
 - CONCRETE SURFACE
 - ASPHALT SURFACE

THERE ARE 3 RESIDENTIAL LOTS ABUTTING THE PROJECT ON THIS BOUNDARY. THE BUFFER IS MADE LARGER IN THIS AREA.

	<p style="text-align: center;">FOREST OAKS STORAGE KEY NO. 1027855 MASTER PLAN</p>
<p>PROCIVIL 360</p>	<p style="text-align: center;">CIVIL ENGINEERING/RESIDENTIAL & COMMERCIAL SITE DEVELOPMENT/PLANNING & ZONING / PERMITTING / CONSTRUCTION SERVICES</p> <p style="font-size: small; text-align: center;">BROOKSHVILLE, FL 33507 • PHONE: (862) 989-0265 12 SOUTH MAIN STREET</p>
<p style="font-size: x-small;">DIGITAL/ELECTRONIC SIGNATURE NOTE: I, JAMES H. MOORE, PE, REGISTERED PROFESSIONAL ENGINEER IN THE STATE OF FLORIDA, HEREBY CERTIFY THAT I AM THE DESIGNER OF THE PROJECT SHOWN ON THIS PLAN AND I HAVE REVIEWED THE PROJECT FOR THIS DOCUMENT AND I AM LICENSED IN THE STATE OF FLORIDA AS A PROFESSIONAL ENGINEER IN THE STATE OF FLORIDA.</p>	<p style="text-align: right;">JAMES H. MOORE PE, STATE DATE: _____ DRAWN AND APPROVED</p>
<p style="font-size: x-small;">PROJECT NO. _____ SCALE: 1"=50' DATE: _____ SHEET NO. _____</p>	<p style="text-align: right;">1 of 1</p>

Plot Date: Sep 21, 2023 - 7:27am User Name: aking Drawing Name: W:\PROCIVIL\2022\Projects\PRO22051 - Pastore-Forest Oaks\22051.cnc1.dwg