



Hernando County

Hernando County Tax Building 100% GMP Revision 1

02-05-2024

Prepared for:

Erik van De Boogaard
Hernando County Construction
Projects Coordinator
Brooksville, FL 34601

CPPI Contact:

Janet Cole
Chief Estimator
janet.cole@cpipi.com
(813) 344-9070

Page 1	Table of Contents
Page 2	Cover Letter
Page 3	Cost Comparison
Page 4	Summary
Page 8	Alternates
Page 9	Qualifications & Clarifications
Page 13	Site Logistics Plan
Page 14	Schedule - Pending
Page 17	Bid Tabs
Page 51	Document List





construction management | design build | general contracting

February 05, 2024

Erik van de Boogaard
Hernando County Construction Projects Coordinator
Brooksville, FL 34601

RE: Hernando County Tax Collector Building
100% Estimate

Mr. Erik van de Boogaard

CPPI is pleased to present you with the 100% GMP estimate for the Hernando County Tax Collector Building. This GMP estimate is based on the 100% Permit drawings provided by Straughn Trout Architects, dated December 20, 2023 and on the Landscape and Irrigation plans dated January 22, 2024 in response to RFIs 55 and 56.

Our GMP Estimate for this work is:

Thirteen Million Five Hundred Ninety-Seven Thousand Four Hundred Seventy-Six Dollars

If you have any questions or concerns, please don't hesitate to contact me at 813-344-9070 or janet.cole@cpai.com.

Sincerely,
Charles Perry Partners, Inc.

Janet Cole

Janet Cole
Chief Estimator

Hernando County Tax Collector Florida GMP Revision 1 Comparison - 02-05-2024

Description	Owner Budget	02/24/2023 Schematic ESTw/site allowance	08/02/2023 Design Dev. Budget	02/05/2024 GMP	Notes	Comparison SD 4/28 and DD 8/02 Budgets
03A - Concrete		\$820,699	\$886,218	\$840,570	includes porosity inhibiting admixture	(\$45,648)
04A - Masonry / Exterior Brick		\$6,960	\$6,960	\$21,890	masonry/brick on exterior signage	\$14,930
05A - Structural Steel/Metals		\$529,181	\$442,200	\$455,500	added steel	\$13,300
06D - Door and Hardware Installation		\$8,840	\$6,340	\$10,831		\$4,491
07A - Caulking and Waterproofing		\$25,747	\$83,150	\$66,000	As specified	(\$17,150)
07B - Roofing		\$614,371	\$501,000	\$336,800	Soprema PVC	(\$164,200)
08A - Frames, Doors & Hardware		\$69,250	\$66,400	\$69,455		\$3,055
08B - Windows & Glazing/Sliding Doors/Security Doors		\$291,285	\$473,304	\$369,762	impact rated glazing, Stanley Sliding Doors	(\$103,542)
08C - Overhead Door		\$0	\$0	\$15,746	OH door at tag storage	\$15,746
09A - Framing, Drywall, Insulation		\$323,479	\$421,757	\$416,105		(\$5,652)
09B - Stucco		\$6,180	\$17,870	\$11,273	Stucco at exterior monument signs, clerestory, and break patio	(\$6,597)
09C - Acoustical Ceilings and Wall Panels		\$91,250	\$103,410	\$159,380	specialty black tile spec, floating ceilings	\$55,970
09D - Painting		\$81,267	\$44,815	\$96,180	polish finish on canopy columns	\$51,365
09E - Flooring and Tiling/Walk off mat		\$369,448	\$179,459	\$217,754	includes (3) ext. walk off mats/int stone veneer	\$38,295
10A- Toilet Accessories / Partitions		\$40,866	\$59,322	\$48,315	includes SS door kick plates	(\$11,007)
10AA - Flagpoles		\$0	\$0	\$38,274	3 flagpoles	\$38,274
10B - Signage		\$30,670	\$48,879	\$79,528	7 exterior monument signs	\$30,649
10E - Canopies/Columns, sunshades		\$295,495	\$991,400	\$573,260	2 coat Kynar ilo anodized for 10 yr. warranty	(\$418,140)
11B - Appliances		\$6,000	\$9,400	\$11,500	refrigerator/ice machine	\$2,100
11G - Projection Screens		\$12,000	\$12,000	\$0	replaced by LCD TV - in electrical/low voltage scope	(\$12,000)
12A - Casework		\$245,160	\$245,720	\$238,303	includes moss wall	(\$7,417)
12C - Window Treatments		\$16,740	\$58,397	\$48,054	motorized and manual	(\$10,343)
12D - Interior Furnishings Allowance		\$305,000	\$305,000	\$435,990	Furnishing allowance per StraughnTrout Architects	\$130,990
12E - Exterior Furnishings		\$0	\$0	\$89,130	Exterior furnishings included	\$89,130
21A - Fire Suppression System		\$63,965	\$85,000	\$78,200		(\$6,800)
22A - Plumbing		\$342,506	\$349,500	\$539,575		\$190,075
23A - HVAC		\$1,181,191	\$593,265	\$699,310	Trane controls	\$106,045
26A - Electrical, Fire Alarm and Low Voltage Systems		\$1,398,953	\$1,089,179	\$1,476,870	incl.all low voltage per matrix	\$387,691
31A-31AAA - Earthwork and Paving		\$2,339,931	\$2,926,485	\$2,351,994	recycled asphalt	(\$574,491)
31A - Site Utilities Drainage		\$506,367	\$755,594	\$564,143	includes HP ilo RCP piping	(\$191,451)
31C - Site Utilities - Sanitary		\$105,152	\$112,079	\$128,613		\$16,534
31D - Site Utilities - Water/Fire Service		\$131,816	\$168,421	\$203,147		\$34,726
32B - Fencing and Gates		\$11,645	\$43,063	\$71,183	Barrier arm/access	\$28,120
32C - Pavers		\$0	\$43,275	\$39,706	Specialty pavers at test drive parking, Front Entry, Seating	(\$3,569)
32D - Landscape and Irrigation		\$222,721	\$312,721	\$207,383		(\$105,338)
99C - Survey, AS-Builts, Rough/Final Clean		\$41,719	\$62,470	\$62,620		\$150
99C - Storage, Opening protection, temp pole, forklift, dumpser, start up		\$0	\$0	\$56,561		\$56,561
99C - Material Testing allowance		\$0	\$0	\$30,000		\$30,000
SUBTOTAL DIRECT COSTS		\$10,535,854	\$11,504,053	\$11,158,905		(\$345,148)
General Requirements		\$70,544	\$70,544	\$179,324		\$108,780
General Conditions		\$616,912	\$616,912	\$845,232		\$228,320
Permit Fee Allowance		\$0	\$0	\$45,000		\$45,000
Design Contingency		\$231,335	\$130,029	\$0		(\$130,029)
Construction Contingency		\$561,165	\$631,446	\$334,767	3%	(\$296,679)
Subcontractor default insurance		\$143,770	\$152,640	\$148,631		(\$4,009)
Contract Bond		\$82,028	\$90,442	\$85,522		(\$4,920)
General Liability		\$68,305	\$76,055	\$71,523		(\$4,532)
Builder's Risk		\$49,346	\$54,945	\$38,472	Quote	(\$16,473)
CM Fee		\$549,421	\$617,642	\$613,100		(\$4,542)
Precon Fee		\$77,000	\$77,000	\$77,000		\$0
TOTAL CONSTRUCTION COSTS	\$11,700,000	\$12,985,680	\$14,021,708	\$13,597,476		(\$424,232)

pckge	Description	Takeoff Quantity	Sub Cost/Unit	Sub Amount	Total Amount
	PROGRAM AREA:				
03A	STRUCTURAL CONCRETE & STAIR CONCRETE				
	concrete/tilt panel/form liner/thin brick	1.00 ls	813,005.00 /ls	813,005	813,005
	porosity inhibiting concrete admixture add	1.00 ls	27,565.00 /ls	27,565	27,565
	03A STRUCTURAL CONCRETE & STAIR CONCRETE		/SF	840,570	840,570
04A	MASONRY				
	CMU at exterior signage	1.00 ls	10,100.00 /ls	10,100	10,100
	Exterior Brick at exterior prime ID sign	1.00 ls	11,790.00 /ls	11,790	11,790
	04A MASONRY		/SF	21,890	21,890
05A	STRUCTURAL & MISCELLANEOUS STEEL				
	Structural Steel	1.00 ls	455,500.00 /ls	455,500	455,500
	05A STRUCTURAL & MISCELLANEOUS STEEL		/SF	455,500	455,500
06D	DOOR AND HARDWARE INSTALLATION				
	Install Doors and Hardware	1.00 LS	10,831.00 /LS	10,831	10,831
	06D DOOR AND HARDWARE INSTALLATION		/sf	10,831	10,831
07A	CAULKING & WATERPROOFING				
	caulking and waterproofing (including Vandex)	1.00 ls	66,000.00 /ls	66,000	66,000
	07A CAULKING & WATERPROOFING		/SF	66,000	66,000
07B	ROOFING				
	Roof system - Soprema PVC	1.00 LS	336,800.00 /LS	336,800	336,800
	07B ROOFING		/SF	336,800	336,800
08A	FRAMES, DOORS & HARDWARE				
	Doors, Frames, Hardware (Furnish)	1.00 ls	69,455.00 /ls	69,455	69,455
	08A FRAMES, DOORS & HARDWARE		/SF	69,455	69,455
08B	WINDOWS & GLAZING				
	Exterior Glass and Glazing	1.00 LS	325,998.00 /LS	325,998	325,998
	Automatic Sliding Doors - 3 each - Stanley	1.00 LS	42,612.00 /LS	42,612	42,612
	vinyl privacy film - on int. sliding doors	1.00 LS	1,152.00 /LS	1,152	1,152
	08B WINDOWS & GLAZING		/SF	369,762	369,762
08C	OVERHEAD COILING DOORS				
	Overhead Door at Tag Storage - interior	1.00 ls	15,746.00 /ls	15,746	15,746
	08C OVERHEAD COILING DOORS	77,514.00 SF	0.20 /SF	15,746	15,746
09A	DRYWALL, FRAMING, INSULATION				
	drywall, framing, insulation, blocking	1.00 ls	416,105.00 /ls	416,105	416,105
	09A DRYWALL, FRAMING, INSULATION		/SF	416,105	416,105
09B	STUCCO				
	Stucco - clerestory	1.00 ls	3,860.00 /ls	3,860	3,860
	Stucco - signage	1.00 ls	2,565.00 /ls	2,565	2,565
	Stucco - break patio ceiling	1.00 ls	4,848.00 /ls	4,848	4,848
	09B STUCCO		/SF	11,273	11,273
09C	ACOUSTICAL CEILINGS				
	acoustical ceilings	1.00 ls	159,380.00 /ls	159,380	159,380
	09C ACOUSTICAL CEILINGS		/SF	159,380	159,380
09D	PAINTING				
	Painting	1.00 LS	49,980.00 /LS	49,980	49,980
	Polish on concrete columns	1.00 ls	46,200.00 /ls	46,200	46,200
	09D PAINTING		/SF	96,180	96,180
09E	FLOORING				
	Flooring/tile	1.00 ls	188,727.00 /ls	188,727	188,727
	walk off mats	1.00 ls	13,950.00 /ls	13,950	13,950
	Interior stone veneer	1.00 ls	15,077.00 /ls	15,077	15,077
	09E FLOORING		/SF	217,754	217,754
10A	TOILET ACCESSORIES				

pckge	Description	Takeoff Quantity	Sub Cost/Unit	Sub Amount	Total Amount
10A	TOILET ACCESSORIES				
	Specialties	1.00 LS	38,585.00 /LS	38,585	38,585
	Flag Poles - 3 each	1.00 ls	38,274.00 /ls	38,274	38,274
	add for SS door kick plates for wood doors	1.00 ls	9,730.00 /ls	9,730	9,730
	10A TOILET ACCESSORIES		/SF	86,589	86,589
10B	SIGNAGE				
	interior and exterior signage	1.00 ls	79,528.00 /ls	79,528	79,528
	10B SIGNAGE		/SF	79,528	79,528
10E	CANOPIES and SUNSHADES				
	Canopies/sunshades	1.00 ls	502,048.00 /ls	502,048	502,048
	add alternate for 2 coat kynar finish with 10 year warranty	1.00 ls	71,212.00 /ls	71,212	71,212
	10E CANOPIES and SUNSHADES		/sf	573,260	573,260
11B	APPLIANCES				
	Refrigerators Samsung RF28R7351	2.00 ls	3,500.00 /ls	7,000	7,000
	Ice Machine Manitowoc IRT0500A	1.00 ls	4,500.00 /ls	4,500	4,500
	11B APPLIANCES		/SF	11,500	11,500
12A	MILLWORK				
	millwork	1.00 ls	225,784.00 /ls	225,784	225,784
	Moss wall at back of reception	1.00 ls	12,519.00 /ls	12,519	12,519
	12A MILLWORK		/SF	238,303	238,303
12C	WINDOW TREATMENTS				
	Window Treatments	1.00 ls	48,054.00 /ls	48,054	48,054
	12C WINDOW TREATMENTS		/SF	48,054	48,054
12E	SITE FURNISHINGS				
	Site Furnishings, Bike Racks	1.00 ls	89,130.00 /ls	89,130	89,130
	Interior Furniture Allowance	1.00 allow	435,990.00 /allow	435,990	435,990
	12E SITE FURNISHINGS		/sf	525,120	525,120
21A	FIRE SUPRESSION SYSTEM				
	Fire sprinkler system	1.00 LS	78,200.00 /LS	78,200	78,200
	21A FIRE SUPRESSION SYSTEM		/SF	78,200	78,200
22A	PLUMBING				
	Plumbing	1.00 ls	539,575.00 /ls	539,575	539,575
	22A PLUMBING		/SF	539,575	539,575
23A	HVAC				
	Mechanical - Trane Equip and Controls	1.00 ls	699,310.00 /ls	699,310	699,310
	23A HVAC		/SF	699,310	699,310
26A	ELECTRICAL AND LOW VOLTAGE				
	Electrical and Low Voltage	1.00 ls	1,476,870.00 /ls	1,476,870	1,476,870
	26A ELECTRICAL AND LOW VOLTAGE		/SF	1,476,870	1,476,870
31A	EARTHWORK, PAVING & SITE UTILITIES				
	Mobilization, EC, traffic control, layout, as-builts, demo	1.00 ls	394,261.00 /ls	394,261	394,261
	Earthwork, grading on site/off site	1.00 ls	410,682.00 /ls	410,682	410,682
	Temp access roads (& removal), temp utilities, laydown	1.00 ls	168,798.00 /ls	168,798	168,798
	deduct alternate recycled asphalt ilo virgin at main prop.	(1.00) ls	73,839.00 /ls	(73,839)	(73,839)
	31A EARTHWORK, PAVING & SITE UTILITIES		/SF	899,902	899,902
31AA	PAVING				
	ON site asphalt paving, concrete	1.00 ls	1,139,828.00 /ls	1,139,828	1,139,828
	OFF site asphalt paving, concrete	1.00 ls	312,264.00 /ls	312,264	312,264
	31AA PAVING		/SF	1,452,092	1,452,092
31B	SITE UTILITIES - DRAINAGE				
	Drainage	1.00 ls	650,157.00 /ls	650,157	650,157
	Dewatering for utility work	1.00 ls	30,000.00 /ls	30,000	30,000
	deduct alternate for HP pipe ilo RCP for drainage	(1.00) ls	116,014.00 /ls	(116,014)	(116,014)

pckge	Description	Takeoff Quantity	Sub Cost/Unit	Sub Amount	Total Amount
	31B SITE UTILITIES - DRAINAGE		/SF	564,143	564,143
31C	SITE UTILITIES - SANITARY				
	Sanitary	1.00 I	128,613.00 /I	128,613	128,613
	31C SITE UTILITIES - SANITARY		/SF	128,613	128,613
31D	SITE UTILITIES - WATER				
	Water service	1.00 Is	168,597.00 /Is	168,597	168,597
	fire service	1.00 Is	34,550.00 /Is	34,550	34,550
	31D SITE UTILITIES - WATER		/SF	203,147	203,147
32B	FENCING & GATES				
	Fencing and gates and barrier arm	1.00 Is	71,183.00 /Is	71,183	71,183
	32B FENCING & GATES		/SF	71,183	71,183
32C	PAVERS				
	Pavers at test drive parking/entry/patio	1.00 Is	39,706.00 /Is	39,706	39,706
	32C PAVERS		/SF	39,706	39,706
32D	LANDSCAPE AND IRRIGATION				
	Landscaping and Irrigation	1.00 Is	207,383.00 /Is	207,383	207,383
	32D LANDSCAPE AND IRRIGATION		/SF	207,383	207,383
99C					
	Surveying	1.00 Is	56,595.00 /Is	56,595	56,595
	Rough and Final Cleaning	1.00 Is	6,025.00 /Is	6,025	6,025
	General Use Forklift	1.00 Is	10,272.00 /Is	10,272	10,272
	Yard Lights & Temp Pole	1.00 Is	7,000.00 /Is	7,000	7,000
	Openings Protection Allowance	1.00 Is	6,000.00 /Is	6,000	6,000
	Building Start Up	1.00 Is	10,000.00 /Is	10,000	10,000
	Storage Containers Allowance	1.00 allow	5,500.00 /allow	5,500	5,500
	Dumpster	1.00 Is	17,789.00 /Is	17,789	17,789
	Material testing allowance	1.00 allow	30,000.00 /allow	30,000	30,000
	99C			149,181	149,181
	PROGRAM AREA:	15,625.00 SF	714.17 /SF	11,158,905	11,158,905

Estimate Totals

Description	Amount	Totals	Rate
subtotal cost of work		11,158,905	
staffing	845,232		
general requirements ls	179,324		
Permit Fee Allowance	45,000		
construction contingency	334,767		3.000 %
sdi insurance	148,631		1.350 %
contract bond	85,522		
general liability	71,523		5.260 \$ / 1,000
builder's risk quote	38,472		
subtotal ins, bonding	1,748,471	12,907,376	
cm fee	613,100		4.750 %
Precon fee	77,000		
subtotal	690,100	13,597,476	
Total		13,597,476	

Hernando Tax Collector Building

Alternates and Value Engineering Rev 1



February 05, 2024

Item	Description	Add or Deduct	Accepted	Rejected
1	Porosity Inhibiting Concrete Admixture	\$30,727	\$30,727	
2	Enhanced Roofing Warranty	\$64,654		\$64,654
3	Enhanced Exterior Glazing	\$107,951		\$107,951
4	ASSA Albloy sliding doors ilo Stanley	(\$12,734)		(\$12,734)
5	2 Coat Kynar finish with 10 year warranty for canopies	\$79,382	\$79,382	
6	Fiberglass insulation in lieu of Armaflex at plumbing piping.	(\$15,000)	(\$15,000)	
7	Standard plumbing fixture package in lieu of specified package	(\$45,000)		(\$45,000)
8	Parking lot pole cameras	\$24,753		\$24,753
9	To utilize HP pipe in lieu of RCP for drainage system	(\$116,014)	(\$116,014)	
10	To utilize recycled asphalt in lieu of virgin at main property	(\$73,839)	(\$73,839)	
11	To utilize recycled asphalt in lieu of virgin at ROW paving	(\$16,550)		(\$16,550)
12	Use Carrier Equipmet & Delta Controls ilo Trane	(\$67,848)		(\$67,848)
13	Stainless steel kickplates on both sides of wood doors	\$10,846	\$10,846	
14	Painted concrete canopy columns in lieu of polished	(\$41,400)		(\$41,400)
Total		(\$70,072)	(\$83,898)	\$13,826



CPPI

construction management | design build | general contracting

February 05, 2024

Hernando County Board of County Commissioners West Tax Collector Building Spring Hill, Florida

100% GMP Revision 1

QUALIFICATIONS & CLARIFICATIONS

Documents

The budget estimate for the Hernando County West Tax Collector Building in Spring Hill Florida is based on the 100% construction documents dated 12/20/2023, as prepared by Straughn Trout Architects and on the landscape and irrigation plans dated January 22, 2024 in response to RFIs 55 and 56.

Div. 01 General Qualifications:

1. Pricing includes a 3% contingency on total construction cost of work.
2. Performance and Payment Bond is included.
3. General Liability Insurance is included.
4. Subcontractor Default Insurance (SDI) insurance is included in lieu of providing subcontractor payment and performance bonds.
5. Builder's Risk is by CPPI. The deductibles including named storm deductibles are by Owner.
6. We have included an allowance of \$45,000 for building permit fee. All impact and utility fees are excluded and are assumed to be carried by the Owner.
7. It is assumed all utility company charges for new services, connections, meters and transformers are by owner and are not included.
8. We have included an allowance of \$30,000 for material testing.
9. Davis Bacon wages and reporting are excluded.

Div. 02 Existing Conditions Qualifications:

1. We have assumed that all excavated materials will be reused and are clean, non-reportable soils.
2. We have not included any premium costs associated with the handling or disposal of regulated and/or contaminated soils.
3. We have not included deep foundations or soil improvements.

Div. 03 Concrete and Masonry Qualifications:

1. We have included CMU block at prime ID sign per AS drawings. No other CMU is shown on plans and therefore not included.



CPPI

construction management | design build | general contracting

2. We have included Modular Brick size, 2-1/2" high x 8" long, in specified two color blend and with smooth texture. Norman Brick size, as discussed with Maschmeyer, is not available.
3. We have included the accepted alternate add for porosity inhibiting concrete admixture.

Div. 06 Wood and Plastics Qualifications:

1. Interior brick veneer accent walls at reception back wall and surround of interior side of entry doors is included as shown on interior elevations.

Div. 07 Thermal and Moisture Protection Qualifications:

1. We have not included any fireproofing/intumescent paint.
2. We have included Vandex super white crystalline waterproofing over concrete tilt panels.
3. We have included peel and stick membrane on sheathing at exterior stucco walls at clerestory.
4. We have included tilt panel joint sealants at both sides of tilt panels.
5. We have included Soprema PVC roofing as equal to the ASTM requirements of the specifications.

Div. 08 Openings Qualifications:

1. Exterior storefront system by Kawneer Trifab VG 451 or equal is included. Includes Kawneer 350 or equal medium stile exterior entrance doors. Finish is class 1 clear anodized.
2. We have included (1) Stanley Dura-Storm 2000 bi-parting exterior level D impact auto sliding door system with clear class 1 anodized finish.
3. We have included Stanley Dura-Glide 2000 single, all glass sliding door system with clear class 1 anodized finish.
4. We have not included fire rated glazing. None are shown on plans.
5. Interior bullet proof security window by Hamilton is included.
6. We have included vinyl privacy film on doors 121 and 125.

Div. 09 Finishes Qualifications:

1. We have included level 4 wall finish.
2. We have included 5/8" Durock for walls receiving wall tile or stone.
3. Acoustical wall panels are not included in our proposal. None are shown on plans.
4. We have included stucco finish at clerestory behind ladder and above continuous clerestory glazing.
5. We have included stucco finish at exterior monument signs as shown on AS drawing sheets.
6. We have included Sto synthetic stucco system at ceiling of break patio per RFI response.
7. We have not included moisture mitigation.



CPPI

construction management | design build | general contracting

Div. 10 Specialties Qualifications:

1. We have included toilet accessories as manufactured by ASI or equal.
2. We have included ceiling hung toilet compartments as manufactured by ASI accurate or equal partitions.
3. We have included (1) one 50' high and (2) 40' high flagpoles as shown on AS drawing sheets.
4. We have included exterior canopies with a 2 coat Kynar finish with a 10-year warranty per accepted add alternate.
5. Canopy 2 beams run full length East to West. Deck will run North to South due to 20'-0" span.
6. We have included stainless steel door kick plates for wood doors per accepted alternate.
7. We have included signage at both sides of prime ID monument sign.
8. We have included signage at one side for secondary, E1, E2, E3, and E4 monument signs as shown on AS103.

Div. 11 Equipment Qualifications:

1. We have included (2) refrigerators at breakroom.
2. We have included (1) ice machine.

Div. 12 Furnishings Qualifications:

1. The window treatments are included by Draper.
2. We have included an allowance of \$435,990 for interior furniture per STA's proposal.
3. Pricing includes site furnishings and benches as listed in specification.

Div. 21 Fire Protection Qualifications:

1. Code compliant system per NFPA 13, 25 and local authorities having jurisdiction is included throughout new buildings.
2. The budget assumes adequate water pressure and flow are present on the site.
3. No dry pipe or specialty fire protection systems are anticipated or included.

Div. 22 Plumbing Qualifications:

1. We have included 1-1/2" fiberglass insulation in lieu of Armaflex per accepted value engineering.

Div. 23 HVAC Qualifications:

1. We have included test and balance.
2. We have included mechanical equipment and controls by Trane.



CPPI

construction management | design build | general contracting

3. We have included commissioning assistance.

Div. 26 Electrical and Low Voltage Qualifications:

1. We have not included removal or relocation of existing light poles.
2. We have not included site light fixture, pole, wiring, conduit, and controls as per ES102 schedule. To be by Withlacoochee River Electric Cooperative Inc.
3. We have included an allowance of \$38,150 for (1) 5" conduit for UG primary service entrance for 800 LF to road. Size of conduit is not shown on plans.
4. We have included (2) 2" conduits at 800' from the road to the MDF for low voltage service coming in to the property.
5. We have included \$14,475 for the innerduct for the low voltage service entrance conduits for 800'. Conduit sizes are not shown on plans.
6. We have included \$13,950 for power/circuitry for flush valve sensors. Includes (1) 20amp circuit breaker per restroom, (1) 120-48/dc transformer and low voltage wiring to each fixture.
7. We have included \$13,495 for single point connection for motorized window shades. Includes (18) junction boxes for window treatments, 120 v to each spread across (4) circuits.
8. We have included \$6,975 for a single point connection at 3 automatic door locations. Includes 120v and 20amp breaker.
9. We have not included any concrete encasements. None are shown on plans.
10. We have included utility transformer pad. Utility transformer by Withlacoochee River Electric Cooperative Inc.
11. We have not included emergency power. None are shown on plans.
12. We have included non-voice fire alarm system per FA 101.
13. We have included DAS testing. DAS rough-in and DAS system are not included.
14. We have included Samsung Pro series 98" Class QLED 4K Q80C, QN98Q80CAFXZA.
15. We have not included third party testing for NETA.
16. CT meter assumed to be provided by WREC per "summary and check list for new commercial account."
17. We have not included network hardware, switches, etc. Assumed to be by Owner's vendor.
18. We have not included sound systems. None are shown on the plans.

Div. 31 Sitework Qualifications:

1. We have assumed the project has a balanced site per civil engineer, and therefore we have not included imported fill. Pricing assumes all cut material is suitable for structural fill.
2. Removal and/or replacement of unsuitable soils, hazardous or buried debris is not included.
3. We have not included any muck removal from existing retention areas. We have assumed that all ponds can be disked.
4. There is no bypass pumping included for the sanitary manhole connection offsite. For the duration of this item, we have assumed that the upstream adjacent manhole can be temporarily plugged and pumped down using a vac truck. We have not received flow rates at time of bid.



CPPI

construction management | design build | general contracting

5. We have included installation of new silt fence along the Eastern most perimeter of the site. There is no silt fence shown along the perimeter wall.
6. Location, exploration and/or repairs to existing utilities are not included. As-builts of existing utilities are not included.
7. Opening trenches for fire marshal to inspect existing fire lines, if required, is not included.
8. We have excluded turtle relocation. To be by owner.
9. We have included HP pipe in lieu of RCP for drainage piping per accepted value engineering.
10. We have included recycled asphalt in lieu of virgin asphalt at main property per accepted value engineering.
11. Includes MOT for duration of county road improvements only.

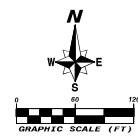

GRADING PLAN LEGEND

- PAVEMENT AT GENERAL PARKING AND DRIVE AREAS
- PAVEMENT AT HEAVY DUTY TRAFFIC AREAS
- CONCRETE
- RIP-RAP
- EXISTING CONTOUR
- PROPOSED CONTOUR
- STORM PIPE
- STAKED SEDIMENT BARRIER
- INLET PROTECTION
- PROJECT LIMITS

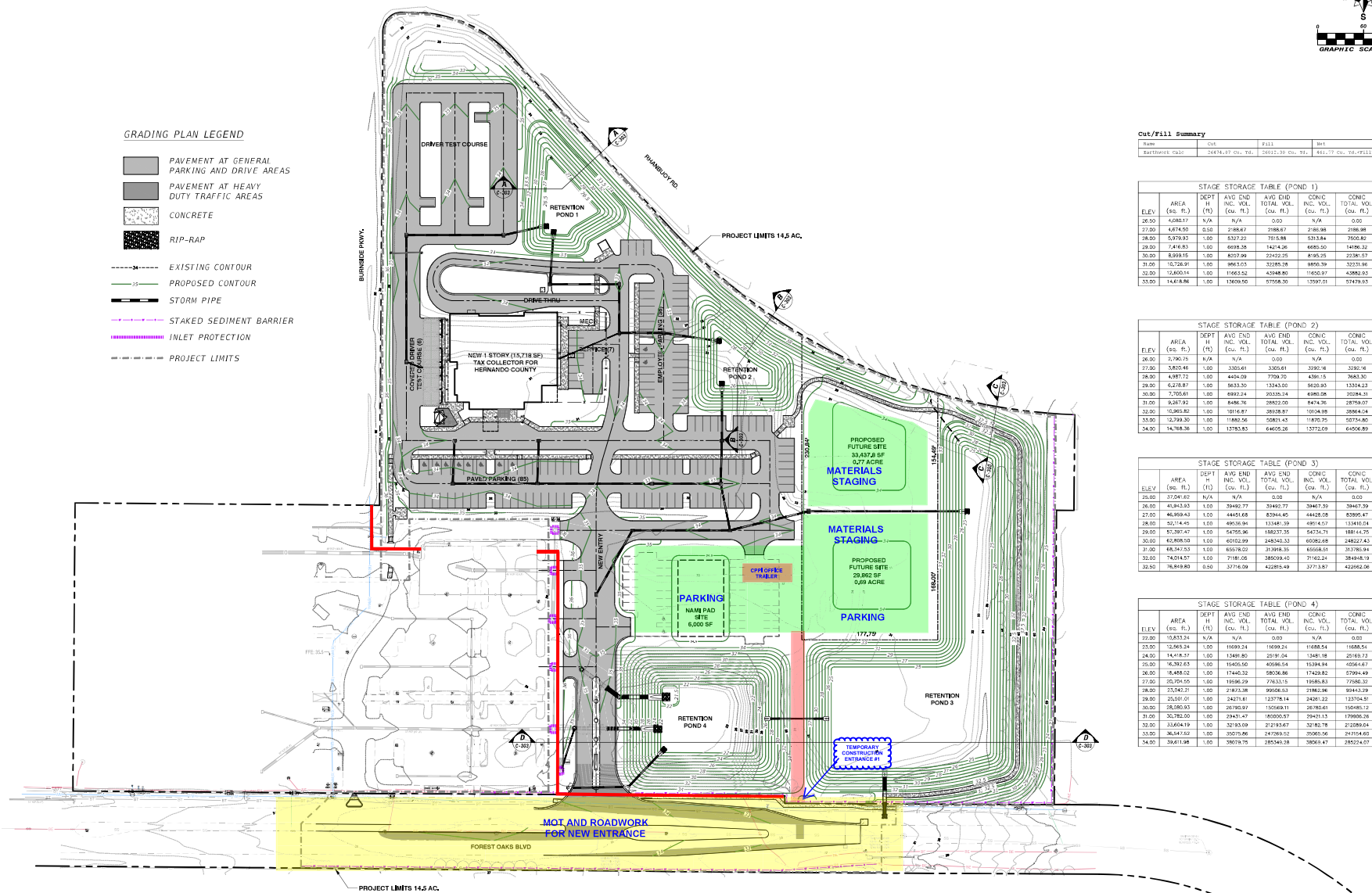

Cut/Fill Summary

Item	Cut	Fill	Net
Eastwest road	2474.97 Cu. Yd.	2012.30 Cu. Yd.	462.67 Cu. Yd. (FILL)

STAGE STORAGE TABLE (POND 1)

ELEV.	AREA (sq. Ft.)	DEPTH (ft)	AVG. END INC. VOL. (cu. Ft.)	AVG. END CONC. TOTAL VOL. (cu. Ft.)	CONC. INC. VOL. (cu. Ft.)	CONC. TOTAL VOL. (cu. Ft.)
26.00	4208.17	N/A	N/A	0.00	N/A	0.00
27.00	4,674.50	0.50	2188.67	2188.67	2188.68	2188.68
28.00	5,979.85	1.00	5377.22	7915.88	5313.84	7902.82
29.00	7,746.83	1.50	8693.38	14174.26	6885.50	14166.32
30.00	8,999.15	1.00	8057.99	22422.25	6195.25	22381.57
31.00	10,724.91	1.50	9961.63	32285.28	8956.39	32231.96
32.00	12,603.14	1.00	11961.52	43948.80	11605.97	43886.55
33.00	14,618.36	1.50	13699.50	57598.30	15991.01	57479.83

STAGE STORAGE TABLE (POND 2)

ELEV.	AREA (sq. Ft.)	DEPTH (ft)	AVG. END INC. VOL. (cu. Ft.)	AVG. END CONC. TOTAL VOL. (cu. Ft.)	CONC. INC. VOL. (cu. Ft.)	CONC. TOTAL VOL. (cu. Ft.)
26.00	7,790.25	N/A	N/A	0.00	N/A	0.00
27.00	5,820.46	1.00	3305.61	3305.61	3292.18	3292.16
28.00	4,987.72	1.00	4424.09	7704.70	4391.15	7683.30
29.00	6,216.87	1.00	5833.50	13445.30	5820.83	13344.23
30.00	7,705.61	1.00	6992.24	20437.24	6980.06	20294.31
31.00	9,267.92	1.00	8486.76	28922.00	8474.76	28750.07
32.00	10,910.82	1.00	10116.87	38838.87	10104.88	38684.24
33.00	12,739.50	1.00	11983.56	50811.45	11970.25	50714.80
34.00	14,768.36	1.00	13783.83	64655.28	13772.09	64506.89

STAGE STORAGE TABLE (POND 3)

ELEV.	AREA (sq. Ft.)	DEPTH (ft)	AVG. END INC. VOL. (cu. Ft.)	AVG. END CONC. TOTAL VOL. (cu. Ft.)	CONC. INC. VOL. (cu. Ft.)	CONC. TOTAL VOL. (cu. Ft.)
26.00	37,091.68	N/A	N/A	0.00	N/A	0.00
27.00	41,943.53	1.00	39492.77	39492.77	39467.39	39467.39
28.00	46,899.43	1.50	44451.68	83944.40	44428.28	83900.47
29.00	52,114.40	1.00	49936.99	133481.39	49814.67	131461.04
30.00	57,397.47	1.50	54755.96	183237.35	54724.71	181144.75
31.00	62,808.10	1.00	60192.99	243430.33	60062.68	242227.43
32.00	68,347.53	1.00	65918.00	303918.35	65808.01	302766.94
33.00	74,014.97	1.50	71919.08	380509.40	71822.24	380494.79
34.00	79,819.80	0.50	37714.09	422815.49	37713.87	422662.06

STAGE STORAGE TABLE (POND 4)

ELEV.	AREA (sq. Ft.)	DEPTH (ft)	AVG. END INC. VOL. (cu. Ft.)	AVG. END CONC. TOTAL VOL. (cu. Ft.)	CONC. INC. VOL. (cu. Ft.)	CONC. TOTAL VOL. (cu. Ft.)
22.00	10,833.24	N/A	N/A	0.00	N/A	0.00
23.00	12,963.24	1.00	11693.24	11693.24	11688.54	11688.54
24.00	14,418.37	1.00	13481.80	25175.04	13481.18	25163.73
25.00	16,392.63	1.00	15620.50	40795.54	15394.94	40566.67
26.00	18,488.02	1.00	17462.32	58257.86	17429.82	57994.49
27.00	20,795.55	1.00	19596.29	77853.15	19586.83	77582.32
28.00	23,242.31	1.00	21873.38	99506.53	21862.96	99443.29
29.00	25,820.01	1.00	24271.81	123778.34	24261.22	123704.30
30.00	28,526.83	1.00	26793.91	150569.25	26783.81	150485.12
31.00	30,782.50	1.00	29431.47	180000.57	29421.13	179956.26
32.00	32,604.19	1.00	32185.09	212193.67	32182.78	212094.04
33.00	34,014.02	1.00	35073.90	247868.52	35066.96	247814.63
34.00	34,611.98	1.00	38079.75	285345.28	38069.47	285274.07

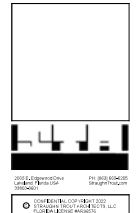

DAVID W. BUTCHER, P.E.
 LICENSE NO. 55401
 STATE OF FLORIDA
 PROFESSIONAL ENGINEER
 CIVIL ENGINEERING
 11111 W. US HWY 90, SUITE 100
 SPRING HILL, FL 34606

wsp
 WSP CONSULTANTS, INC.
 11111 W. US HWY 90, SUITE 100
 SPRING HILL, FL 34606
 (813) 399-1111
 www.wspinc.com

NEW WEST TAX COLLECTOR BUILDING FOR HERNANDO COUNTY BOARD OF COUNTY COMMISSIONERS FOREST OAKS BOULEVARD SPRING HILL, FL 34606

STA PROJECT #: 2243

#	DATE	ISSUED AS
1	10/05/23	PERM SET

CIVIL
 OVERALL GRADING PLAN

C-300

Project: Hernando Tax Collector
 Bid Date: 01/22/24

Bid Package #01E - Surveying



Subcontractor/Vendor Phone # Contact		Ferguson updated Scott Acker	American Layout updated	Geopoint Surveying No Bid Vernon Horne	Astra Surveying No Bid Eric Amos	John B. Webb & Assoc. No Bid Jacqueline Webb	Pura Vida Engineering No Bid Mustafa Syed
Bid Amount			\$56,595				
Addendum and RFIs 1-33							
Bond Premium							
furnish and install		included	included				
construction layout survey - infrastrucure		\$37,525	included				
as built survey		\$27,025	included				
construction layout survey - building/canopy		\$5,775	included				
construction layout survey - electric, light poles, dumpster pad		\$5,225	included				
foundation tie in survey		\$2,850	included				
optional - earthwork/utilities		\$10,425	included				
optional - FEMA elevation certificate		\$2,450	included				
optional - final survey		\$5,950	included				
TOTAL ADJUSTED BID		\$97,225	\$56,595				

Project: Hernando Tax Collector
 Bid Date: 01/22/24

Bid Package #01F - Final Clean



Subcontractor/Vendor Phone # Contact		Fine Tune <i>new</i>	DNS Const.- Magic Touch <i>new</i>	Millenium <i>new</i> Dell Holley	Americas Finest <i>new</i>	Spartan <i>updated</i> Jon Spengler	Spectra <i>updated</i>
Bid Amount		\$10,930	\$5,725	\$3,525	\$65,261	\$15,550	\$12,150
Addendum and RFIs 1-33							
Bond Premium							
Furnish and Install							
final clean			included	included	included	included	included
interior and exterior windows			included	included	included	included	included
exterior clerestory			included	included	included	included	included
pressure washing			No	included	included	included	included
lift			\$1,500	\$2,500	included	included	included
TOTAL ADJUSTED BID		\$10,930	\$7,225	\$6,025	\$65,261	\$15,550	\$12,150

Project: Hernando Tax Collector

Bid Date: 01/22/24

Bid Package #03A - Concrete/Tilt Panel



Subcontractor/Vendor Phone # Contact	BNG Construction updated - erry Hoinsworth - 407-688-1747 ext 212	Hoopers Concrete & Block updated Shantanu Adsul - 719-799-8098	OLP new Alexis Farinas - 321-438-6658	VMG No Bid Eric Martinez - 407-676-2384	Acclaim Saervice Gro9up No Bid Brent Jones - 727- 848-3200	Green Construction No Bid Carsen Stefanelli - 352-6658-0180	Liberty Concrete & Foaming No Bid Jerry Johnson - 407-864-2325
Bid Amount	\$773,745	\$830,461	\$895,887				
Addendum and RFIs 1-33							
Bond Premium							
Furnish and Install	included	included	included				
foundations	included	included	included				
SOG concrete	included	included	included				
tilt up panels	included	included	included				
cast in place - at 21 columns wrap - at canopy	included	included	included				
termite treatment	included	included	included				
form liner and thin brick (Norman size, smooth texture, 2 color blend - 3,186 sf)	Modular acceptable	Modular	Modular				
dumpster pad and apron, transformer pad, MEP pads	\$36,760	included	included				
(15) bollards - installation (6 at dumpster, 3 at rear of building, 1 at slide gate, 4 at course access arm)	in above	included -at dumpsters	for dumpster only				
5 bollards - Bullard Bollard at front entry	\$2,500	No	No				
concrete for flagpoles - 3 each	in above	No	No				
concrete foundations for (6) monument signs	in above	\$31,686	included				
canopy foundations	included	included	included				
backfill	included	\$38,000	included				
100% casting beds	included	included	included				
TOTAL ADJUSTED BID	\$813,005	\$900,147	\$895,887				

Project: Hernando Tax Collector
 Bid Date: 01/22/24

Bid Package #05A - Structural Steel



Subcontractor/Vendor Phone # Contact	East Coast Metal Structures updated Estimating - 561-766-2579	Industrial Steel LLC updated Gary Hood - 321-267-2341	Morrow Steel Fabricators updated Chad Morrow - 813-715-0404	Trinity Fab new Jake Westfall - 904- 652-4310	Allstate No Bid Cody James - 904-694-0661	United Steel No Bid Mike Growe
Bid Amount	\$504,090	\$609,700	\$455,937	\$450,000		
RFI responses			included			
Bond Premium			2%			
Furnish and Install	included	included	included	included		
structural steel columns	included	included	included	included		
steel W Beams	included	included	included	included		
steel channel beams	included		included	included		
Steel base plates, cap plates, connections	included	included	included	included		
Horizontal steel tubes/connections - including sunshade supports	included	included	included	included		
steel framing at sunshade extensions	included		included	included		
steel joists, bridging	included	included	included	included		
metal decking	included	included	included	included		
South entry framing with outriggers per S511 details 5, 6 and 7	included	included	included	included		
Diagonal bracing per S511 details 8, 9 and 12	included	included	included	included		
Angle braces for joist 1/S511	included	included	included	included		
Angle braces and joist reinforcing for cloud support	included	included	included	included		
Perimeter bent plate	included	included	included	included		
Perimeter angle	included	included	included	included		
restroom partition and screen support framing - 10/S-513	included	included	included	included		
HSS support at clerestory	included	included	included	included		
HSS braces at South canopy 1/S513	included	included	included	included		
roof hatch support angle low roof	included	included	included	included		
steel angle frames for exhaust fan and RTUs	included	included	none shown or required	included		
interior roof access ladder per A101 - finish as specified	included	included	\$5,500	\$5,500		
steel HSS post per 11/A806 - shop prime	included	included	included	included		
roof drain/overflow frain angle frames	included		included	included		
Furnish	included	included	included	included		
steel bollards	15 each		included	included		
anchor bolts for structural steel	included	included	included	included		
embeds for structural steel	included	included	included	included		
steel - 6/S513	included	included	included	included		
TOTAL ADJUSTED BID	\$504,090	\$609,700	\$461,437	\$455,500		

Project: Hernando Tax Collector
 Bid Date: 01/22/24

Bid Package #06A - Door Install



Subcontractor/Vendor Phone # Contact		Mills & Nebraska David Bridges - 863-226-4235	Shelmar new Shelley Roth - 813-892-3829	Silver Meteor Installation No Bid Bridge Pulsifer -	Redey Door Specialits No Bid Rudolf Brunathm- 941-545-3039
Bid Amount		\$8,525	\$7,031		
Addendum and RFIs 1-33					
Bond Premium					
installation		included	included		
door types A, B, C, D, E, F, G		included	included		
hardware		included	included		
temp door protection	19 each	\$3,800	\$3,800		
TOTAL ADJUSTED BID		\$12,325	\$10,831		

Project: Hernando Tax Collector
 Bid Date: 01/22/24

Bid Package #07A - Caulking/Waterproofing



Subcontractor/Vendor	ABG Caulking Contractors updated - as specified Kenny Mayberry - 407-846-6868	Midstate Caulking & Construction Serv. updated as specified Amber Nguon - 407-530-5775	General Caulking new Iampa Estimating - 813-769-9617	Jamestown Painting updated Wayne Abbott - 813-328-3192	Above All Caulking No Bid Jim Kontos - 727-573-9771	Paramount Painting & Services No Bid Chris Page - 813-715-9699
Bid Amount			\$26,300			
Addendum and RFIs 1-33						
Bond Premium						
furnish and install	included	included	included	included		
caulk of exterior joints at tilt wall	\$24,000	\$34,395	included	\$18,610		
exterior perimeter, slab to building interior and slb control joints	\$10,000	in above	included	No		
WP - membrane on sheathing under stucco - at clerestory	\$10,000	\$3,410	No	No		
WP - waterproofing over concrete tilt panels - Vandex as BOD	\$22,000	\$52,475	No	No		
TOTAL ADJUSTED BID	\$66,000	\$90,280	\$26,300	\$18,610		

Project: Hernando Tax Collector
 Bid Date: 01/22/24

Bid Package #07AB - Roofing



Subcontractor/Vendor Phone # Contact	Atlas-Apex Roofing No Bid Daniel Neely - 954-565-1567	Baker Roofing No Bid Estimating - 919-828-2975	P & A Roofing & Sheet Metal updated Ryan Upchurch - 866- 650-9541	Keeler Roofing No Bid Ben Keeler - 352- 514-4930	SpringerPeterson Roofing No Bid Heather Harris - 863- 665-1163
Bid Amount			\$329,000		
Addendum and RFIs 1-33					
Bond Premium					
furnish and install			included		
tapered insulation			included		
60 mil TPO system			included		
warranty			included		
walkway treads			included		
pipe boots			included		
sheet metal flashing and trim			included		
wood blocking for coping cap			\$7,800		
PVC - Durolast is BOD			Soprema PVC		
TOTAL ADJUSTED BID			\$336,800		

Project: Hernando Tax Collector
 Bid Date: 01/22/24

Bid Package #08A - Doors, Frames, Hardware



Subcontractor/Vendor Phone # Contact		Taylor Cotton <i>new</i> Dennis Hoffman - 352-746-3134	AG Mauro <i>new</i> Mark Carpenter - 407-333-0500	Mills & Nebraska <i>new</i> David Bridges - 863- 226-4235	Door & Hardware Opening <i>No Bid</i> Luis Rodriguez - 813- 679-0310	Allegion Access Technologies <i>No Bid</i> Don Hunt - 941-706-1248
Bid Amount		\$93,624	\$69,455	\$69,951		
RFIs included			yes			
Bond Premium						
Furnish		included	included	included		
Bid Form		Yes	Yes	Yes		
hollow metal frame - HM9	1		included	included		
hollow metal frames - HM10 and HM11	4		included	included		
hollow metal borrowed lite frames	21		included	included		
hollow metal doors	11		included	included		
factory primed wood doors	19		included	included		
hardware			included	included		
TOTAL ADJUSTED BID		\$93,624	\$69,455	\$69,951		

Project: Hernando Tax Collector
 Bid Date: 01/22/24

Bid Package #08B - Glazing



Subcontractor/Vendor Phone # Contact			Countryside Glass & Mirror updated Bernie Hill - 727-953-6145	Heritage Glass new Joan Hicks - 941-244-9225	Lake Glass new Beau Burkett - 352-787-4700	Diamond Glass new Joseph Paschitti - 239-482-7587	City Glass new Patrnck Johnson - 727-522-9453	Bay Glass & Window No Bid Paula Holmes - 239- 464-9331
Bid Amount			\$429,100	\$339,000	\$348,290	\$294,481	\$349,995	
Addendum and RFIs 1-33								
Bond Premium								
Furnish and Install			included	YKK	Kawneer	Kawneer		
Bid Form			included	yes	No	No		
Exterior Storefront - clear anodized, non impact			included	included	included	included	included	
SF101	1	ea	included	included	included	included	included	
SF102	1	ea	included	included	included	2	included	
SF103	1	ea	included	included	included	included	included	
SF104	1	ea	included	included	included	included	included	
SF105 - with perforated aluminum panels	1	ea	included	included	included	included	included	
SF106 - with perforated aluminum panels	1	ea	included	included	included	included	included	
SF107	1	ea	included	included	included	included	included	
SF108	1	ea	included	included	included	included	included	
SF109	4	ea	included	included	included	included	included	
SF110	5	ea	included	included	included	included	included	
SF111	1	ea	included	included	included	included	included	
SF112	1	ea	included	included	included	included	included	
SF113	1	ea	included	included	included	included	included	
SF114	1	ea	included	included	included	included	included	
SF115	3	ea	included	included	included	included	included	
SF116	1	ea	included	included	included	included	included	
SF117	1	ea	included	included	included	included	included	
Glazing SFC01 through SFC18 (SFC03 spandrel)	18	ea	included	included	included	included	included	
Exterior Storefront doors			included	included	included	included	included	
110C			included	included	included	included	included	
137			included	included	included	included	included	
149			included	included	included	included	included	
159			included	included	included	included	included	
Interior Storefront			included	included	included	included	included	
SF118	2	ea	included	included	included	included	included	
SF119	1	ea	included	included	included	included	included	
SF120	1	ea	included	included	included	included	included	
SF121	1	ea	included	included	included	included	included	
SF122	2	ea	included	included	included	included	included	
SF123	1	ea	included	included	included	included	included	
SF124	1	ea	included	included	included	included	included	
Q no fire rated glazing								
Interior storefront doors: 104, 126, 136, 140, 141, 148			included	included	included	included	included	
Hollow metal glazing			included	included	included	included	included	
HM9	1	ea	included	included	included	included	included	
HM10	2	ea	included	included	included	included	included	
HM11	2	ea	included	included	included	included	included	
exterior security window (window does not have a florida product approval and will require a hurricane shutter) - has non impact			included	\$18,197	included	\$18,197	\$11,000	
Q hurrucane shutter allowance			\$10,000	Not required w/ window	\$10,000	Not required w/ window	\$10,000	
break metal wrapping exterior tube steel at clerestory windows per detail A-511			included	included	included	included		
sill flashing per A-604			included	included	included	included		
blue max protection add				included	\$24,000	\$13,320		
vinyl privacy film allowance			\$1,152	\$1,152	\$1,152	\$1,152	\$1,152	
TOTAL ADJUSTED BID			\$440,252	\$358,349	\$383,442	\$327,150	\$372,147	

Project: Hernando Tax Collector
 Bid Date: 01/22/24

Bid Package #08D - Overhead door



Subcontractor/Vendor		D&D Garage Drs.	OH Door Co of Tampa Bay		
Phone #		813-486-2537			
Contact		Anthony Judt - 813-224-0123	Steve Livingston		
Bid Amount					
Addendum and RFIs 1-33					
Bond Premium					
Furnish and Install		included	included		
15' x 9' oh door at tag storage		\$19,750	\$15,746		
TOTAL ADJUSTED BID		\$19,750	\$15,746		

Project: Hernando Tax Collector
 Bid Date: 01/22/24

Bid Package #09A - Drywall, Framing



Subcontractor/Vendor Phone # Contact	MB Drywall Solutions updated Dale Hadley - 413- 313-6962	Comerstone new Shane Wright - 727- 540-0277	Drywall Elements new Greg Coulombe - 407-454-7293	Bay Area Drywall new Jose Garcia - 813-967-5620	Kenpat USA No Bid Phil Klote - 407-464-7070	South A Drywall No Bid Chris O'Brien - 321-806-7115	Sunliving Construction No Bid Dennis French 317- 987-3666
Bid Amount	\$416,105	\$469,300	\$780,670	\$489,067			
Addendum and RFIs 1-33							
Bond Premium							
Furnish and Install	included	included	included	included			
metal framing per wall types	included	included	included	included			
rigid insulation	included	included	included	included			
R-11 insulation	included	included	4625	included			
R-19 insulation	included	included	included	included			
deflection track	included	included	included	included			
acoustical caulk	included	included	included	included			
fire caulk at smoke walls - foot and head of wall	included	included	included	included			
drywall	included	included	included	included			
durock	included	included	included	included			
hat channels with isilation clips	included	included	included	included			
Clerestory framing including all plywood and vapor barrier	included	included	included	included			
soffits, floating soffits (cable), cove soffit	included	included	included	included			
bulkheads, radius bulkheads	included	included	included	included			
bulkhead soffit at overhead door	included	included	included	included			
Durock at restrooms, mop sinks and lobby areas	included	included	included	included			
framing for window shades	included	included	included	included			
drywall ceilings	included	included	included	included			
box beams	included	included	included	included			
backing	included	included	included	included			
frame out recesssed FEC cabinets	included	included	included	included			
break metal where wall meets galss at clerestory - 598/A-102	included	included	included	included			
install interior hollow metal frames	included	included	included	included			
wood bucks at interior window frames	included	included	included	included			
projector mount framing and blocking	included	included	included	included			
drywall reveals at lobby areas	included	included	included	included			
all FRT plywood at data room	included	included	included	included			
furnish and install general access panels at restroom drywall ceilings	included	included	included	included			
level 4 finish	included	included	included	included			
parapet blocking at clerestory	included	included	\$8,915	included			
fry reglet - at moss wall	included	included	included	included			
lift rental	included	included	included	included			
TOTAL ADJUSTED BID	\$416,105	\$469,300	\$794,210	\$489,067			

Project: Hernando Tax Collector
 Bid Date: 01/22/24

Bid Package #09B - Stucco



Subcontractor/Vendor Phone # Contact			Central Florida Construction Walls new Manuel Quilli - 407-250-3653	Cornerstone new Shane Wright - 727-540-0277	Midstate Caulking & Construction updated Amber Nguon - 407-530-5775	MB Drywall Solutions No Bid Dale Hadley - 413-313-6962	Florida Stucco Contractors No Bid Cobe Maldonado - 863-904-9435	Exterior Finish Plastering No Bid Juan Ciro - 352 369-9510
Bid Amount				\$29,250	\$13,435			
Addendum and RFIs 1-33								
Bond Premium								
Furnish and Install			included	included	included			
7/8" painted stucco on galvanized wire lath at high roof clerestory - stucco behind the ladder and above the continuous clerestory glazing.	400	sf	\$3,860	included	included			
stucco on exterior monument signs (prime ID, secondary, E1, E2, E3, and E4 signs) - AS103	6	ea	\$2,565	included	included			
sto (synthetic stucco) ceiling system at 12'-0" on exterior sheathing on cold formed suspension system.	400	sf	\$4,848	included	included			
TOTAL ADJUSTED BID			\$11,273	\$29,250	\$13,435			

Project: Hernando Tax Collector
 Bid Date: 01/22/24

Bid Package #09D - Painting, Coatings, Wallcoverings



Subcontractor/Vendor Phone # Contact		CC Painting late - new Juan Salazar - 813-297-5722	Jamestown Painting updated Bryan Shroyer - 239 785-3893	POD-NC updated Frank Nieves - 813- 355-1338	Percopo Coatings Company, LLC updated Sid Moore - 407-331-3805	Paramount Painting & Services No Bid Chris Page - 813-715-9699	KDB Painting No Bid Dave Black - 813-931-1587	All Coat Painting of Florida No Bid Ronald Hill - 352-484-8739
Bid Amount		\$55,320	\$45,945	\$39,980	\$77,757			
Addendum and RFIs 1-33								
Bond Premium								
Furnish and Install		included	included	included	included			
GWB walls		included	included	included	included			
GWB ceilings and soffits		included	included	included	included			
HM doors and frames		included	included	included	included			
exterior tilt panel		included	included	\$11,500	included			
polished concrete canopy columns	21 each	\$46,200	\$46,200	\$46,200	\$46,200			
pipe bollards	15 each	included	included	\$700	included			
sealed concrete floors		included	\$4,035	included	included			
prep and protection		included	included	included	included			
paint stucco at exterior monument signs	6 each	included	included	\$1,300	included			
lifts		included	included	included	included			
note - wood doors are prefinished								
TOTAL ADJUSTED BID		\$101,520	\$96,180	\$99,680	\$123,957			

Project: Hernando Tax Collector
 Bid Date: 01/22/24

Bid Package #09C - Acoustical Ceilings



Subcontractor/Vendor Phone # Contact		Hanlon Acoustical Ceilings updated Mathew Wright - 813- 930-0023	L&D ceilings new Sean Alling - 352-377-4112	Drywall Elements new Alan Bureau - 407- 454-7293	Acouti Engineering Co. No Bid Jason Saladino - 813-620-0718	Real Ceilings in Tampa No Bid Kevin De Maille - 813-837-8181	AAA Ceiling No Bid Estimating - 407- 928-3830
Bid Amount		\$159,380	\$262,497	\$206,695			
Addendum and RFIs							
Bond Premium							
Furnish and install		included	included	included			
ACT-1 - armstrong Optima 3254 2x2 white with white grid	9468	included	included	included			
ACT-2 - armstrong Calla 1x2 2824 Black with black grid	746	included	included	included			
ACT-3 4x4 armstrong 3256 white with white grid	1928	included	included	included			
4" and 6" axiom outside corner edge		included		included			
4" and 6" armstrong axiom classic straight trim, white		included		included			
TOTAL ADJUSTED BID		\$159,380	\$262,497	\$206,695			

Project: Hernando Tax Collector
 Bid Date: 01/22/24

Bid Package 10A - Specialties



Subcontractor/Vendor Phone #			Watkins new Kim Phillips - 352-777-4105	Streamline new Jamie Reed - 407-416-2882	McLeod General updated Connor McDonald - 352-215-2431	Interior Specialties new Brittany Biggs - 407-539-1303	Gren Wall Scapes new moss wall	Florida Specialty Products No Bid Scott Pratt - 321-765-4975	Square 10 Source No Bid Jeremy Line - 813-425-5868
Bid Amount				\$47,764	\$88,000		\$12,519		
Addendum and RFIs 1-33									
Bond Premium									
furnish and install			included	included	included	ASI	included		
Accessories			\$11,540	included	included	\$14,257			
framed mirror 18 x 36	5	ea	included	included	included	24x36			
36" grab bar	5	ea	included	included	included	included			
42" grab bar	5	ea	included	included	included	included			
wall mount toilet tissue disp	9	ea	included	included	included	included			
wall mount sanitary disp	7	ea	included	included	included	included			
recessed fold down baby changing station	5	ea	included	included	included	included			
recessed waste receptacle and paper towel comb	11	ea	included	included	included	included			
framed mirror 60x36	5	ea	included	included	included	included			
recessed seat cover disp	9	ea	included	included	included	8			
mop and broom holder	1	ea	included	included	included	included			
install owner furnished paper towel dispense	1	ea	included	included	included	included			
toilet compartments			\$18,100	included	included	\$33,942			
ceiling mounted compartments with 55" doors and panels	8	ea	included	included	included	included			
ceiling mounted phenolic 48" urinal screen	4	ea	included	included	included	included			
FEC			\$2,070	included	included	\$3,812			
semi recessed non rated FEC	4	ea	included	included	included	included			
10lb multi purpose FE	4	ea	included	included	included	included			
Corner Guards			included	included	included	included			
SS flush corner guards	9	ea	\$6,875	included	included	\$9,358			
tax			included	included	included	included			
stainless steel door kick plates for wood doors - both sides	19	ea	\$9,730	\$9,730	\$9,730	\$9,730			
TOTAL ADJUSTED BID			\$48,315	\$57,494	\$97,730	\$71,099			

Project: Hernando Tax Collector
 Bid Date: 01/22/24

Bid Package #09E - Flooring/09F - Tiling



Subcontractor/Vendor Phone #			Flooring Solutions new	Spectra updated	Morales Flooring new - no tile	Bay Area Comm new	AJ Flooring No Bid	Hudson Everly No Bid	Olson Contract Floors No Bid
Contact			Thomas Zentmeyer 813-882-8382	Andy Evans - 813-242-9879	Kimberly Connell - 813-933-7100	Jatuania Hatcher - 727-249-2061	Lucia Martinez - 407- 614-8286	Paul Ritten - 407- 405-3916	Mark Etting - 352-243-0266
Bid Amount			\$187,227	\$237,026	\$120,111	\$230,860			
Addendum and RFls 1-33									
Bond Premium									
Furnish and install			included	included	included	included			
Carpet Tile-CPT-1 Interface Third Space			771	819	included	807			
LVT-1 Interface Northern Grain			7158	7535	included	7212			
4" vinyl cove base-RB-1 Tarket Reveal 6"			2010	2635	included	1920			
RB-2- standard			360	400	included	240			
moisture testing			included		included	included			
flooring transitions			included		included	included			
minor floor prep			included	included - 640	included	included - 4420			
CT-1 Crossville Moonstruck 12x24 UPS finish			1175	1288	\$98,386	1164			
CT-2 Crossville Moonstruck 12x24 Honed finish			900	1009	included	947			
CT-3 GS Season 3x12 wall tile - Petrolio			367	349	included	779			
CT-4 Crossville Retroactive 4x12 wall tile royal navy			525	170	included	186			
CT-5 GS Forma 12x24 mica matte			1600	1692	included	1586			
trim associated with tiling/bullnose			included	included	included	included			
waterproofing membrane at tile			included	included	included	included			
moisture mitigation at carpet and vinyl flooring			No	No	No	No			
floor protection			\$1,500	included - 1500	\$1,500	\$1,500			
walk off mat - 6x6	3 each		\$13,950	\$13,950	\$13,950	\$13,950			
interior brick venter - A-801 - at North reception wall and at exterior side of SF101 entrance slider doors	200	sf	\$15,077	\$15,077	\$15,077	\$15,077			
TOTAL ADJUSTED BID			\$217,754	\$266,053	\$249,024	\$261,387			

Project: Hernando Tax Collector
 Bid Date: 01/22/24

Bid Package 10B - Signage



Subcontractor/Vendor Phone # Contact			Mid FL new Tom Rudd - 352-787-3882	Vital Signs of Orlando updated Gary Stephens - 407-297-0680	White Sign new Jacob Pippin - 386 - 320-0623	Architectural Identification No Bid Trent Eckfeld - 727-639-0250	ASI Signage Innovations No Bid Noel Westman - 727-742-9480	JSI Signage No Bid Kimberly James - 813-693-1609
Bid Amount			\$69,528	\$99,998	\$104,189			
Addendum and RFIs 1-33								
Bond Premium								
Furnish and install			included	included	included			
INTERIOR			included	included	included			
room ID signage			included	included	included			
restroom/with symbol			included	included	included			
exit signage/Tactile exit signs			included	included	included			
life safety/EVAC signage			included	included	included			
testing room signage			included	included	included			
36" diameter - LOGO			included	included	included			
cast aluminum letters - WELCOME			included	included				
EXTERIOR			included	included	included			
monument prime ID sign (10/AS103) - double sided , internally illuminated aluminum entrance monument sign	1	ea	included	included	(\$4,000)			
monument secondary ID sign (7/AS103) - single sided , internally illuminated aluminum entry sign	1	ea	included	included	included			
monument TAX COLLECTOR sign E1 (AS103) - single sided , internally illuminated aluminum monument sign	1	ea	included	included	included			
monument TAX COLLECTOR SIGN E2 (AS103) single sided internally illuminated aluminum monument sign	1	ea	included	included	included			
monument TAX COLLECTOR SIGN E3 (AS103) single sided internally illuminated aluminum monument sign	1	ea	included	included	included			
monument TAX COLLECTOR SIGN E4 (AS103) single sided internally illuminated aluminum monument sign	1	ea	included	included	included			
16"x 10" Aluminum panel sign - at concrete column (12/AS103)	6	ea	included	included	included			
Drivers testing parking (2 and 3 /AS103) - reserved for testing applied to aluminum canopy	6	ea	included	included	included			
18" Aluminum lettering - South elevation: TAX COLLECTOR	1	ea	included	included	included			
40" high cast aluminum dedication plaque	1	ea	included	included	included			
misc signage				\$10,000	included			
TOTAL ADJUSTED BID			\$79,528	\$99,998	\$100,189			

Project: Hernando Tax Collector
 Bid Date: 01/22/24

Bid Package 10E - Canopy



Subcontractor/Vendor Phone #			Awning Factory updated	Perfection new	Peachtree new - Logan Asniey - did the canopy at Lake Alfred - CA finish - 770-779- 9410	Awning Factor No Bid	Seco South No Bid	Logsdon and Associates No Bid	Architectural Metals of SW No Bid	Mitchell Metals No Bid
Contact			Maggie Mankarious	O. Delgado - 407-671-6225	Maggie Mankarious - 407- 460-1526	Jose irizarry - 727-536-1924	Ryan Logsdon - 407-466-4009	Andrew Sass - 239-334-7433	Sebastian Medina - 770-882-2647	
Bid Amount			\$1,010,000	\$598,265	\$502,048					
Addendum and RFIs 1-33										
Bond Premium										
Furnish and install - see page A-301			included	included	included					
aluminum canopy- note 1090 - 3, 4, 5 and 6 on East and North sides of building with fascia and integral cantilevered soffit deck by Mapes	4	ea	included	included	included					
Canopy 1A at South entry	1	ea	included	included	included					
Canopy 1B at South entry	1	ea	included	included	included					
Canopy 2 at test parking	3790	sf	included	included	included					
aluminum canopy columns	21	ea	included	included	included					
Sunshades note 1029 - bracket mounted	4	ea	included	included	included					
sunshades with airofoil blades - at clerestory - steel supported(in steel)	1727	sf	included	included	included					
6x6 columns at west canopy per S-502 detail 1	21	ea	included	included	included					
Q	clear anodized - 5 year warranty		included	included	included - like Lake Alfred per photos					
Q	2 coat Kynar - 10 year warranty				\$71,212					
Q					canopy 2 - beams run full length E to W - deck will run N to S due to span					
TOTAL ADJUSTED BID			\$1,010,000	\$598,265	\$573,260					

Project: Hernando Tax Collector
 Bid Date: 01/22/24

Bid Package 10H- Aluminum Flagpoles



Subcontractor/Vendor Phone # Contact			Head Flags new Tony Clayton - 813- 636-0701	Flagpoles Etc new Danielle Bass	Global Flags need update Belinda Moses - 800-962-0956	Watkins new Kim Phillips - 352-777-4105	McLeod General Trades No Bid Connor McDonald - 352-215-2431	Square 10 Source No Bid Stacey Gimson - 813-425-2323
Bid Amount			\$38,274	\$39,190	\$41,551	\$42,965		
RFIs								
Bond Premium								
Furnish and install			included	included	included	included		
bid form			yes	included	No	No		
40' flagpole as shown on plan notes and diagrams	2	ea	included	included	70	included		
50' flagpole as shown on plan notes and diagrams	1	ea	included	included		included		
external halyards			included	included	included	included		
flagpole stamped drawings						\$590		
flagpole engineered footing drawings						\$725		
TOTAL ADJUSTED BID			\$38,274	\$39,190	\$41,551	\$44,280		

Project: Hernando Tax Collector
 Bid Date: 01/22/24

Bid Package 11G - Projection Screens



Subcontractor/Vendor Phone # Contact		Interior Specialties No Bid Brittany Biggs -	Watkins Kim Phillips - 352-777-4105	Contract Décor No Bid Penny Wartler - 760-343-4444	Division 10 Sales No Bid Catie Hamrick - 704-644-5913	Florida Visual Display No Bid Tim Woodward - 727-9*44-4901	McLeod General No Bid Connor McDonald - 352-215-2431
Bid Amount							
Addendum and RFIs 1-33							
Bond Premium							
Furnish and install							
recessed ceiling mounted projection screen - stewart cascade HMT3 screen size 76H x 136 wide, matte white screen, white housing - training room			\$20,050				
TOTAL ADJUSTED BID		\$0	\$20,050	\$0	\$0	\$0	\$0

Project: Hernando Tax Collector
 Bid Date: 01/22/24

Bid Package 12A - Casework



Subcontractor/Vendor Phone # Contact			D & R Cabinetry and Millwork updated Evan Yaros - 407-8547-4008	Kabinets by Kinsey new Chuck Kinsey- 813-222-0460	Home Pride new Jeremy Gray - 731-793-0372	Star Quality new Joel Torres - 813- 875-9955	OEC Interiors new reception only	Crystal Clear Cabinetry No Bid Todd Fleming - 912-600-7044
Bid Amount			\$239,900	\$219,434	\$193,874	\$205,400	\$46,678	
Addendum and RFIs 1-33								
Bond Premium								
Furnish and Install			included	included	included	included		
Reception deck at lobby 101, solid surface, wall cladding, Plam knee wall/cabinets, lockable - M1			included	included	included	included		
Back wall at reception 102 - solidsurface, plam- M1A and M1B			included	included	included	included		
Lobby Walls, entry low wall and columns cover, wall cap, plam knee wall cover, reveals - M2	4	ea	included	included	included	included		
plastic laminate ceiling cloud/reception wall panel on plywood - M4, M4A - allowance provided until receive details - 252 sf laminate system - page A-212	157	sf	\$30,000	included	No	\$30,000		
Moss wall at reception 102 back wall - plam wall panels above countertop up to ceiling on side walls and soffit above			included	included	\$9,500	included		
bench and counter at lobby 101, solidsurface counter and waterfalls, plam bench - M3	2	ea	included	3500 allowance for fabric	included	included		
planter at lobby 101 - solidsurface wall wrap and top - M12	2	ea	included	included	included	included		
Clerk stations at 117 - SS counter, plam cabinets - M4	2	ea	included	included	included	included		
Testing 116 - plam counter/splash, plam dividers, concealed brackets - M6			included	included	included	included		
Drive up teller 116 - SS counter, plam cabinets - M7			included	included	included	included		
Q deal drawer by owner at drive up teller			with window	with window	with window	included		
quiet room 135 - ss counter, plam cabinets/apron with access panel - M8			included	included	included	included		
break room 136 - ss counter, plam cabinets - M9 (dining counter is FF&E)			included	included in FF&E	included	included		
breakroom waste bin			\$2,500	included	\$2,500	included		
3rd party vendor 110 - ss counter, plam cabinets, gate - M10			included	included	included	included		
CWL testing stations 111 - plam counter/splash, plam dividers, concealed brackets - M11			included	included	included	included		
foot bar rail at reception desk knee spaces and drive up window			included	\$6,350	included	included		
ss window sill at exterior storefront windows			No	included	included	included		
millwork (Plam) gate - 102A, 102B, and 143			included	included	\$7,500	included		
maple stained with lacquer cap at photo booth - A-806			included	included	included	included		
cloud wire			included	included	included	included		
lift			included	included	included	included		
TOTAL ADJUSTED BID			\$272,400	\$225,784	\$213,374	\$235,400		

Project: Hernando Tax Collector
 Bid Date: 01/22/24

Bid Package 12C - Window Treatment



Subcontractor/Vendor Phone # Contact			Interior Specialties <i>updated</i> Maggie Mckenzie - 407-539-1303	James Blinds <i>updated</i> Estimating - 614-291-4621	Cube Care <i>new</i> susana Kobleddo - 305-556-8700	Florida Contract <i>new</i> Megan Moynieux- 352-682-4018	TBS Construction Specialties <i>No Bid</i> Tim Smith - 813- 632-0657	Above the Sill <i>No Bid</i> MEISSA MCNALLY - 941-492-3101
Bid Amount			\$48,054	\$64,628	\$76,361	\$49,424		
Addendum and RFIs 1-33								
Bond Premium								
Furnish and Install			Draper	Draper	Mecho Shades	Hunter Douglas		
manual single roller shades with fascia - at secure interior windows (2) tax collector (2) chief deputy	4	ea	included	included	included	included		
manual single roller shades with closure and mount - training room(4), breakroom (3)	7	ea	included	included	included	included		
motor operated roller shades with single rollers	5	ea	included	included	included	included		
motor, digital timer	12	ea	included	included	included	included		
TOTAL ADJUSTED BID			\$48,054	\$64,628	\$76,361	\$49,424		

Project: Hernando Tax Collector
 Bid Date: 01/22/24

Bid Package #21A - Fire Protection



Subcontractor/Vendor Phone # Contact		Fire Safety Inc. updated David Rose - 407-455-8605	Piper Fire new Chris Johnson - 727-581-9339	Titan Fire new Ray Cole - 727- 408-5306	Brown Automatic Sprinklers No Bid Marty Seles - 813-621-2071	Universal Fire Systems No Bid Steve Shea - 813-662-9200	Cox Fire Protection No Bid Paul Pass - 813-980-3282
Bid Amount		\$105,900	\$80,369	\$78,200			
Addendum and RFIs							
Bond Premium							
Furnish and Install		included	included	included			
bid form		yes	yes	yes			
wet pipe riser complete		included	included	included			
control valve		included	included	included			
tamper switch		included	included	included			
check valve		included	included	included			
maindrain		included	included	included			
flow switch		included	included	included			
elecgric bell		included	included	included			
inspectors test connection		included	included	included			
spare head cabinet		included	included	included			
white semi-recessed pendent sprinkler heads (Brass uprights with exposed decks)	157 each	included	included	included			
automatic air release		included	included	included			
TOTAL ADJUSTED BID		\$105,900	\$80,369	\$78,200			

Project: Hernando Tax Collector
 Bid Date: 01/22/24

Bid Package #22A Plumbing



Subcontractor/Vendor Phone # Contact	Quantity	Unit	American Mechanical Solutions	Feddon Mechanical	Royalair Mechanical	Coastal Mechanical Ser.	Comfort Temp Company	MIELK Mechanical
			updated	updated	updated	No Bid	No Bid	No Bid
			Joshua Merrick - 813-534-0010	Joseph Branton - 813-644-1196	Tommy Thornton - 904-716-5883	Paul McQuain - 321-302-3354	Austin Schrack - 352-575-3040	Estimating - 330- 725-8845
Bid Amount			\$469,511	\$490,325	\$594,300			
Addendum and RFIs 1-33								
Bond Premium								
Finish and install			included	included	included			
supervision			\$45,000	included	included			
sanitary waste and vent piping			included	included	included			
domestic waterpiping - type L and K			included	included	included			
storm piping in lobby/reception shall be cast iron because this area has a return air plenum. All other areas have ducted returns and can be PVC			included	included	included			
insulation with Armaflex			\$15,000	included	included			
excavation and backfill			included	included	included			
plumbing ID			included	included	included			
fire safing			included	included	included			
warranty			included	included	included			
accepted VE - 2-1/2" thick fiberglass insulation ilo armaflex			(\$10,000)	(\$750)	(\$15,000)			
plumbing equipment and fixtures -AS SPECIFIED			\$65,000	\$50,000	included			
WC-1	4	ea	included	included	included			
WC-2	5	ea	included	included	included			
L-1	5	ea	included	included	included			
L-2	4	ea	included	included	included			
U-1	4	ea	included	included	included			
EWC-1	2	ea	included	included	included			
MS-1	2	ea	included	included	included			
S-1	1	ea	included	included	included			
S-2	1	ea	included	included	included			
CP-1	1	ea	included	included	included			
EWH-1 - 20 gal	1	ea	included	included	included			
MV-1	1	ea	included	included	included			
ET	1	ea	included	included	included			
OB-1 ice maker box	1	ea	included	included	included			
trap primers	7	ea	included	included	included			
HB-1	6	ea	included	included	included			
FD-1	5	ea	included	included	6			
FD-2	1	ea	included	included	included			
FS-1	1	ea	included	included	included			
ECO	2	ea	included	included	included			
RD-1	21	ea	included	included	included			
RD-2	3	ea	included	included	included			
DSN	3	ea	included	included	included			
TOTAL ADJUSTED BID			\$584,511	\$539,575	\$579,300			

Project: Hernando Tax Collector
 Bid Date: 01/22/24

Bid Package #23A - HVAC



Subcontractor/Vendor Phone # Contact	Quantity	Unit	American Mechanical Solutions not qualified Joshua Merrick - 813-534-0010	Feddon Mechanical updated Joseph Branton - 813-644-1196	Royalaire Mechanical updated Tommy Thornton - 904-716-5883	Comfort Temp Company updated Mark Houston - 352-376-2366	Jax HVAC not complete Dave Ceyrolles - 352-544-1100	Penninsular new Jason Spears - 727-573-4822
Bid Amount			\$640,811	\$755,545	\$670,800	\$622,395	\$515,175	\$725,500
Addendum and RFIs								
Bond Premium						1.5%	1.5%	
Furnish and Install			included	included	included	included	included	included
Trane (BOD) air cooled condensing units CU 1 and 2	2	ea	Trane	Trane	Carrier	Trane	Trane	Trane
Trane (BOD) DX AHU (assembled in three pieces) - corrosion resistant coils	1	ea	included	included	included	included	included	included
installation of duct mounted smoke detectors (furnish by electrical sub)	1	ea	included	included	included	included	included	included
in line outside air electric pre heat duct heater	1	ea	included	included	included	included	included	included
Trane VAV terminal units with electric heat strips	14	ea	included	included	included	included	included	included
Mitsubishi DX dutless mini split system	1	ea	included	included	included	included	included	included
auxiliary drain pan			included	included	included	included	included	included
exhaust fans interlocked with building management system, controls			\$5,000			\$5,000	\$5,000	
ACR refrigeration copper piping with pipe supports and required external pipe insulation - aluminum jacket for exposed piping			included	included	included	included	included	included
type L copper condensate piping with insulation, pipe supports to nearest floor drain			included	included	included	included	included	included
Greenheck roof mount exhaust fan	1	ea	included	included	included	included	included	included
exterior wall mount outside air louver	1	ea	included	included	included	included	included	included
fire dampers in fire rated walls	5	ea	\$10,000			\$10,000	\$10,000	
Manual volum dampers	30	ea	included	included	included	included	included	included
galv rectangular and round sheet metal ductwork as specified			included	included	included	included	included	included
low pressure round ductwork as specified			included	included	included	included	included	included
air distribution: grilles, registers, diffusers, clerestory, sidewall grilles	112	ea	included	included	included	included	included	included
flexduct and collars for air distribution			included	included	included	included	included	included
DDC controls			included	included	included	included	included	included
mechanical ID			included	included	included	included	included	included
vibration isolation			included	included	included	included	included	included
mechanical insulation			included	included	included	included	included	included
test and balance			\$33,000	included	included	\$33,000	\$33,000	included
equipment rigging and start up			included	included	included	included	included	included
supervision			included	included	included	included	\$45,000	included
fire safing of rated floor and wall partitions			included	included	included	included	included	included
permits and warranty			included	included	included	included	included	included
Trane equipment/controls add			included	included	\$95,620	included	included	included
commissioning assistance			\$5,000	included	included	\$5,000	included	included
storage on site (conex)			\$5,000			\$5,000	included	included
escalation - hold bid for 60 days			\$18,915	included	included	\$18,915	\$18,915	included
TOTAL ADJUSTED BID			\$717,726	\$755,545	\$766,420	\$699,310	\$627,090	\$725,500

Bid Package #26A - Electrical/Low voltage



Subcontractor/Vendor	Erwin Electric Brian 8666	All Phase Constan - 813- 876-7074	LEBS Ben - 954-228-7539	Inerby/ Kon - 813-875-1886	Borrell Adria - 727-892-1941	Elect. Services Greg - 352-674-1322
Subcontractor/Vendor Phone #	Erwin Electric Brian 8666	All Phase Constan - 813- 876-7074	LEBS Ben - 954-228-7539	Inerby/ Kon - 813-875-1886	Borrell Adria - 727-892-1941	Elect. Services Greg - 352-674-1322
Bid Amount	\$1,352,295	\$1,383,250	\$1,245,500	\$1,613,496	\$1,661,564	\$1,794,000
Contact						
Address and RFS						
Bond Premium						
Furnish and Install						
Electrical	included	included	included	included	included	included
1000 amp switchgear - E-501	included	included	included	included	included	included
feeders E-501	included	included	included	included	included	included
EMT conduit with compression fittings per county	included	included	included	included	included	included
Conduit from the utility transformer to the electrical C.T cabinet - note 3	included	included	included	included	included	included
Provide and install (2)" conduits from the road to the MDF (800)", - low voltage service coming in to property, - 1051	included	included	included	included	included	included
(2)" per owner	\$4,120,000	\$9,975,000	included	included	included	included
deduct for (2)" conduits and inner duct in lieu of (2) 4" conduits - 8507	\$15,070,000	\$14,475,000	\$22,000,000	included	included	included
Innerduct for the low voltage service entrance conduits -page 1051 - 8007	allowance	allowance	allowance	allowance	allowance	allowance
pad mounted utility transformer - note 1 - (pad w/ concrete contractor)	allowance	allowance	allowance	allowance	allowance	allowance
(1)" primary UG service entrance - coord termination point - note 2 - included allowance - 800 to the road - includes pull boxes	\$28,265	\$38,150	\$25,000	included	included	included
fixtures and lighting controls E-201	included	included	included	included	included	included
floor boxes	included	included	included	included	included	included
walker duct	included	included	included	included	included	included
Cable tray - T101	No-site lighting - by county per ES102 schedule	No-site lighting - by county per ES102 schedule	No-site lighting - by county per ES102 schedule	No-site lighting - by county per ES102 schedule	No-site lighting - by county per ES102 schedule	No-site lighting - by county per ES102 schedule
site lighting - direct burial concrete poles	18 each	18 each	18 each	18 each	18 each	18 each
receptacles and connectors E-101	included	included	included	included	included	included
circuit connection disconnecting for electrical equipment E-101	included	included	included	included	included	included
lighting protection E-301	\$10,000	included	No	included	included	included
temp power and lighting	included	included	included	included	included	included
hook up GC trailer	included	included	included	included	included	included
Non voice fire alarm system - FA 101	included	correct	Dynafire	included	included	included - 100%
DAS testing/BDA survey only, no system or conduit system	included	included	included	included	included	included
plywood backboards	included	included	included	included	included	included
traffic rated hand holes and pull boxes - shown on each drawing, 1051	included	included	included	included	included	included
power supply to monument sign lighting/lighting pole lighting	included	included	included	included	included	included
power supply to operator and photo eye - v-track gate	included	included	included	included	included	included
furnish duct mounted smoke detectors (install by mechanical sub)/wiring by FA)	\$10,000	No	included	included	included	included
composite clean up	\$36,000	included	included	included	included	included
coordination studies - Infrared inspection 6 months as specified	\$10,000	\$10,000	included	4800	included	included
BIM	\$10,000	included	included	included	included	included
NETA testing	not 3rd party	not 3rd party	not 3rd party	not 3rd party	not 3rd party	not 3rd party
power/circuits for Aish valves sensors	\$2,987	\$13,950				
power breaker size for motorized window shades	\$7,211	\$15,495				
city/ty power, breaker size for Auto door - single point connectors at 3 locations	3 each	3 each				
E/101 - electrical at each of the workstations for under floor trainhead system wall in-deck locations	\$6,975	\$6,975				
Low Voltage	included	included	included	included	included	included
Telecommunications/structured cabling	included - A Tech	included	included	included	included	included
Access Control - card reader, (Enterprise)	included - Minuteman	included - Minuteman	included - Minuteman	included	included	included
Audio Visual system - including projector/projector screens	included - A Tech	included	included	included	included	included
deduct projector and screen	\$6,503,000	below				
CCTV/FP surveillance/Cameras per schedule and RFI responses	included - Minuteman	included	included	included	included	included
LOD TV - Samsung Pro Series	\$8,548	\$1,850				
TV's - Samsung	13 each	13 each				
access control - card readers, audio visual intercoms for v-track gate by gate company - 1051	In gate company	In gate company	In gate company	In gate company	In gate company	In gate company
TOTAL ADJUSTED BID	\$3,477,228	\$3,477,637.00	\$3,549,456	\$3,613,496	\$3,661,564	\$3,794,000
parking lot pole cameras - alternate	\$22,205					
site lighting deduct	(\$24,533)					
DPD amount		\$300,000				

Bid Package #31A - Sitework



Subcontractor/Vendor			Raymow	Crisdel	Cook Const.	Burgess	JA Pavers	Cypress Gulf
Phone #								
Contact			updated James Daugherty - 813-855-8484	updated Israel Justice - 813-625-5216	new - need revision Stephen, Michael, David	new Justin Sylvester - 813-502-3727	new Roger Smith - 407-383-1304	No Bid Dave Valdez 813- 241-6200
Bid Amount							\$39,706	
Addendum and RFIs								
Bond Premium						1.25%		
General Conditions and Erosion Control			\$393,503.00	\$933,111	\$213,400	\$394,261		
Mobilization			included	included	included	included		
MOT			included	included	included	included		
Silt Fence - on and off site			4327 LF	1294 LF	1270 LF	1065 LF		
Inlet Protection			32 each	6 each	4 each	37 each		
construction entrance/wash off pads	1	EA	included	included	included	included		
sod - pond slopes and 2' BOC			115307 sy	14690 sy	No	17290 SY		
seed & mulch			No	17000 sy	No	28198 SY		
survey/layout			included	included	included	included		
Demolition			\$77,145.00	included	\$60,860	included		
Clearing and Grubbing			included	included	included	included		
Remove existing storm pipe	120	LF	118 lf	included	included	81 LF		
remove storm structures						4 each		
remove pressure pipe	240	LF	238 lf	included	included	included		
remove and dispose existing asphalt and base	8149	SF	included	included	included	355 SY		
saw cut pavement						190 LF		
remove curbs						416 LF		
remove and dispose existing chain link fences	870	LF	870 lf	included	included	874 LF		
remove and dispose trees and misc vegetation	15	EA	included	included	included	included		
Scrape sod and top soil, utilize for backfill in nonstructural areas and haul off excess			included	included	included	included - no haul off		
no milling of existing asphalt								
Earthwork			\$708,782.00	\$422,331	\$657,362	\$335,682		
cut site			included	34389 CY	included	included		
disc site				11 acres		12 acres		
import fill - According to the engineers takeoff this is a balanced site.								
pond excavation						29285 CY		
proof roll site			included	11 AC		34554 SY		
construct building pad						2080 SY		
place and compact			included	26716 CY		included		
final grading			included	included	included	included		
building pads for future						\$100,000		
Concrete			\$251,936.00	\$339,748	\$339,748	in paving		
type D curb			included	6187 LF	included	5965 LF		
type F curb				807 LF		800 LF		
ribbon curb				680 LF		795 LF		
4" sidewalk with fibermech/thickened edge/WWF			6736 sf	8,828 sf	No	1630 SY		
handicap ramp with domes	17	ea	included	16 each	No	13 each		
concrete flumes			included	26 LF	included	13 SY		
6" steel concrete filled bollards	8	ea	-\$20,000.00	(\$20,000)	No - in steel	No - in steel		
Concrete pavers	3278	sf	(\$33,330)	No	No	(\$25,000)	included	
Asphalt Paving			\$2,289,387.00	\$953,786	\$1,134,576	\$1,102,080		
stabilized subgrade - 12"	17250	SY	included	17073 SY	included	15545 SY		
6" standard duty road base/meroc			included	15301 SY	included	15545 SY		
1.5" SP-95 asphalt - virgin asphalt			included	included	included	15545 SY - one lift		
8" heavy duty road base/meroc			included	included	included	in above		
2,0" SP-95 asphalt - virgin asphalt			included	included	included	in above		
wheel stops						63 each		
signage and striping			included	included	included	included		
second lift asphalt add			included	included	included	\$37,748		
pending accepted VE - FDOT asphalt to virgin (main property)						(\$73,839)		
Off Site Work			in above	\$228,311	included	\$312,264		
demo asphalt and sidewalk			included	included	included	included		
Clear and Grub/Excavate for offsite paving			included	included		included		
saw cut pavement						637 LF		
Offsite 14" road base	1297	SY	included	1346 SY		1555 SY		
Offsite 2,0" SP-95 asphalt - virgin asphalt	1297	SY	FDOT standard mix	1346 SY		1655 SY		
Offsite signage and striping			included	included		included		
Type F curb						455 LF		
Type A curb at ADA ramp	70	LF	included	included		72 LF		
4" concrete sidewalk /fiber mesh	1161	SF	included	included	included	201 SY		
Handicap ramp	6	EA	included	included		6 each		
Sod - Bahia - ROW	750	SY	included	750 SY		2150 SY		
add/deduct for virgin asphalt			No	included	included	included		
Drainage			\$722,221.00	\$715,069	\$730,133	\$650,157		
Connect to Existing Structure			included	included	included			
Connect to Existing 42" and 54" RCP			included	included		HP for 42"???		
2" Forcemain				included		included		
roof drain connections	7	each	included	included	included	included		
storm cleanout	4	each	included	included	included	included		
4" PVC storm						70 LF		
10" storm PVC - to roof drain connection	244	LF	included	244 LF	included	247 LF		
29x45 ERCP	63	LF	215 lf	63 LF	included	63 LF		
12" storm	58	LF	included	included	included	56 LF - RCP		
18" RCP	2110	LF	included	2110 LF	included	2113 LF - RCP		
42" RCP	64	LF	included	63 LF	included	64 LF - RCP		
54" RCP	80	LF	included	76 LF	included	77 LF - RCP		
18" MES	8	EA	included	included	included	included		
42" MES	1	EA	included	included	included	included		
54" MES	1	EA	included	included	included	included		
29x45 MEP	1	EA	included	included		included		
Rip Rap installation			included	included	included	included		
storm manhole type J	1	EA	included	included	included	included		
Type D inlet			included	1 each	included	2 each		
type E inlet			included	1 each	included	1 each		
type F inlet			included	17 each	included	16 each		
storm drain testing			included	included		included		
dewatering for storm			included	No		\$24,725		
pending accepted VE - HP to RCP for drainage						(\$116,014)		
Sanitary Sewer Service			\$116,352.00	\$179,389	\$178,773	\$128,613		

Connect to Existing 12" sanitary line			included	included	included	included	
sanitary service line (6" sanitary piping)	28	lf	included	included	included	24 LF	
8" sanitary piping and fittings	881	lf	included	881 LF	included	881 LF	
sanitary manholes	4	ea	included	included	included	included	
SS inflow protectors	4	ea	included	included	included	included	
6" PVC terminal cleanout	1	ea	included		included	included	
dewatering for pipe installation			included	No		included	
Water Service			\$176,364.00	\$173,688	\$297,638	\$168,597	
Connect to existing water main	2	EA	included	included		included	
6" PVC piping	1118	LF	included	1118 LF	included	1156 LF	
3" PVC piping	123	lf	included	123 LF	included	121 LF	
3" RPZ backflow preventer assembly	1	ea	included	included	included	included	
3" gate valve	2	EA	included	2 each	included	2 each	
6" gate valve	7	EA	5 each	7 each	included	5 each	
fire hydrant assembly/relocate fire hydrant assembly	3	EA	included	included	included	included	
temp blow off assembly			included			included	
Pressure test and chlorination			included	included	included	included	
Fire Service			\$36,288.00	\$40,553	in above	\$34,550	
6" PVC piping	131	lf	included	131 LF	included	130 LF	
6" stainless steel in-building riser, stubbed up - none shown (budgeted)	1	EA	included	included	included	included	
6" DDCVA/RPDA	1	EA	included	included	included	included	
Temporary blow off assembly	1	EA	included	included	included	included	
Pressure test and chlorination			included	included	included	included	
General						\$168,798	
dust control			included	included	included	included	
remobilize			included	included		included	
construction road - 6" limerock			No	\$11,587		420 sy	
Laydown area - 6" limerock			No	\$191,550		7840 sy	
Bringing water service/sanitary service to trailer/temp water to site			No	in above		included	
dewatering for utility work						\$30,000	
OSP permit and inspecto						included	
schedule				11 months	8 month	10 months	
TOTAL ADJUSTED BID			\$4,718,648	\$4,169,123	\$3,637,215	\$3,247,897	
utilize HP ilo RCP deduct						(\$116,014)	
utilize recycled asphalt ilo virgin asphalt main paving deduct						(\$73,839)	
utilize recycled asphalt ilo virgin asphalt ROW deduct						(\$16,550)	
sur charge the site - bring in fill							

Project: Hernando Tax Collector
 Bid Date: 01/22/24

Bid Package #32B Fencing and Gates



Subcontractor/Vendor Phone # Contact			Smith Fence updated Ryan Swisher - 727-600-0080	Cardinal Fence Lion Fence Brad Hankin - /27/ 655-9757	Fine Tune Enterprises No Bid Ryan	American Fence No Bid	Big Dog Fence Co. No Bid Alan L	Good Neighbor Fence No Bid Paul Shook
Bid Amount			\$63,595	\$71,183				
Addendum and RFIs								
Bond Premium								
Furnish and Installation			included	included				
Q Omega is Basis of Design			Omega	Omega				
dumpster enclosure fence and gates			included	included				
break patio fence			included	included				
6' decorative groove wire fence - black finish	335	lf	included	included				
4'w x 6' h decorative v groove wire swing gates - standard fork latch and hinges	3	ea	included	included				
12'w x 6' h decorative v groove wire double swing gates - standard drop rod and hinges	1	ea	included	included				
18'w x 6'h decorative v groove wire double swing gates - standard drop rod and hinges	1	ea	included	included				
24'w x 8' h decorative v groove wire v-track gate	1	ea	included	included				
8'w x 6' h decorative v groove wire panels, 2.5" line posts, 3" corner/end posts, gate posts in concrete footings			included	included				
v track			included	included				
gate operator			included	included				
gooseneck post			included	included				
photo eye			included	included				
inground safety and free exit loop detectors			included	included				
operation testing			included	included				
access control with (2) barrier arms with one operator			\$31,058.00	included				
TOTAL ADJUSTED BID			\$94,653	\$71,183				

Project: Hernando Tax Collector
 Bid Date: 01/22/24

Bid Package #32D - Landscape and Irrigation



Subcontractor/Vendor			Capital Maintenance & Landscaping	Landscape Pros	Millenium	United Landscape	Sunshine Landscapes
Phone #			need revised	revised per addendum	late	No Bid	No Bid
Contact			Amber Stulley - 352-544-0402	Ian Miller - 813-982-1820	James Slayton - 813-920-8041	Mark Derry - 904-829-9255	Robert Brooks - 813-470-0979
Bid Amount			\$117,227	\$207,383	\$220,882		
Addendum and RFIs							
Bond Premium							
REVISED PER RFI REPOSES TO 55 AND 56			No	yes			
Furnish and install			included	included	included		
bid form			No	Yes			
sioux crape myrtle	42		included	included	included		
yuma crape myrtle	8		included	included	included		
acoma crape myrtle	27		included	included	included		
live oak	42		included	included	included		
tibouchina	3		included	included	included		
american elm	11		included	included	included		
varigated ginger	15		included	included	included		
simpson stopper	20		included	included	included		
hibiscus	47		included	included	included		
queen emma crinum lily	15		included	included	included		
podocarpus	560		included	included	included		
sweet viburnum	31		included	included	included		
agapanthus	130		included	included	included		
juniper	45		included	included	included		
white fountain grass	108		included	included	included		
fountain grass	38		included	included	included		
spartina	73		included	included	included		
coontie palm	12		included	included	included		
soil test			included	included	included		
irrigation/well allowance			\$40,000.00	included	included		
sleeving				included	included		
pine bark mulch			included	included	included		
bahia sod			\$9,800	included	included		
St Augustine sod			\$2,400	included	included		
maintenance based on 30 day LS maintenance during end of construction			\$6,500	included	included		
misc sod			\$10,000	included	included		
TOTAL ADJUSTED BID			\$185,927	\$207,383	\$220,882		

Project: Hernando Tax Collector
 Bid Date: 01/22/24

Bid Package #32H - Site Furnishings



Subcontractor/Vendor Phone # Contact			Streamline new Jamie Reid - 407- 416-2882	Watkins new Kim Phillips - 352- 777-4105	Dero Bike Racks No Bid Chad Clark - 651- 789-4217	Edwards Concrete No Bid Zach Fielder - 407- 656-2139	Playmore West No Bid Daniel Hoop - 239- 791-2400	Premier Structural No Bid Matthew Weaver - 813-914-7998
Bid Amount			\$121,630	\$89,130				
Addendum and RFIs								
Bond Premium								
Furnish and install bid form			included yes	included No				
landscape form benches - 117" backless bench	1	ea	included	included				
landscape form benches - 87" backless bench	7	ea	included	included				
Twig concrete backless bench	7	ea	included	included				
Twig concrete backed benches	in above	ea	included	included				
Charlie picnic table	1	ea	included	included				
Bola bike rack	1	ea	included	included				
36 gallon side opening chase park litter	1	ea	4	included				
TOTAL ADJUSTED BID			\$121,630	\$89,130				

SECTION

1



Summary of Work





CPPI

construction management | design build | general contracting

Summary of Work

New construction and Site Development of a freestanding tilt-up 15,718sf Tax Collector's Office, DMV Driver Test Course, and (3) construction pads for future site development. Building will include a large lobby, reception, tag storage, photo booths for driver's license issuance and a training room.

Site work includes 4 retention ponds, site lighting, underground utilities, and a parking lot for 134 vehicles that ties into the East end of the Florida Department of Health's parking lot and into the ROW to tie into Forest Oaks Blvd. All dirt fill for building pads to be excavated from the ponds onsite.



GMP Price Summary -

To include Construction Authorization & Tax Savings



pckge	Description	Total Amount
1	PROGRAM AREA:	
2	03A STRUCTURAL CONCRETE & STAIR CONCRETE	840,570
3	04A MASONRY	21,890
4	05A STRUCTURAL & MISCELLANEOUS STEEL	455,500
5	06D DOOR AND HARDWARE INSTALLATION	10,831
6	07A CAULKING & WATERPROOFING	66,000
7	07B ROOFING	336,800
8	08A FRAMES, DOORS & HARDWARE	69,455
9	08B WINDOWS & GLAZING	369,762
10	08C OVERHEAD COILING DOORS	15,746
11	09A DRYWALL, FRAMING, INSULATION	416,105
12	09B STUCCO	11,273
13	09C ACOUSTICAL CEILINGS	159,380
14	09D PAINTING	96,180
15	09E FLOORING	217,754
16	10A TOILET ACCESSORIES	86,589
17	10B SIGNAGE	79,528
18	10E CANOPIES and SUNSHADES	573,260
19	11B APPLIANCES	11,500
20	12A MILLWORK	238,303
21	12C WINDOW TREATMENTS	48,054
22	12E SITE FURNISHINGS	525,120
23	21A FIRE SUPPRESSION SYSTEM	78,200
24	22A PLUMBING	539,575
25	23A HVAC	699,310
26	26A ELECTRICAL AND LOW VOLTAGE	1,476,870
27	31A EARTHWORK, PAVING & SITE UTILITIES	899,902
28	31AA PAVING	1,452,092
29	31B SITE UTILITIES - DRAINAGE	564,143
30	31C SITE UTILITIES - SANITARY	128,613
31	31D SITE UTILITIES - WATER	203,147
32	32B FENCING & GATES	71,183
33	32C PAVERS	39,706
34	32D LANDSCAPE AND IRRIGATION	207,383
35	99C SURVEYING, CLEANING,FORKLIFT,YARD LIGHTS, TEMP.POLE,OPENINGS PROTECTION ALLOWANCE,BUILDING START UP,STORAGE CONTAINERS,DUMPSTER,MATERIAL TESTING	149,181

Estimate Totals

Description	Amount	Totals	Rate
subtotal cost of work	11,158,905	11,158,905	
staffing	845,232		
general requirements Is	179,324		
Permit Fee Allowance	45,000		
construction contingency	334,767		3.000 %
sdi insurance	148,631		1.350 %
contract bond	85,522		
general liability	71,523		5.260 \$ / 1,000
builder's risk quote	38,472		
subtotal ins, bonding	1,748,471	12,907,376	
cm fee	613,100		4.750 %
Precon fee	77,000		
subtotal	690,100	13,597,476	
Total		13,597,476	

SECTION

3



Scope Clarifications and Assumptions





CPPI

construction management | design build | general contracting

February 05, 2024

Hernando County Board of County Commissioners West Tax Collector Building Spring Hill, Florida

100% GMP Revision 1

QUALIFICATIONS & CLARIFICATIONS

Documents

The budget estimate for the Hernando County West Tax Collector Building in Spring Hill Florida is based on the 100% construction documents dated 12/20/2023, as prepared by Straughn Trout Architects and on the landscape and irrigation plans dated January 22, 2024 in response to RFIs 55 and 56.

Div. 01 General Qualifications:

1. Pricing includes a 3% contingency on total construction cost of work.
2. Performance and Payment Bond is included.
3. General Liability Insurance is included.
4. Subcontractor Default Insurance (SDI) insurance is included in lieu of providing subcontractor payment and performance bonds.
5. Builder's Risk is by CPPI. The deductibles including named storm deductibles are by Owner.
6. We have included an allowance of \$45,000 for building permit fee. All impact and utility fees are excluded and are assumed to be carried by the Owner.
7. It is assumed all utility company charges for new services, connections, meters and transformers are by owner and are not included.
8. We have included an allowance of \$30,000 for material testing.
9. Davis Bacon wages and reporting are excluded.

Div. 02 Existing Conditions Qualifications:

1. We have assumed that all excavated materials will be reused and are clean, non-reportable soils.
2. We have not included any premium costs associated with the handling or disposal of regulated and/or contaminated soils.
3. We have not included deep foundations or soil improvements.

Div. 03 Concrete and Masonry Qualifications:

1. We have included CMU block at prime ID sign per AS drawings. No other CMU is shown on plans and therefore not included.



CPPI

construction management | design build | general contracting

2. We have included Modular Brick size, 2-1/2" high x 8" long, in specified two color blend and with smooth texture. Norman Brick size, as discussed with Maschmeyer, is not available.
3. We have included the accepted alternate add for porosity inhibiting concrete admixture.

Div. 06 Wood and Plastics Qualifications:

1. Interior brick veneer accent walls at reception back wall and surround of interior side of entry doors is included as shown on interior elevations.

Div. 07 Thermal and Moisture Protection Qualifications:

1. We have not included any fireproofing/intumescent paint.
2. We have included Vandex super white crystalline waterproofing over concrete tilt panels.
3. We have included peel and stick membrane on sheathing at exterior stucco walls at clerestory.
4. We have included tilt panel joint sealants at both sides of tilt panels.
5. We have included Soprema PVC roofing as equal to the ASTM requirements of the specifications.

Div. 08 Openings Qualifications:

1. Exterior storefront system by Kawneer Trifab VG 451 or equal is included. Includes Kawneer 350 or equal medium stile exterior entrance doors. Finish is class 1 clear anodized.
2. We have included (1) Stanley Dura-Storm 2000 bi-parting exterior level D impact auto sliding door system with clear class 1 anodized finish.
3. We have included Stanley Dura-Glide 2000 single, all glass sliding door system with clear class 1 anodized finish.
4. We have not included fire rated glazing. None are shown on plans.
5. Interior bullet proof security window by Hamilton is included.
6. We have included vinyl privacy film on doors 121 and 125.

Div. 09 Finishes Qualifications:

1. We have included level 4 wall finish.
2. We have included 5/8" Durock for walls receiving wall tile or stone.
3. Acoustical wall panels are not included in our proposal. None are shown on plans.
4. We have included stucco finish at clerestory behind ladder and above continuous clerestory glazing.
5. We have included stucco finish at exterior monument signs as shown on AS drawing sheets.
6. We have included Sto synthetic stucco system at ceiling of break patio per RFI response.
7. We have not included moisture mitigation.



CPPI

construction management | design build | general contracting

Div. 10 Specialties Qualifications:

1. We have included toilet accessories as manufactured by ASI or equal.
2. We have included ceiling hung toilet compartments as manufactured by ASI accurate or equal partitions.
3. We have included (1) one 50' high and (2) 40' high flagpoles as shown on AS drawing sheets.
4. We have included exterior canopies with a 2 coat Kynar finish with a 10-year warranty per accepted add alternate.
5. Canopy 2 beams run full length East to West. Deck will run North to South due to 20'-0" span.
6. We have included stainless steel door kick plates for wood doors per accepted alternate.
7. We have included signage at both sides of prime ID monument sign.
8. We have included signage at one side for secondary, E1, E2, E3, and E4 monument signs as shown on AS103.

Div. 11 Equipment Qualifications:

1. We have included (2) refrigerators at breakroom.
2. We have included (1) ice machine.

Div. 12 Furnishings Qualifications:

1. The window treatments are included by Draper.
2. We have included an allowance of \$435,990 for interior furniture per STA's proposal.
3. Pricing includes site furnishings and benches as listed in specification.

Div. 21 Fire Protection Qualifications:

1. Code compliant system per NFPA 13, 25 and local authorities having jurisdiction is included throughout new buildings.
2. The budget assumes adequate water pressure and flow are present on the site.
3. No dry pipe or specialty fire protection systems are anticipated or included.

Div. 22 Plumbing Qualifications:

1. We have included 1-1/2" fiberglass insulation in lieu of Armaflex per accepted value engineering.

Div. 23 HVAC Qualifications:

1. We have included test and balance.
2. We have included mechanical equipment and controls by Trane.



CPPI

construction management | design build | general contracting

3. We have included commissioning assistance.

Div. 26 Electrical and Low Voltage Qualifications:

1. We have not included removal or relocation of existing light poles.
2. We have not included site light fixture, pole, wiring, conduit, and controls as per ES102 schedule. To be by Withlacoochee River Electric Cooperative Inc.
3. We have included an allowance of \$38,150 for (1) 5" conduit for UG primary service entrance for 800 LF to road. Size of conduit is not shown on plans.
4. We have included (2) 2" conduits at 800' from the road to the MDF for low voltage service coming in to the property.
5. We have included \$14,475 for the innerduct for the low voltage service entrance conduits for 800'. Conduit sizes are not shown on plans.
6. We have included \$13,950 for power/circuitry for flush valve sensors. Includes (1) 20amp circuit breaker per restroom, (1) 120-48/dc transformer and low voltage wiring to each fixture.
7. We have included \$13,495 for single point connection for motorized window shades. Includes (18) junction boxes for window treatments, 120 v to each spread across (4) circuits.
8. We have included \$6,975 for a single point connection at 3 automatic door locations. Includes 120v and 20amp breaker.
9. We have not included any concrete encasements. None are shown on plans.
10. We have included utility transformer pad. Utility transformer by Withlacoochee River Electric Cooperative Inc.
11. We have not included emergency power. None are shown on plans.
12. We have included non-voice fire alarm system per FA 101.
13. We have included DAS testing. DAS rough-in and DAS system are not included.
14. We have included Samsung Pro series 98" Class QLED 4K Q80C, QN98Q80CAFXZA.
15. We have not included third party testing for NETA.
16. CT meter assumed to be provided by WREC per "summary and check list for new commercial account."
17. We have not included network hardware, switches, etc. Assumed to be by Owner's vendor.
18. We have not included sound systems. None are shown on the plans.

Div. 31 Sitework Qualifications:

1. We have assumed the project has a balanced site per civil engineer, and therefore we have not included imported fill. Pricing assumes all cut material is suitable for structural fill.
2. Removal and/or replacement of unsuitable soils, hazardous or buried debris is not included.
3. We have not included any muck removal from existing retention areas. We have assumed that all ponds can be disked.
4. There is no bypass pumping included for the sanitary manhole connection offsite. For the duration of this item, we have assumed that the upstream adjacent manhole can be temporarily plugged and pumped down using a vac truck. We have not received flow rates at time of bid.



CPPI

construction management | design build | general contracting

5. We have included installation of new silt fence along the Eastern most perimeter of the site. There is no silt fence shown along the perimeter wall.
6. Location, exploration and/or repairs to existing utilities are not included. As-builts of existing utilities are not included.
7. Opening trenches for fire marshal to inspect existing fire lines, if required, is not included.
8. We have excluded turtle relocation. To be by owner.
9. We have included HP pipe in lieu of RCP for drainage piping per accepted value engineering.
10. We have included recycled asphalt in lieu of virgin asphalt at main property per accepted value engineering.
11. Includes MOT for duration of county road improvements only.

Hernando Tax Collector Building

Alternates and Value Engineering Rev 1



February 05, 2024

Item	Description	Add or Deduct	Accepted	Rejected
1	Porosity Inhibiting Concrete Admixture	\$30,727	\$30,727	
2	Enhanced Roofing Warranty	\$64,654		\$64,654
3	Enhanced Exterior Glazing	\$107,951		\$107,951
4	ASSA Albloy sliding doors ilo Stanley	(\$12,734)		(\$12,734)
5	2 Coat Kynar finish with 10 year warranty for canopies	\$79,382	\$79,382	
6	Fiberglass insulation in lieu of Armaflex at plumbing piping.	(\$15,000)	(\$15,000)	
7	Standard plumbing fixture package in lieu of specified package	(\$45,000)		(\$45,000)
8	Parking lot pole cameras	\$24,753		\$24,753
9	To utilize HP pipe in lieu of RCP for drainage system	(\$116,014)	(\$116,014)	
10	To utilize recycled asphalt in lieu of virgin at main property	(\$73,839)	(\$73,839)	
11	To utilize recycled asphalt in lieu of virgin at ROW paving	(\$16,550)		(\$16,550)
12	Use Carrier Equipmet & Delta Controls ilo Trane	(\$67,848)		(\$67,848)
13	Stainless steel kickplates on both sides of wood doors	\$10,846	\$10,846	
14	Painted concrete canopy columns in lieu of polished	(\$41,400)		(\$41,400)
Total		(\$70,072)	(\$83,898)	\$13,826

SECTION

4



Detailed Estimate



pckge	Description	Takeoff Quantity	Sub Cost/Unit	Sub Amount	Total Amount
	PROGRAM AREA:				
03A	STRUCTURAL CONCRETE & STAIR CONCRETE				
	concrete/tilt panel/form liner/thin brick	1.00 ls	813,005.00 /ls	813,005	813,005
	porosity inhibiting concrete admixture add	1.00 ls	27,565.00 /ls	27,565	27,565
	03A STRUCTURAL CONCRETE & STAIR CONCRETE		/SF	840,570	840,570
04A	MASONRY				
	CMU at exterior signage	1.00 ls	10,100.00 /ls	10,100	10,100
	Exterior Brick at exterior prime ID sign	1.00 ls	11,790.00 /ls	11,790	11,790
	04A MASONRY		/SF	21,890	21,890
05A	STRUCTURAL & MISCELLANEOUS STEEL				
	Structural Steel	1.00 ls	455,500.00 /ls	455,500	455,500
	05A STRUCTURAL & MISCELLANEOUS STEEL		/SF	455,500	455,500
06D	DOOR AND HARDWARE INSTALLATION				
	Install Doors and Hardware	1.00 LS	10,831.00 /LS	10,831	10,831
	06D DOOR AND HARDWARE INSTALLATION		/sf	10,831	10,831
07A	CAULKING & WATERPROOFING				
	caulking and waterproofing (including Vandex)	1.00 ls	66,000.00 /ls	66,000	66,000
	07A CAULKING & WATERPROOFING		/SF	66,000	66,000
07B	ROOFING				
	Roof system - Soprema PVC	1.00 LS	336,800.00 /LS	336,800	336,800
	07B ROOFING		/SF	336,800	336,800
08A	FRAMES, DOORS & HARDWARE				
	Doors, Frames, Hardware (Furnish)	1.00 ls	69,455.00 /ls	69,455	69,455
	08A FRAMES, DOORS & HARDWARE		/SF	69,455	69,455
08B	WINDOWS & GLAZING				
	Exterior Glass and Glazing	1.00 LS	325,998.00 /LS	325,998	325,998
	Automatic Sliding Doors - 3 each - Stanley	1.00 LS	42,612.00 /LS	42,612	42,612
	vinyl privacy film - on int. sliding doors	1.00 LS	1,152.00 /LS	1,152	1,152
	08B WINDOWS & GLAZING		/SF	369,762	369,762
08C	OVERHEAD COILING DOORS				
	Overhead Door at Tag Storage - interior	1.00 ls	15,746.00 /ls	15,746	15,746
	08C OVERHEAD COILING DOORS	77,514.00 SF	0.20 /SF	15,746	15,746
09A	DRYWALL, FRAMING, INSULATION				
	drywall, framing, insulation, blocking	1.00 ls	416,105.00 /ls	416,105	416,105
	09A DRYWALL, FRAMING, INSULATION		/SF	416,105	416,105
09B	STUCCO				
	Stucco - clerestory	1.00 ls	3,860.00 /ls	3,860	3,860
	Stucco - signage	1.00 ls	2,565.00 /ls	2,565	2,565
	Stucco - break patio ceiling	1.00 ls	4,848.00 /ls	4,848	4,848
	09B STUCCO		/SF	11,273	11,273
09C	ACOUSTICAL CEILINGS				
	acoustical ceilings	1.00 ls	159,380.00 /ls	159,380	159,380
	09C ACOUSTICAL CEILINGS		/SF	159,380	159,380
09D	PAINTING				
	Painting	1.00 LS	49,980.00 /LS	49,980	49,980
	Polish on concrete columns	1.00 ls	46,200.00 /ls	46,200	46,200
	09D PAINTING		/SF	96,180	96,180
09E	FLOORING				
	Flooring/tile	1.00 ls	188,727.00 /ls	188,727	188,727
	walk off mats	1.00 ls	13,950.00 /ls	13,950	13,950
	Interior stone veneer	1.00 ls	15,077.00 /ls	15,077	15,077
	09E FLOORING		/SF	217,754	217,754
10A	TOILET ACCESSORIES				

pckge	Description	Takeoff Quantity	Sub Cost/Unit	Sub Amount	Total Amount
10A	TOILET ACCESSORIES				
	Specialties	1.00 LS	38,585.00 /LS	38,585	38,585
	Flag Poles - 3 each	1.00 ls	38,274.00 /ls	38,274	38,274
	add for SS door kick plates for wood doors	1.00 ls	9,730.00 /ls	9,730	9,730
	10A TOILET ACCESSORIES		/SF	86,589	86,589
10B	SIGNAGE				
	interior and exterior signage	1.00 ls	79,528.00 /ls	79,528	79,528
	10B SIGNAGE		/SF	79,528	79,528
10E	CANOPIES and SUNSHADES				
	Canopies/sunshades	1.00 ls	502,048.00 /ls	502,048	502,048
	add alternate for 2 coat kynar finish with 10 year warranty	1.00 ls	71,212.00 /ls	71,212	71,212
	10E CANOPIES and SUNSHADES		/sf	573,260	573,260
11B	APPLIANCES				
	Refrigerators Samsung RF28R7351	2.00 ls	3,500.00 /ls	7,000	7,000
	Ice Machine Manitowoc IRT0500A	1.00 ls	4,500.00 /ls	4,500	4,500
	11B APPLIANCES		/SF	11,500	11,500
12A	MILLWORK				
	millwork	1.00 ls	225,784.00 /ls	225,784	225,784
	Moss wall at back of reception	1.00 ls	12,519.00 /ls	12,519	12,519
	12A MILLWORK		/SF	238,303	238,303
12C	WINDOW TREATMENTS				
	Window Treatments	1.00 ls	48,054.00 /ls	48,054	48,054
	12C WINDOW TREATMENTS		/SF	48,054	48,054
12E	SITE FURNISHINGS				
	Site Furnishings, Bike Racks	1.00 ls	89,130.00 /ls	89,130	89,130
	Interior Furniture Allowance	1.00 allow	435,990.00 /allow	435,990	435,990
	12E SITE FURNISHINGS		/sf	525,120	525,120
21A	FIRE SUPRESSION SYSTEM				
	Fire sprinkler system	1.00 LS	78,200.00 /LS	78,200	78,200
	21A FIRE SUPRESSION SYSTEM		/SF	78,200	78,200
22A	PLUMBING				
	Plumbing	1.00 ls	539,575.00 /ls	539,575	539,575
	22A PLUMBING		/SF	539,575	539,575
23A	HVAC				
	Mechanical - Trane Equip and Controls	1.00 ls	699,310.00 /ls	699,310	699,310
	23A HVAC		/SF	699,310	699,310
26A	ELECTRICAL AND LOW VOLTAGE				
	Electrical and Low Voltage	1.00 ls	1,476,870.00 /ls	1,476,870	1,476,870
	26A ELECTRICAL AND LOW VOLTAGE		/SF	1,476,870	1,476,870
31A	EARTHWORK, PAVING & SITE UTILITIES				
	Mobilization, EC, traffic control, layout, as-builts, demo	1.00 ls	394,261.00 /ls	394,261	394,261
	Earthwork, grading on site/off site	1.00 ls	410,682.00 /ls	410,682	410,682
	Temp access roads (& removal), temp utilities, laydown	1.00 ls	168,798.00 /ls	168,798	168,798
	deduct alternate recycled asphalt ilo virgin at main prop.	(1.00) ls	73,839.00 /ls	(73,839)	(73,839)
	31A EARTHWORK, PAVING & SITE UTILITIES		/SF	899,902	899,902
31AA	PAVING				
	ON site asphalt paving, concrete	1.00 ls	1,139,828.00 /ls	1,139,828	1,139,828
	OFF site asphalt paving, concrete	1.00 ls	312,264.00 /ls	312,264	312,264
	31AA PAVING		/SF	1,452,092	1,452,092
31B	SITE UTILITIES - DRAINAGE				
	Drainage	1.00 ls	650,157.00 /ls	650,157	650,157
	Dewatering for utility work	1.00 ls	30,000.00 /ls	30,000	30,000
	deduct alternate for HP pipe ilo RCP for drainage	(1.00) ls	116,014.00 /ls	(116,014)	(116,014)

pckge	Description	Takeoff Quantity	Sub Cost/Unit	Sub Amount	Total Amount
	31B SITE UTILITIES - DRAINAGE		/SF	564,143	564,143
31C	SITE UTILITIES - SANITARY				
	Sanitary	1.00 I	128,613.00 /I	128,613	128,613
	31C SITE UTILITIES - SANITARY		/SF	128,613	128,613
31D	SITE UTILITIES - WATER				
	Water service	1.00 Is	168,597.00 /Is	168,597	168,597
	fire service	1.00 Is	34,550.00 /Is	34,550	34,550
	31D SITE UTILITIES - WATER		/SF	203,147	203,147
32B	FENCING & GATES				
	Fencing and gates and barrier arm	1.00 Is	71,183.00 /Is	71,183	71,183
	32B FENCING & GATES		/SF	71,183	71,183
32C	PAVERS				
	Pavers at test drive parking/entry/patio	1.00 Is	39,706.00 /Is	39,706	39,706
	32C PAVERS		/SF	39,706	39,706
32D	LANDSCAPE AND IRRIGATION				
	Landscaping and Irrigation	1.00 Is	207,383.00 /Is	207,383	207,383
	32D LANDSCAPE AND IRRIGATION		/SF	207,383	207,383
99C					
	Surveying	1.00 Is	56,595.00 /Is	56,595	56,595
	Rough and Final Cleaning	1.00 Is	6,025.00 /Is	6,025	6,025
	General Use Forklift	1.00 Is	10,272.00 /Is	10,272	10,272
	Yard Lights & Temp Pole	1.00 Is	7,000.00 /Is	7,000	7,000
	Openings Protection Allowance	1.00 Is	6,000.00 /Is	6,000	6,000
	Building Start Up	1.00 Is	10,000.00 /Is	10,000	10,000
	Storage Containers Allowance	1.00 allow	5,500.00 /allow	5,500	5,500
	Dumpster	1.00 Is	17,789.00 /Is	17,789	17,789
	Material testing allowance	1.00 allow	30,000.00 /allow	30,000	30,000
	99C			149,181	149,181
	PROGRAM AREA:	15,625.00 SF	714.17 /SF	11,158,905	11,158,905

Estimate Totals

Description	Amount	Totals	Rate
subtotal cost of work		11,158,905	
staffing	845,232		
general requirements ls	179,324		
Permit Fee Allowance	45,000		
construction contingency	334,767		3.000 %
sdi insurance	148,631		1.350 %
contract bond	85,522		
general liability	71,523		5.260 \$ / 1,000
builder's risk quote	38,472		
subtotal ins, bonding	1,748,471	12,907,376	
cm fee	613,100		4.750 %
Precon fee	77,000		
subtotal	690,100	13,597,476	
Total		13,597,476	

SECTION

5



Bid Tabulations and Recommendations



Project: Hernando Tax Collector
 Bid Date: 01/22/24

Bid Package #01E - Surveying



Subcontractor/Vendor Phone # Contact	Ferguson updated Scott Acker	American Layout updated	Geopoint Surveying No Bid Vernon Horne	Astra Surveying No Bid Eric Amos	John B. Webb & Assoc. No Bid Jacqueline Webb	Pura Vida Engineering No Bid Mustafa Syed
Bid Amount		\$56,595				
Addendum and RFIs 1-33						
Bond Premium						
furnish and install	included	included				
construction layout survey - infrastructure	\$37,525	included				
as built survey	\$27,025	included				
construction layout survey - building/canopy	\$5,775	included				
construction layout survey - electric, light poles, dumpster pad	\$5,225	included				
foundation tie in survey	\$2,850	included				
optional - earthwork/utilities	\$10,425	included				
optional - FEMA elevation certificate	\$2,450	included				
optional - final survey	\$5,950	included				
TOTAL ADJUSTED BID	\$97,225	\$56,595				

Project: Hernando Tax Collector
 Bid Date: 01/22/24

Bid Package #01F - Final Clean



Subcontractor/Vendor Phone # Contact		Fine Tune <i>new</i>	DNS Const.- Magic Touch <i>new</i>	Millenium <i>new</i> Dell Holley	Americas Finest <i>new</i>	Spartan <i>updated</i> Jon Spengler	Spectra <i>updated</i>
Bid Amount		\$10,930	\$5,725	\$3,525	\$65,261	\$15,550	\$12,150
Addendum and RFIs 1-33							
Bond Premium							
Furnish and Install							
final clean			included	included	included	included	included
interior and exterior windows			included	included	included	included	included
exterior clerestory			included	included	included	included	included
pressure washing			No	included	included	included	included
lift			\$1,500	\$2,500	included	included	included
TOTAL ADJUSTED BID		\$10,930	\$7,225	\$6,025	\$65,261	\$15,550	\$12,150

Project: Hernando Tax Collector
 Bid Date: 01/22/24

Bid Package #03A - Concrete/Tilt Panel



Subcontractor/Vendor Phone # Contact	BNG Construction updated - erry Hoinsworth - 407-688-1747 ext 212	Hoopers Concrete & Block updated Shantanu Adsul - 719-799-8098	OLP new Alexis Farinas - 321-438-6658	VMG No Bid Eric Martinez - 407-676-2384	Acclaim Saervice Gro9up No Bid Brent Jones - 727- 848-3200	Green Construction No Bid Carsen Stefanelli - 352-6658-0180	Liberty Concrete & Foaming No Bid Jerry Johnson - 407-864-2325
Bid Amount	\$773,745	\$830,461	\$895,887				
Addendum and RFIs 1-33							
Bond Premium							
Furnish and Install	included	included	included				
foundations	included	included	included				
SOG concrete	included	included	included				
tilt up panels	included	included	included				
cast in place - at 21 columns wrap - at canopy	included	included	included				
termite treatment	included	included	included				
form liner and thin brick (Norman size, smooth texture, 2 color blend - 3,186 sf)	Modular acceptable	Modular	Modular				
dumpster pad and apron, transformer pad, MEP pads	\$36,760	included	included				
(15) bollards - installation (6 at dumpster, 3 at rear of building, 1 at slide gate, 4 at course access arm)	in above	included -at dumpsters	for dumpster only				
5 bollards - Bullard Bollard at front entry	\$2,500	No	No				
concrete for flagpoles - 3 each	in above	No	No				
concrete foundations for (6) monument signs	in above	\$31,686	included				
canopy foundations	included	included	included				
backfill	included	\$38,000	included				
100% casting beds	included	included	included				
TOTAL ADJUSTED BID	\$813,005	\$900,147	\$895,887				

Project: Hernando Tax Collector
 Bid Date: 01/22/24

Bid Package #04A - CMU and Exterior Brick



Subcontractor/Vendor		Stonewall	Mid FL	CL Florida Walls	VMG	Exterior Finish	Green Construction
Phone #		masonry	masonry/brick at signage only	brick only	No Bid	No Bid	No Bid
Contact		Eric Guzman - 407-688-1747		Manuel Quilli	Eric Martinez - 407-676-2384	Juan Ciro	Carsen Stefanelli - 352-6658-0180
Bid Amount		\$10,100	\$97,100	\$109,283			
Addendum and RFIs 1-33							
Bond Premium							
Furnish and Install		included	included	included			
CMU at (6) monument signs	6 each	included	included	included			
brick at masonry primary ID sign	1 each - 115 sf	\$11,790	included	included			
interior stone veneer at reception and lobby entry surround		in div 09	in div 09	in div o9			
TOTAL ADJUSTED BID		\$21,890	\$97,100	\$109,283			

Project: Hernando Tax Collector
 Bid Date: 01/22/24

Bid Package #05A - Structural Steel



Subcontractor/Vendor Phone # Contact	East Coast Metal Structures updated Estimating - 561-766-2579	Industrial Steel LLC updated Gary Hood - 321-267-2341	Morrow Steel Fabricators updated Chad Morrow - 813-715-0404	Trinity Fab new Jake Westfall - 904- 652-4310	Allstate No Bid Cody James - 904-694-0661	United Steel No Bid Mike Growe
Bid Amount	\$504,090	\$609,700	\$455,937	\$450,000		
RFI responses			included			
Bond Premium			2%			
Furnish and Install	included	included	included	included		
structural steel columns	included	included	included	included		
steel W Beams	included	included	included	included		
steel channel beams	included		included	included		
Steel base plates, cap plates, connections	included	included	included	included		
Horizontal steel tubes/connections - including sunshade supports	included	included	included	included		
steel framing at sunshade extensions	included		included	included		
steel joists, bridging	included	included	included	included		
metal decking	included	included	included	included		
South entry framing with outriggers per S511 details 5, 6 and 7	included	included	included	included		
Diagonal bracing per S511 details 8, 9 and 12	included	included	included	included		
Angle braces for joist 1/S511	included	included	included	included		
Angle braces and joist reinforcing for cloud support	included	included	included	included		
Perimeter bent plate	included	included	included	included		
Perimeter angle	included	included	included	included		
restroom partition and screen support framing - 10/S-513	included	included	included	included		
HSS support at clerestory	included	included	included	included		
HSS braces at South canopy 1/S513	included	included	included	included		
roof hatch support angle low roof	included	included	included	included		
steel angle frames for exhaust fan and RTUs	included	included	none shown or required	included		
interior roof access ladder per A101 - finish as specified	included	included	\$5,500	\$5,500		
steel HSS post per 11/A806 - shop prime	included	included	included	included		
roof drain/overflow frain angle frames	included		included	included		
Furnish	included	included	included	included		
steel bollards	15 each		included	included		
anchor bolts for structural steel	included	included	included	included		
embeds for structural steel	included	included	included	included		
steel - 6/S513	included	included	included	included		
TOTAL ADJUSTED BID	\$504,090	\$609,700	\$461,437	\$455,500		

Project: Hernando Tax Collector
 Bid Date: 01/22/24

Bid Package #06A - Door Install



Subcontractor/Vendor Phone # Contact		Mills & Nebraska David Bridges - 863-226-4235	Shelmar new Shelley Roth - 813-892-3829	Silver Meteor Installation No Bid Bridge Pulsifer -	Redey Door Specialits No Bid Rudolf Brunathm- 941-545-3039
Bid Amount		\$8,525	\$7,031		
Addendum and RFIs 1-33					
Bond Premium					
installation		included	included		
door types A, B, C, D, E, F, G		included	included		
hardware		included	included		
temp door protection	19 each	\$3,800	\$3,800		
TOTAL ADJUSTED BID		\$12,325	\$10,831		

Project: Hernando Tax Collector
 Bid Date: 01/22/24

Bid Package #07A - Caulking/Waterproofing



Subcontractor/Vendor	ABG Caulking Contractors updated - as specified Kenny Mayberry - 407-846-6868	Midstate Caulking & Construction Serv. updated as specified Amber Nguon - 407-530-5775	General Caulking new Iampa Estimating - 813-769-9617	Jamestown Painting updated Wayne Abbott - 813-328-3192	Above All Caulking No Bid Jim Kontos - 727-573-9771	Paramount Painting & Services No Bid Chris Page - 813-715-9699
Bid Amount			\$26,300			
Addendum and RFIs 1-33						
Bond Premium						
furnish and install	included	included	included	included		
caulk of exterior joints at tilt wall	\$24,000	\$34,395	included	\$18,610		
exterior perimeter, slab to building interior and slb control joints	\$10,000	in above	included	No		
WP - membrane on sheathing under stucco - at clerestory	\$10,000	\$3,410	No	No		
WP - waterproofing over concrete tilt panels - Vandex as BOD	\$22,000	\$52,475	No	No		
TOTAL ADJUSTED BID	\$66,000	\$90,280	\$26,300	\$18,610		

Project: Hernando Tax Collector
 Bid Date: 01/22/24

Bid Package #07AB - Roofing



Subcontractor/Vendor Phone # Contact	Atlas-Apex Roofing No Bid Daniel Neely - 954-565-1567	Baker Roofing No Bid Estimating - 919-828-2975	P & A Roofing & Sheet Metal updated Ryan Upchurch - 866- 650-9541	Keeler Roofing No Bid Ben Keeler - 352- 514-4930	SpringerPeterson Roofing No Bid Heather Harris - 863- 665-1163
Bid Amount			\$329,000		
Addendum and RFIs 1-33					
Bond Premium					
furnish and install			included		
tapered insulation			included		
60 mil TPO system			included		
warranty			included		
walkway treads			included		
pipe boots			included		
sheet metal flashing and trim			included		
wood blocking for coping cap			\$7,800		
PVC - Durolast is BOD			Soprema PVC		
TOTAL ADJUSTED BID			\$336,800		

Project: Hernando Tax Collector
 Bid Date: 01/22/24

Bid Package #08A - Doors, Frames, Hardware



Subcontractor/Vendor Phone # Contact		Taylor Cotton <i>new</i> Dennis Hoffman - 352-746-3134	AG Mauro <i>new</i> Mark Carpenter - 407-333-0500	Mills & Nebraska <i>new</i> David Bridges - 863- 226-4235	Door & Hardware Opening <i>No Bid</i> Luis Rodriguez - 813- 679-0310	Allegion Access Technologies <i>No Bid</i> Don Hunt - 941-706-1248
Bid Amount		\$93,624	\$69,455	\$69,951		
RFIs included			yes			
Bond Premium						
Furnish		included	included	included		
Bid Form		Yes	Yes	Yes		
hollow metal frame - HM9	1		included	included		
hollow metal frames - HM10 and HM11	4		included	included		
hollow metal borrowed lite frames	21		included	included		
hollow metal doors	11		included	included		
factory primed wood doors	19		included	included		
hardware			included	included		
TOTAL ADJUSTED BID		\$93,624	\$69,455	\$69,951		

Project: Hernando Tax Collector
 Bid Date: 01/22/24

Bid Package #08B - Glazing



Subcontractor/Vendor Phone # Contact			Countryside Glass & Mirror updated Bernie Hill - 727-953-6145	Heritage Glass new Joan Hicks - 941-244-9225	Lake Glass new Beau Burkett - 352-787-4700	Diamond Glass new Joseph Paschitti - 239-482-7587	City Glass new Patrnck Johnson - 727-522-9453	Bay Glass & Window No Bid Paula Holmes - 239- 464-9331
Bid Amount			\$429,100	\$339,000	\$348,290	\$294,481	\$349,995	
Addendum and RFIs 1-33								
Bond Premium								
Furnish and Install			included	YKK	Kawneer	Kawneer		
Bid Form			included	yes	No	No		
Exterior Storefront - clear anodized, non impact			included	included	included	included	included	
SF101	1	ea	included	included	included	included	included	
SF102	1	ea	included	included	included	2	included	
SF103	1	ea	included	included	included	included	included	
SF104	1	ea	included	included	included	included	included	
SF105 - with perforated aluminum panels	1	ea	included	included	included	included	included	
SF106 - with perforated aluminum panels	1	ea	included	included	included	included	included	
SF107	1	ea	included	included	included	included	included	
SF108	1	ea	included	included	included	included	included	
SF109	4	ea	included	included	included	included	included	
SF110	5	ea	included	included	included	included	included	
SF111	1	ea	included	included	included	included	included	
SF112	1	ea	included	included	included	included	included	
SF113	1	ea	included	included	included	included	included	
SF114	1	ea	included	included	included	included	included	
SF115	3	ea	included	included	included	included	included	
SF116	1	ea	included	included	included	included	included	
SF117	1	ea	included	included	included	included	included	
Glazing SFC01 through SFC18 (SFC03 spandrel)	18	ea	included	included	included	included	included	
Exterior Storefront doors			included	included	included	included	included	
110C			included	included	included	included	included	
137			included	included	included	included	included	
149			included	included	included	included	included	
159			included	included	included	included	included	
Interior Storefront			included	included	included	included	included	
SF118	2	ea	included	included	included	included	included	
SF119	1	ea	included	included	included	included	included	
SF120	1	ea	included	included	included	included	included	
SF121	1	ea	included	included	included	included	included	
SF122	2	ea	included	included	included	included	included	
SF123	1	ea	included	included	included	included	included	
SF124	1	ea	included	included	included	included	included	
Q no fire rated glazing								
Interior storefront doors: 104, 126, 136, 140, 141, 148			included	included	included	included	included	
Hollow metal glazing			included	included	included	included	included	
HM9	1	ea	included	included	included	included	included	
HM10	2	ea	included	included	included	included	included	
HM11	2	ea	included	included	included	included	included	
exterior security window (window does not have a florida product approval and will require a hurricane shutter) - has non impact			included	\$18,197	included	\$18,197	\$11,000	
Q hurrucane shutter allowance			\$10,000	Not required w/ window	\$10,000	Not required w/ window	\$10,000	
break metal wrapping exterior tube steel at clerestory windows per detail A-511			included	included	included	included		
sill flashing per A-604			included	included	included	included		
blue max protection add				included	\$24,000	\$13,320		
vinyl privacy film allowance			\$1,152	\$1,152	\$1,152	\$1,152	\$1,152	
TOTAL ADJUSTED BID			\$440,252	\$358,349	\$383,442	\$327,150	\$372,147	

Project: Hernando Tax Collector
 Bid Date: 01/22/24

Bid Package #08D - Overhead door



Subcontractor/Vendor		D&D Garage Drs.	OH Door Co of Tampa Bay		
Phone #		813-486-2537			
Contact		Anthony Judt - 813-224-0123	Steve Livingston		
Bid Amount					
Addendum and RFIs 1-33					
Bond Premium					
Furnish and Install		included	included		
15' x 9' oh door at tag storage		\$19,750	\$15,746		
TOTAL ADJUSTED BID		\$19,750	\$15,746		

Project: Hernando Tax Collector
 Bid Date: 01/22/24

Bid Package #09A - Drywall, Framing



Subcontractor/Vendor Phone # Contact	MB Drywall Solutions updated Dale Hadley - 413- 313-6962	Comerstone new Shane Wright - 727- 540-0277	Drywall Elements new Greg Coulombe - 407-454-7293	Bay Area Drywall new Jose Garcia - 813-967-5620	Kenpat USA No Bid Phil Klote - 407-464-7070	South A Drywall No Bid Chris O'Brien - 321-806-7115	Sunliving Construction No Bid Dennis French 317- 987-3666
Bid Amount	\$416,105	\$469,300	\$780,670	\$489,067			
Addendum and RFIs 1-33							
Bond Premium							
Furnish and Install	included	included	included	included			
metal framing per wall types	included	included	included	included			
rigid insulation	included	included	included	included			
R-11 insulation	included	included	4625	included			
R-19 insulation	included	included	included	included			
deflection track	included	included	included	included			
acoustical caulk	included	included	included	included			
fire caulk at smoke walls - foot and head of wall	included	included	included	included			
drywall	included	included	included	included			
durock	included	included	included	included			
hat channels with isilation clips	included	included	included	included			
Clerestory framing including all plywood and vapor barrier	included	included	included	included			
soffits, floating soffits (cable), cove soffit	included	included	included	included			
bulkheads, radius bulkheads	included	included	included	included			
bulkhead soffit at overhead door	included	included	included	included			
Durock at restrooms, mop sinks and lobby areas	included	included	included	included			
framing for window shades	included	included	included	included			
drywall ceilings	included	included	included	included			
box beams	included	included	included	included			
backing	included	included	included	included			
frame out recesssed FEC cabinets	included	included	included	included			
break metal where wall meets galss at clerestory - 598/A-102	included	included	included	included			
install interior hollow metal frames	included	included	included	included			
wood bucks at interior window frames	included	included	included	included			
projector mount framing and blocking	included	included	included	included			
drywall reveals at lobby areas	included	included	included	included			
all FRT plywood at data room	included	included	included	included			
furnish and install general access panels at restroom drywall ceilings	included	included	included	included			
level 4 finish	included	included	included	included			
parapet blocking at clerestory	included	included	\$8,915	included			
fry reglet - at moss wall	included	included	included	included			
lift rental	included	included	included	included			
TOTAL ADJUSTED BID	\$416,105	\$469,300	\$794,210	\$489,067			

Project: Hernando Tax Collector
 Bid Date: 01/22/24

Bid Package #09B - Stucco



Subcontractor/Vendor Phone # Contact			Central Florida Construction Walls new Manuel Quilli - 407-250-3653	Cornerstone new Shane Wright - 727-540-0277	Midstate Caulking & Construction updated Amber Nguon - 407-530-5775	MB Drywall Solutions No Bid Dale Hadley - 413-313-6962	Florida Stucco Contractors No Bid Cobe Maldonado - 863-904-9435	Exterior Finish Plastering No Bid Juan Ciro - 352 369-9510
Bid Amount				\$29,250	\$13,435			
Addendum and RFIs 1-33								
Bond Premium								
Furnish and Install			included	included	included			
7/8" painted stucco on galvanized wire lath at high roof clerestory - stucco behind the ladder and above the continuous clerestory glazing.	400	sf	\$3,860	included	included			
stucco on exterior monument signs (prime ID, secondary, E1, E2, E3, and E4 signs) - AS103	6	ea	\$2,565	included	included			
sto (synthetic stucco) ceiling system at 12'-0" on exterior sheathing on cold formed suspension system.	400	sf	\$4,848	included	included			
TOTAL ADJUSTED BID			\$11,273	\$29,250	\$13,435			

Project: Hernando Tax Collector
 Bid Date: 01/22/24

Bid Package #09D - Painting, Coatings, Wallcoverings



Subcontractor/Vendor Phone # Contact		CC Painting late - new Juan Salazar - 813-297-5722	Jamestown Painting updated Bryan Shroyer - 239 785-3893	POD-NC updated Frank Nieves - 813- 355-1338	Percopo Coatings Company, LLC updated Sid Moore - 407-331-3805	Paramount Painting & Services No Bid Chris Page - 813-715-9699	KDB Painting No Bid Dave Black - 813-931-1587	All Coat Painting of Florida No Bid Ronald Hill - 352-484-8739
Bid Amount		\$55,320	\$45,945	\$39,980	\$77,757			
Addendum and RFIs 1-33								
Bond Premium								
Furnish and Install		included	included	included	included			
GWB walls		included	included	included	included			
GWB ceilings and soffits		included	included	included	included			
HM doors and frames		included	included	included	included			
exterior tilt panel		included	included	\$11,500	included			
polished concrete canopy columns	21 each	\$46,200	\$46,200	\$46,200	\$46,200			
pipe bollards	15 each	included	included	\$700	included			
sealed concrete floors		included	\$4,035	included	included			
prep and protection		included	included	included	included			
paint stucco at exterior monument signs	6 each	included	included	\$1,300	included			
lifts		included	included	included	included			
note - wood doors are prefinished								
TOTAL ADJUSTED BID		\$101,520	\$96,180	\$99,680	\$123,957			

Project: Hernando Tax Collector
 Bid Date: 01/22/24

Bid Package #09C - Acoustical Ceilings



Subcontractor/Vendor Phone # Contact		Hanlon Acoustical Ceilings updated Mathew Wright - 813- 930-0023	L&D ceilings new Sean Alling - 352-377-4112	Drywall Elements new Alan Bureau - 407- 454-7293	Acouti Engineering Co. No Bid Jason Saladino - 813-620-0718	Real Ceilings in Tampa No Bid Kevin De Maille - 813-837-8181	AAA Ceiling No Bid Estimating - 407- 928-3830
Bid Amount		\$159,380	\$262,497	\$206,695			
Addendum and RFIs							
Bond Premium							
Furnish and install		included	included	included			
ACT-1 - armstrong Optima 3254 2x2 white with white grid	9468	included	included	included			
ACT-2 - armstrong Calla 1x2 2824 Black with black grid	746	included	included	included			
ACT-3 4x4 armstrong 3256 white with white grid	1928	included	included	included			
4" and 6" axiom outside corner edge		included		included			
4" and 6" armstrong axiom classic straight trim, white		included		included			
TOTAL ADJUSTED BID		\$159,380	\$262,497	\$206,695			

Project: Hernando Tax Collector
 Bid Date: 01/22/24

Bid Package 10A - Specialties



Subcontractor/Vendor Phone #			Watkins new Kim Phillips - 352-777-4105	Streamline new Jamie Reed - 407-416-2882	McLeod General updated Connor McDonald - 352-215-2431	Interior Specialties new Brittany Biggs - 407-539-1303	Gren Wall Scapes new moss wall	Florida Specialty Products No Bid Scott Pratt - 321-765-4975	Square 10 Source No Bid Jeremy Line - 813-425-5868
Bid Amount				\$47,764	\$88,000		\$12,519		
Addendum and RFIs 1-33									
Bond Premium									
furnish and install			included	included	included	ASI	included		
Accessories			\$11,540	included	included	\$14,257			
framed mirror 18 x 36	5	ea	included	included	included	24x36			
36" grab bar	5	ea	included	included	included	included			
42" grab bar	5	ea	included	included	included	included			
wall mount toilet tissue disp	9	ea	included	included	included	included			
wall mount sanitary disp	7	ea	included	included	included	included			
recessed fold down baby changing station	5	ea	included	included	included	included			
recessed waste receptacle and paper towel comb	11	ea	included	included	included	included			
framed mirror 60x36	5	ea	included	included	included	included			
recessed seat cover disp	9	ea	included	included	included	8			
mop and broom holder	1	ea	included	included	included	included			
install owner furnished paper towel dispense	1	ea	included	included	included	included			
toilet compartments			\$18,100	included	included	\$33,942			
ceiling mounted compartments with 55" doors and panels	8	ea	included	included	included	included			
ceiling mounted phenolic 48" urinal screen	4	ea	included	included	included	included			
FEC			\$2,070	included	included	\$3,812			
semi recessed non rated FEC	4	ea	included	included	included	included			
10lb multi purpose FE	4	ea	included	included	included	included			
Corner Guards			included	included	included	included			
SS flush corner guards	9	ea	\$6,875	included	included	\$9,358			
tax			included	included	included	included			
stainless steel door kick plates for wood doors - both sides	19	ea	\$9,730	\$9,730	\$9,730	\$9,730			
TOTAL ADJUSTED BID			\$48,315	\$57,494	\$97,730	\$71,099			

Project: Hernando Tax Collector
 Bid Date: 01/22/24

Bid Package #09E - Flooring/09F - Tiling



Subcontractor/Vendor Phone #			Flooring Solutions new	Spectra updated	Morales Flooring new - no tile	Bay Area Comm new	AJ Flooring No Bid	Hudson Everly No Bid	Olson Contract Floors No Bid
Contact			Thomas Zentmeyer 813-882-8382	Andy Evans - 813-242-9879	Kimberly Connell - 813-933-7100	Jatuania Hatcher - 727-249-2061	Lucia Martinez - 407- 614-8286	Paul Ritten - 407- 405-3916	Mark Etting - 352-243-0266
Bid Amount			\$187,227	\$237,026	\$120,111	\$230,860			
Addendum and RFls 1-33									
Bond Premium									
Furnish and install			included	included	included	included			
Carpet Tile-CPT-1 Interface Third Space			771	819	included	807			
LVT-1 Interface Northern Grain			7158	7535	included	7212			
4" vinyl cove base-RB-1 Tarket Reveal 6"			2010	2635	included	1920			
RB-2- standard			360	400	included	240			
moisture testing			included		included	included			
flooring transitions			included		included	included			
minor floor prep			included	included - 640	included	included - 4420			
CT-1 Crossville Moonstruck 12x24 UPS finish			1175	1288	\$98,386	1164			
CT-2 Crossville Moonstruck 12x24 Honed finish			900	1009	included	947			
CT-3 GS Season 3x12 wall tile - Petrolio			367	349	included	779			
CT-4 Crossville Retroactive 4x12 wall tile royal navy			525	170	included	186			
CT-5 GS Forma 12x24 mica matte			1600	1692	included	1586			
trim associated with tiling/bullnose			included	included	included	included			
waterproofing membrane at tile			included	included	included	included			
moisture mitigation at carpet and vinyl flooring			No	No	No	No			
floor protection			\$1,500	included - 1500	\$1,500	\$1,500			
walk off mat - 6x6	3 each		\$13,950	\$13,950	\$13,950	\$13,950			
interior brick venter - A-801 - at North reception wall and at exterior side of SF101 entrance slider doors	200	sf	\$15,077	\$15,077	\$15,077	\$15,077			
TOTAL ADJUSTED BID			\$217,754	\$266,053	\$249,024	\$261,387			

Project: Hernando Tax Collector
 Bid Date: 01/22/24

Bid Package 10B - Signage



Subcontractor/Vendor Phone #			Mid FL new	Vital Signs of Orlando updated	White Sign new	Architectural Identification No Bid	ASI Signage Innovations No Bid	JSI Signage No Bid
Contact			Tom Rudd - 352-787-3882	Gary Stephens - 407-297-0680	Jacob Pippin - 386 - 320-0623	Trent Eckfeld - 727-639-0250	Noel Westman - 727-742-9480	Kimberly James - 813-693-1609
Bid Amount			\$69,528	\$99,998	\$104,189			
Addendum and RFIs 1-33								
Bond Premium								
Furnish and install			included	included	included			
INTERIOR			included	included	included			
room ID signage			included	included	included			
restroom/with symbol			included	included	included			
exit signage/Tactile exit signs			included	included	included			
life safety/EVAC signage			included	included	included			
testing room signage			included	included	included			
36" diameter - LOGO			included	included	included			
cast aluminum letters - WELCOME			included	included				
EXTERIOR			included	included	included			
monument prime ID sign (10/AS103) - double sided , internally illuminated aluminum entrance monument sign	1	ea	included	included	(\$4,000)			
monument secondary ID sign (7/AS103) - single sided , internally illuminated aluminum entry sign	1	ea	included	included	included			
monument TAX COLLECTOR sign E1 (AS103) - single sided , internally illuminated aluminum monument sign	1	ea	included	included	included			
monument TAX COLLECTOR SIGN E2 (AS103) single sided internally illuminated aluminum monument sign	1	ea	included	included	included			
monument TAX COLLECTOR SIGN E3 (AS103) single sided internally illuminated aluminum monument sign	1	ea	included	included	included			
monument TAX COLLECTOR SIGN E4 (AS103) single sided internally illuminated aluminum monument sign	1	ea	included	included	included			
16"x 10" Aluminum panel sign - at concrete column (12/AS103)	6	ea	included	included	included			
Drivers testing parking (2 and 3 /AS103) - reserved for testing applied to aluminum canopy	6	ea	included	included	included			
18" Aluminum lettering - South elevation: TAX COLLECTOR	1	ea	included	included	included			
40" high cast aluminum dedication plaque	1	ea	included	included	included			
misc signage			\$10,000	included	included			
TOTAL ADJUSTED BID			\$79,528	\$99,998	\$100,189			

Project: Hernando Tax Collector
 Bid Date: 01/22/24

Bid Package 10E - Canopy



Subcontractor/Vendor Phone #			Awning Factory updated	Perfection new	Peachtree new - Logan Asniey - did the canopy at Lake Alfred - CA finish - 770-779- 9410	Awning Factor No Bid	Seco South No Bid	Logsdon and Associates No Bid	Architectural Metals of SW No Bid	Mitchell Metals No Bid
Contact			Maggie Mankarious	O. Delgado - 407-671-6225		Maggie Mankarious - 407- 460-1526	Jose irizarry - 727-536-1924	Ryan Logsdon - 407-466-4009	Andrew Sass - 239-334-7433	Sebastian Medina - 770-882-2647
Bid Amount			\$1,010,000	\$598,265	\$502,048					
Addendum and RFIs 1-33										
Bond Premium										
Furnish and install - see page A-301			included	included	included					
aluminum canopy- note 1090 - 3, 4, 5 and 6 on East and North sides of building with fascia and integral cantilevered soffit deck by Mapes	4	ea	included	included	included					
Canopy 1A at South entry	1	ea	included	included	included					
Canopy 1B at South entry	1	ea	included	included	included					
Canopy 2 at test parking	3790	sf	included	included	included					
aluminum canopy columns	21	ea	included	included	included					
Sunshades note 1029 - bracket mounted	4	ea	included	included	included					
sunshades with airofoil blades - at clerestory - steel supported(in steel)	1727	sf	included	included	included					
6x6 columns at west canopy per S-502 detail 1	21	ea	included	included	included					
Q	clear anodized - 5 year warranty		included	included	included - like Lake Alfred per photos					
Q	2 coat Kynar - 10 year warranty				\$71,212					
Q					canopy 2 - beams run full length E to W - deck will run N to S due to span					
TOTAL ADJUSTED BID			\$1,010,000	\$598,265	\$573,260					

Project: Hernando Tax Collector
 Bid Date: 01/22/24

Bid Package 10H- Aluminum Flagpoles



Subcontractor/Vendor Phone # Contact			Head Flags new Tony Clayton - 813- 636-0701	Flagpoles Etc new Danielle Bass	Global Flags need update Belinda Moses - 800-962-0956	Watkins new Kim Phillips - 352-777-4105	McLeod General Trades No Bid Connor McDonald - 352-215-2431	Square 10 Source No Bid Stacey Gimson - 813-425-2323
Bid Amount			\$38,274	\$39,190	\$41,551	\$42,965		
RFIs								
Bond Premium								
Furnish and install			included	included	included	included		
bid form			yes	included	No	No		
40' flagpole as shown on plan notes and diagrams	2	ea	included	included	70	included		
50' flagpole as shown on plan notes and diagrams	1	ea	included	included		included		
external halyards			included	included	included	included		
flagpole stamped drawings						\$590		
flagpole engineered footing drawings						\$725		
TOTAL ADJUSTED BID			\$38,274	\$39,190	\$41,551	\$44,280		

Project: Hernando Tax Collector
 Bid Date: 01/22/24

Bid Package 11G - Projection Screens



Subcontractor/Vendor Phone # Contact		Interior Specialties No Bid Brittany Biggs -	Watkins Kim Phillips - 352-777-4105	Contract Décor No Bid Penny Wartler - 760-343-4444	Division 10 Sales No Bid Catie Hamrick - 704-644-5913	Florida Visual Display No Bid Tim Woodward - 727-9*44-4901	McLeod General No Bid Connor McDonald - 352-215-2431
Bid Amount							
Addendum and RFIs 1-33							
Bond Premium							
Furnish and install							
recessed ceiling mounted projection screen - stewart cascade HMT3 screen size 76H x 136 wide, matte white screen, white housing - training room			\$20,050				
TOTAL ADJUSTED BID		\$0	\$20,050	\$0	\$0	\$0	\$0

Project: Hernando Tax Collector
 Bid Date: 01/22/24

Bid Package 12A - Casework



Subcontractor/Vendor Phone # Contact			D & R Cabinetry and Millwork updated Evan Yaros - 407-8547-4008	Kabinets by Kinsey new Chuck Kinsey- 813-222-0460	Home Pride new Jeremy Gray - 731-793-0372	Star Quality new Joel Torres - 813- 875-9955	OEC Interiors new reception only	Crystal Clear Cabinetry No Bid Todd Fleming - 912-600-7044
Bid Amount			\$239,900	\$219,434	\$193,874	\$205,400	\$46,678	
Addendum and RFIs 1-33								
Bond Premium								
Furnish and Install			included	included	included	included		
Reception deck at lobby 101, solid surface, wall cladding, Plam knee wall/cabinets, lockable - M1			included	included	included	included		
Back wall at reception 102 - solidsurface, plam- M1A and M1B			included	included	included	included		
Lobby Walls, entry low wall and columns cover, wall cap, plam knee wall cover, reveals - M2	4	ea	included	included	included	included		
plastic laminate ceiling cloud/reception wall panel on plywood - M4, M4A - allowance provided until receive details - 252 sf laminate system - page A-212	157	sf	\$30,000	included	No	\$30,000		
Moss wall at reception 102 back wall - plam wall panels above countertop up to ceiling on side walls and soffit above			included	included	\$9,500	included		
bench and counter at lobby 101, solidsurface counter and waterfalls, plam bench - M3	2	ea	included	3500 allowance for fabric	included	included		
planter at lobby 101 - solidsurface wall wrap and top - M12	2	ea	included	included	included	included		
Clerk stations at 117 - SS counter, plam cabinets - M4	2	ea	included	included	included	included		
Testing 116 - plam counter/splash, plam dividers, concealed brackets - M6			included	included	included	included		
Drive up teller 116 - SS counter, plam cabinets - M7			included	included	included	included		
Q deal drawer by owner at drive up teller			with window	with window	with window	included		
quiet room 135 - ss counter, plam cabinets/apron with access panel - M8			included	included	included	included		
break room 136 - ss counter, plam cabinets - M9 (dining counter is FF&E)			included	included in FF&E	included	included		
breakroom waste bin			\$2,500	included	\$2,500	included		
3rd party vendor 110 - ss counter, plam cabinets, gate - M10			included	included	included	included		
CWL testing stations 111 - plam counter/splash, plam dividers, concealed brackets - M11			included	included	included	included		
foot bar rail at reception desk knee spaces and drive up window			included	\$6,350	included	included		
ss window sill at exterior storefront windows			No	included	included	included		
millwork (Plam) gate - 102A, 102B, and 143			included	included	\$7,500	included		
maple stained with lacquer cap at photo booth - A-806			included	included	included	included		
cloud wire			included	included	included	included		
lift			included	included	included	included		
TOTAL ADJUSTED BID			\$272,400	\$225,784	\$213,374	\$235,400		

Project: Hernando Tax Collector
 Bid Date: 01/22/24

Bid Package 12C - Window Treatment



Subcontractor/Vendor Phone # Contact			Interior Specialties <i>updated</i> Maggie Mckenzie - 407-539-1303	James Blinds <i>updated</i> Estimating - 614-291-4621	Cube Care <i>new</i> susana Kobleddo - 305-556-8700	Florida Contract <i>new</i> Megan Moynieux- 352-682-4018	TBS Construction Specialties <i>No Bid</i> Tim Smith - 813- 632-0657	Above the Sill <i>No Bid</i> Meissa McNally - 941-492-3101
Bid Amount			\$48,054	\$64,628	\$76,361	\$49,424		
Addendum and RFIs 1-33								
Bond Premium								
Furnish and Install			Draper	Draper	Mecho Shades	Hunter Douglas		
manual single roller shades with fascia - at secure interior windows (2) tax collector (2) chief deputy	4	ea	included	included	included	included		
manual single roller shades with closure and mount - training room(4), breakroom (3)	7	ea	included	included	included	included		
motor operated roller shades with single rollers	5	ea	included	included	included	included		
motor, digital timer	12	ea	included	included	included	included		
TOTAL ADJUSTED BID			\$48,054	\$64,628	\$76,361	\$49,424		

Project: Hernando Tax Collector
 Bid Date: 01/22/24

Bid Package #21A - Fire Protection



Subcontractor/Vendor Phone # Contact		Fire Safety Inc. updated David Rose - 407-455-8605	Piper Fire new Chris Johnson - 727-581-9339	Titan Fire new Ray Cole - 727- 408-5306	Brown Automatic Sprinklers No Bid Marty Seles - 813-621-2071	Universal Fire Systems No Bid Steve Shea - 813-662-9200	Cox Fire Protection No Bid Paul Pass - 813-980-3282
Bid Amount		\$105,900	\$80,369	\$78,200			
Addendum and RFIs							
Bond Premium							
Furnish and Install		included	included	included			
bid form		yes	yes	yes			
wet pipe riser complete		included	included	included			
control valve		included	included	included			
tamper switch		included	included	included			
check valve		included	included	included			
maindrain		included	included	included			
flow switch		included	included	included			
elecgric bell		included	included	included			
inspectors test connection		included	included	included			
spare head cabinet		included	included	included			
white semi-recessed pendent sprinkler heads (Brass uprights with exposed decks)	157 each	included	included	included			
automatic air release		included	included	included			
TOTAL ADJUSTED BID		\$105,900	\$80,369	\$78,200			

Project: Hernando Tax Collector
 Bid Date: 01/22/24

Bid Package #22A Plumbing



Subcontractor/Vendor Phone # Contact	Quantity	Unit	American Mechanical Solutions	Feddon Mechanical	Royalair Mechanical	Coastal Mechanical Ser.	Comfort Temp Company	MIELK Mechanical
			updated	updated	updated	No Bid	No Bid	No Bid
			Joshua Merrick - 813-534-0010	Joseph Branton - 813-644-1196	Tommy Thornton - 904-716-5883	Paul McQuain - 321-302-3354	Austin Schrack - 352-575-3040	Estimating - 330- 725-8845
Bid Amount			\$469,511	\$490,325	\$594,300			
Addendum and RFIs 1-33								
Bond Premium								
Finish and install			included	included	included			
supervision			\$45,000	included	included			
sanitary waste and vent piping			included	included	included			
domestic waterpiping - type L and K			included	included	included			
storm piping in lobby/reception shall be cast iron because this area has a return air plenum. All other areas have ducted returns and can be PVC			included	included	included			
insulation with Armaflex			\$15,000	included	included			
excavation and backfill			included	included	included			
plumbing ID			included	included	included			
fire safing			included	included	included			
warranty			included	included	included			
accepted VE - 2-1/2" thick fiberglass insulation ilo armaflex			(\$10,000)	(\$750)	(\$15,000)			
plumbing equipment and fixtures -AS SPECIFIED			\$65,000	\$50,000	included			
WC-1	4	ea	included	included	included			
WC-2	5	ea	included	included	included			
L-1	5	ea	included	included	included			
L-2	4	ea	included	included	included			
U-1	4	ea	included	included	included			
EWC-1	2	ea	included	included	included			
MS-1	2	ea	included	included	included			
S-1	1	ea	included	included	included			
S-2	1	ea	included	included	included			
CP-1	1	ea	included	included	included			
EWH-1 - 20 gal	1	ea	included	included	included			
MV-1	1	ea	included	included	included			
ET	1	ea	included	included	included			
OB-1 ice maker box	1	ea	included	included	included			
trap primers	7	ea	included	included	included			
HB-1	6	ea	included	included	included			
FD-1	5	ea	included	included	6			
FD-2	1	ea	included	included	included			
FS-1	1	ea	included	included	included			
ECO	2	ea	included	included	included			
RD-1	21	ea	included	included	included			
RD-2	3	ea	included	included	included			
DSN	3	ea	included	included	included			
TOTAL ADJUSTED BID			\$584,511	\$539,575	\$579,300			

Project: Hernando Tax Collector
 Bid Date: 01/22/24

Bid Package #23A - HVAC



Subcontractor/Vendor Phone # Contact	Quantity	Unit	American Mechanical Solutions not qualified Joshua Merrick - 813-534-0010	Feddon Mechanical updated Joseph Branton - 813-644-1196	Royalaire Mechanical updated Tommy Thornton - 904-716-5883	Comfort Temp Company updated Mark Houston - 352-376-2366	Jax HVAC not complete Dave Ceyrolles - 352-544-1100	Penninsular new Jason Spears - 727-573-4822
Bid Amount			\$640,811	\$755,545	\$670,800	\$622,395	\$515,175	\$725,500
Addendum and RFIs								
Bond Premium						1.5%	1.5%	
Furnish and Install			included	included	included	included	included	included
Trane (BOD) air cooled condensing units CU 1 and 2	2	ea	Trane	Trane	Carrier	Trane	Trane	Trane
Trane (BOD) DX AHU (assembled in three pieces) - corrosion resistant coils	1	ea	included	included	included	included	included	included
installation of duct mounted smoke detectors (furnish by electrical sub)	1	ea	included	included	included	included	included	included
in line outside air electric pre heat duct heater	1	ea	included	included	included	included	included	included
Trane VAV terminal units with electric heat strips	14	ea	included	included	included	included	included	included
Mitsubishi DX dutless mini split system	1	ea	included	included	included	included	included	included
auxiliary drain pan			included	included	included	included	included	included
exhaust fans interlocked with building management system, controls			\$5,000			\$5,000	\$5,000	
ACR refrigeration copper piping with pipe supports and required external pipe insulation - aluminum jacket for exposed piping			included	included	included	included	included	included
type L copper condensate piping with insulation, pipe supports to nearest floor drain			included	included	included	included	included	included
Greenheck roof mount exhaust fan	1	ea	included	included	included	included	included	included
exterior wall mount outside air louver	1	ea	included	included	included	included	included	included
fire dampers in fire rated walls	5	ea	\$10,000			\$10,000	\$10,000	
Manual volum dampers	30	ea	included	included	included	included	included	included
galv rectangular and round sheet metal ductwork as specified			included	included	included	included	included	included
low pressure round ductwork as specified			included	included	included	included	included	included
air distribution: grilles, registers, diffusers, clerestory, sidewall grilles	112	ea	included	included	included	included	included	included
flexduct and collars for air distribution			included	included	included	included	included	included
DDC controls			included	included	included	included	included	included
mechanical ID			included	included	included	included	included	included
vibration isolation			included	included	included	included	included	included
mechanical insulation			included	included	included	included	included	included
test and balance			\$33,000	included	included	\$33,000	\$33,000	included
equipment rigging and start up			included	included	included	included	included	included
supervision			included	included	included	included	\$45,000	included
fire safing of rated floor and wall partitions			included	included	included	included	included	included
permits and warranty			included	included	included	included	included	included
Trane equipment/controls add			included	included	\$95,620	included	included	included
commissioning assistance			\$5,000	included	included	\$5,000	included	included
storage on site (conex)			\$5,000			\$5,000	included	included
escalation - hold bid for 60 days			\$18,915	included	included	\$18,915	\$18,915	included
TOTAL ADJUSTED BID			\$717,726	\$755,545	\$766,420	\$699,310	\$627,090	\$725,500

Bid Package #26A - Electrical/Low voltage



Subcontractor/Vendor Phone # Contact	Erwin Electric <i>updated</i> Brian E. - 727-466-8566	All Phase <i>new</i> Constantin - 813-876-7074	LEBS <i>new</i> Ian Crom - 954-228-7539	Interbay <i>new</i> Ivan Salazar - 813-875-1886	Borrell <i>new</i> Adrian Keener - 727-692-1841	Elect. Services <i>new</i> Greg Kirk - 352-787-1322
Bid Amount	\$1,352,895	\$1,383,250	\$1,245,500	\$1,613,496	\$1,661,564	\$1,794,000
Addendum and RFIs						
Bond Premium						
Furnish and Install	included	included	included	included	included	included
Electrical	included	included	included	included	included	included
1000 amp switchgear - E-501	included	included	included	included	included	included
feeders E501	included	included	included	included	included	included
EMT conduit with compression fittings per county	included	included	included	included	included	included
Conduit from the utility transformer to the electrical CT cabinet - note 3	included	included	included	included	included	included
Provide and install (2) 2" conduits from the road to the MDF (800'), - low voltage service coming in to property - T051	(2) 2" per owner	-\$4,120.00	\$9,975.00	included	included	
deduct for (2) 2" conduits and inner udcnt in lieu of (2) 4" conduits - 850'		in above	-\$15,250.00			
Innerduct for the low voltage service entrance conduits -page T051 - 800'	allowance	\$15,070.00	\$14,475.00	\$22,000.00	included	included
pad mounted utility transformer - note 1 - (pad w concrete contractor)		No- Lacoochee - provide pad for utility transformer	No- Lacoochee - provide pad for utility transformer	No- Lacoochee - provide pad for utility transformer	No- Lacoochee - provide pad for utility transformer	No- Lacoochee - provide pad for utility transformer
(1) 5" primary UG service entrance - coord termination point - note 2 - included allowance - 800' to the road - includes pull boxes	allowance	\$28,265	\$38,150	\$25,000	included	included
fixtures and lighting controls E-201	included	included	included	included	included	included
floor boxes	included	included	included	included	included	included
walker duct	included	included	included	included	included	included
Cable tray - T101	included	included	included	included	included	included
site lighting - direct burial concrete poles	18 each	No-site lighting - by county per ES102 schedule	No-site lighting - by county per ES102 schedule	No-site lighting - by county per ES102 schedule	No-site lighting - by county per ES102 schedule	No-site lighting - by county per ES102 schedule
receptacles and connections E-101	included	included	included	included	included	included
circuit, connection, disconnecting for electrical equipment E-101	included	included	included	included	included	included
lightning protection E-301	included	included	No	included	included	included
temp power and lighting	\$10,000	included	included	included	included	included
hook up GC trailer	included	included	included	included	included	included
Non voice fire alarm system - FA 101	included	included	included	included	included	included
DAS testing/BDA survey only, no sytem or conduit system	included	correct	included - Dynafire	included	included	included - 100%
plywood backboards	included	included	included	included	included	included
traffic rated hand holes and pull boxes - shown on tech drawings T051	included	included	included	included	included	included
power supply to monument sign lighting/lag pole lighting	included	included	included	included	included	included
power supply to operator and photo eye - v track gate	included	included	included	included	included	included
furnish duct mounted smoke detectors (install by mechanical sub/wiring by FA)	included	included	included	included	included	included
composite clean up	\$10,000	No	included	included	included	included
coordination studies - Infrared inspection 6 months as specified	\$36,000	included	included	46000	included	included
BIM	\$10,000	\$10,000	included	included	included	included
NETA testing	not 3rd party	not 3rd party	not 3rd party	not 3rd party	not 3rd party	not 3rd party
power/circuits for flush valve sensors	\$2,987	\$13,950				
power, breaker size for motorized window shades	\$7,211	\$13,495				
circuitry/power, breaker size for Auto door - single point connections at 3 locations	3 each	\$6,975	\$6,975			
E/101 - electrical at each of the workstations for under floor tranhe/duct system wall in-feed locations		included	included	included	included	included
Low Voltage	included	included	\$256,956	included	included	included
Telecommunications/structured cabling	included - A Tech	included	in above	included	included	included
Access Control - card reader (Enterprise)	included - Minuteman	included - Minuteman	in above	included	included	included
Audio Visual system - including projectors/projector screens	included - A Tech	included	in above	included	included	included
deduct projector and screen		-\$6,503.00	see add for TV below			
CCTV/IP surveillance/Camers per schedule and RFI responses	included - Minuteman	included	in above	included	included	included
LCD TV - Samsung Pro Series	\$8,548	\$1,850				
TVs - Samsung	13 each	A Tech	included	in above	included	included
access control - card readers, audio visual intercoms for v-track gate by gate company - (raceway by electrical)		in gate company	in gate company	in gate company	in gate company	in gate company
TOTAL ADJUSTED BID	\$1,477,328	\$1,476,870	\$1,549,456	\$1,613,496	\$1,661,564	\$1,794,000
parking lot pole cameras - alternate		\$22,205				
site lighting deduct		(\$24,535)				
DPO amount			\$300,000			

Bid Package #31A - Sitework



Subcontractor/Vendor			Raymow	Crisdel	Cook Const.	Burgess	JA Pavers	Cypress Gulf
Phone #			updated	updated	new - need	new	new	No Bid
Contact			James Daugherty - 813-855-8484	Israel Justice - 813-625-5216	Stephen, Michael David	Justin Sylvester - 813-502-3727	Roger Smith - 407-383-1304	Dave Valdez 813-241-6200
Bid Amount							\$39,706	
Addendum and RFIs								
Bond Premium						1.25%		
General Conditions and Erosion Control			\$393,503.00	\$933,111	\$213,400	\$394,261		
Mobilization			included	included	included	included		
MOT			included	included	included	included		
Silt Fence - on and off site			4327 LF	1294 LF	1270 LF	1065 LF		
Inlet Protection			32 each	6 each	4 each	37 each		
construction entrance/wash off pads	1	EA	included	included	included	included		
sod - pond slopes and 2' BOC			115307 sy	14690 sy	No	17290 SY		
seed & mulch			No	17000 sy	No	28198 SY		
survey/layout			included	included	included	included		
Demolition			\$77,145.00	included	\$60,860	included		
Clearing and Grubbing			included	included	included	included		
Remove existing storm pipe	120	LF	118 lf	included	included	81 LF		
remove storm structures						4 each		
remove pressure pipe	240	LF	238 lf	included	included	included		
remove and dispose existing asphalt and base	8149	SF	included	included	included	355 SY		
saw cut pavement						190 LF		
remove curbs						416 LF		
remove and dispose existing chain link fences	870	LF	870 lf	included	included	874 LF		
remove and dispose trees and misc vegetation	15	EA	included	included	included	included		
Scrape sod and top soil, utilize for backfill in nonstructural areas and haul off excess			included	included	included	included - no haul off		
no milling of existing asphalt								
Earthwork			\$708,782.00	\$422,331	\$657,362	\$335,682		
cut site			included	34389 CY	included	included		
disc site				11 acres		12 acres		
import fill - According to the engineers takeoff this is a balanced site								
pond excavation						29285 CY		
proof roll site			included	11 AC		34554 SY		
construct building pad						2080 SY		
place and compact			included	26716 CY		included		
final grading			included	included	included	included		
building pads for future						\$100,000		
Concrete			\$251,936.00	\$339,748	\$339,748	in paving		
type D curb			included	6187 LF	included	5965 LF		
type F curb				807 LF		800 LF		
ribbon curb				680 LF		795 LF		
4" sidewalk with fibermech/thickened edge/WWF			6736 sf	8,828 sf	No	1630 SY		
handicap ramp with domes	17	ea	included	16 each	No	13 each		
concrete flumes			included	26 LF	included	13 SY		
6" steel concrete filled bollards	8	ea	-\$20,000.00	(\$20,000)	No - in steel	No - in steel		
Concrete pavers	3278	sf	(\$33,330)	No	No	(\$25,000)	included	
Asphalt Paving			\$2,289,387.00	\$953,786	\$1,134,576	\$1,102,080		
stabilized subgrade - 12"	17250	SY	included	17073 SY	included	15545 SY		
6" standard duty road base/meroc			included	15301 SY	included	15545 SY		
1.5" SP-95 asphalt - virgin asphalt			included	included	included	15545 SY - one lift		
8" heavy duty road base/meroc			included	included	included	in above		
2,0" SP-95 asphalt - virgin asphalt			included	included	included	in above		
wheel stops						63 each		
signage and striping			included	included	included	included		
second lift asphalt add			included	included	included	\$37,748		
pending accepted VE - FDOT asphalt to virgin (main property)						(\$73,839)		
Off Site Work			in above	\$228,311	included	\$312,264		
demo asphalt and sidewalk			included	included	included	included		
Clear and Grub/Excavate for offsite paving			included	included		included		
saw cut pavement						637 LF		
Offsite 14" road base	1297	SY	included	1346 SY		1555 SY		
Offsite 2,0" SP-95 asphalt - virgin asphalt	1297	SY	FDOT standard mix	1346 SY		1655 SY		
Offsite signage and striping			included	included		included		
Type F curb						455 LF		
Type A curb at ADA ramp	70	LF	included	included		72 LF		
4" concrete sidewalk /fiber mesh	1161	SF	included	included	included	201 SY		
Handicap ramp	6	EA	included	included		6 each		
Sod - Bahia - ROW	750	SY	included	750 SY		2150 SY		
add/deduct for virgin asphalt			No	included	included	included		
Drainage			\$722,221.00	\$715,069	\$730,133	\$650,157		
Connect to Existing Structure			included	included	included			
Connect to Existing 42" and 54" RCP			included	included		HP for 42"???		
2" Forcemain				included		included		
roof drain connections	7	each	included	included	included	included		
storm cleanout	4	each	included	included	included	included		
4" PVC storm						70 LF		
10" storm PVC - to roof drain connection	244	LF	included	244 LF	included	247 LF		
29x45 ERCP	63	LF	215 lf	63 LF	included	63 LF		
12" storm	58	LF	included	included	included	56 LF - RCP		
18" RCP	2110	LF	included	2110 LF	included	2113 LF - RCP		
42" RCP	64	LF	included	63 LF	included	64 LF - RCP		
54" RCP	80	LF	included	76 LF	included	77 LF - RCP		
18" MES	8	EA	included	included	included	included		
42" MES	1	EA	included	included	included	included		
54" MES	1	EA	included	included	included	included		
29x45 MEP	1	EA	included	included		included		
Rip Rap installation			included	included	included	included		
storm manhole type J	1	EA	included	included	included	included		
Type D inlet			included	1 each	included	2 each		
type E inlet			included	1 each	included	1 each		
type F inlet			included	17 each	included	16 each		
storm drain testing			included	included		included		
dewatering for storm			included	No		\$24,725		
pending accepted VE - HP to RCP for drainage						(\$116,014)		
Sanitary Sewer Service			\$116,352.00	\$179,389	\$178,773	\$128,613		

Connect to Existing 12" sanitary line			included	included	included	included	
sanitary service line (6" sanitary piping)	28	lf	included	included	included	24 LF	
8" sanitary piping and fittings	881	lf	included	881 LF	included	881 LF	
sanitary manholes	4	ea	included	included	included	included	
SS inflow protectors	4	ea	included	included	included	included	
6" PVC terminal cleanout	1	ea	included		included	included	
dewatering for pipe installation			included	No		included	
Water Service			\$176,364.00	\$173,688	\$297,638	\$168,597	
Connect to existing water main	2	EA	included	included		included	
6" PVC piping	1118	LF	included	1118 LF	included	1156 LF	
3" PVC piping	123	lf	included	123 LF	included	121 LF	
3" RPZ backflow preventer assembly	1	ea	included	included	included	included	
3" gate valve	2	EA	included	2 each	included	2 each	
6" gate valve	7	EA	5 each	7 each	included	5 each	
fire hydrant assembly/relocate fire hydrant assembly	3	EA	included	included	included	included	
temp blow off assembly			included			included	
Pressure test and chlorination			included	included	included	included	
Fire Service			\$36,288.00	\$40,553	in above	\$34,550	
6" PVC piping	131	lf	included	131 LF	included	130 LF	
6" stainless steel in-building riser, stubbed up - none shown (budgeted)	1	EA	included	included	included	included	
6" DDCVA/RPDA	1	EA	included	included	included	included	
Temporary blow off assembly	1	EA	included	included	included	included	
Pressure test and chlorination			included	included	included	included	
General						\$168,798	
dust control			included	included	included	included	
remobilize			included	included		included	
construction road - 6" limerock			No	\$11,587		420 sy	
Laydown area - 6" limerock			No	\$191,550		7840 sy	
Bringing water service/sanitary service to trailer/temp water to site			No	in above		included	
dewatering for utility work						\$30,000	
OSP permit and inspectio						included	
schedule				11 months	8 month	10 months	
TOTAL ADJUSTED BID			\$4,718,648	\$4,169,123	\$3,637,215	\$3,247,897	
utilize HP ilo RCP deduct						(\$116,014)	
utilize recycled asphalt ilo virgin asphalt main paving deduct						(\$73,839)	
utilize recycled asphalt ilo virgin asphalt ROW deduct						(\$16,550)	
sur charge the site - bring in fill							

Project: Hernando Tax Collector
 Bid Date: 01/22/24

Bid Package #32B Fencing and Gates



Subcontractor/Vendor Phone # Contact			Smith Fence updated Ryan Swisher - 727-600-0080	Cardinal Fence Lion Fence Brad Hankin - /27/ 655-9757	Fine Tune Enterprises No Bid Ryan	American Fence No Bid	Big Dog Fence Co. No Bid Alan L	Good Neighbor Fence No Bid Paul Shook
Bid Amount			\$63,595	\$71,183				
Addendum and RFIs								
Bond Premium								
Furnish and Installation			included	included				
Q Omega is Basis of Design			Omega	Omega				
dumpster enclosure fence and gates			included	included				
break patio fence			included	included				
6' decorative groove wire fence - black finish	335	lf	included	included				
4'w x 6' h decorative v groove wire swing gates - standard fork latch and hinges	3	ea	included	included				
12'w x 6' h decorative v groove wire double swing gates - standard drop rod and hinges	1	ea	included	included				
18'w x 6'h decorative v groove wire double swing gates - standard drop rod and hinges	1	ea	included	included				
24'w x 8' h decorative v groove wire v-track gate	1	ea	included	included				
8'w x 6' h decorative v groove wire panels, 2.5" line posts, 3" corner/end posts, gate posts in concrete footings			included	included				
v track			included	included				
gate operator			included	included				
gooseneck post			included	included				
photo eye			included	included				
inground safety and free exit loop detectors			included	included				
operation testing			included	included				
access control with (2) barrier arms with one operator			\$31,058.00	included				
TOTAL ADJUSTED BID			\$94,653	\$71,183				

Project: Hernando Tax Collector
 Bid Date: 01/22/24

Bid Package #32D - Landscape and Irrigation



Subcontractor/Vendor			Capital Maintenance & Landscaping	Landscape Pros	Millenium	United Landscape	Sunshine Landscapes
Phone #			need revised	revised per addendum	late	No Bid	No Bid
Contact			Amber Stulley - 352-544-0402	Ian Miller - 813-982-1820	James Slayton - 813-920-8041	Mark Derry - 904-829-9255	Robert Brooks - 813-470-0979
Bid Amount			\$117,227	\$207,383	\$220,882		
Addendum and RFIs							
Bond Premium							
REVISED PER RFI REPOSES TO 55 AND 56			No	yes			
Furnish and install			included	included	included		
bid form			No	Yes			
sioux crape myrtle	42		included	included	included		
yuma crape myrtle	8		included	included	included		
acoma crape myrtle	27		included	included	included		
live oak	42		included	included	included		
tibouchina	3		included	included	included		
american elm	11		included	included	included		
varigated ginger	15		included	included	included		
simpson stopper	20		included	included	included		
hibiscus	47		included	included	included		
queen emma crinum lily	15		included	included	included		
podocarpus	560		included	included	included		
sweet viburnum	31		included	included	included		
agapanthus	130		included	included	included		
juniper	45		included	included	included		
white fountain grass	108		included	included	included		
fountain grass	38		included	included	included		
spartina	73		included	included	included		
coontie palm	12		included	included	included		
soil test			included	included	included		
irrigation/well allowance			\$40,000.00	included	included		
sleeving				included	included		
pine bark mulch			included	included	included		
bahia sod			\$9,800	included	included		
St Augustine sod			\$2,400	included	included		
maintenance based on 30 day LS maintenance during end of construction			\$6,500	included	included		
misc sod			\$10,000	included	included		
TOTAL ADJUSTED BID			\$185,927	\$207,383	\$220,882		

Project: Hernando Tax Collector
 Bid Date: 01/22/24

Bid Package #32H - Site Furnishings



Subcontractor/Vendor Phone # Contact			Streamline new Jamie Reid - 407- 416-2882	Watkins new Kim Phillips - 352- 777-4105	Dero Bike Racks No Bid Chad Clark - 651- 789-4217	Edwards Concrete No Bid Zach Fielder - 407- 656-2139	Playmore West No Bid Daniel Hoop - 239- 791-2400	Premier Structural No Bid Matthew Weaver - 813-914-7998
Bid Amount			\$121,630	\$89,130				
Addendum and RFIs								
Bond Premium								
Furnish and install			included	included				
bid form			yes	No				
landscape form benches - 117" backless bench	1	ea	included	included				
landscape form benches - 87" backless bench	7	ea	included	included				
Twig concrete backless bench	7	ea	included	included				
Twig concrete backed benches	in above	ea	included	included				
Charlie picnic table	1	ea	included	included				
Bola bike rack	1	ea	included	included				
36 gallon side opening chase park litter	1	ea	4	included				
TOTAL ADJUSTED BID			\$121,630	\$89,130				

SECTION

6



Preliminary Construction Schedule



Activity ID	Activity Name	Original Duration	Remaining Duration	Activity % complete	Start	Finish	J	F	M	April 2024	May 2024	June 2024	July 2024	A	S	O	N	D	J	F	M	J25	
Total		325	325		02-Jan-24	09-Apr-25	3	0	1	2	2	0	1	1	2	0	1	1	2	3	0	1	2
Project Milestones		253	253		11-Apr-24	09-Apr-25																	
M1000	Notice to Proceed Sitework	0	0	0%	11-Apr-24																		
M1010	Building Dry In	0	0	0%		16-Oct-24																	
M1020	Permanent Power	0	0	0%	20-Dec-24																		
M1030	Project Substantial Completion	0	0	0%		12-Mar-25																	
M1040	Project Completion	0	0	0%		09-Apr-25																	
Design/GMP		118	118		02-Jan-24	14-Jun-24																	
D1090	Pre-Con GMP Due	49	49	0%	02-Jan-24	08-Mar-24																	
D1100	GMP Review and Approval	19	19	0%	11-Mar-24	04-Apr-24																	
D1150	Site Permitting	23	23	0%	11-Mar-24	10-Apr-24																	
D1170	SWFWMD Permitting	23	23	0%	11-Mar-24	10-Apr-24																	
D1180	NPDES Permitting	23	23	0%	11-Mar-24	10-Apr-24																	
D1190	ROW Use Permitting	23	23	0%	11-Mar-24	10-Apr-24																	
D1140	Subcontracting	21	21	0%	05-Apr-24	03-May-24																	
D1160	Building Permitting	23	23	0%	11-Apr-24	13-May-24																	
D1110	Construction NTP	0	0	0%	14-May-24																		
D1200	Utility Easement	23	23	0%	14-May-24	14-Jun-24																	
Submittals/Procurement		180	180		05-Apr-24	19-Dec-24																	
LL1020	Submittal Materials	20	20	0%	05-Apr-24	02-May-24																	
LL1030	Approval	10	10	0%	03-May-24	16-May-24																	
LL1000	Fab & Deliver Switchgear	150	150	0%	17-May-24	19-Dec-24																	
LL1010	Fab & Deliver Transformer	80	80	0%	17-May-24	10-Sep-24																	
LL1040	Fab & Deliver HVAC Equipment	50	50	0%	17-May-24	29-Jul-24																	
LL1050	Fab & Deliver Structural Steel & Joists	40	40	0%	17-May-24	15-Jul-24																	
LL1070	Fab & Deliver Condensing Units	50	50	0%	17-May-24	29-Jul-24																	
Construction		253	253		11-Apr-24	09-Apr-25																	
Site work		222	222		11-Apr-24	25-Feb-25																	
S1000	Mobilization	5	5	0%	11-Apr-24	17-Apr-24																	
S1010	Clear and Grub and Grading	40	40	0%	18-Apr-24	13-Jun-24																	
S1020	Building Pad Survey/Layout	2	2	0%	16-May-24	17-May-24																	
S1030	Excavate/Install/Backfill/Compact Utilities	60	60	0%	24-Jul-24	16-Oct-24																	
S1170	Install Transformer	3	3	0%	11-Sep-24	13-Sep-24																	
S1090	Parking/Roadways	60	60	0%	17-Oct-24	14-Jan-25																	
S1140	Pavers	15	15	0%	15-Jan-25	04-Feb-25																	
S1150	Landscaping & Irrigation	30	30	0%	15-Jan-25	25-Feb-25																	
S1180	Site Lighting	20	20	0%	15-Jan-25	11-Feb-25																	
Foundation/Structure		115	115		20-May-24	30-Oct-24																	
SF100	Foundations	15	15	0%	20-May-24	10-Jun-24																	
SF110	Underground Utilities	20	20	0%	11-Jun-24	09-Jul-24																	
SF140	Slab on Grade	10	10	0%	10-Jul-24	23-Jul-24																	
SF180	FRP Tilt Panels	10	10	0%	24-Jul-24	06-Aug-24																	
SF200	Install Tilt Panels	15	15	0%	07-Aug-24	27-Aug-24																	

Hernando Tax Collector						UFHCL												19-Mar-24 09:57					
Activity ID	Activity Name	Original Duration	Remaining Duration	Activity % Complete	Start	Finish	J	F	M	April 2024	May 2024	June 2024	July 2024	A	S	O	N	D	J	F	M	25	
SF230	Install Structural Steel & Joists & Decking	15	15	0%	28-Aug-24	18-Sep-24																	
SF250	Roofing	10	10	0%	19-Sep-24	02-Oct-24																	
SF290	Exterior Finishes	20	20	0%	19-Sep-24	16-Oct-24																	
SF370	Exterior Windows/Doors/Storefront	20	20	0%	19-Sep-24	16-Oct-24																	
SF360	Canopies	20	20	0%	03-Oct-24	30-Oct-24																	
Interior		131	131		03-Oct-24	09-Apr-25																	
A3000	Overhead MEP Rough In	30	30	0%	03-Oct-24	13-Nov-24																	
A3060	Wall Framing	20	20	0%	03-Oct-24	30-Oct-24																	
A3070	Wall MEP Rough In	25	25	0%	07-Oct-24	08-Nov-24																	
A3120	HTF Drywall	15	15	0%	04-Nov-24	22-Nov-24																	
A4000	Painting	10	10	0%	25-Nov-24	10-Dec-24																	
A4100	Ceilings	15	15	0%	25-Nov-24	17-Dec-24																	
A4150	MEP Trim	15	15	0%	04-Dec-24	24-Dec-24																	
A4080	Ceramic Tile	10	10	0%	11-Dec-24	24-Dec-24																	
A4230	Doors & Hardware	15	15	0%	11-Dec-24	02-Jan-25																	
A4090	Lighting	15	15	0%	18-Dec-24	09-Jan-25																	
A4240	HVAC Startup	5	5	0%	26-Dec-24	02-Jan-25																	
A4120	Millwork	20	20	0%	03-Jan-25	30-Jan-25																	
A4220	Flooring	15	15	0%	03-Jan-25	23-Jan-25																	
A4250	Systems & Specialty Equipment	10	10	0%	10-Jan-25	23-Jan-25																	
A4260	FFE & Owner Move In	10	10	0%	13-Mar-25	26-Mar-25																	
A4270	FFE Tie-In/connections	10	10	0%	27-Mar-25	09-Apr-25																	
Testing & Commissioning		30	30		03-Jan-25	13-Feb-25																	
CX1050	TAB Execution	10	10	0%	03-Jan-25	16-Jan-25																	
CX1030	Building Commissioning	15	15	0%	24-Jan-25	13-Feb-25																	
CX1070	Submit TAB Report	5	5	0%	24-Jan-25	30-Jan-25																	
Closeout		54	54		24-Jan-25	09-Apr-25																	
ZS1000	O&M's	5	5	0%	24-Jan-25	30-Jan-25																	
ZS1010	As-Built Record Drawings	10	10	0%	24-Jan-25	06-Feb-25																	
Z1080	Training	3	3	0%	24-Jan-25	28-Jan-25																	
A4010	Contractor Punch Inspection	5	5	0%	07-Feb-25	13-Feb-25																	
A4020	Contractor Punch Corrections	7	7	0%	14-Feb-25	24-Feb-25																	
A4030	Contractor Final Punch Inspection	2	2	0%	25-Feb-25	26-Feb-25																	
ZS1020	Rough & Final Clean	5	5	0%	25-Feb-25	03-Mar-25																	
A4040	Owner Final Inspection	3	3	0%	27-Feb-25	03-Mar-25																	
A4050	Final Inspection Corrections	5	5	0%	04-Mar-25	10-Mar-25																	
A4060	Certificate of Occupancy Issued	2	2	0%	11-Mar-25	12-Mar-25																	
ZS1080	Demobilization	3	3	0%	11-Mar-25	13-Mar-25																	
ZI9000	End Project	0	0	0%		09-Apr-25																	

█ Actual Work
 █ Critical Remaining Work
 Summary
█ Remaining Work
 ◆ Milestone

SECTION

7



Contract Documents - Drawing List and Specification List



Hernando County -Tax Collector Building

Number	Title	Oct 5, 2023	Dec 20, 2023	Jan 10, 2024	Jan 22, 2024
		Permit Set (Civil)	Permit Set	RFI 3,7,8,9,10,13,14,17,18,25,26,28,29,30	RFI 55 & 56
G-000	COVER SHEET & INDEX		✓		
G-001	BUILDING CODE DATA AND PRODUCT APPROVALS		✓		
G-002	ARCHITECTURAL GRAPHIC SYMBOLS		✓		
G-003	ABBREVIATIONS AND GENERAL NOTES		✓		
G-004	ADAAG STANDARDS		✓		
G-005	ADAAG STANDARDS MANEUVERING CLEARANCES		✓		
C-100	COVER SHEET	✓			
C-101	GENERAL NOTES	✓			
C-102	EXISTING SITE CONDITIONS	✓			
C-103	DEMOLITION	✓			
C-104	EROSION CONTROL (2 OF 2)	✓			
C-200	OVERALL SITE PLAN	✓			
C-201	SITE LAYOUT (1 OF 2)	✓			
C-202	SITE LAYOUT (2 OF 2)	✓			
C-203	SITE PAVEMENT MARKING	✓			
C-204	SITE PAVEMENT MARKING (2 OF 2)	✓			
C-205	AUTO-TURN TEMPLATE	✓			
C-300	OVERALL GRADING PLAN	✓			
C-301	GRADING PLAN (1 OF 2)	✓			
C-302	GRADING PLAN (2 OF 2)	✓			
C-303	POND SECTIONS	✓			
C-304	STORMWATER POLLUTION PREVENTION PLAN	✓			
C-305	DRAINAGE DETAILS	✓			
C-400	WATER	✓			
C-401	UTILITY DETAILS	✓			
C-402	UTILITY DETAILS	✓			
C-500	FOREST OAKS BOULEVARD IMPROVEMENTS (1 OF 3)	✓			

Number	Title	Oct 5, 2023	Dec 20, 2023	Jan 10, 2024	Jan 22, 2024
		Permit Set (Civil)	Permit Set	RFI 3,7,8,9,10,13,14,17,18,25,26,28,29,30	RFI 55 & 56
C-501	FOREST OAKS BOULEVARD IMPROVEMENTS (2 OF 3)	✓			
C-502	FOREST OAKS BOULEVARD IMPROVEMENTS (3 OF 3)	✓			
L-100	LANDSCAPE OVERALL PLANTING PLAN				✓
L-101	LANDSCAPE PLANTING PLAN (1 OF 2)				✓
L-102	LANDSCAPE PLANTING PLAN (2 OF 2)				✓
LS101	LIFE SAFETY PLAN		✓		
S-001	STRUCTURAL ABBREVIATIONS, SYMBOLS, AND SHEET IND		✓		
S-002	STRUCTURAL NOTES		✓		
S-003	STRUCTURAL NOTES		✓		
S-005	COMPONENT& CLADDING WIND LOAD DIAGRAM		✓		
S-101	STRUCTURAL FOUNDATION PLAN		✓		
S-111	STRUCTURAL SLAB PLAN		✓		
S-121	LOW ROOF FRAMING PLAN		✓		
S-201	ENLARGED FRAMING PLANS		✓		
S-301	STRUCTURAL SECTIONS& ELEVATIONS		✓		
S-501	STRUCTURAL DETAILS		✓		
S-502	STRUCTURAL DETAILS		✓		
S-511	STRUCTURAL DETAILS		✓		
S-512	STRUCTURAL DETAILS		✓		
S-513	STRUCTURAL DETAILS		✓		
S-521	STRUCTURAL DETAILS		✓		
S-522	STRUCTURAL DETAILS		✓		
S-523	STRUCTURAL DETAILS		✓		
A-101	ANNOTATION FLOOR PLAN		✓		
A-101D	DIMENSION PLAN		✓		
A-101F	FURNITURE PLAN		✓		
A-102	CLERESTORY PLAN		✓		

Number	Title	Oct 5, 2023	Dec 20, 2023	Jan 10, 2024	Jan 22, 2024
		Permit Set (Civil)	Permit Set	RFI 3,7,8,9,10,13,14,17,18,25,26,28,29,30	RFI 55 & 56
A-131	ENLARGED RESTROOM PLANS& ELEVATIONS		✓		
A-201	REFLECTED CEILING PLAN		✓		
A-210	CEILING DETAILS		✓		
A-211	CEILING DETAILS		✓		
A-212	CEILING DETAILS		✓		
A-301	ROOF PLAN		✓		
A-302	ENLARGED ALUMINUM CANOPY		✓		
A-303	ENLARGED ALUMINUM CANOPY		✓		
A-310	ROOF DETAILS		✓		
A-401	EXTERIOR ELEVATIONS		✓		
A-402	TILT UP PANEL ELEVATIONS		✓		
A-403	TILT UP PANEL ELEVATIONS		✓		
A-404	TILT UP PANEL ELEVATIONS		✓		
A-405	TILT UP PANEL ELEVATIONS		✓		
A-410	BUILDINGS SECTIONS		✓		
A-411	BUILDING SECTIONS		✓		
A-501	WALL SECTIONS		✓		
A-502	WALL SECTIONS		✓		
A-503	WALL SECTIONS		✓		
A-510	WALL TYPES		✓		
A-511	EXTERIOR DETAILS		✓		
A-512	EXTERIOR DETAILS		✓		
A-525	LADDER DETAILS		✓		
A-601	DOOR& WINDOW SCHEDULE, ELEVATIONS,& DETAILS			✓	
A-602	HEAD, JAMB, AND SILL DETAILS		✓		
A-603	HEAD, JAMB, AND SILL DETAILS		✓		
A-604	HEAD JAMB AND SILL DETAILS			✓	

Number	Title	Oct 5, 2023	Dec 20, 2023	Jan 10, 2024	Jan 22, 2024
		Permit Set (Civil)	Permit Set	RFI 3,7,8,9,10,13,14,17,18,25,26,28,29,30	RFI 55 & 56
A-605	STOREFRONT WINDOW ELEVATIONS			✓	
A-606	STOREFRONT WINDOW ELEVATIONS		✓		
A-610	FINISH SCHEDULE& PAINT FINISH PLAN		✓		
A-801	MILLWORK		✓		
A-802	MILLWORK		✓		
A-803	MILLWORK		✓		
A-804	MILLWORK DETAILS		✓		
A-805	MILLWORK DETAILS		✓		
A-806	MILLWORK DETAILS		✓		
A-901	EXTERIOR 3D VIEWS		✓		
A-902	EXTERIOR RENDERINGS		✓		
A-911	SHADES PLAN		✓		
A-912	ELEVATIONS- SHADES		✓		
A-913	ELEVATIONS- SHADES		✓		
AS100	ARCHITECTURAL MASTER SITE PLAN		✓		
AS101	ARCHITECTURAL SITE PLAN		✓		
AS102	ARCHITECTURAL SITE PLAN& FLAGPOLE DETAILS		✓		
AS103	EXTERIOR SIGNAGE		✓		
I-100	IRRIGATION OVERALL PLAN				✓
I-101	IRRIGATION PLAN (1 OF 3)				✓
I-102	IRRIGATION PLAN (2 OF 3)				✓
I-103	IRRIGATION PLAN (3 OF 3)				✓
FA001	FIRE ALARM LEGEND AND NOTES		✓		
FA101	FIRE ALARM PLAN		✓		
FP001	FIRE PROTECTION SYMBOLS, LEGEND, NOTES AND INDEX		✓		
FP101	FIRE PROTECTION REFLECTED CEILING PLAN		✓		
FP301	FIRE PROTECTION DETAILS		✓		

Number	Title	Oct 5, 2023	Dec 20, 2023	Jan 10, 2024	Jan 22, 2024
		Permit Set (Civil)	Permit Set	RFI 3,7,8,9,10,13,14,17,18,25,26,28,29,30	RFI 55 & 56
P001	PLUMBING SYMBOLS, LEGEND, NOTES AND INDEX		✓		
P201	UNDERGROUND PLUMBING PLAN		✓		
P202	FIRST FLOOR GRAVITY PLAN		✓		
P203	PLUMBING ROOF PLAN		✓		
P301	PLUMBING PRESSURE PLAN		✓		
P401	PLUMBING SCHEDULES		✓		
P501	ENLARGED PLUMBING PLANS		✓		
P601	PLUMBING RISER DIAGRAMS		✓		
P602	PLUMBING RISER DIAGRAMS		✓		
P603	PLUMBING RISER DIAGRAMS		✓		
P701	PLUMBING DETAILS		✓		
M001	MECHANICAL SYMBOLS, LEGEND, NOTES AND INDEX		✓		
M002	MINIMUM COMMISIONING REQUIRMENTS		✓		
M003	MECHANICAL SCHEDULES		✓		
M101	MECHANICAL PLAN		✓		
M111	MECHAINCAL CEILING PLAN		✓		
M301	ENLARGED MECHANICAL PLAN		✓		
M302	MECHANICAL SECTIONS		✓		
M501	MECHANICAL DETAILS		✓		
M502	MECHANICAL DETAILS		✓		
M601	MECHANICAL CONTROLS		✓		
E-001	ELECTRICAL LEGEND AND NOTES		✓		
E-101	POWER PLAN		✓		
E-201	LIGHTING PLAN		✓		
E-301	ROOF ELECTRICAL PLAN		✓		
E-401	ENLARGED ELECTRICAL PLANS		✓		
E-501	ELECTRICAL ONE-LINE DIAGRAM		✓		

Number	Title	Oct 5, 2023	Dec 20, 2023	Jan 10, 2024	Jan 22, 2024
		Permit Set (Civil)	Permit Set	RFI 3,7,8,9,10,13,14,17,18,25,26,28,29,30	RFI 55 & 56
E-601	LIGHTING FIXTURE SCHEDULE		✓		
E-602	ELECTRICAL PANEL SCHEDULES		✓		
E-701	ELECTRICAL DETAILS		✓		
E-702	ELECTRICAL DETAILS		✓		
ES101	ELECTRICAL SITE PLAN		✓		
ES102	PHOTOMETRIC SITE PLAN		✓		
T001	TECHNOLOGY SYMBOLS, LEGEND, NOTES AND INDEX		✓		
T051	TECHNOLOGY SITE PLAN		✓		
T101	TECHNOLOGY LEVEL 01 FLOOR PLAN		✓		
T102	SECURITY/A-V LEVEL 01 FLOOR PLAN		✓		
T401	ENLARGED PLANS		✓		
T501	TECHNOLOGY DETAILS		✓		
T502	TECHNOLOGY DETAILS		✓		
T503	TECHNOLOGY DETAILS		✓		
T504	TECHNOLOGY SITE DETAILS		✓		
T511	AUDIO/VISUAL DETAILS		✓		
T521	SECURITY DETAILS		✓		
T600	TECHNOLOGY DETAILS		✓		
T601	TECHNOLOGY SCHEDULES		✓		