

H-24-39

Photo date: 2023

This map was prepared by this office to be used as an aid in land parcel location and identification only. All land locations, right-of-way widths, acreages, and utility locations are subject to field survey or other appropriate verification.



Hernando County Comprehensive Plan Map

Existing Future Land Use: H-24-39
Version Date: 12/09/2022

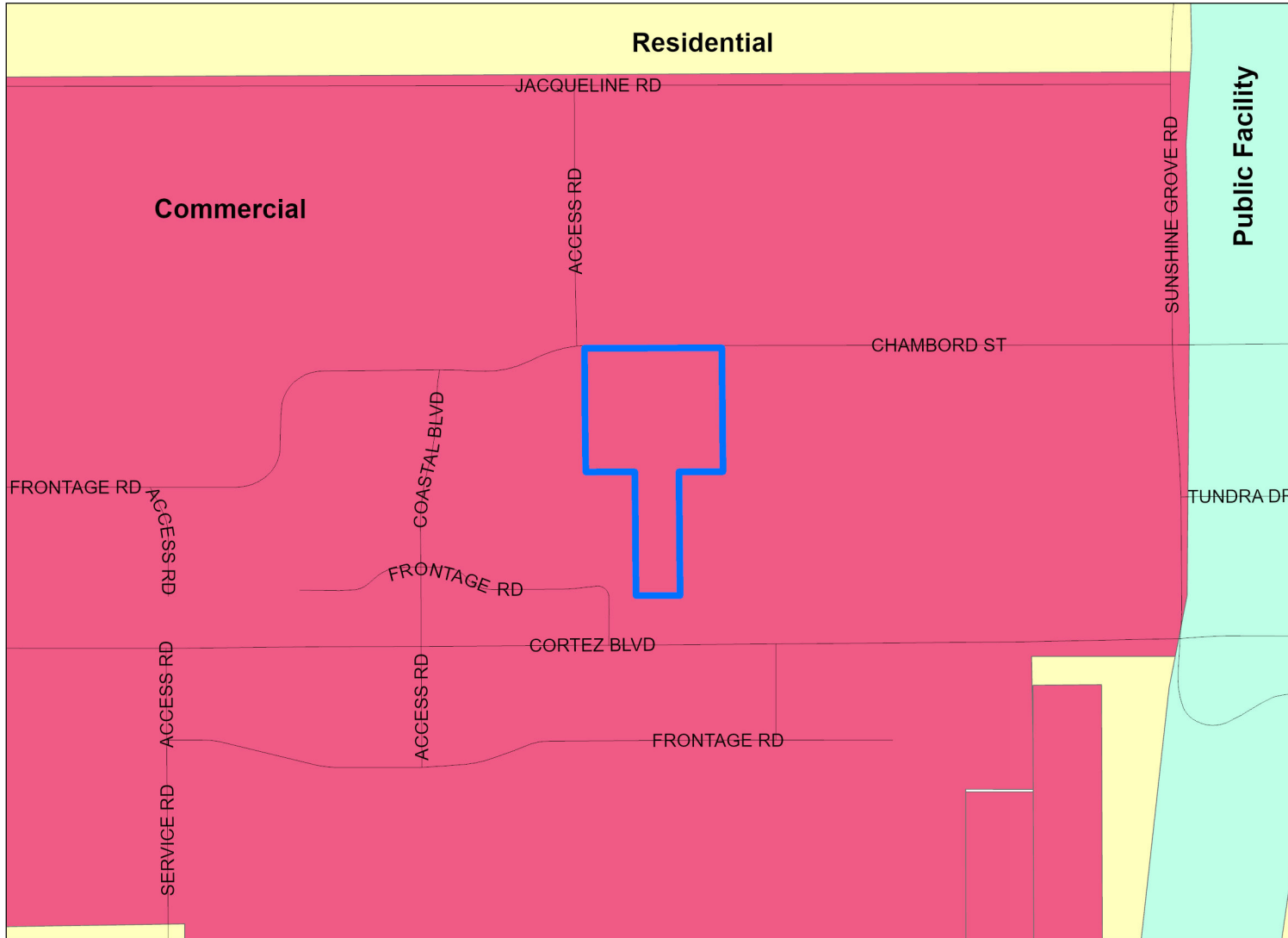

H-24-39

FLU Riverine District

Regional Commercial

FLU

- CITY
- COMMERCIAL
- CONSERVATION
- EDUCATION
- INDUSTRIAL
- MINING
- PLANNED DEVELOPMENT
- PUBLIC FACILITIES
- RECREATION
- RESIDENTIAL
- RURAL

Future Land Use Map

PLEASE REFER TO THE TEXT PORTION OF THE COMPREHENSIVE PLAN IN CONJUNCTION WITH THE USE OF THE FUTURE LAND USE MAP SERIES.

NOTE: THE RIVERINE DISTRICT IS SHOWN AS A LINE SETBACK PARALLEL TO THE WEEKI WACHEE, MUD AND WITHLACOOCHEE RIVERS.

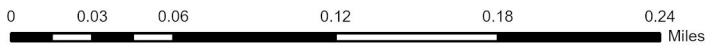

Date of mapping: 08/26/2024



H-24-39 AREA MAP

This map was prepared by this office to be used as an aid in land parcel location and identification only. All land locations, right-of-way widths, acreages, and utility locations are subject to field survey or other appropriate verification.

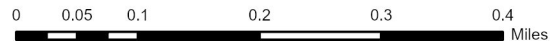
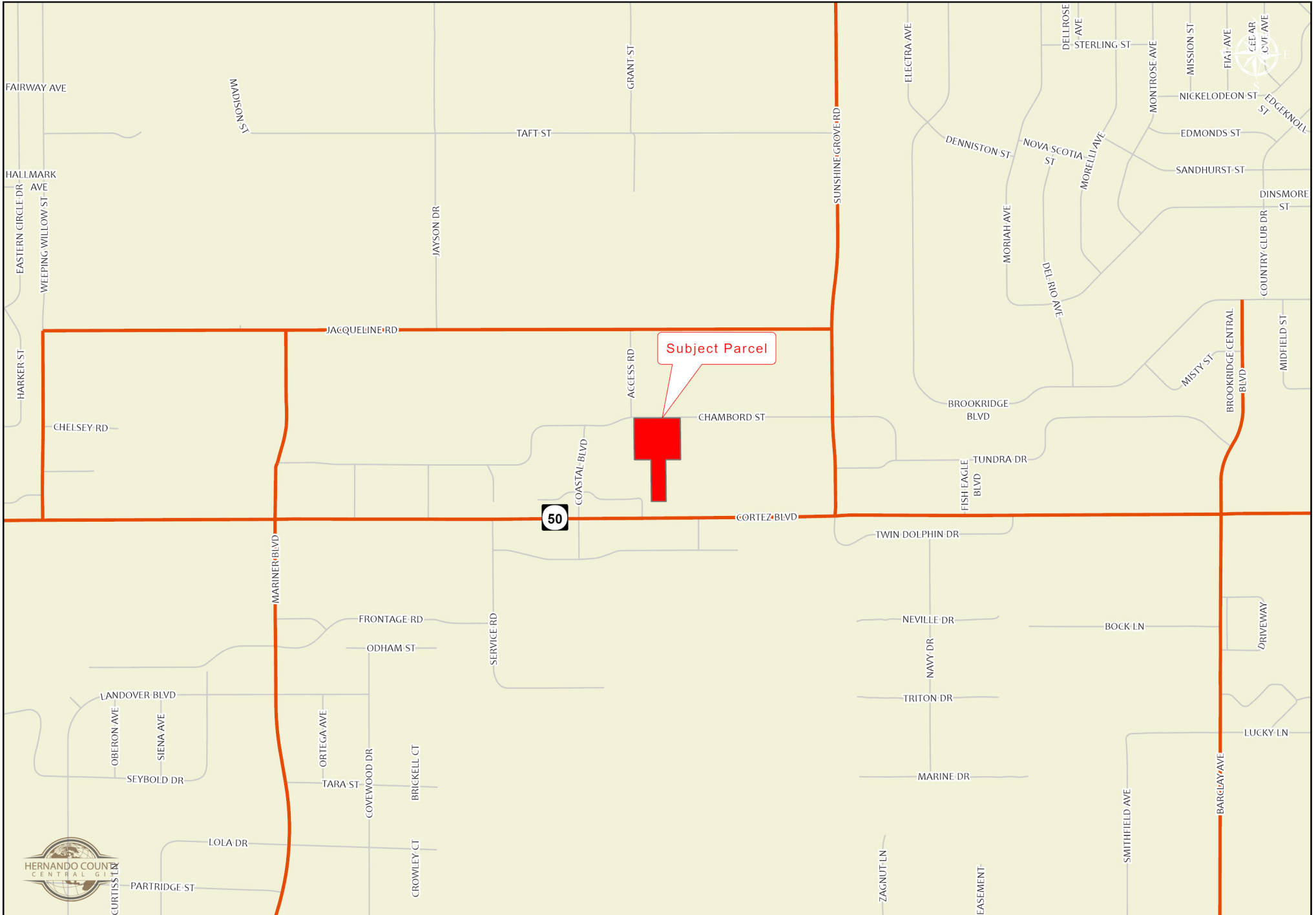

H-24-39

This map was prepared by this office to be used as an aid in land parcel location and identification only. All land locations, right-of-way widths, acreages, and utility locations are subject to field survey or other appropriate verification.

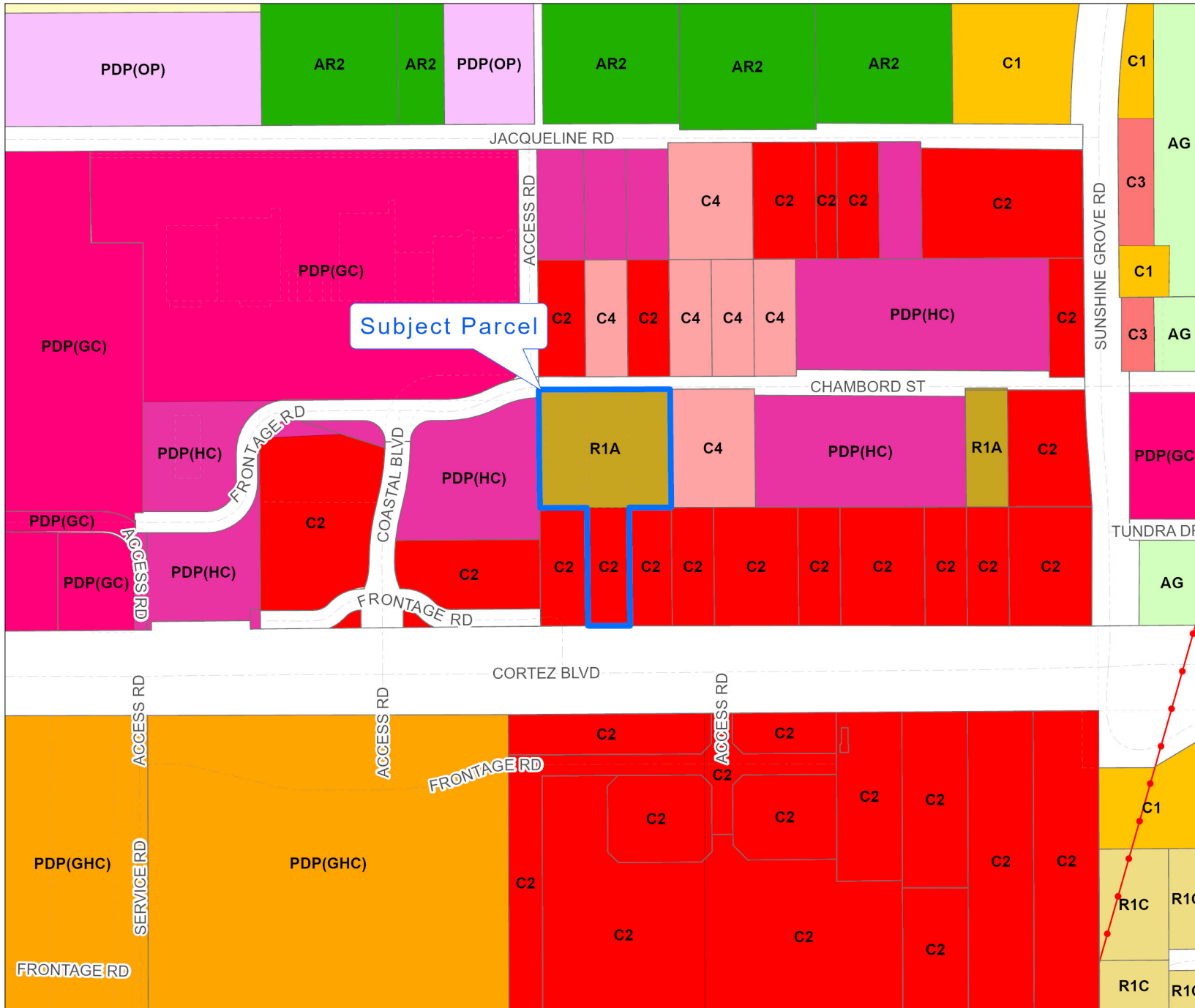

Zoning:

	PDP(HC)
	AC
	PDP(HHC)
	AG
	PDP(HID)
	AR
	PDP(IND)
	AR1
	PDP(LI)
	AR2
	PDP(MF)
	C1
	C2
	PDP(MH)
	C3
	PDP(NC)
	C4
	PDP(OP)
	PDP(PHF)
	CITY
	PDP(PSF)
	CM1
	PDP(REC)
	CM2
	PDP(RR)
	CPDP
	PDP(RUR)
	PDP(SF)
	PDP(SU)
	CV
	R1A
	I1
	R1B
	I2
	R1C
	M
	R1MH
	OP
	R2
	PDP(AF)
	R2.5
	PDP(CM)
	R3
	PDP(CP)
	RC
	PDP(GC)
	RM
	PDP(GHC)

City Zoning Pending

