

# H-23-39 Aerial Map

This map was prepared by this office to be used as aid and land parcel location and identification only. All land locations, right-of-ways widths, acreages, and utility locations are subject to field survey or other appropriate verification.



Not to Scale.



# Hernando County Comprehensive Plan Map

Existing Future Land Use: H-23-39

Version Date: 5/11/2026

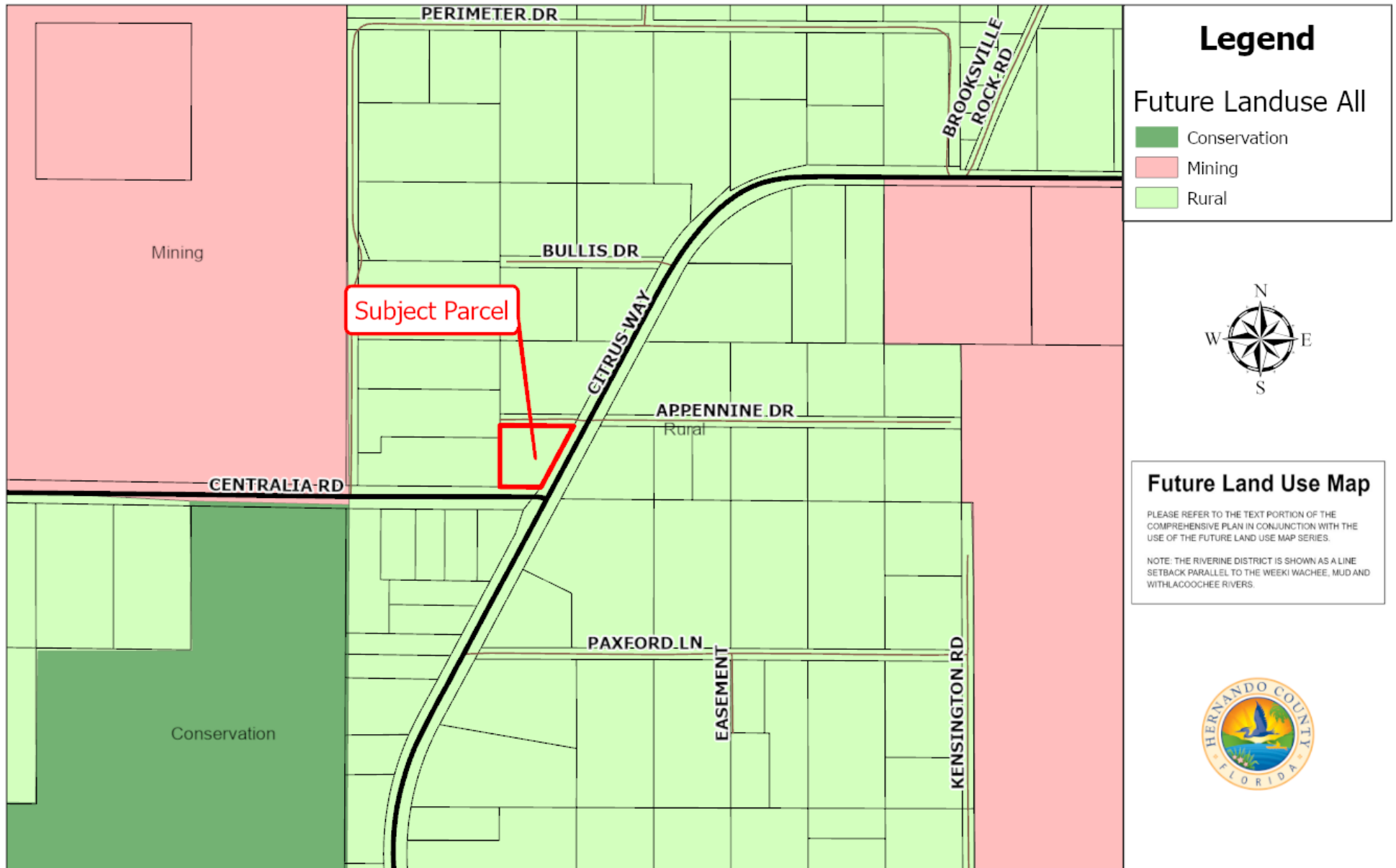

## Legend

Future Landuse All

- Conservation
- Mining
- Rural



## Future Land Use Map

PLEASE REFER TO THE TEXT PORTION OF THE COMPREHENSIVE PLAN IN CONJUNCTION WITH THE USE OF THE FUTURE LAND USE MAP SERIES.

NOTE: THE RIVERINE DISTRICT IS SHOWN AS A LINE SETBACK PARALLEL TO THE WEEKI WACHEE, MUD AND WITHLACOCHEE RIVERS.



Not to Scale.

# H-23-39 Area Map

This map was prepared by this office to be used as aid and land parcel location and identification only. All land locations, right-of-ways widths, acreages, and utility locations are subject to field survey or other appropriate verification.

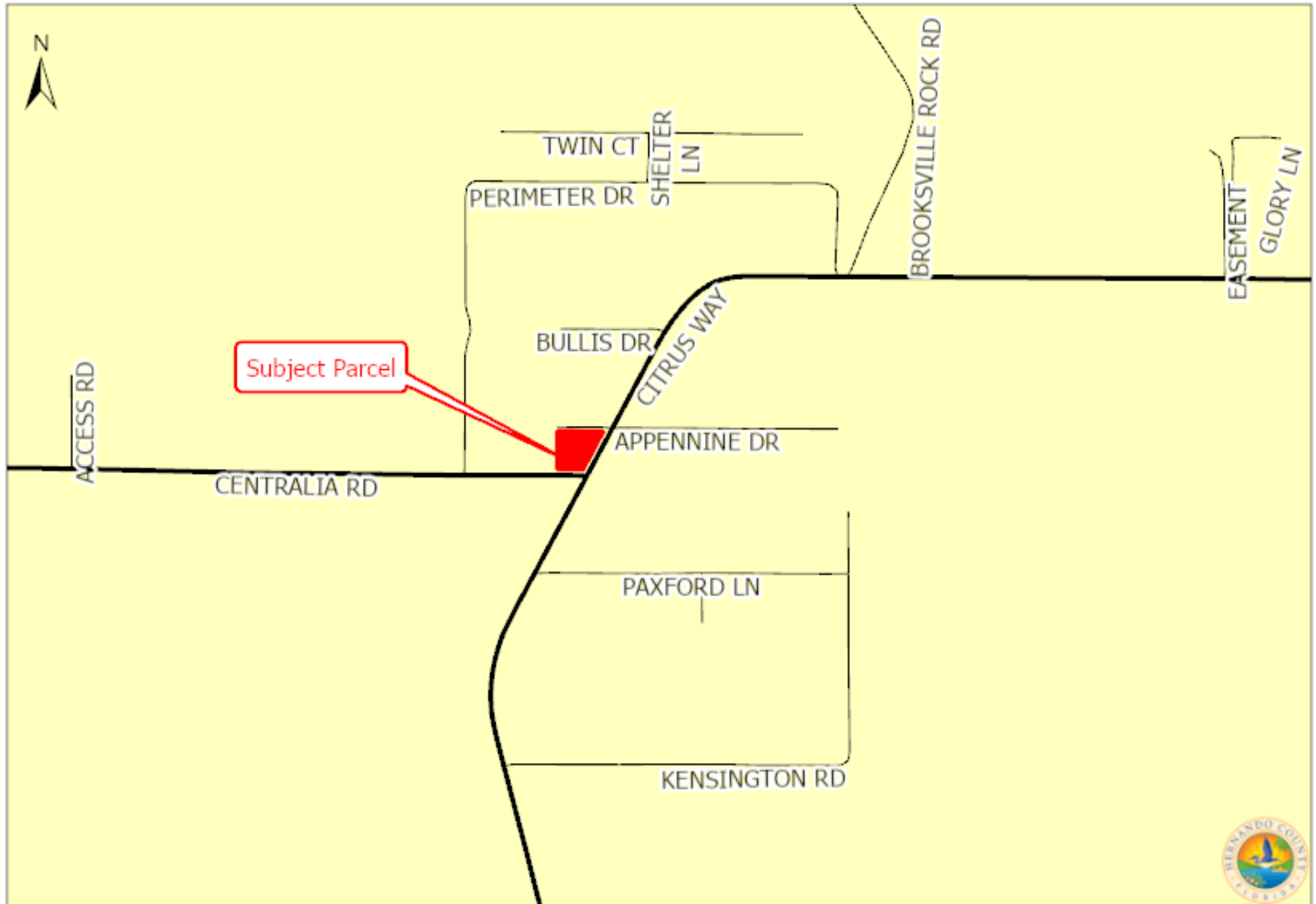

Not to Scale.

# H-23-39 Zoning Map

This map was prepared by this office to be used as aid and land parcel location and identification only. All land locations, right-of-ways widths, acreages, and utility locations are subject to field survey or other appropriate verification.

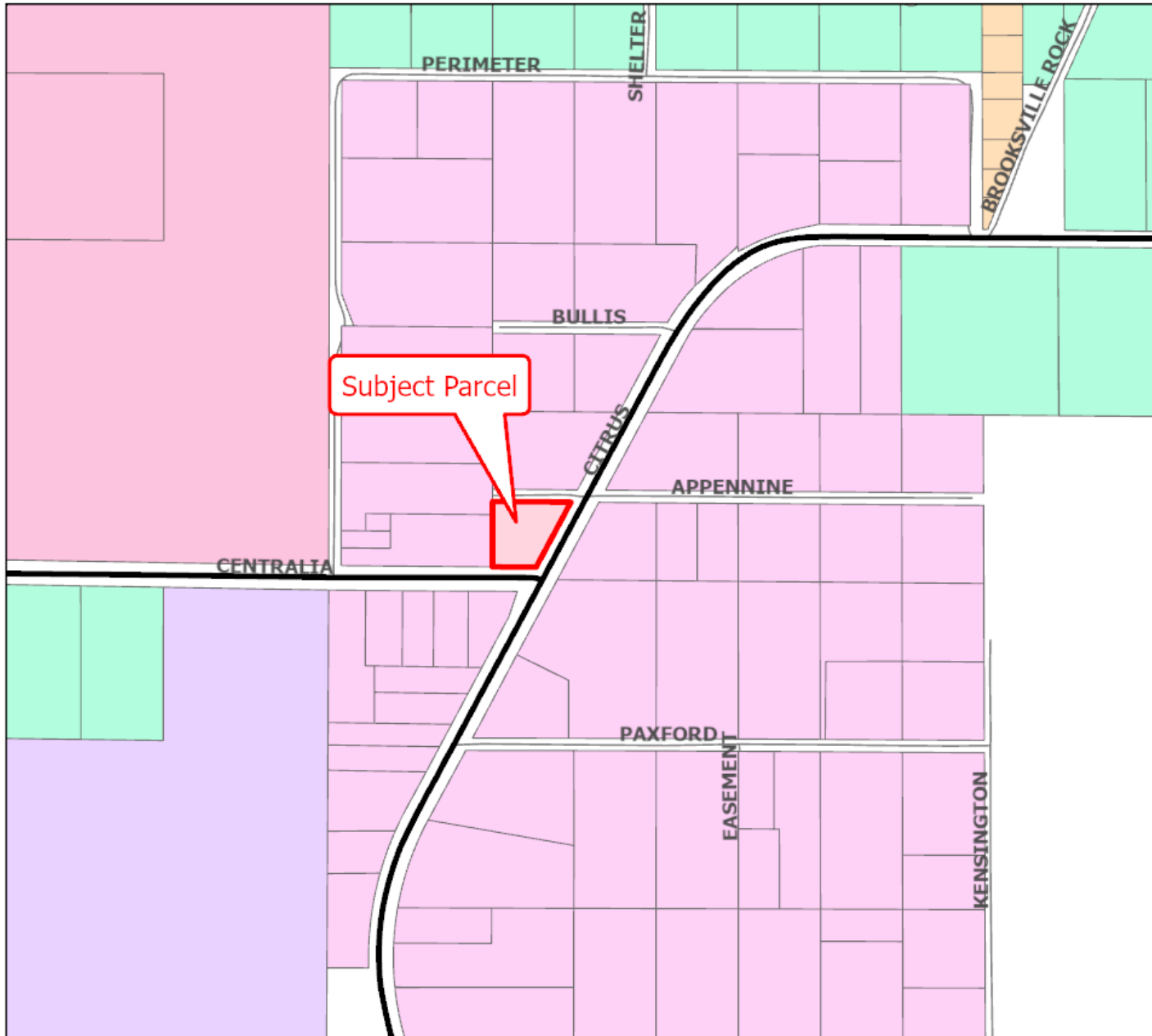

### Legend

Zoning\_

- AG
- AR2
- C1
- CV
- M
- R1C

