

HERNANDO COUNTY CONDITIONAL USE PERMIT
OR SPECIAL EXCEPTION USE PERMIT PETITION



Application request (check one):

- ☐ Conditional Use Permit
☐ Special Exception Use Permit

PRINT OR TYPE ALL INFORMATION

File No. SE2116 Official Date Stamp:

Received

DEC 29 2021

Planning Department

John & Pamela Henry

Date: _____

APPLICANT NAME: JOHN HENRY Sculptor Inc

Address: 231 Spring Lake Hwy
City: Brooksville FL State: FL Zip: 34602
Phone: 305-794-8653 Email: pamela@johnhenrysculpture.com
Property owner's name: (if not the applicant) _____

REPRESENTATIVE/CONTACT NAME: Pamela Henry

Company Name: ~~Pamela Henry~~ JOHN HENRY Sculptor Inc
Address: 231 Spring Lake Hwy
City: Brooksville FL State: FL Zip: 34602
Phone: 305-794-8653 Email: pamela@johnhenrysculpture.com

HOME OWNERS ASSOCIATION: ☐ Yes ☒ No (if applicable provide name) _____

Contact Name: _____
Address: _____ City: _____ State: _____ Zip: _____

PROPERTY INFORMATION:

1. PARCEL(S) KEY NUMBER(S): 01783724 + 01784929 + 393069
2. SECTION _____, TOWNSHIP _____, RANGE _____
3. Current zoning classification: A9
4. Desired use: Home Occupation
5. Size of area covered by application: 15 acres
6. Highway and street boundaries: Spring Lake Hwy
7. Has a public hearing been held on this property within the past twelve months? ☐ Yes ☒ No
8. Will expert witness(es) be utilized during the public hearings? ☐ Yes ☒ No (If yes, identify on an attached list.)
9. Will additional time be required during the public hearing(s) and how much? ☐ Yes ☒ No (Time needed: _____)

PROPERTY OWNER AFFIDAVIT

I, Pamela Henry, have thoroughly examined the instructions for filing this application and state and affirm that all information submitted within this petition are true and correct to the best of my knowledge and belief and are a matter of public record, and that (check one):

☐ I am the owner of the property and am making this application OR

☒ I am the owner of the property and am authorizing (applicant): Pamela Henry
and (representative, if applicable): _____
to submit an application for the described property.

Pamela Henry

John R. Henry
Signature of Property Owner

STATE OF FLORIDA
COUNTY OF HERNANDO

The foregoing instrument was acknowledged before me this 20TH day of DECEMBER, 2021, by Pamela Henry John Henry who is personally known to me or produced _____ as identification.

David Townsend
Signature of Notary Public

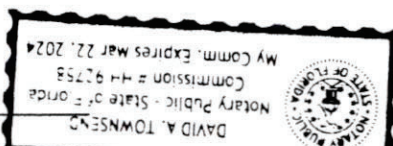

Effective Date: 11/8/16 Last Revision: 11/8/16

PRINT FORM

CLEAR FORM

Notary Seal/Stamp

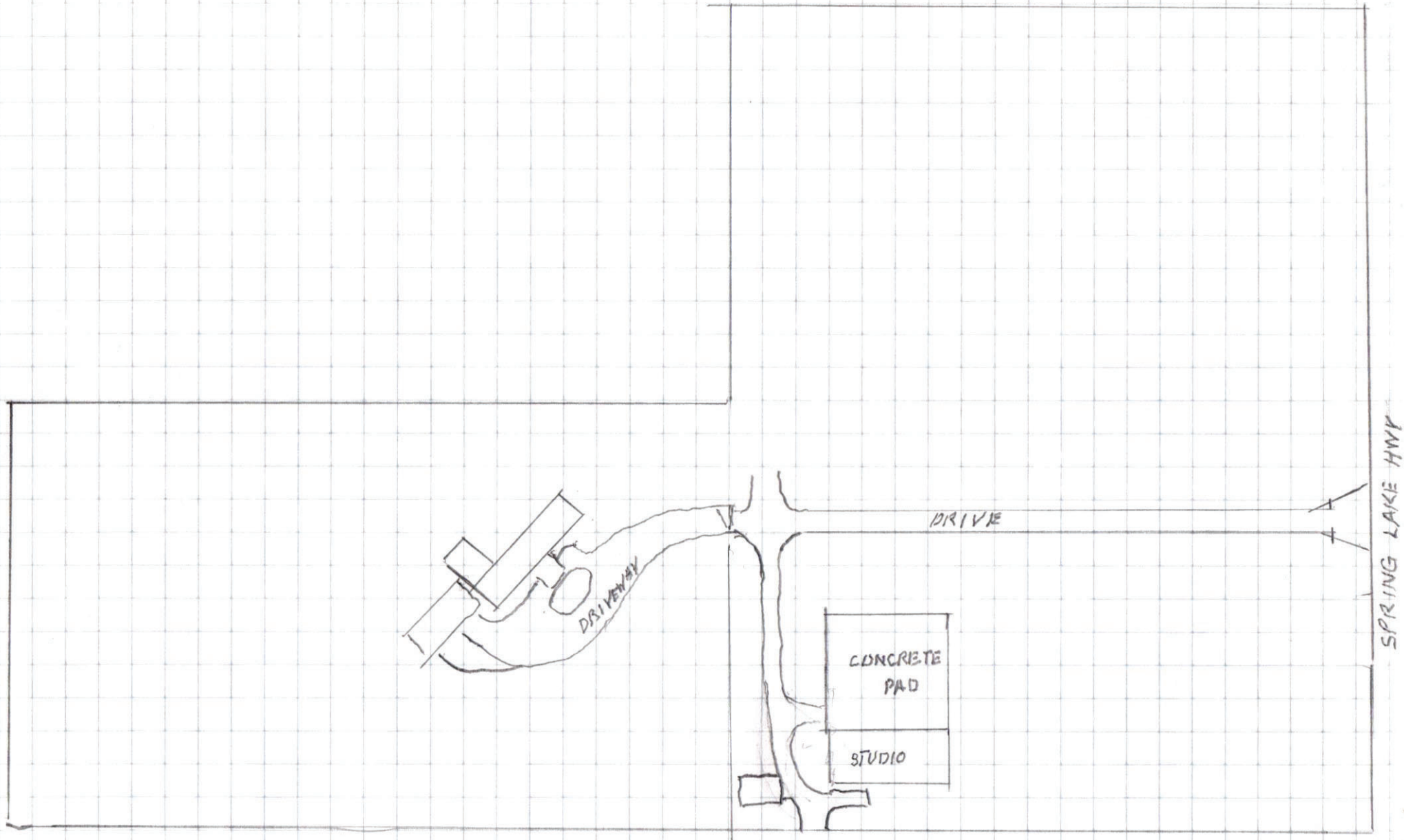

Received

DEC 29 2021

Planning Department
Hernando County, Florida

HENRY PROPERTY
231 SPRING LAKE HWY.

John Henry Sculptor Inc.
231 Spring Lake Hwy
Brooksville, Fl. 34602

Key # 1783724, 1784929 & 393069

Application for Special Exception Use Permit Petition- HOME OCCUPATION

REVISED

We are requesting permission to continue building sculpture as we have for 3 years upon moving to Brooksville. John's career spans 55+ years and his sculpture are well known throughout the world. He continues to fabricate his own work with a team of experienced fabricators and other sculptors.

The fabrication process uses aluminum, steel and bronze elements that are welded together and joined mechanically.

John Henry has a studio building with 4 employees and parking for the employee is adequate and to the west of the building. We start at 9am and close the shop at 6pm 5 days a week. The noise level beyond the shop is minimal. Mr. Bast's complaint is not founded but what is true is that Mr. Bast has had a problem with every neighbor in our small section of Brooksville.

John has moved the worktable to the North side of the Studio out of ear shot to our neighbors.

It is our intention to continue contributing to the economy and the wellbeing of our neighborhood of Brooksville.

Sincerely,

John Henry

Pamela Henry