

PREVIOUS PURPOSED DEVELOPMENT SITE PLAN

REZONING
HERNANDO COUNTY, JUNE 9, 2025



06/09/2025

Petitioner exhibit -17163

PREVIOUS PURPOSED DEVELOPMENT VS CURRENT

BOARD OF COUNTY COMMISSIONERS
HERNANDO COUNTY, AUGUST 5, 2025

Lot	
Lot 1	3,500 +/- SF
Lot 2	4,000 +/- SF
Lot 3	6,000 +/- SF
Lot 4	3,500 +/- SF
Lot 5	5,000 +/- SF
Total Building	22,000 +/-
Open Space	117,612 +/-

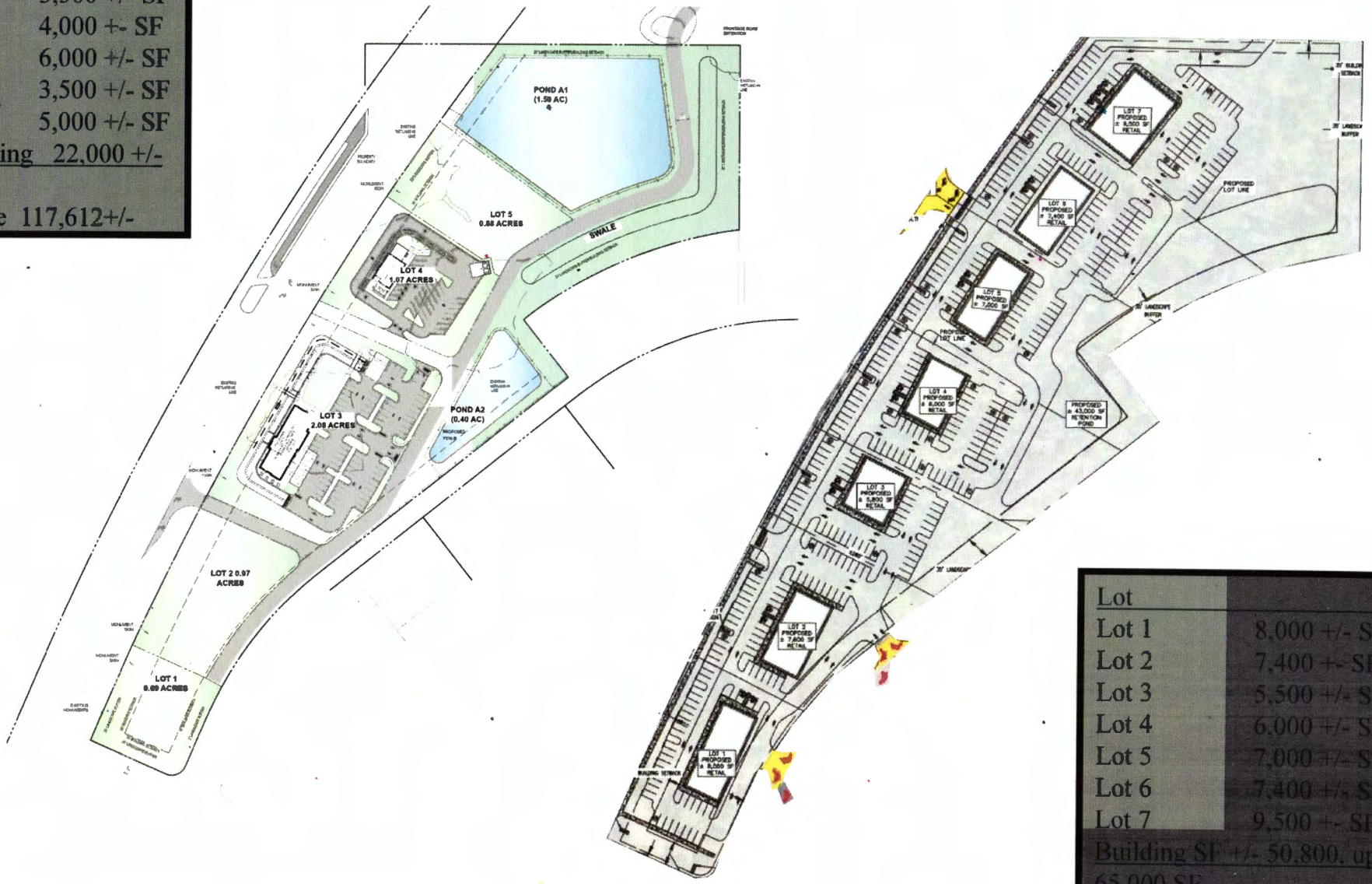

Lot	
Lot 1	8,000 +/- SF
Lot 2	7,400 +/- SF
Lot 3	5,500 +/- SF
Lot 4	6,000 +/- SF
Lot 5	7,000 +/- SF
Lot 6	7,400 +/- SF
Lot 7	9,500 +/- SF
Building SF +/-	50,800, up to 65,000 SF
Open Space/Retention Pound	43,000 SF +/-

06/09/2025 *Petitioner Exhibit - 17103*



LEGEND

SITE PLAN

- EX PROPERTY LINE
- EX ADJACENT PROPERTY LINE
- EX ROAD CENTERLINE
- EXIP PROPERTY LINE
- PROP BUFFER
- PROP SETBACK
- PROP DRIVE
- PROP SWALE
- PROP FENCED FLIGHT
- PROP SWIM
- PROP BUILDING ENTRANCE
- PROP CONCRETE SIDEWALK
- PROP STANDARD
- PROP ALIQUOT DUTY
- CONCRETE

BOHLER

BOHLER & ASSOCIATES, INC.
 SITE CIVIL, LAND SURVEYING, ENGINEERING
 LANDSCAPE ARCHITECTURE
 SUSTAINABLE DESIGN
 TRANSPORTATION SERVICES

REVISIONS

REV	DATE	COMMENT	BY



FOR CONCEPT PURPOSES ONLY

PROJECT No. PLANDIV 0004
 DRAWN BY: ANBU
 CHECKED BY: JAC
 DATE: 08/10/2023
 CAD ID: PLANDIV0004

EXHIBIT

FOR
MERIDIEN DEVELOPMENT, LLC

PROPOSED DEVELOPMENT
 US 19 & SPRING HILL DR NE
 SPRING HILL, FL 34686
 HERNANDO COUNTY
 9.29, 7.23 S, R 17 E

BOHLER

480 N. WESTSHORE BLVD, SUITE 500
 TAMPA, FLORIDA 33608
 Phone: (813) 812-4100
 Fax: (813) 812-4101

SHEET TITLE:
EXHIBIT PLAN

SHEET NUMBER:
1 OF 1

DRG. DATE - 07/24/2023

