

# H-24-19

Photo date:

This map was prepared by this office to be used as an aid in land parcel location and identification only. All land locations, right-of-way widths, acreages, and utility locations are subject to field survey or other appropriate verification.

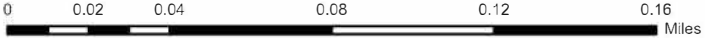

# Hernando County Comprehensive Plan Map

Existing Future Land Use: H-24-19  
Version Date: 12/09/2022

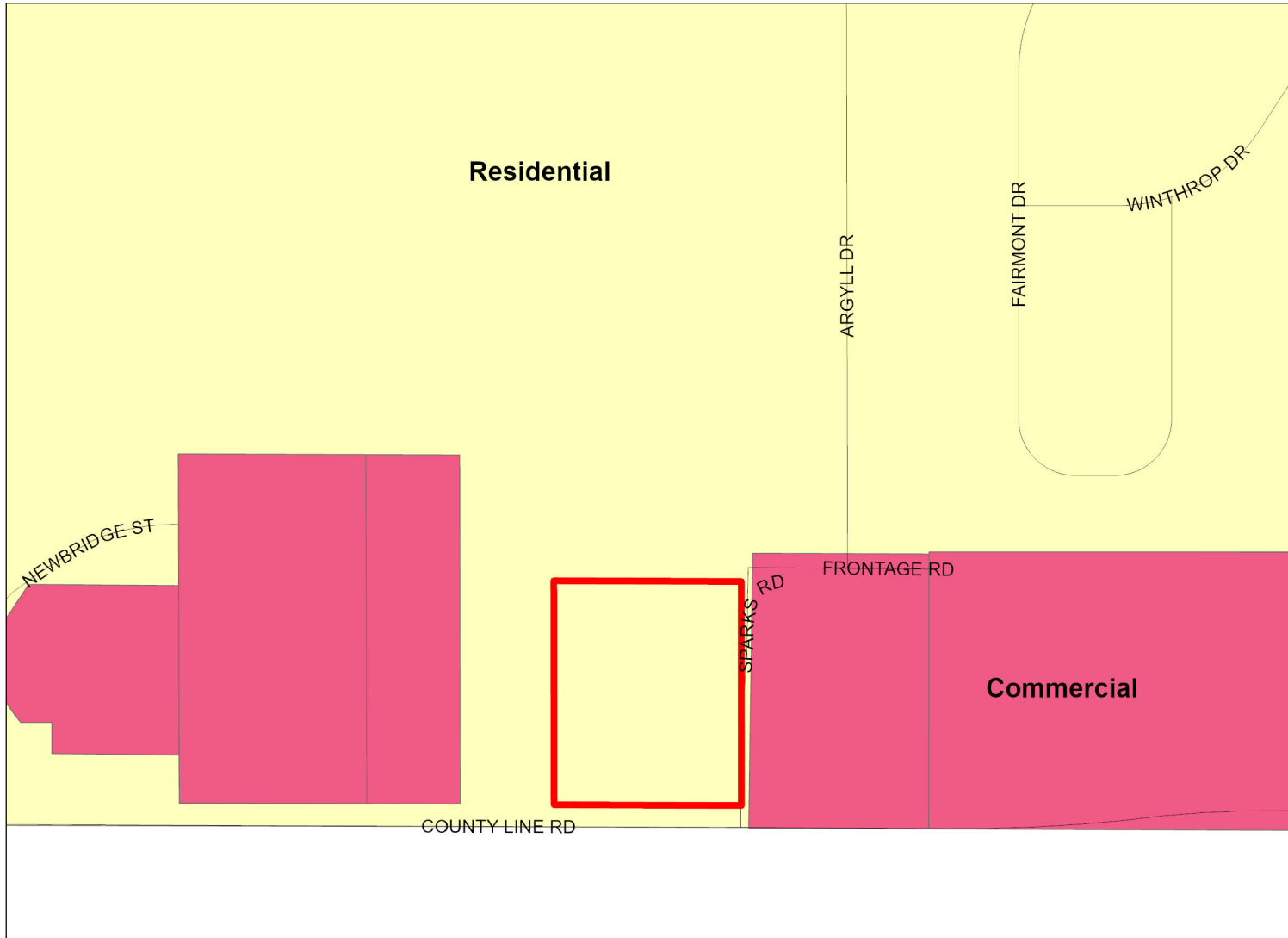

**H-24-19**

FLU Riverine District

Regional Commercial

**FLU**

- CITY
- COMMERCIAL
- CONSERVATION
- EDUCATION
- INDUSTRIAL
- MINING
- PLANNED DEVELOPMENT
- PUBLIC FACILITIES
- RECREATION
- RESIDENTIAL
- RURAL

**Future Land Use Map**

PLEASE REFER TO THE TEXT PORTION OF THE COMPREHENSIVE PLAN IN CONJUNCTION WITH THE USE OF THE FUTURE LAND USE MAP SERIES.

NOTE: THE RIVERINE DISTRICT IS SHOWN AS A LINE SETBACK PARALLEL TO THE WEEKI WACHEE, MUD AND WITHLACOOCHEE RIVERS.

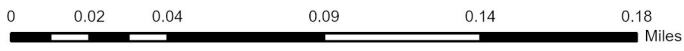

Date of mapping: 06/03/2024



# H-24-19 AREA MAP

This map was prepared by this office to be used as an aid in land parcel location and identification only. All land locations, right-of-way widths, acreages, and utility locations are subject to field survey or other appropriate verification.

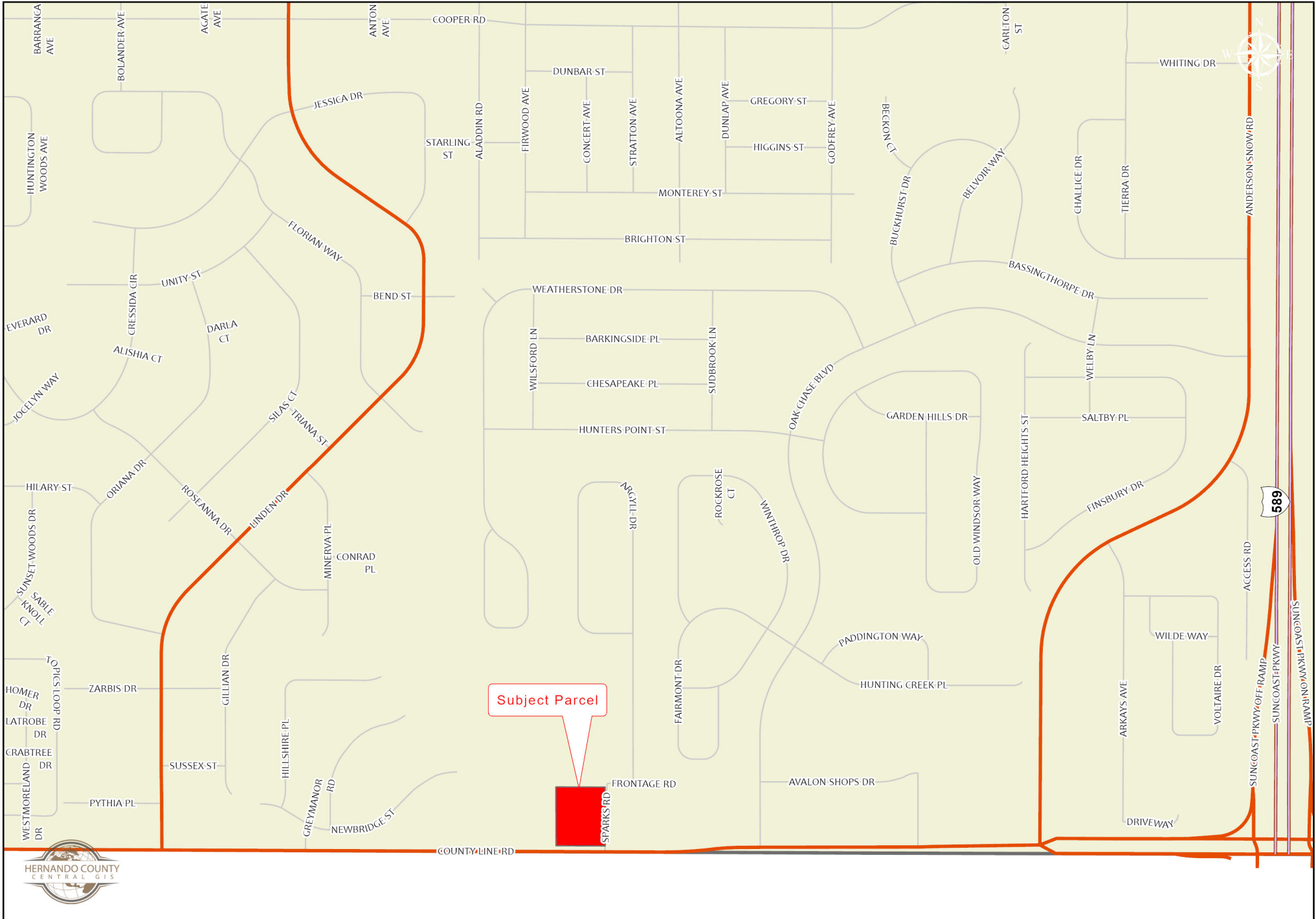

Subject Parcel



0 0.05 0.1 0.2 0.3 0.4 Miles

# H-24-19

This map was prepared by this office to be used as an aid in land parcel location and identification only. All land locations, right-of-way widths, acreages, and utility locations are subject to field survey or other appropriate verification.

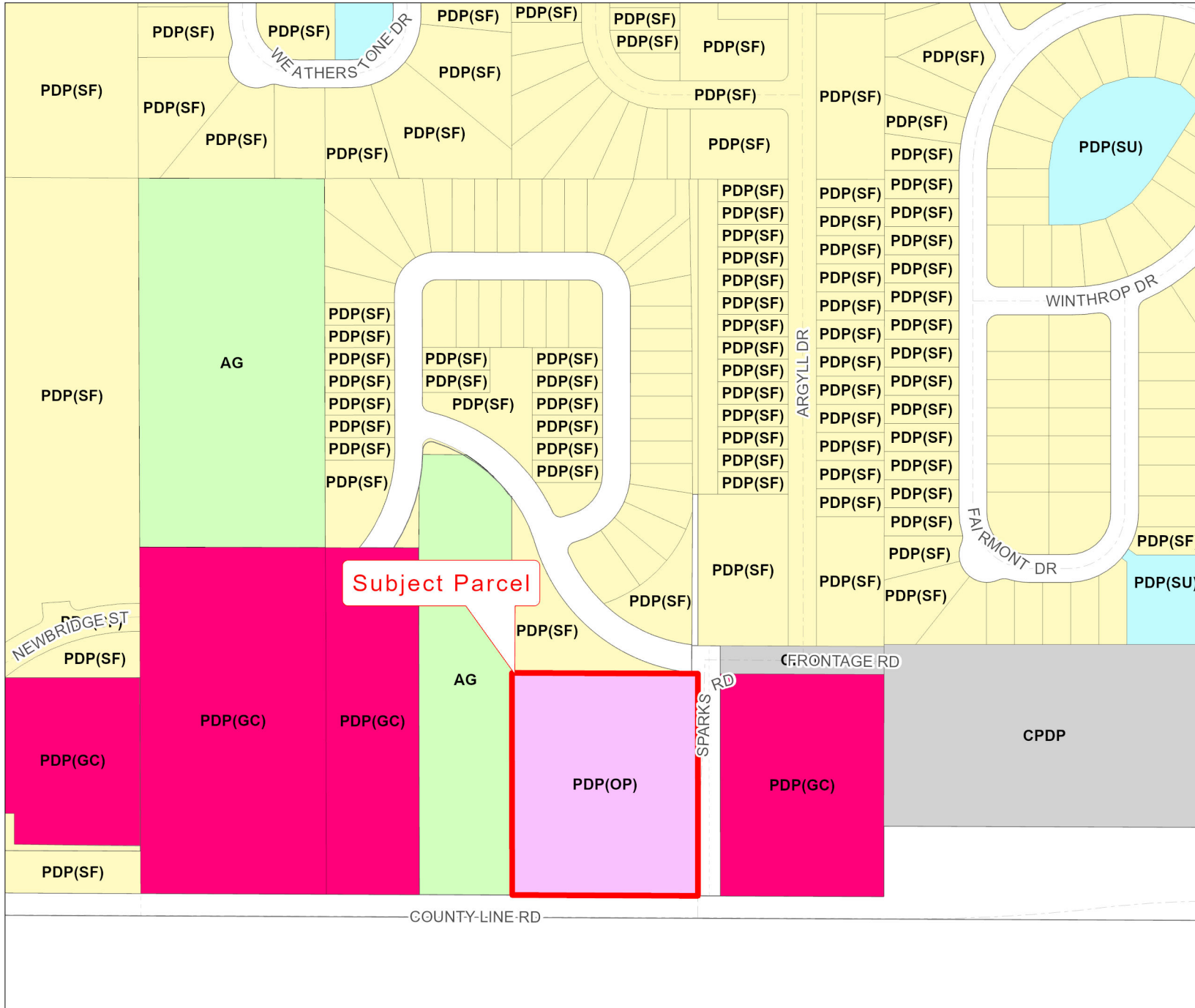

**Zoning:**

	PDP(HC)
	AC
	PDP(HHC)
	AG
	PDP(HID)
	AR
	PDP(IND)
	AR1
	PDP(LI)
	AR2
	PDP(MF)
	C1
	PDP(MH)
	C2
	PDP(NC)
	C3
	PDP(OP)
	C4
	PDP(PSF)
	CITY
	CM1
	PDP(REC)
	CM2
	PDP(RR)
	CPDP
	PDP(RUR)
	CV
	PDP(SF)
	I1
	R1A
	I2
	R1B
	M
	R1C
	OP
	R1MH
	PDP(AF)
	R2
	PDP(CM)
	R2.5
	PDP(CP)
	R3
	PDP(GC)
	RC
	PDP(GHC)
	RM

City Zoning Pending

