

50' RIGHT OF WAY (R)

S00°24'00"E 180.00'(P)
S00°27'55"E 180.14'(F)
S00°24'00"E 180.31'(P)
S00°23'46"E 180.67'(F)

SE 1/4
LR 7851

EAST
N89°57'35"E

LOT 1

FP 5/8"
No Cap

370.00'(P)
370.15'(F)

FP 1"
No Cap

FP 1"
No Cap

LOT 2
BLOCK A

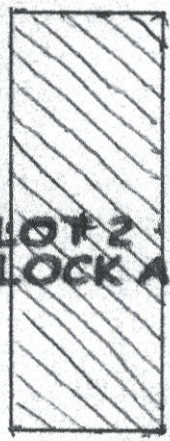

Planning Department
Hernando County, Florida

FEB 5 2024

Received

6' Wire Fence

FP 1/4"
No Cap

EAST
N89°55'12"E

LOT 3

370.00'(P)
370.07'(F)

FP 1"
No Cap

LINE	BEARING	DISTANCE
------	---------	----------