

Received

DEC 5 2023

Planning Department
Hernando County, Florida

SCALE: 1" = 30'

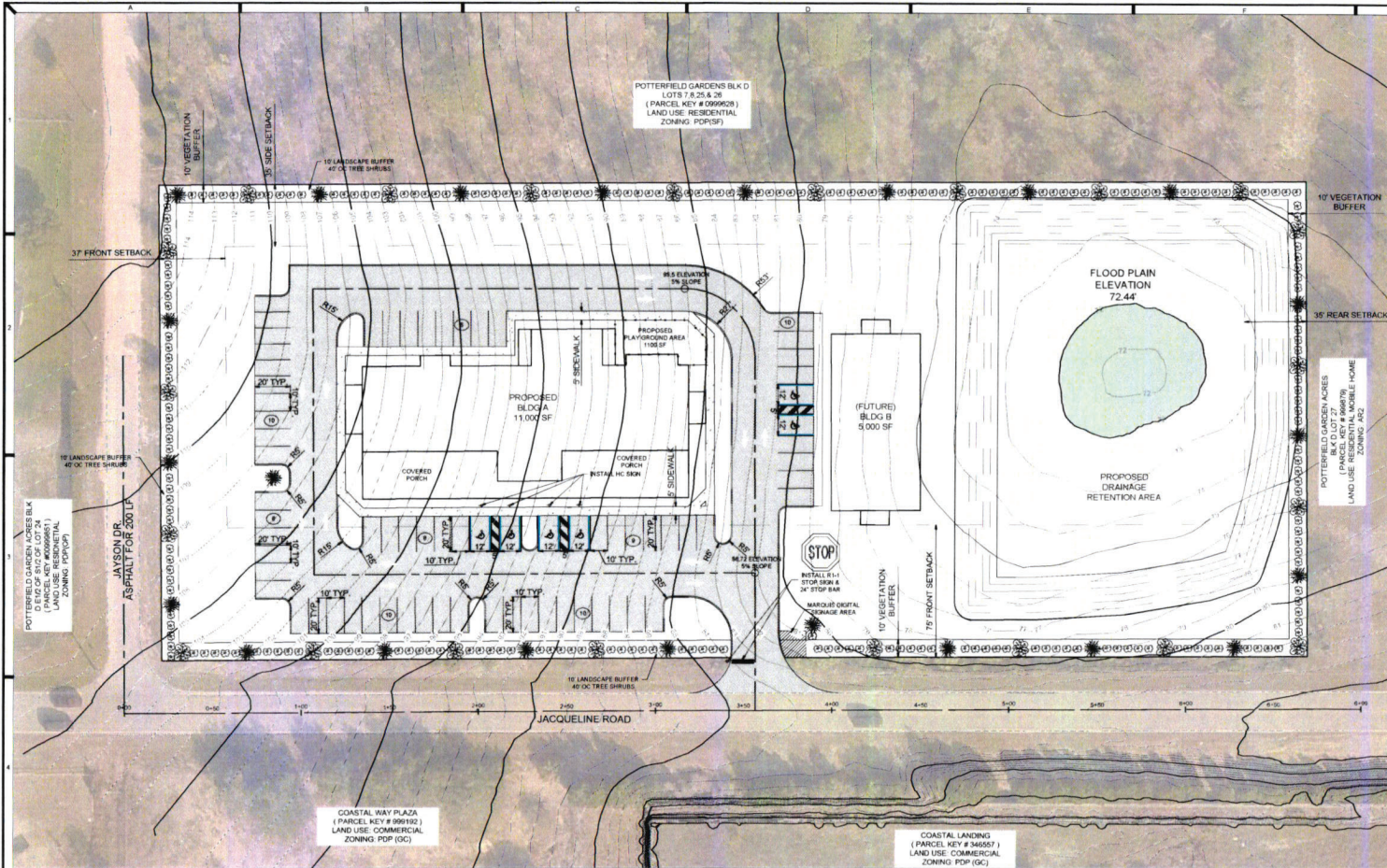

1122	REV. PLOT DATE
1123	REVISIONS
1124	DESCRIPTION
1125	DATE
1126	BY
1127	APP. NO.
1128	DATE
1129	BY
1130	APP. NO.
1131	DATE
1132	BY
1133	APP. NO.
1134	DATE
1135	BY
1136	APP. NO.
1137	DATE
1138	BY
1139	APP. NO.
1140	DATE
1141	BY
1142	APP. NO.
1143	DATE
1144	BY
1145	APP. NO.
1146	DATE
1147	BY
1148	APP. NO.
1149	DATE
1150	BY

MID FLORIDA COMMUNITY SERVICES, INC. - JACQUELINE RD
MASTER PLAN

PROCIVIL 360
CIVIL ENGINEERING/RESIDENTIAL & COMMERCIAL
SITE DEVELOPMENT / PLANNING & ZONING /
PERMITTING / CONSTRUCTION SERVICES
13 SOUTH MAIN STREET, BROOKSVILLE, FL 34601 PHONE: (781) 526-6243
WWW.PROCIVIL360.COM

DISTITAL/ELECTRONIC SIGNATURE NOTE
I HEREBY CERTIFY THAT THE CONTENTS OF THIS PLAN, SPECIFICATIONS, AND ANY OTHER INFORMATION CONTAINED HEREIN WERE PREPARED BY ME OR UNDER MY CLOSE PERSONAL SUPERVISION AND THAT I AM A LICENSED PROFESSIONAL ENGINEER IN THE STATE OF FLORIDA. I AM NOT PROVIDING ANY PROFESSIONAL SERVICES TO ANY OTHER PARTY IN CONNECTION WITH THIS PROJECT.

REVISION NO.	DATE	BY	APP. NO.	DATE	BY	APP. NO.
1						
2						

1. STATEMENT OF INTENT:
THE OWNER IS DESIROUS OF BUILDING A 11,000 SF ± FOR A CHILD ADVOCACY CENTER AND A FUTURE 5,000 SF BUILDING FOR EXPANSION ON A 4 AC. PARCEL. THIS PROJECT WOULD NEED TO MEET ALL CRITERIA FROM HERNANDO COUNTY AND SWFWMD.
PROJECT KEY # 1590497

SITE ADDRESS: THE SITE IS AT THE NORTHEAST CORNER OF JACQUELINE RD AND JAYSON DR., SPRING HILL, FLORIDA

SITE TOTAL AREA: 4.0 ACRES

EXISTING USE: VACANT

2. PROPOSED BUILDING DATA:
11,000 SF CHILD ADVOCACY CENTER & 5,000 SF OFFICE EXPANSION

CURRENT ZONING: PDP(OP)

REQUESTED ZONING: PDP (OP)

3. PARKING CALCULATIONS

OFFICES
3.5 SPACES PER 1000 SF
11,000 + 5,000 = 16,000 SF OF BUILDING / 1000 X 3.5
56 SPACES REQUIRED W/ 3 BEING HANDICAP
67 SPACES PROVIDED W/ 6 BEING HANDICAP

4. PERIMETER SETBACKS:
FRONT: 75' (JACQUELINE) 37' JAYSON RD
SIDES: 35' (NORTH)
REAR: 35' (EAST)

5. ON-SITE AREA CALCULATIONS:

EXISTING PERVIOUS	174,240.00 SF	(4.0000 AC)
PROPOSED PERVIOUS	86,809.040 SF	(1.9929 AC)
PROPOSED BUILDINGS	16,000.000 SF	(0.3673 AC)
PROPOSED IMPERVIOUS	44,875.512 SF	(1.0302 AC)
PROPOSED POND	26,555.454 SF	(0.6096 AC)

LEGEND

—	CONCRETE WHEEL STOP
○	# OF PARKING SPACES
⊕	TYPE "C" INLET
▭	CONCRETE SURFACE
▨	ASPHALT SURFACE

Plot Date: Dec 01, 2023 - 8:52am User Name: fclca Drawing Name: W:\PROCIVIL\2023 Projects\PRO23072 - Child Advocacy Center\23072cnc3.dwg