

H-26-18 Aerial Map

This map was prepared by this office to be used as aid and land parcel location and identification only. All land locations, right-of-ways widths, acreages, and utility locations are subject to field survey or other appropriate verification.



Not to Scale.

Hernando County Comprehensive Plan Map

Existing Future Land Use: H-26-18

Version Date: 6/8/2026

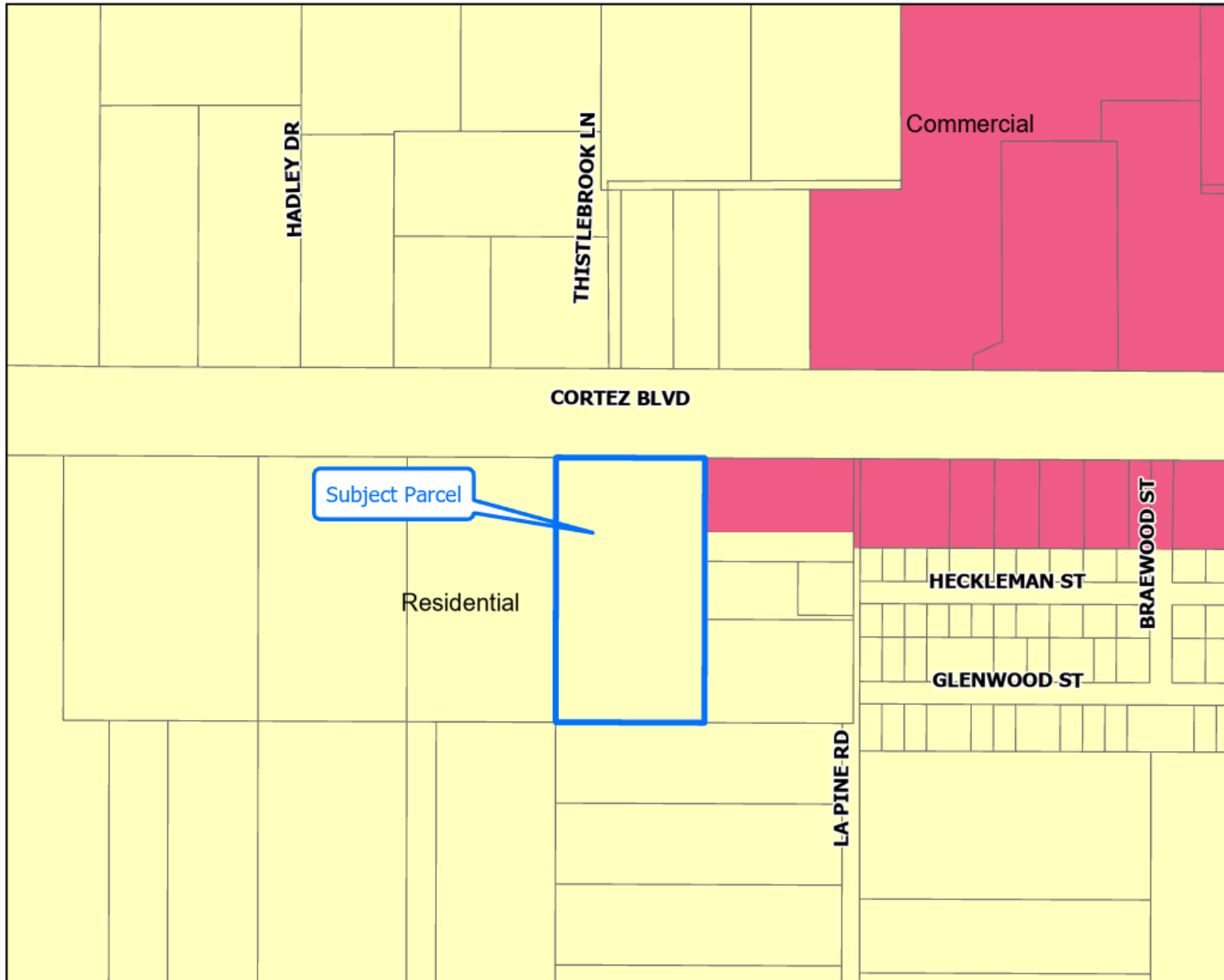

Legend

Future Landuse All

- Commercial
- Residential



Future Land Use Map

PLEASE REFER TO THE TEXT PORTION OF THE COMPREHENSIVE PLAN IN CONJUNCTION WITH THE USE OF THE FUTURE LAND USE MAP SERIES.

NOTE: THE RIVERINE DISTRICT IS SHOWN AS A LINE SETBACK PARALLEL TO THE WEEKI WACHEE, MUD AND WITHLACOOCHEE RIVERS.



Not to Scale.

H-26-18 Area Map

This map was prepared by this office to be used as aid and land parcel location and identification only. All land locations, right-of-ways widths, acreages, and utility locations are subject to field survey or other appropriate verification.

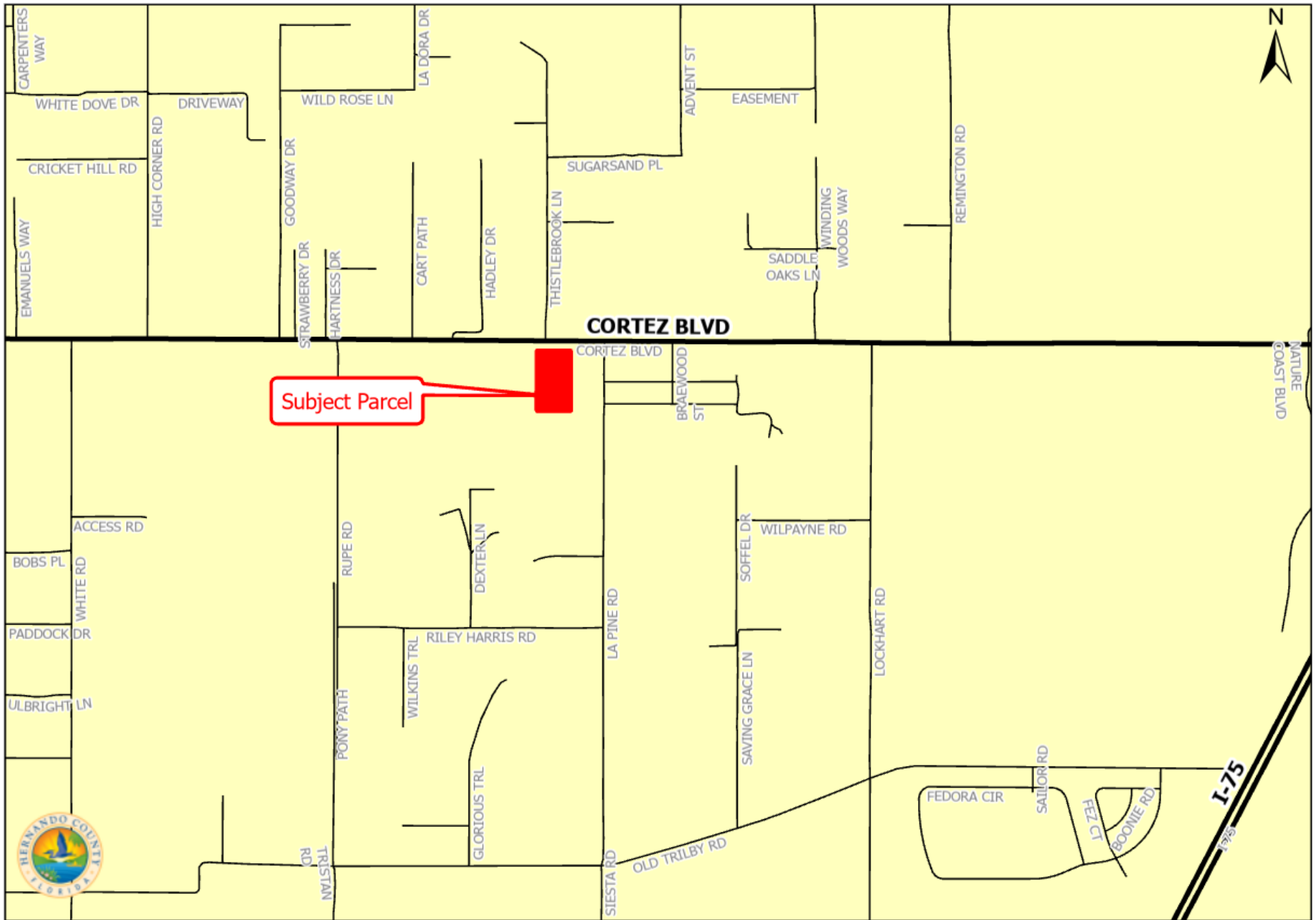

Not to Scale.

H-26-18 Zoning Map

This map was prepared by this office to be used as aid and land parcel location and identification only. All land locations, right-of-ways widths, acreages, and utility locations are subject to field survey or other appropriate verification.

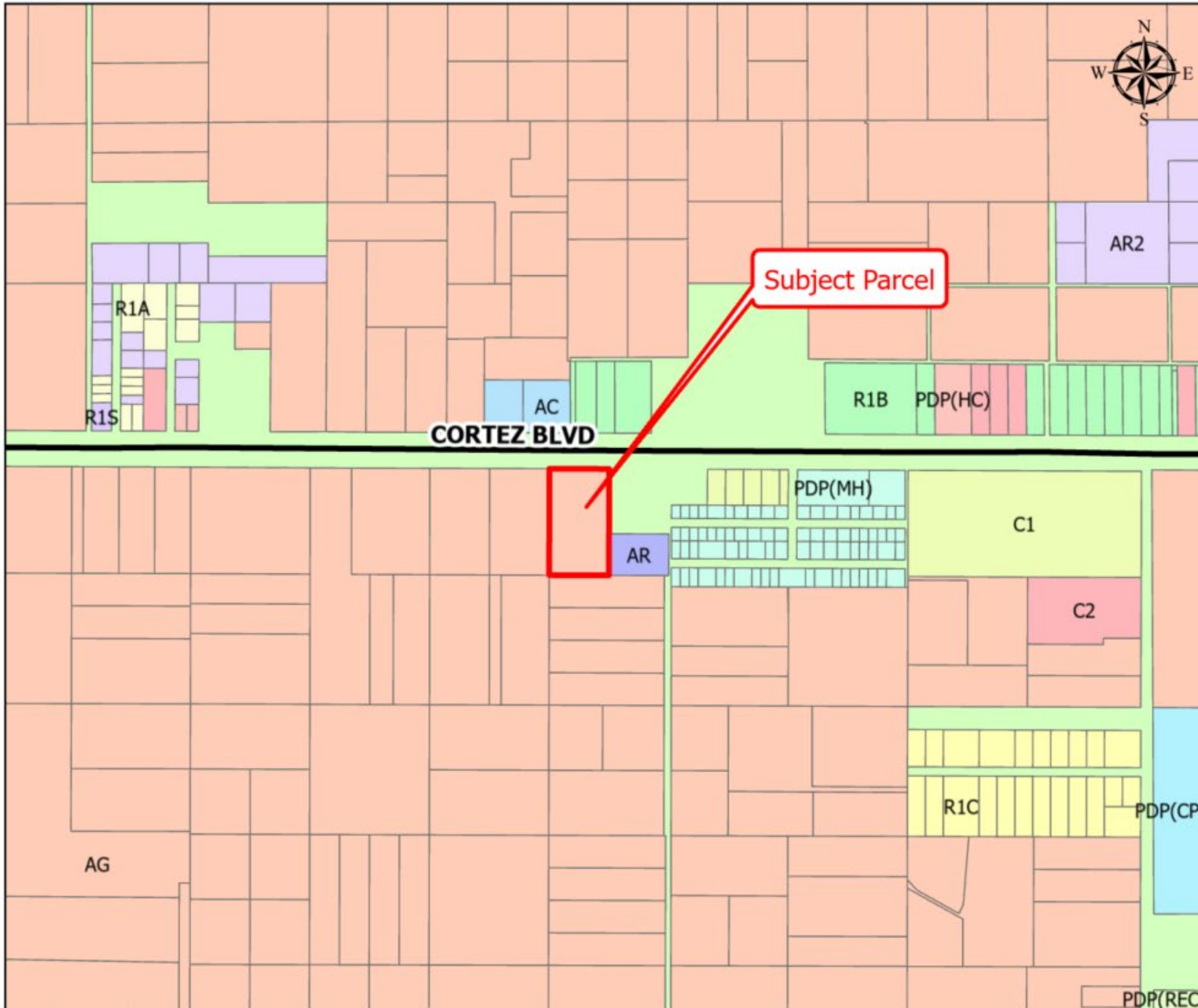

Legend

Zoning_

- AC
- AG
- AR
- AR2
- C1
- C2
- PDP(CP)
- PDP(HC)
- PDP(MH)
- PDP(REC)
- R1A
- R1B
- R1C
- R1S

