

Received

JUL 06 2022

Planning Department
Hernando County, Florida

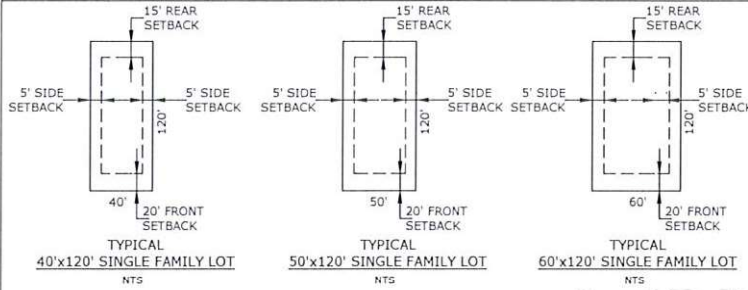

LAND USE TABLE			
LAND USE	ACRES ±	UNITS	DENSITY
SINGLE FAMILY RESIDENTIAL	258.3	928	
CASITAS MULTI FAMILY	26.0	200	
RECREATION	11.8		
TOTAL	296.1	1128	3.81 D.U. / Ac.

SITE DATA

APPLICANT: OAK HILL LAND LLC.
18125 WAYNE RD.
ODESSA, FL 33556

PARCEL AREA: ±296.1

PARCEL KEY NUMBERS: 1797489, 1797498 & 01725191
LOCATED IN SECTIONS 30, 31 AND 34, TOWNSHIP 22 S., RANGE 18 E., HERNANDO COUNTY, FLORIDA.

PROPOSED ZONING: COMBINED PLANNED DEVELOPMENT PROJECT WITH SINGLE FAMILY & MULTI FAMILY RESIDENTIAL. [C/PDP (SF) (MF)]

FUTURE LAND USE MAP DESIGNATION: RURAL, RESIDENTIAL.

FLOOD INSURANCE RATE MAP (FIRM):
COMMUNITY PANEL NO. 12053C0155D EFFECTIVE DATE
FEBRUARY 2, 2012

TOTAL NUMBER OF LOTS: 1128

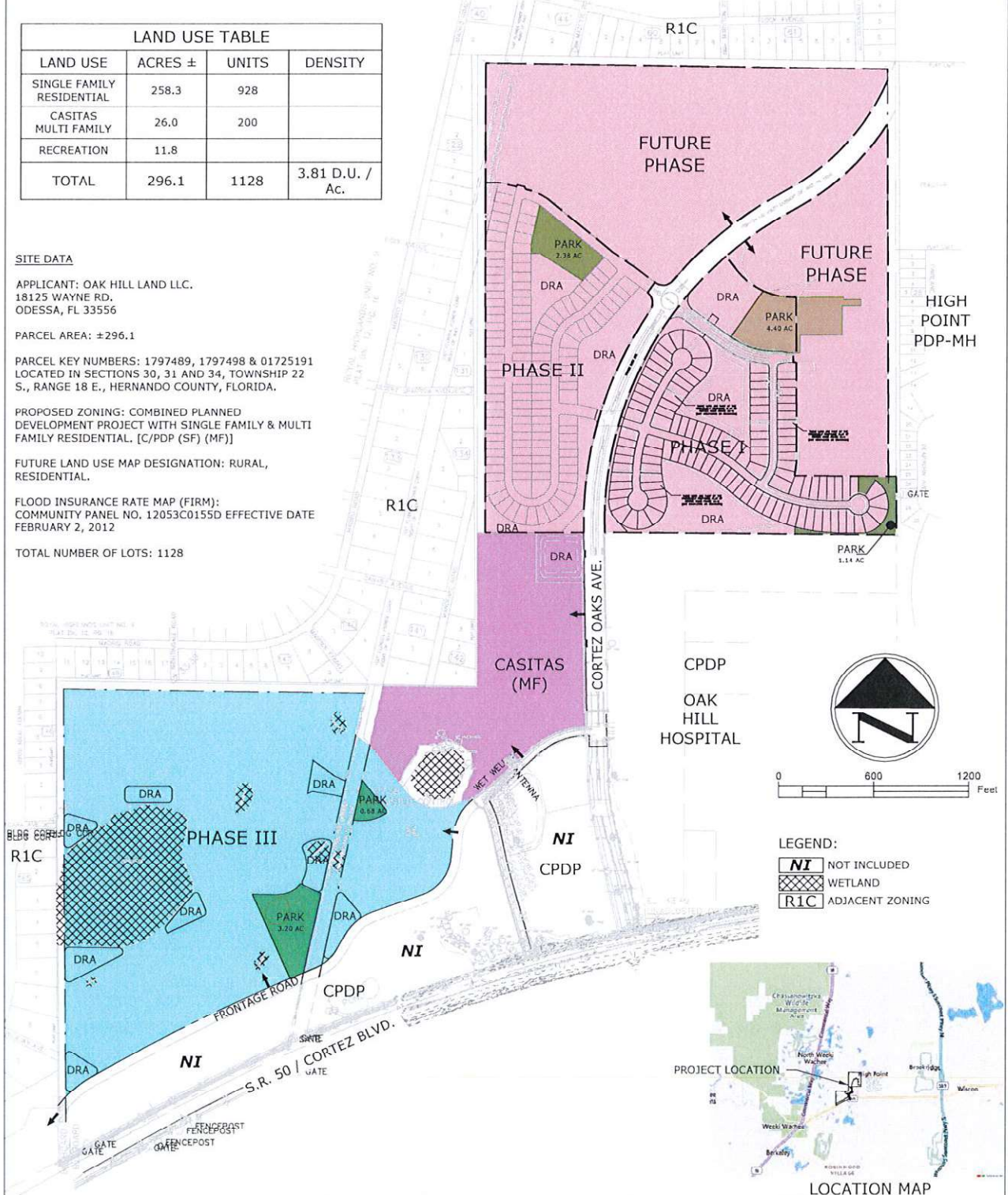

DATE	REV. BY/REV. NO.	REVISION

WHEN PRINTED TO SCALE, DRAWING SIZE SHALL BE 11" X 17"

REUSE OF DOCUMENT

THIS DOCUMENT, COMPRISED OF THE INCORPORATED DEAS AND DESIGN PROFESSIONAL SERVICE, IS THE PROPERTY OF COASTAL ENGINEERING ASSOCIATES, INC. AND IS NOT TO BE USED, IN WHOLE OR IN PART FOR ANY OTHER PURPOSE WITHOUT THE WRITTEN AUTHORIZATION OF COASTAL ENGINEERING ASSOCIATES, INC.

Coastal Engineering
Planning
Surveying
Environmental
Transportation
Construction Management

engineering associates, inc.

966 Candlelight Boulevard • Brooksville • Florida 34601
(352) 766-9423 • Fax (352) 799-8339
EB-0000142

REZONING MASTER PLAN

WATERFORD