

## ***File H-24-22 Cone & Graham***

Proposed New Performance Condition:

### A. Planning

- Setbacks
  - I. Internal Single Family Detached Lot
    - Front 25'
    - Side 7.5'
    - Rear 15'
  - Minimum Lot Size – 6,000 sf

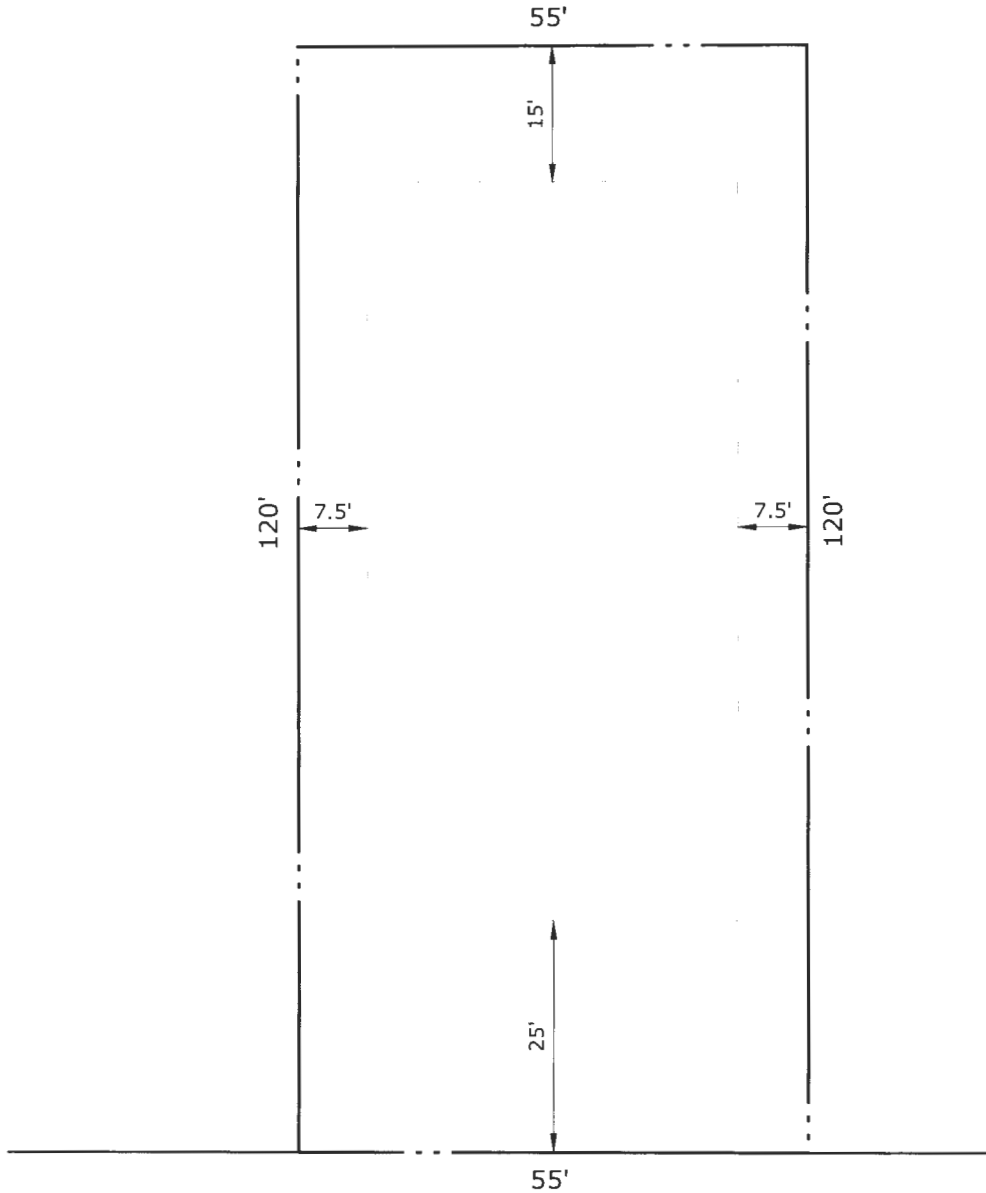

TYPICAL  
55'x120' SINGLE FAMILY LOT  
 NTS

**Coastal**  
 engineering associates, inc.

Engineering  
 Planning  
 Surveying  
 Environmental  
 Traffic  
 Transportation  
 Construction Management

966 Candlelight Boulevard - Brooksville - Florida 34601  
 (352) 796-9423 - Fax (352) 799-8359  
 EB-0000142

TYPICAL LOT DETAIL

STANDARD

DATE  
 8/20/24

17010

**1**