

PARCEL_KEY	PARCEL_SHO	PARCEL_NUM	OWNER_NAME
527479	12	R32 323 17 5130 0790 0120	ANANIA DAVID
526960	13	R32 323 17 5130 0787 0130	BOLIN FRANCIS N, BOLIN MICHELLE A
527362	22	R32 323 17 5130 0789 0220	BREWSTER RICHARD RUSSELL JR, BREWSTER
296398	1	R32 323 17 5130 0787 0010	BURKEY JASON M, BURKEY AMANDA C
527308	16	R32 323 17 5130 0789 0160	CARCANA FRANCISCO
526899	6	R32 323 17 5130 0787 0060	CAUDILL RACHEL M, GONZALEZ BRENT
527558	9	R32 323 17 5130 0791 0090	CHAMORRO MARIA DEL CARMEN CABALLERO
527004	5	R32 323 17 5130 0788 0050	CORBETT CHARLES W
527399	4	R32 323 17 5130 0790 0040	COTRONEO MARIA
527237	9	R32 323 17 5130 0789 0090	CPI AMHERST SFR PROGRAM OWNER LLC
526933	10	R32 323 17 5130 0787 0100	CPI AMHERST SFR PROGRAM OWNER LLC
527969	26	R32 323 17 5130 0792 0260	CROCKER MELODY A TTEE
526988	3	R32 323 17 5130 0788 0030	CRONIN HEATHER A
527371	2	R32 323 17 5130 0790 0020	DAMICO BRAD, DAMICO DAWN
527567	10	R32 323 17 5130 0791 0100	DAVILA DAN N, DAVILA TAMMY L QUINONES,
527683	23	R32 323 17 5130 0789 0230	DECOLA ALDO C, DECOLA GRACE K
526924	9	R32 323 17 5130 0787 0090	DENEWETH MICHAEL, DENEWETH KATHLEEN
527576	11	R32 323 17 5130 0791 0110	DOMAN THOMAS R JR, DOMAN PATRICIA
527282	14	R32 323 17 5130 0789 0140	DRAKE TERRY V SR, BURTON DEBBIE Y
296414	1	R32 323 17 5130 0789 0010	DUNCAN JARRETT S
527415	6	R32 323 17 5130 0790 0060	EXEMPT PER PUBLIC RECORD LAWS
527193	5	R32 323 17 5130 0789 0050	GRANT KEON J, MOORE ROSHAE L
1461787	DRA	R32 323 17 5130 0789 0000	HERNANDO COUNTY
1036827	E1	R32 323 17 5130 00E1 0000	HERNANDO COUNTY
527353	21	R32 323 17 5130 0789 0210	HOME SFR BORROWER LLC
527460	11	R32 323 17 5130 0790 0110	IMSCHWEILER ALEX RUSSEL WILLIAM,
527585	12	R32 323 17 5130 0791 0120	JONES DEBORAH G
527246	10	R32 323 17 5130 0789 0100	KELLETT RENEE
527549	8	R32 323 17 5130 0791 0080	KLUEPFEL ROSEMARIE
527219	7	R32 323 17 5130 0789 0070	KOCH KATHLEEN A LIFE ESTATE
526880	5	R32 323 17 5130 0787 0050	LOPEZ EDWIN MARTINEZ, LOPEZ NILDA G
527184	4	R32 323 17 5130 0789 0040	LOUIS-JEAN OCDORE Y, MICHEL JOCELYNE
527638	17	R32 323 17 5130 0791 0170	LOWE DONALD K, NAME RACHELLE E
526853	2	R32 323 17 5130 0787 0020	MALHAM KENNETH T LIFE ESTATE
527326	18	R32 323 17 5130 0789 0180	MARKFORD RICHARD E, MARKFORD LORRAINE
527200	6	R32 323 17 5130 0789 0060	MARONDA HOMES LLC OF FLORIDA
527594	13	R32 323 17 5130 0791 0130	MELENDEZ LUCY TTEE
527601	14	R32 323 17 5130 0791 0140	MELENDEZ LUCY TTEE
527692	24	R32 323 17 5130 0789 0240	MERITAGE HOMES OF FLORIDA INC
526951	12	R32 323 17 5130 0787 0120	MESA VERDE ASSETS LLC
527406	5	R32 323 17 5130 0790 0050	MORTON PETER, MORTON PAMELA
527166	2	R32 323 17 5130 0789 0020	MULLINS PATRICK, MULLINS CRISLYNN
527175	3	R32 323 17 5130 0789 0030	MURRAY MAUREEN E
527273	13	R32 323 17 5130 0789 0130	NELSON GEORGE C, NELSON DIANE M
527433	8	R32 323 17 5130 0790 0080	PAALVAST JOHN W, PAALVAST CATHERINE
527424	7	R32 323 17 5130 0790 0070	PASTORELLI DOTTIE JO

296423 1	R32 323 17 5130 0790 0010	PAWLOSKI RAYMOND R, PAWLOSKI CHERYL A
526942 11	R32 323 17 5130 0787 0110	PHILLIPS DAKOTA, PHILLIPS GIANNA
526979 2	R32 323 17 5130 0788 0020	POINDEXTER THERESA, POINDEXTER WILLIAM
527291 15	R32 323 17 5130 0789 0150	RENTAS NICHOLAS LUIS, ROSARIO JUSTINE
417294 E	R32 323 17 5130 00E0 0000	RYAN AND JAKE LLC
527451 10	R32 323 17 5130 0790 0100	SCHAFFER JOHN R LIFE ESTATE
527335 19	R32 323 17 5130 0789 0190	SPOONER MATTHEW
527344 20	R32 323 17 5130 0789 0200	STEADFAST CONTRACTING LLC
527610 15	R32 323 17 5130 0791 0150	STEVENSON AMIE LYNN
527987 28	R32 323 17 5130 0792 0280	SUAREZ JESSICA J
527978 27	R32 323 17 5130 0792 0270	TURPIN GARFIELD R, RICHARDS-TURPIN
527228 8	R32 323 17 5130 0789 0080	VALENTIN HECTOR
526871 4	R32 323 17 5130 0787 0040	VONADA WILLIAM J JR, VONADA REBECCA
527629 16	R32 323 17 5130 0791 0160	WALSH SHERRY L, WALSH JORDAN R
527255 11	R32 323 17 5130 0789 0110	WARD LYDIA R, DHONDT PATRICIA F
527727 2	R32 323 17 5130 0792 0020	WEST JAMES G, WEST HEATHER E
526906 7	R32 323 17 5130 0787 0070	WILBERG EDWARD C, MANN THERESA M
527317 17	R32 323 17 5130 0789 0170	WILL JAMES, WILL ANGEL
296441 1	R32 323 17 5130 0792 0010	WJHFL LLC
527264 12	R32 323 17 5130 0789 0120	YUHAS SEAN
526997 4	R32 323 17 5130 0788 0040	ZAMORA CLAUDIA L

OWNER\_NA\_1

MARY ANN

FARRINGTON PATRICIA A

(DRA)  
FIRE STATION (SH DR & WHITEWOOD)  
C/O HAVENBROOK HOMES  
ANDERSON LACEY A

MARTINEZ

MAIL\_ADDR1  
2350 RING RD  
2248 RING RD  
2363 RING RD  
13276 ASBURY ST  
2321 RING RD  
13318 ASBURY ST  
13321 ASBURY ST  
2222 WHITEWOOD AVE  
2298 RING RD  
5001 PLAZA ON THE LK STE 200  
5001 PLAZA ON THE LK STE 200  
11455 SW 82ND COURT RD  
13246 ASBURY ST  
2439 CULBREATH RD  
13313 ASHBURY ST  
19906 TATTNALL WAY  
13317 MITTEN LN  
13305 ASBURY ST  
2305 RING RD  
8085 E 28TH AVE  
  
2278 WHITEWOOD AVE  
20 N MAIN ST RM 263  
20 N MAIN ST RM 460  
3505 KOGER BLVD STE 400  
2362 RING RD  
2296 AINSWORTH AVE  
13247 ASBURY ST  
10 SHIRLEY CT  
2262 WHITEWOOD AVE  
13308 ASBURY ST  
2286 WHITEWOOD AVE  
2408 RING RD  
13290 ASBURY ST  
2333 RING RD  
9416 CAMDEN FIELD PKWY  
4151 HAWKS BILL CT  
4151 HAWKS BILL CT  
10117 PRINCESS PALM AVE STE 550  
5001 PLAZA ON THE LK STE 200  
2290 RING RD  
2302 WHITEWOOD AVE  
2294 WHITEWOOD AVE  
2297 RING RD  
2285 AINSWORTH AVE  
2275 AINSWORTH AVE

ODETTE M

7615 JENKS RD  
13303 MITTEN LN  
13238 ASBURY ST  
2313 RING RD  
4446 MARSALIS CT  
2301 AINSWORTH AVE  
2339 RING RD  
3628 HARPERS FERRY DR  
2390 RING RD  
2379 RING RD  
2387 RING RD  
13231 ASBURY ST  
13298 ASBURY ST  
2400 RING RD  
13255 ASBURY ST  
13310 SPRING HILL DR  
13328 ASBURY ST  
2327 RING RD  
3091 GOVERNORS LAKE DR STE 300  
2289 RING RD  
13254 ASBURY ST

MAIL\_ADDR2

SPRING HILL FL 34609-5174  
SPRING HILL FL 34609-5172  
SPRING HILL FL 34609  
SPRING HILL FL 34609-5116  
SPRING HILL FL 34609-5175  
SPRING HILL FL 34609-5118  
SPRING HILL FL 34609-5119  
SPRING HILL FL 34609  
SPRING HILL FL 34609-5172  
AUSTIN TX 78746-1053  
AUSTIN TX 78746-1053  
OCALA FL 34481-3566  
SPRING HILL FL 34609-5114  
BROOKSVILLE FL 34602-6137  
SPRING HILL FL 34609  
BROOKSVILLE FL 34601-6475  
SPRING HILL FL 34609-5161  
SPRING HILL FL 34609-5119  
SPRING HILL FL 34609-5175  
DENVER CO 80238-3157

SPRING HILL FL 34609-5060  
BROOKSVILLE FL 34601  
BROOKSVILLE FL 34601-2893  
DULUTH GA 30096-7672  
SPRING HILL FL 34609-5174  
SPRING HILL FL 34609-5187  
SPRING HILL FL 34609-5115  
EAST NORTHPORT NY 11731-5819  
SPRING HILL FL 34609-5060  
SPRING HILL FL 34609-5118  
SPRING HILL FL 34609-5060  
SPRING HILL FL 34609-5100  
SPRING HILL FL 34609  
SPRING HILL FL 34609-5175  
RIVERVIEW FL 33578-0519  
WESLEY CHAPEL FL 33543-4822  
WESLEY CHAPEL FL 33543-4822  
TAMPA FL 33610-8301  
AUSTIN TX 78746-1053  
SPRING HILL FL 34609-5172  
SPRING HILL FL 34609-5061  
SPRING HILL FL 34609  
SPRING HILL FL 34609-5173  
SPRING HILL FL 34609-5188  
SPRING HILL FL 34609-5188

MAIL\_ADDR3 MAIL\_ADDR4

HARBOR BEACH MI 48441-8369  
SPRING HILL FL 34609-5161  
SPRING HILL FL 34609-5114  
SPRING HILL FL 34609  
SPRING HILL FL 34609  
SPRING HILL FL 34609-5102  
SPRING HILL FL 34609-5175  
TALLAHASSEE FL 32308-9429  
SPRING HILL FL 34609-5176  
SPRING HILL FL 34609-5177  
SPRING HILL FL 34609-5177  
SPRING HILL FL 34609-5115  
SPRING HILL FL 34609-5116  
SPRING HILL FL 34609-5100  
SPRING HILL FL 34609-5115  
SPRING HILL FL 34609-5183  
SPRING HILL FL 34609-5118  
SPRING HILL FL 34609-5175  
PEACHTREE CORNERS GA 30071-1133  
SPRING HILL FL 34609  
SPRING HILL FL 34609-5114

PARCEL_KEY	PARCEL_SHO	PARCEL_NUM	OWNER_NAME
527479	12	R32 323 17 5130 0790 0120	ANANIA DAVID
527308	16	R32 323 17 5130 0789 0160	CARCANA FRANCISCO
527399	4	R32 323 17 5130 0790 0040	COTRONEO MARIA
527371	2	R32 323 17 5130 0790 0020	DAMICO BRAD, DAMICO DAWN
527576	11	R32 323 17 5130 0791 0110	DOMAN THOMAS R JR, DOMAN PATRICIA
527282	14	R32 323 17 5130 0789 0140	DRAKE TERRY V SR, BURTON DEBBIE Y
527415	6	R32 323 17 5130 0790 0060	EXEMPT PER PUBLIC RECORD LAWS
527193	5	R32 323 17 5130 0789 0050	GRANT KEON J, MOORE ROSHAE L
527460	11	R32 323 17 5130 0790 0110	IMSCHWEILER ALEX RUSSEL WILLIAM,
527585	12	R32 323 17 5130 0791 0120	JONES DEBORAH G
527184	4	R32 323 17 5130 0789 0040	LOUIS-JEAN OCDORE Y, MICHEL JOCELYNE
527326	18	R32 323 17 5130 0789 0180	MARKFORD RICHARD E, MARKFORD LORRAINE
527594	13	R32 323 17 5130 0791 0130	MELENDEZ LUCY TTEE
527601	14	R32 323 17 5130 0791 0140	MELENDEZ LUCY TTEE
527406	5	R32 323 17 5130 0790 0050	MORTON PETER, MORTON PAMELA
527175	3	R32 323 17 5130 0789 0030	MURRAY MAUREEN E
527273	13	R32 323 17 5130 0789 0130	NELSON GEORGE C, NELSON DIANE M
527433	8	R32 323 17 5130 0790 0080	PAALVAST JOHN W, PAALVAST CATHERINE
527424	7	R32 323 17 5130 0790 0070	PASTORELLI DOTTIE JO
296423	1	R32 323 17 5130 0790 0010	PAWLOSKI RAYMOND R, PAWLOSKI CHERYL A
527291	15	R32 323 17 5130 0789 0150	RENTAS NICHOLAS LUIS, ROSARIO JUSTINE
527451	10	R32 323 17 5130 0790 0100	SCHAFFER JOHN R LIFE ESTATE
527255	11	R32 323 17 5130 0789 0110	WARD LYDIA R, DHONDT PATRICIA F
527317	17	R32 323 17 5130 0789 0170	WILL JAMES, WILL ANGEL
527264	12	R32 323 17 5130 0789 0120	YUHAS SEAN

OWNER_NA_1	MAIL_ADDR1	MAIL_ADDR2	MAIL_ADDR3
	2350 RING RD	SPRING HILL FL 34609-5174	
	2321 RING RD	SPRING HILL FL 34609-5175	
	2298 RING RD	SPRING HILL FL 34609-5172	
	2439 CULBREATH RD	BROOKSVILLE FL 34602-6137	
	13305 ASBURY ST	SPRING HILL FL 34609-5119	
	2305 RING RD	SPRING HILL FL 34609-5175	
	2278 WHITEWOOD AVE	SPRING HILL FL 34609-5060	
ANDERSON LACEY A	2362 RING RD	SPRING HILL FL 34609-5174	
	2296 AINSWORTH AVE	SPRING HILL FL 34609-5187	
	2286 WHITEWOOD AVE	SPRING HILL FL 34609-5060	
	2333 RING RD	SPRING HILL FL 34609-5175	
	4151 HAWKS BILL CT	WESLEY CHAPEL FL 33543-4822	
	4151 HAWKS BILL CT	WESLEY CHAPEL FL 33543-4822	
	2290 RING RD	SPRING HILL FL 34609-5172	
	2294 WHITEWOOD AVE	SPRING HILL FL 34609	
	2297 RING RD	SPRING HILL FL 34609-5173	
	2285 AINSWORTH AVE	SPRING HILL FL 34609-5188	
	2275 AINSWORTH AVE	SPRING HILL FL 34609-5188	
	7615 JENKS RD	HARBOR BEACH MI 48441-8369	
	2313 RING RD	SPRING HILL FL 34609	
	2301 AINSWORTH AVE	SPRING HILL FL 34609-5102	
	13255 ASBURY ST	SPRING HILL FL 34609-5115	
	2327 RING RD	SPRING HILL FL 34609-5175	
	2289 RING RD	SPRING HILL FL 34609	



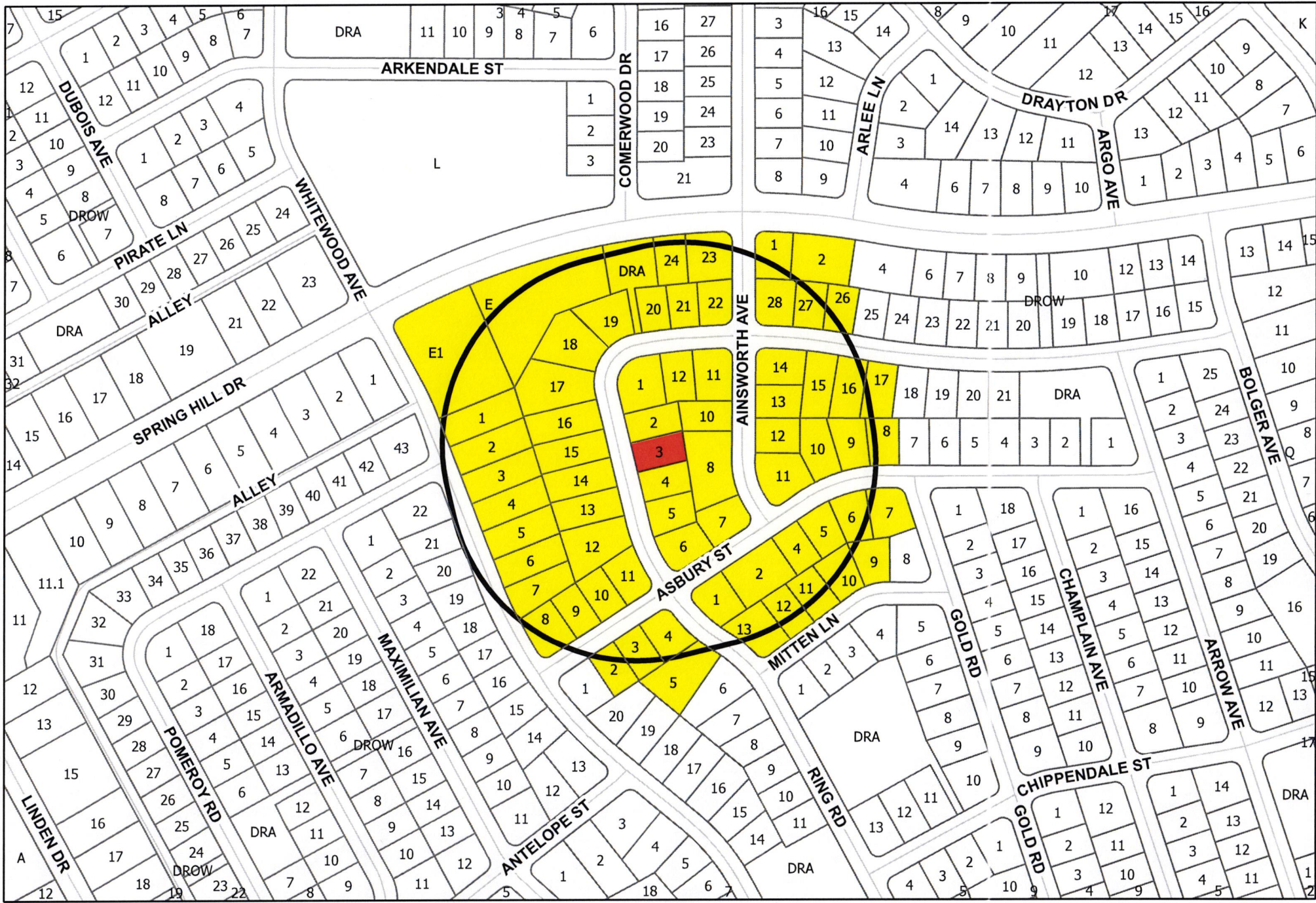

Not to Scale



This map was prepared by this office to be used as an aid in land parcel location and identification only. All land locations, right-of-way widths, acreages, and utility locations are subject to field survey or other appropriate verification. Map reflects parcels and boundaries as they existed on 05/18/2022.

# BRATCHER APO

- Subject Parcel
- 500 ft Buffer
- Parcels within 500 ft





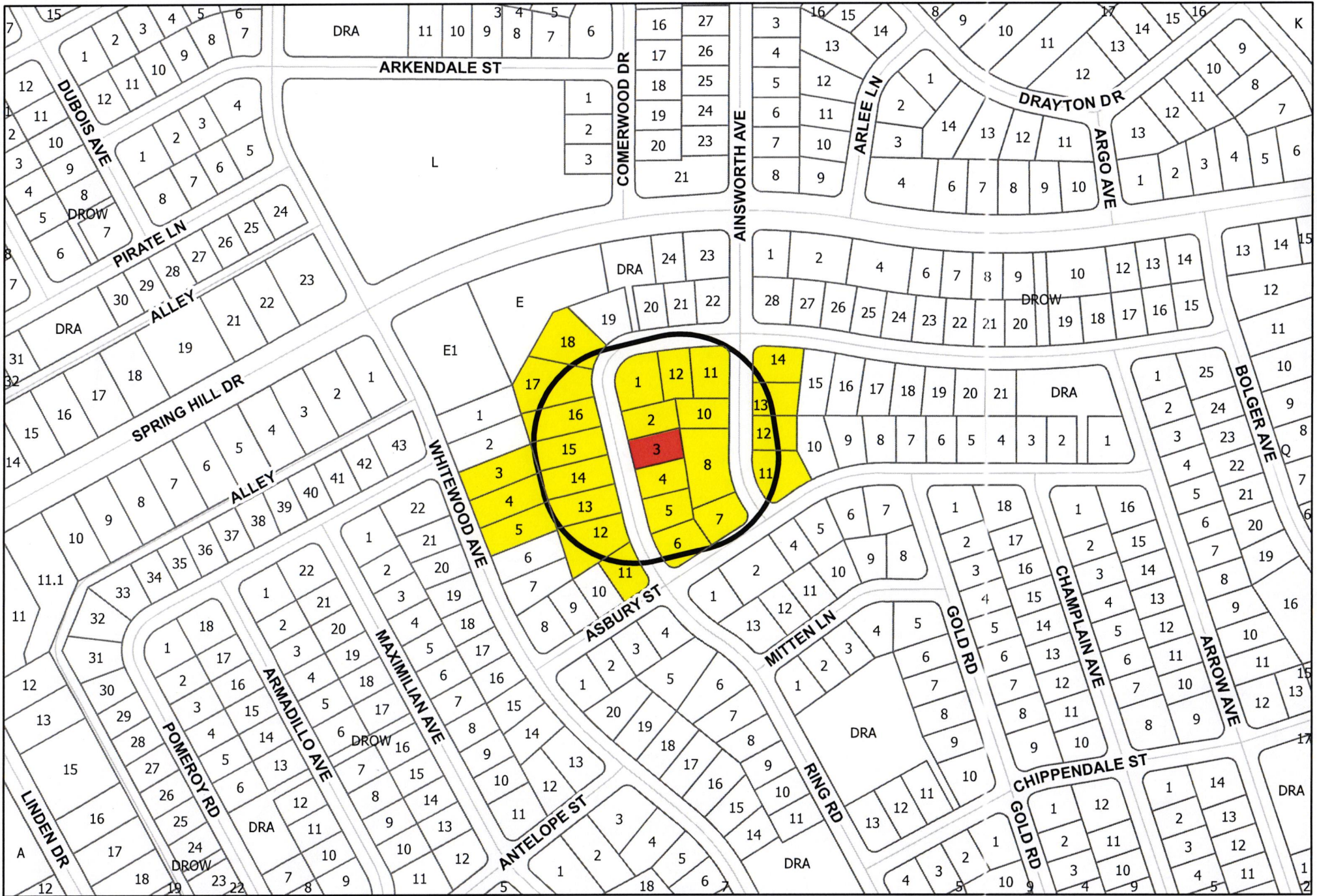

Not to Scale



This map was prepared by this office to be used as an aid in land parcel location and identification only. All land locations, right-of-way widths, acreages, and utility locations are subject to field survey or other appropriate verification. Map reflects parcels and boundaries as they existed on 05/18/2022.

## BRATCHER APO

- Subject Parcel
- 250 ft Buffer
- Parcels within 250 ft

