

Received

JAN 28 2023

Lamson Ave.

Planning Department
Hernando County, Florida

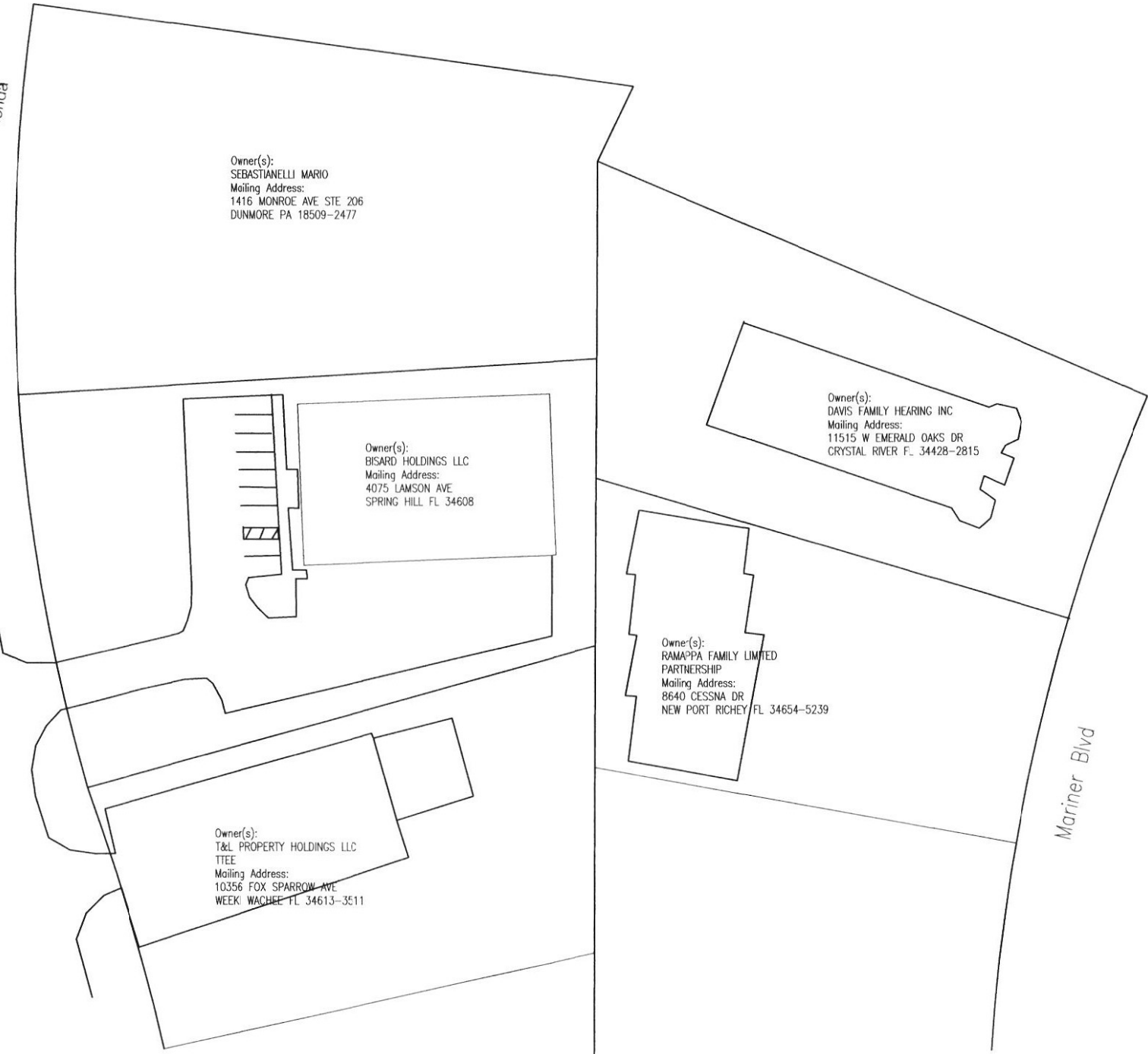

Owner(s):
SEBASTIANELLI MARIO
Mailing Address:
1416 MONROE AVE STE 206
DUNMORE PA 18509-2477

Owner(s):
BISARD HOLDINGS LLC
Mailing Address:
4075 LAMSON AVE
SPRING HILL FL 34608

Owner(s):
T&L PROPERTY HOLDINGS LLC
TTEE
Mailing Address:
10356 FOX SPARROW AVE
WEEKI WACHEE FL 34613-3511

Owner(s):
RAMAPPA FAMILY LIMITED
PARTNERSHIP
Mailing Address:
8640 CESSNA DR
NEW PORT RICHEY FL 34654-5239

Owner(s):
DAVIS FAMILY HEARING INC
Mailing Address:
11515 W EMERALD OAKS DR
CRYSTAL RIVER FL 34428-2815

Mariner Blvd

Single use re-zoning of
Parcel Key# 623748 from C2 to C4.

JOB NAME: Bisard Holding
LOCATION: 4075 Lamson Ave
Spring Hill Fl. 34608
Floor Plan

CONTRACTOR:
Corbin's Custom Design
1606 Turnbull Dr
Spring Hill, FL 34609
Tel: 352-686-7988
CSC# 255794

Home Designed &
Drawn By:
Bill Corbin
SCALE: 1/4" = 1'
DATE: 12/6/2023