

PARCEL : 900.01
WPI/SEG : 4367331
S.R. NO.: 700/US 98
COUNTY : HERNANDO
SECTION : 0808-101
MANAGING DISTRICT: SEVEN
FOLIO #: R10-421-18-0000-0010-0010
PARCEL KEY: 00327505

LA.16

LICENSE AGREEMENT

THIS AGREEMENT, entered into by and between the STATE OF FLORIDA DEPARTMENT OF TRANSPORTATION, hereinafter called the FDOT, and HERNANDO COUNTY, a Political Subdivision of the State of Florida, hereinafter called the Licensors

In consideration of the benefits accruing unto the Licensors, the parties agree as follows:

Licensors hereby grants to FDOT a license to occupy and use, subject to all of the terms and conditions hereof, the following described premises:

SEE EXHIBIT A

The premises may be occupied and used by FDOT solely for Shoulder Widening & sloping, grading, tying in, harmonizing and reconnecting existing features of the Licensors's property with the highway improvements which are to be constructed together with incidental purposes related thereto during the period beginning with the date first above written and continuing until completion of the transportation project, but not later than the last day of December, 2026.

The making, execution, and delivery of this agreement by licensors has been induced by no representations, statements, warranties, or agreements other than those contained herein. This agreement embodies the entire understanding of the parties and there are no further or other agreements or understandings, written or oral, in effect between the parties relating to the subject matter hereof.

IN WITNESS WHEREOF, the Licensors/Hernando County has caused to be executed in its name, by its Board of County Commissioners acting by the Chairperson or Vice-Chairperson of said Board, this agreement effective this _____ day of _____ 2025.

ATTEST: _____
Clerk (or Deputy Clerk)

(S E A L)

HERNANDO County, Florida,
By Its Board of County Commissioners

By: _____
Its Chairperson (or Vice-Chairperson)

PRINT NAME _____

ADDRESS 15470 Flight Path Dr

BROOKSVILLE, FL. 34604

Approved As To Form
And Legal Sufficiency

By Victoria Anderson
County Attorney's Office

EXHIBIT A

LICENSE AGREEMENT

A portion of the Northwest 1/4 of Section 11, Township 21 South, Range 18 East, Hernando County, Florida, being more particularly described as follows:

Commence at a 4"x4" Concrete Monument with disk (LS 2660) marking the Southwest corner of the Northwest 1/4 of Section 11, Township 21 South, Range 18 East, Hernando County, Florida; thence along the South line of said Northwest 1/4 of Section 11, S 89°54'02" W, a distance of 1,071.58 feet to Station 669+30.34 on the Survey Line of State Road 700 (U.S. 98) (per Florida Department of Transportation Right of Way Control Survey, Work Program Item Segment Number 405017 1); thence along said Survey Line, N 48°02'51" W, a distance of 329.66 feet to Station 672+60.00; thence departing said Survey Line, S 41°57'09" W, a distance of 68.00 feet to a point on the Westerly Right of Way Line of said State Road 700 (U.S. 98) and the POINT OF BEGINNING; thence departing said Westerly Right of Way Line, S 41°57'09" W, a distance of 140.00 feet; thence N 48°02'51" W, a distance of 140.00 feet; thence N 41°57'09" E, a distance of 140.00 feet to a point on the aforesaid Westerly Right of Way Line of State Road 700 (U.S. 98); thence along said Westerly Right of Way Line, S 48°02'51" E, a distance of 140.00 feet to the POINT OF BEGINNING.

Containing 19,600 square feet, more or less.

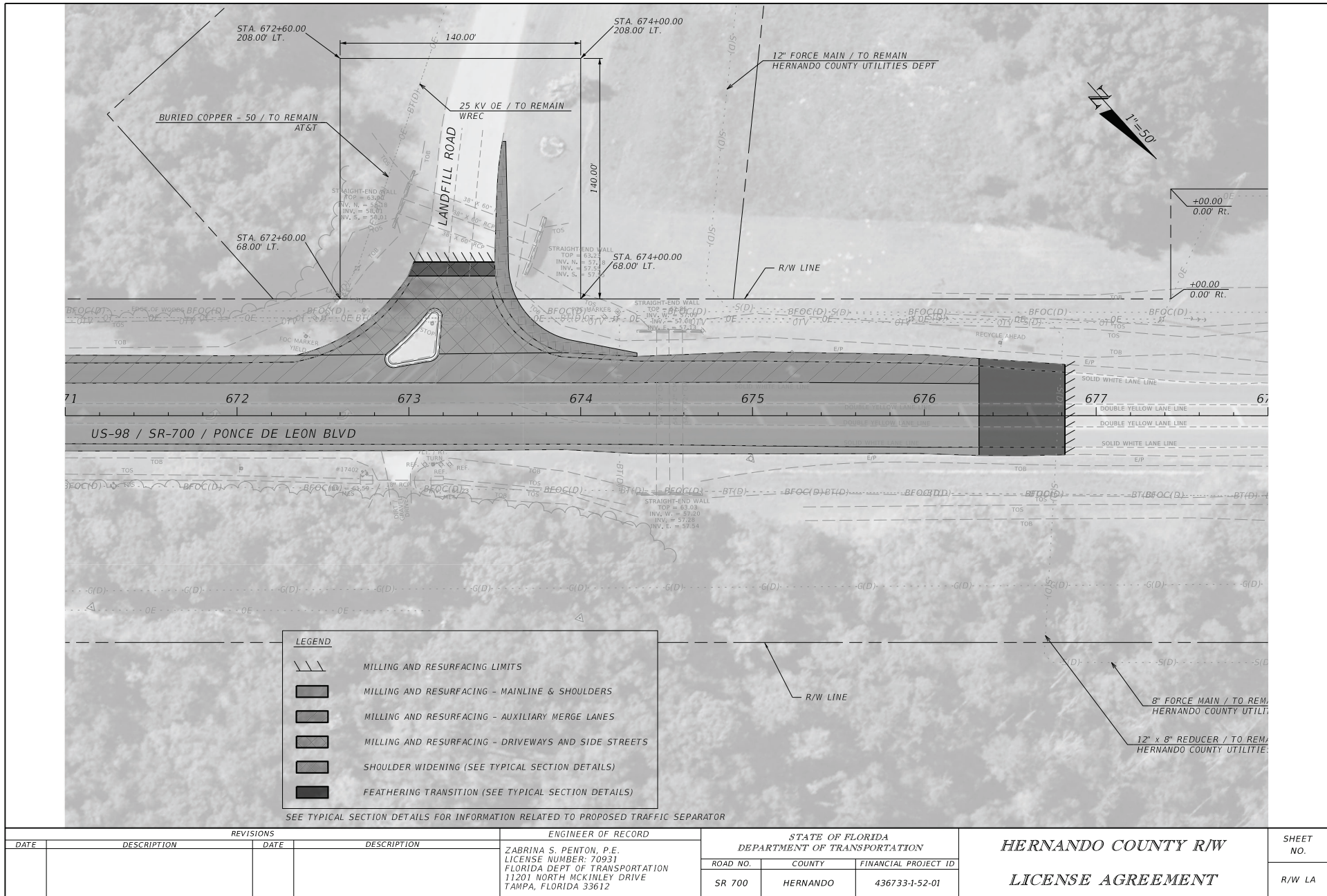

THE OFFICIAL RECORD OF THIS SHEET IS THE ELECTRONIC FILE DIGITALLY SIGNED AND SEALED UNDER RULE 61G15-23.004, F.A.C.