

V:\2020\2020-265-02 - BKV AIP Update\2020-265-02 - CAD\Resurct\2016 MVA\03_BKV_Airport_Layout_Plan Drawing (NEW) - 3:34pm - 3/3/2020 - 3/3/2020 - 3/3/2020

ID	ROADWAY ELEVATION	RUNWAY ELEVATION + PART 77 CLEARANCE REQUIREMENTS	EXISTING PENETRATION	FUTURE PENETRATION	DISPOSITION
R3	80.4	85.1	76.3	53.1	NONE
R2	68.0	83.0	74.3	43.3	NONE
R1	65.6	81.6	69.3	42.3	NONE
R4	65.1	80.1	5.8	N/A	ROAD CLOSURE
R5	66.2	80.2	7.5	N/A	ROAD CLOSURE

ID	ROADWAY ELEVATION	RUNWAY ELEVATION + PART 77 CLEARANCE REQUIREMENTS	EXISTING PENETRATION	FUTURE PENETRATION	DISPOSITION
R16	70.0	81.1	35.0	NONE	NONE
R17	71.0	86.0	39.4	NONE	NONE
R18	72.0	87.0	39.9	NONE	NONE
R19	72.0	87.0	32.0	NONE	NONE
R20	73.0	88.0	28.0	NONE	NONE
R21	69.5	84.0	20.1	NONE	NONE
R22	69.0	84.0	19.0	NONE	NONE
R23	68.0	83.0	22.0	NONE	NONE
R24	68.3	83.3	18.12	NONE	NONE

ID	ROADWAY ELEVATION	RUNWAY ELEVATION + PART 77 CLEARANCE REQUIREMENTS	EXISTING PENETRATION	FUTURE PENETRATION	DISPOSITION
R25	74.5	79.3	76.3	47.1	NONE
R26	78.0	83.0	77.6	48.2	NONE
R27	79.5	88.0	78.6	48.2	NONE
R28	74.1	85.1	75.4	46.1	NONE
R29	73.8	86.0	66.9	37.4	NONE

ID	ROADWAY ELEVATION	RUNWAY ELEVATION + PART 77 CLEARANCE REQUIREMENTS	EXISTING PENETRATION	FUTURE PENETRATION	DISPOSITION
R7	69.4	84.4	13.2	55.9	NONE
R8	71.0	86.0	17.2	61.1	NONE

NOTES:
 1. ROAD ELEVATIONS ARE ESTIMATED AND INCLUDE PART 77 CLEARANCE REQUIREMENTS (TYP)
 2. NEGATIVE PENETRATIONS INDICATE DISTANCE BELOW SURFACE (TYP)
 3. TRAVERSE WAY ID NUMBERS 9, 14 ARE NOT WITHIN THE AIRPORT SHOWN

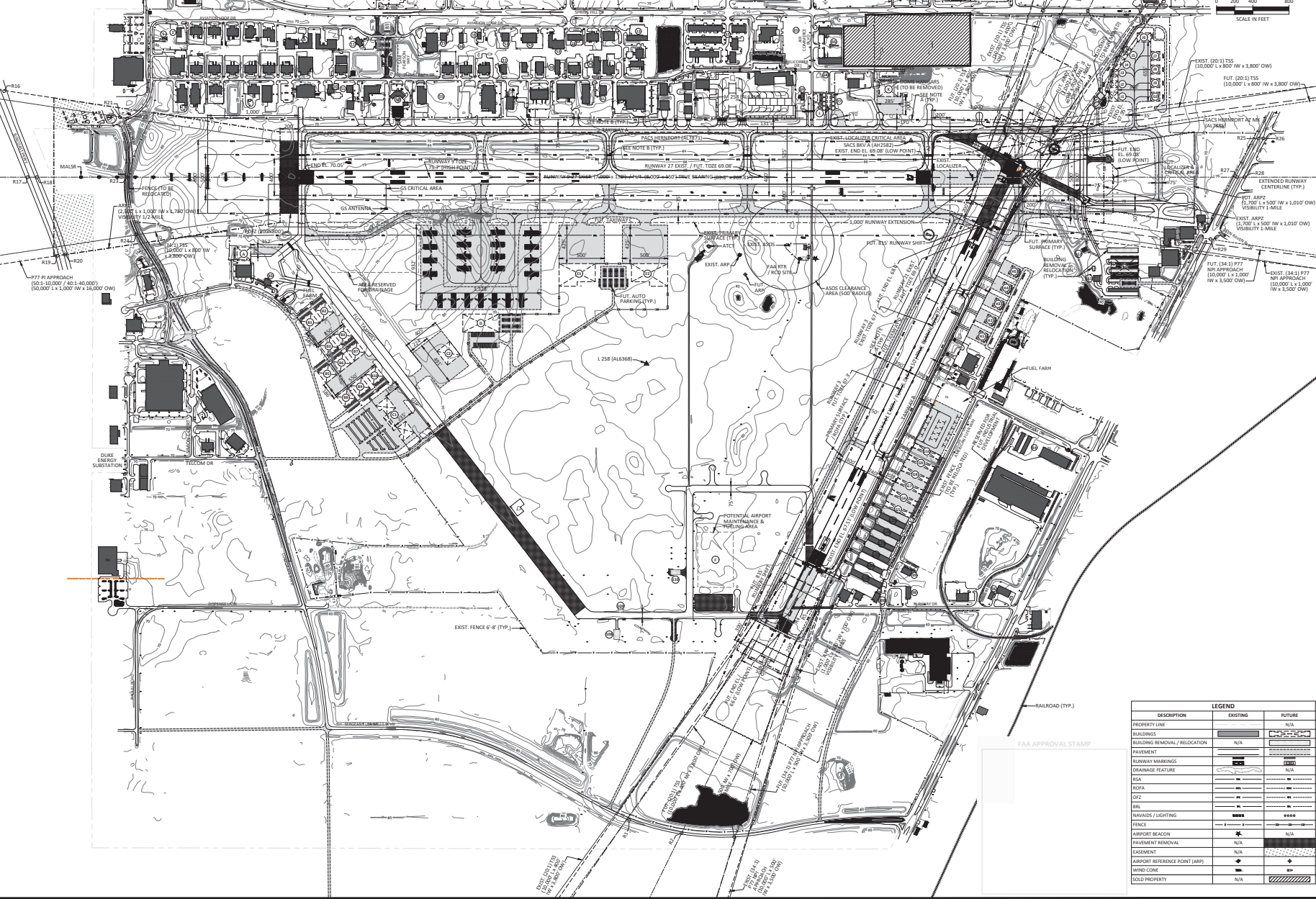

AKV
Aerial Knowledge Visual

BROOKSVILLE-TAMPA BAY REGIONAL AIRPORT
 Brooksville, Florida

Michael Baker
INTERNATIONAL

APN: MIK
 Project Number: 137218

NOTES:
 GENERAL NOTES:
 1. BASE MAPPING SOURCE: QUANTUM SPATIAL SURVEY, FROM OCTOBER 2013.
 2. THE NAVD83 VERTICAL CONTROL DATUM WAS USED FOR ALL ELEVATIONS.
 3. THE NAD83 COORDINATE SYSTEM WAS USED FOR ALL LATITUDE AND LONGITUDE COORDINATES.

PLAN REFERENCED NOTES:
 A. BUILDING RESTRICTION LINE (BRL) ASSUMES A HEIGHT OF 20' ABOVE THE NEAREST RUNWAY CENTERLINE. EXISTING HOLDING POSITION MARKINGS FOR RUNWAY 3-21 ARE LOCATED 250' FROM RUNWAY CENTERLINE. EXISTING HOLDING POSITION MARKINGS FOR RUNWAY 3-21 ARE LOCATED 200' FROM RUNWAY CENTERLINE. FUTURE HOLDING POSITION MARKINGS FOR RUNWAY 3-21 ARE LOCATED 200' FROM RUNWAY CENTERLINE. EXISTING HOLDING LINE NORTH OF TAXIWAY A ARE 134' FROM TAXIWAY CENTERLINE. EXISTING HOLDING LINE NORTH MARKINGS NORTH OF TAXIWAY A ARE 129.5' FROM TAXIWAY CENTERLINE.

CONSTRUCTION NOTICE REQUIREMENT
 TO PROTECT OPERATIONAL SAFETY AND ULTIMATE DEVELOPMENT, ALL PROPOSED CONSTRUCTION ON THE AIRPORT MUST BE COORDINATED BY THE AIRPORT OWNER WITH THE FAA AIRPORTS DISTRICT OFFICE PRIOR TO CONSTRUCTION. FAA REVIEW TIMES APPROXIMATELY 60 DAYS.

FAA DISCLAIMER
 THE CONTENTS DO NOT NECESSARILY REFLECT THE OFFICIAL POSITION OR POLICY OF THE FAA. THE OFFICE OF THE AIRPORT OWNER DOES NOT IN ANY WAY CONSTITUTE A COMMITMENT OR THE PART OF THE AIRPORT OWNER TO PARTICIPATE IN ANY DEVELOPMENT OR INVESTIGATION UNLESS INDICATED BY THE PROJECT DEVELOPER OR UNLESS OTHERWISE ACCEPTABLE IN ACCORDANCE WITH FEDERAL LAWS.

NO.	DESCRIPTION	DATE	BY
1	ISSUE FOR PERMITTING	3/3/2020	MC
2	REVISIONS TO PERMITTING	3/3/2020	MC
3	REVISIONS TO PERMITTING	3/3/2020	MC

DESCRIPTION	EXISTING	FUTURE
PROPERTY LINE	---	N/A
BUILDINGS	█	N/A
BUILDING REMOVAL / RELOCATION	█	█
PAVEMENT	▨	▨
RUNWAY MARKINGS	▬	▬
DRAINAGE FEATURE	▬	N/A
BSA	▬	▬
ROFA	▬	▬
CR	▬	▬
BSL	▬	▬
NAVAIDS / LIGHTING	▬	▬
FENCE	▬	▬
AIRPORT BEACON	★	N/A
PAVEMENT REMOVAL	N/A	▨
EASEMENT	N/A	▨
AIRPORT REFERENCE POINT (ARP)	+	+
WIND CONE	+	+
SOLD PROPERTY	N/A	▨

AIRPORT MASTER PLAN UPDATE

AIRPORT LAYOUT PLAN DRAWING

3-12-008-016-2013 / 4241042
 PLANNING
 MAY 2020 3