

# H-23-38

Photo date: 2023

This map was prepared by this office to be used as an aid in land parcel location and identification only. All land locations, right-of-way widths, acreages, and utility locations are subject to field survey or other appropriate verification.

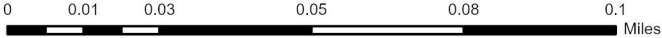



# Hernando County Comprehensive Plan Map

Existing Future Land Use: H-23-38  
Version Date: 12/09/2022

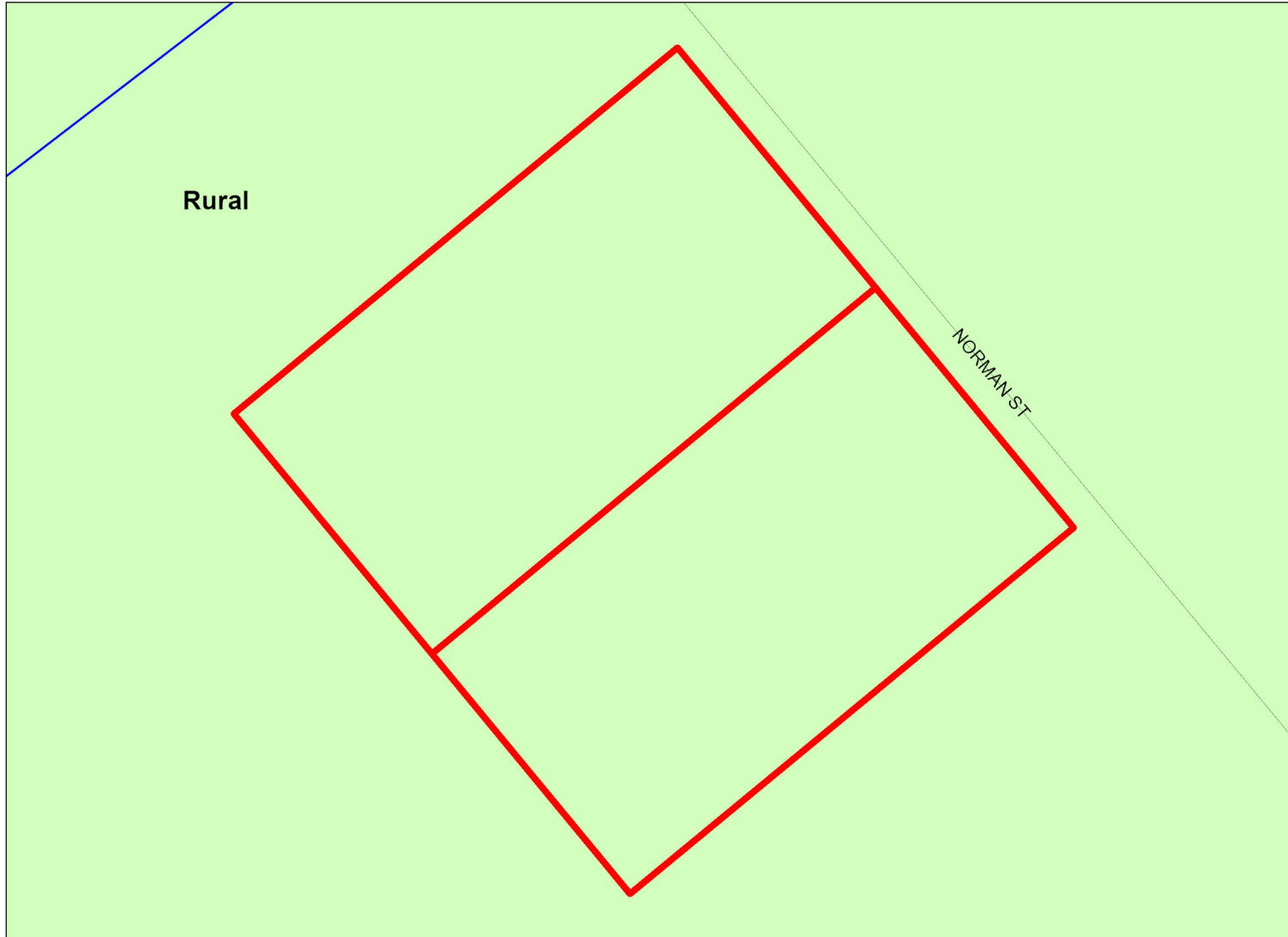

- H-23-38
- FLU Riverine District
- Regional Commercial
- FLU**
- CITY
- COMMERCIAL
- CONSERVATION
- EDUCATION
- INDUSTRIAL
- MINING
- PLANNED DEVELOPMENT
- PUBLIC FACILITIES
- RECREATION
- RESIDENTIAL
- RURAL

**Future Land Use Map**

PLEASE REFER TO THE TEXT PORTION OF THE COMPREHENSIVE PLAN IN CONJUNCTION WITH THE USE OF THE FUTURE LAND USE MAP SERIES.

NOTE: THE RIVERINE DISTRICT IS SHOWN AS A LINE SETBACK PARALLEL TO THE WEEKI WACHEE, MUD AND WITHLACOOCHEE RIVERS.

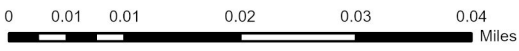

Date of mapping: 07/25/2023



# H-23-38

This map was prepared by this office to be used as an aid in land parcel location and identification only. All land locations, right-of-way widths, acreages, and utility locations are subject to field survey or other appropriate verification.

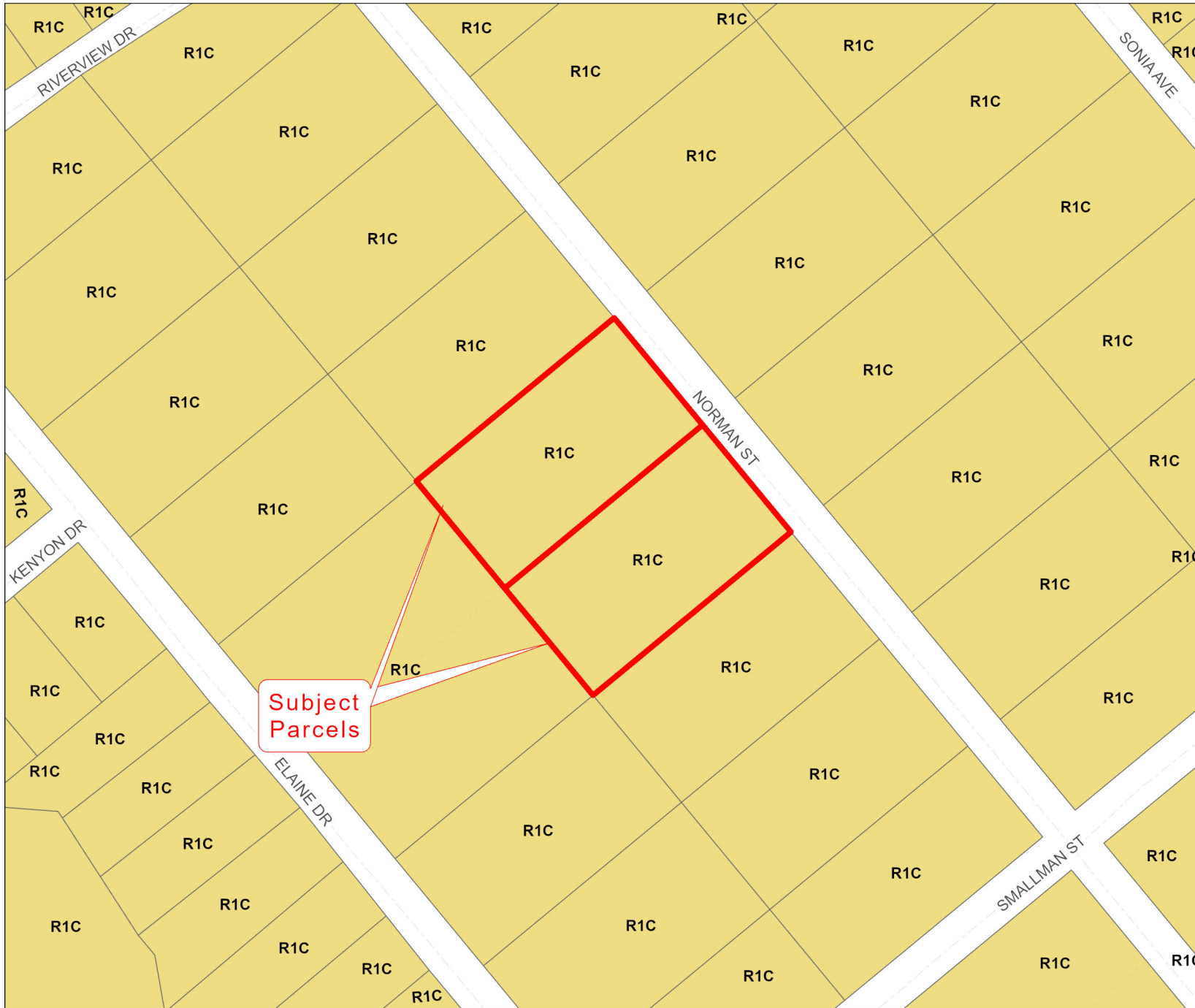

**Zoning:**

AC	PDP(HC)
AG	PDP(HHC)
AR	PDP(HID)
AR1	PDP(IND)
AR2	PDP(LI)
C1	PDP(MF)
C2	PDP(MH)
C3	PDP(NC)
C4	PDP(OP)
CITY	PDP(PSF)
CM1	PDP(REC)
CM2	PDP(RR)
CPDP	PDP(RUR)
CV	PDP(SF)
I1	PDP(SU)
I2	R1A
M	R1B
OP	R1C
PDP(AF)	R1MH
PDP(CM)	R2
PDP(CP)	R2.5
PDP(GC)	R3
PDP(GHC)	RC
	RM

