

# H-25-41 AREA MAP

This map was prepared by this office to be used as aid and land parcel location and identification only. All land locations, right-of-ways widths, acreages, and utility locations are subject to field survey or other appropriate verification.



Not to scale.

# Hernando County Comprehensive Plan Map

Existing Future Land Use: H-25-41

Version Date: 5/5/2026

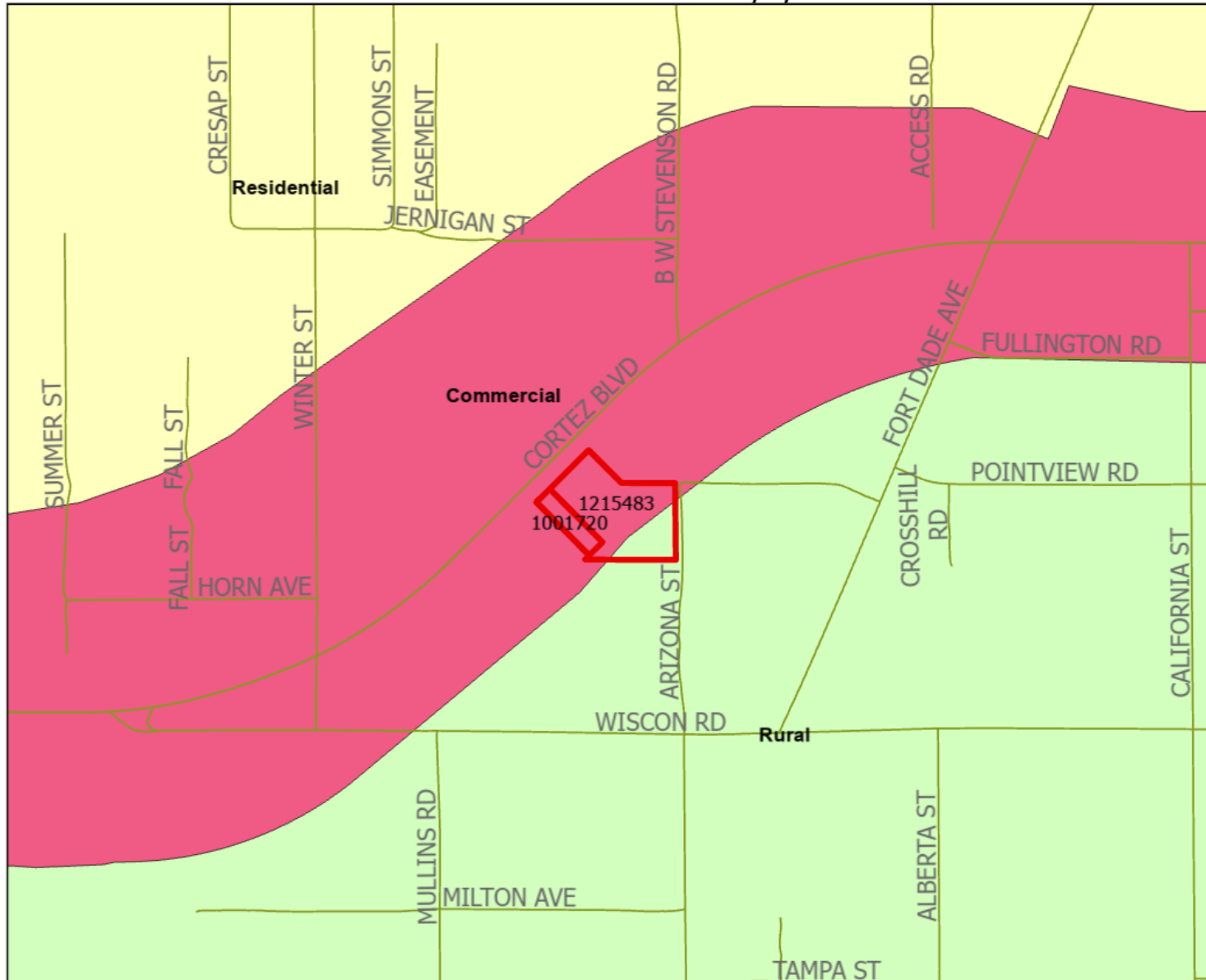

**FLU LABEL**

- Commercial
- Residential
- Rural

**Future Land Use Map**

PLEASE REFER TO THE TEXT PORTION OF THE COMPREHENSIVE PLAN IN CONJUNCTION WITH THE USE OF THE FUTURE LAND USE MAP SERIES.

NOTE: THE RIVERINE DISTRICT IS SHOWN AS A LINE SETBACK PARALLEL TO THE WEEKI WACHEE, MUD AND WITHLACOCHEE RIVERS.



Not to scale.

# H-25-41 AREA MAP

This map was prepared by this office to be used as aid and land parcel location and identification only. All land locations, right-of-ways widths, acreages, and utility locations are subject to field survey or other appropriate verification.

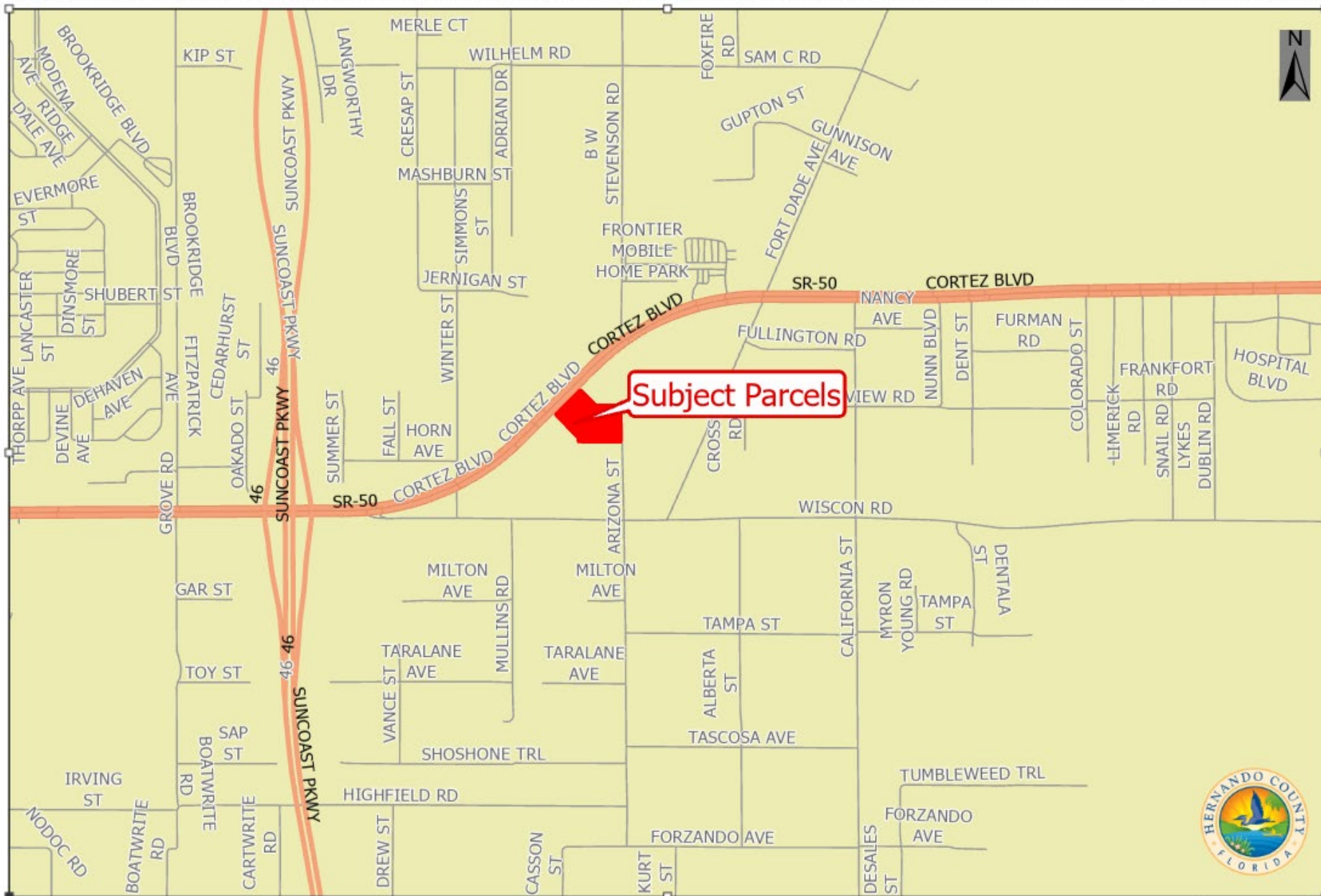

Not to scale.

# H-25-41

This map was prepared by this office to be used as aid and land parcel location and identification only. All land locations, right-of-ways widths, acreages, and utility locations are subject to field survey or other appropriate verification

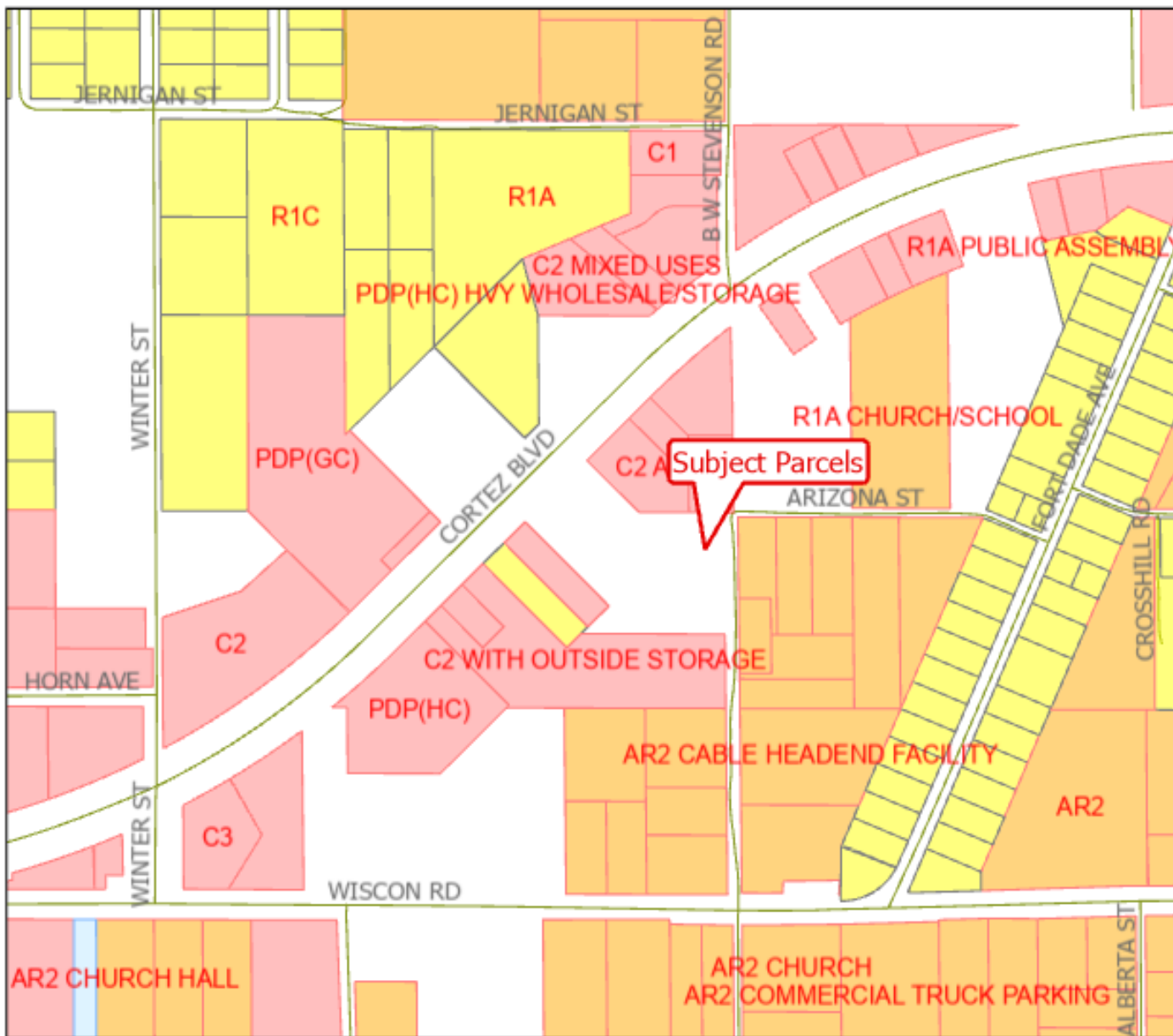

### Legend

**Zoning**

- Agricultural Residential
- Commercial
- Residential
- Special Use

