

RCVD ENGINEERING
FEB 5 '26 PM 1:59

Class D Subdivision Department of Public Works Clearance Form

Pursuant to Hernando County Ordinance, Chapter 26, Section 26-3, Class D (1), Applicants must receive driveway location approval by the Department of Public Works prior to approval of the Class D subdivision. Department of Public Works is located at 1525 E. Jefferson St., Brooksville, FL 34601.

Please submit this form with one copy of the survey showing proposed driveway and access locations to the Department of Public Works for review. The review results will be returned to the Subdivision Review Technician. A fee set by the Department of Public Works will be collected with the clearance form submittal.

Date: 5 Feb 2026 Parcel Key: R16 423 20 0000 0180 0000

Print Applicant Name: DAPHNE J. HERNANDEZ

Applicant Address: 25900 OLD SPRING LAKE RD.

Applicant Phone Number: (813) 389-8942

Applicant Email address: Phernandez11@verizon.net

Review Results:

Department of Public Works inspector Name: Scott Pedman

The proposed driveway location is **approved** by the Department of Public Works. At such time a driveway installation or Right-of-Way improvement is proposed, a Right-of-Way permit or Building Department driveway permit will be required prior to construction.

The proposed driveway location is **not approved**.

Notes: _____

Receipt # 4639 ck # 6184 \$100.00



FOUND 5/8" IR - "LB 3704"
 FOUND 5/8" IR - ILLEGIBLE
 13.25' South, 3.65' East

OLD SPRING LAKE ROAD

POINT OF BEGINNING
 FOUND 5/8" IR
 NO ID

NORTH LINE OF THE NORTHWEST 1/4
 OF SECTION 16-23-20

295.90'
 N 89°59'03" E 315.90'

APPARENT SOUTH MAINTAINED
 RIGHT-OF-WAY LINE OF OLD
 SPRING LAKE ROAD

20.00' INGRESS/EGRESS
 EASEMENT

PARCEL 1

3.04 Acres

SEE HOUSE
 DETAIL

3'X3'
 A/C PAD

4" WELL

6'X8'
 PUMP HOUSE

16'X 12'
 SHED

S 89°56'47" W
 315.04'

FOUND 5/8" IR
 "LB 3704"

PARCEL 2

HOUSE DETAIL
 1"=20'

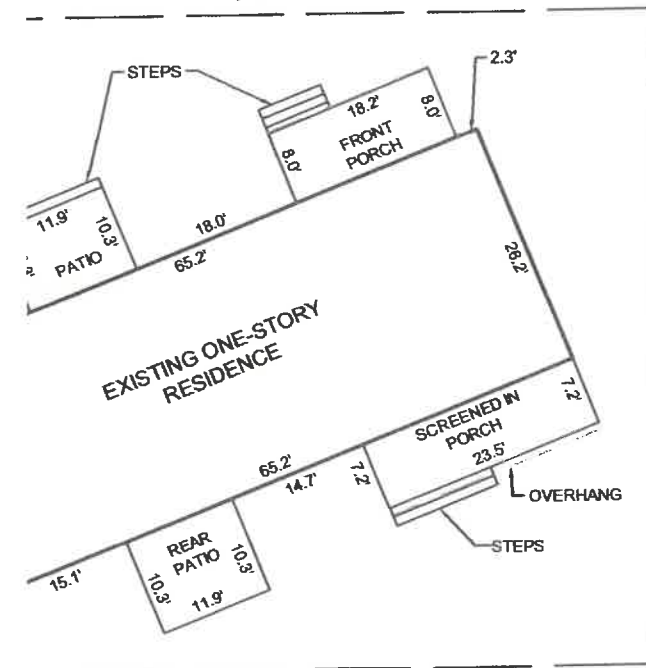

LINE TABLE

LINE	BEARING	DISTANCE
L1	S 00°06'52" W	14.73'